

**District I**

1625 N. French Dr., Hobbs, NM 88240

**District II**

1301 W. Grand Ave., Artesia, NM 88210

**District III**

1000 Rio Brazos Rd., Aztec, NM 87410

**District IV**

1220 S. St Francis Dr., Santa Fe, NM 87505

State of New Mexico  
Energy, Minerals and Natural Resources  
Oil Conservation Division  
1220 S. St Francis Dr.  
Santa Fe, NM 87505

Form C-1

**APPLICATION FOR PERMIT TO DRILL**

Operator Name and Address RICHARDSON OPERATING CO 3100 La Plata Highway Farmington, NM 87401		OGRID Number 19219
		API Number 30-045-32140
Property Code 33345	Property Name WF FRPC 17	Well No. 002

**Surface Location**

UL or Lot E	Section 17	Township 29N	Range 14W	Lot Idn 2	Feet From 1975	N/S Line N	Feet From 575	E/W Line W	County San Juan
----------------	---------------	-----------------	--------------	--------------	-------------------	---------------	------------------	---------------	--------------------

**Proposed Pools**

TWIN MOUNDS FRUITLAND SAND PC (GAS) 86620
---

Work Type New Well	Well Type GAS	Cable/Rotary	Lease Type Private	Ground Level Elevation 5160
Multiple N	Proposed Depth 1100	Formation Pictured Cliffs Formation	Contractor	Spud Date 05/01/2004

**Proposed Casing and Cement Program**

Type	Hole Size	Casing Size	Casing Weight/ft	Setting Depth	Sacks of Cement	Estimated TOC
Surf	8.75	7	20	120	60	0
Prod	6.25	4.5	10.5	1100	175	0

**Proposed Blowout Prevention Program**

Type	Working Pressure	Test Pressure	Manufacturer
Double Ram	2000	1000	

I hereby certify that the information given above is true and complete to the best of my knowledge and belief.

Electronically Signed By: Anne Jones

Title:

Date: 01/23/2004

Phone: 505-564-8115

**OIL CONSERVATION DIVISION**

Electronically Approved By: Frank Chavez

Title: District Supervisor

Approval Date: 01/27/2004 Expiration Date: 01/27/2005

Conditions of Approval:  
There are conditions. See Attached.

State of New Mexico  
Energy, Minerals & Mining Resources Department  
**OIL CONSERVATION DIVISION**  
2040 South Pacheco  
Santa Fe, NM 87505

Form C - 102

☐ AMENDED REPORT

**WELL LOCATION AND ACREAGE DEDICATION PLAT**

APA Number 30-045-	Pool Code 86620	Pool Name Twin Mounds Fruitland Sand PC (Gas)
Property Code	Property Name WF FRPC 17	Well Number 2
OGPD No. 19219	Operator Name RICHARDSON OPERATING COMPANY	Elevation 5160'

Surface Location									
UL or Lot E	Sec. 17	Twp. 29 N.	Rge. 14 W.	Lot Ltr.	Feet from 1975'	North/South North	Feet from 575'	East/West West	County SAN JUAN

Bottom Hole Location if Different From Surface									
UL or Lot	Sec.	Twp.	Rge.	Lot Ltr.	Feet from	North/South	Feet from	East/West	County
Dedication	Joint ?	Consolidation			Order No.				

NO ALLOWABLE WELL ASSIGNED TO THIS COMPLETION UNTIL ALL INTERESTS HAVE BEEN CONSOLIDATED  
OR A NON-STANDARD UNIT HAS BEEN APPROVED BY THE DIVISION

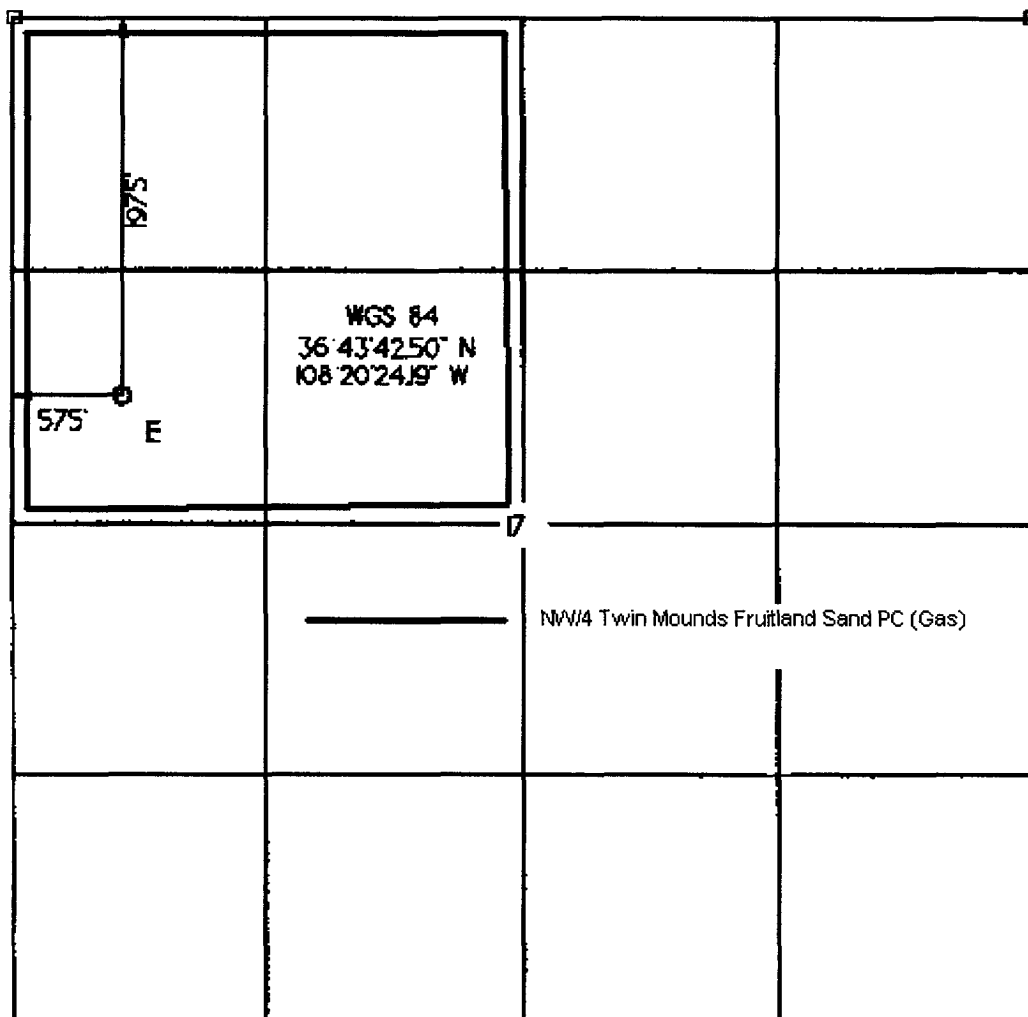

<b>OPERATOR CERTIFICATION</b> I hereby certify that the information contained herein is true and complete to the best of my knowledge and belief.	
Signature <i>Paul Lehrman</i>	Printed Name Paul Lehrman
Title Landman	
Date 1/23/04	
<b>SURVEYOR CERTIFICATION</b> I hereby certify that the well location on this plat was plotted from field notes of actual surveys made by me or under my supervision, and that the same is true and correct to the best of my belief.	
Date of Survey rev: 01/14/04	
Signature and Seal of Professional Surveyor 	

## Permit Comments

**Operator:** RICHARDSON OPERATING CO , 19219

**Well:** WF FRPC 17 #002

User Name	Comment	Comment Date
AJONES	ADDITIONAL COMMINGLE FORMATION FRUITLAND COAL	9/22/2003
PLEHRMAN	Will file simo. NSL with state for NSL location.	1/23/2004
PLEHRMAN	Will not commingle with FC formation (FC is not proposed at this time) as San Juan River does not allow infill for proposed well in NE/4 of Sec. 17., because of river location and Navajo acreage south of San Juan River in NW/4. Please ignore comments as to FC on 9/22/03.	1/23/2004

**Permit Conditions Of Approval**

**Operator: RICHARDSON OPERATING CO , 19219**

**Well: WF FRPC 17 #002**

OCD Reviewer	Condition
SHAYDEN	Will require administrative order for non-standard location