

Submit 3 Copies To Appropriate District Office  
 District I  
 1625 N. French Dr., Hobbs, NM 87240  
 District II  
 1301 W. Grand Ave., Artesia, NM 88210  
 District III  
 1000 Rio Brazos Rd., Aztec, NM 87410  
 District IV  
 1220 S. St. Francis Dr., Santa Fe, NM 87505

State of New Mexico  
 Energy, Minerals and Natural Resources

Form C-103  
 June 19, 2008

OIL CONSERVATION DIVISION  
 1220 South St. Francis Dr.  
 Santa Fe, NM 87505

<b>SUNDRY NOTICES AND REPORTS ON WELLS</b> (DO NOT USE THIS FORM FOR PROPOSALS TO DRILL OR TO DEEPEN OR PLUG BACK TO A DIFFERENT RESERVOIR. USE "APPLICATION FOR PERMIT" (FORM C-101) FOR SUCH PROPOSALS.)		WELL API NO. 30-045-06127
1. Type of Well: Oil Well <input type="checkbox"/> Gas Well <input checked="" type="checkbox"/> Other		5. Indicate Type of Lease STATE <input type="checkbox"/> FEE <input type="checkbox"/>
2. Name of Operator XTO Energy Inc.		6. State Oil & Gas Lease No.
3. Address of Operator 382 CR 3100 AZTEC, NM 87410		7. Lease Name or Unit Agreement Name: BOLACK C LS
4. Well Location Unit Letter <u>L</u> : <u>1800</u> feet from the <u>SOUTH</u> line and <u>1180</u> feet from the <u>WEST</u> line Section <u>33</u> Township <u>27N</u> Range <u>8W</u> NMPM <u>NMEM</u> County <u>SAN JUAN</u>		8. Well Number 15
		9. OGRID Number 5380
		10. Pool name or Wildcat BLANCO MESAVERDE/OTERO CHACRA
		11. Elevation (Show whether DR, RKB, RT, GR, etc.) 6780' GR

12. Check Appropriate Box to Indicate Nature of Notice, Report, or Other Data

NOTICE OF INTENTION TO:

PERFORM REMEDIAL WORK  PLUG AND ABANDON   
 TEMPORARILY ABANDON  CHANGE PLANS   
 PULL OR ALTER CASING  MULTIPLE COMPL   
 DOWNHOLE COMMINGLE   
 OTHER:

SUBSEQUENT REPORT OF:

REMEDIAL WORK  ALTERING CASING   
 COMMENCE DRILLING OPNS.  P AND A   
 CASING/CEMENT JOB  RCVD FEB 24 '11  
 OIL CONS. DIV.  
 DIST. 3

13. Describe proposed or completed operations. (Clearly state all pertinent details, and give pertinent dates, including estimated date of starting any proposed work). SEE RULE 1103. For Multiple Completions: Attach wellbore diagram of proposed completion or recompletion.

XTO Energy requests permission to DHC this well per OCD Rule 19.15.12.11 C(2) in the Blanco Mesaverde (72319, 5048'-5136') & the Otero Chacra (82329, 3705'-3877'), both pre-approved per order R-11363, upon completion of the Chacra. Please see attached spreadsheet for justification of proposed allocations.

Blanco Mesaverde	Oil: 13%	Gas: 27%	Water: 70%
Otero Chacra	Oil: 87%	Gas: 73%	Water: 30%

Ownership in pools is common; therefore, there are no owners to notify of our intent to DHC. DHC will offer an economical method of production while protecting against reservoir damage, waste of reserves & violation of correlative rights. The BLM was notified of our intent to DHC via Form 3160-5 on 2/23/2011.

Spud Date:

DHC 3549A2

Rig Release Date:

I hereby certify that the information above is true and complete to the best of my knowledge and belief.

SIGNATURE Wanett McCauley TITLE REGULATORY COMPLIANCE TECH DATE 2/23/2011  
wanett\_mccauley@xtoenergy.com  
 Type or print name WANETT MCCAULEY E-mail address: \_\_\_\_\_ PHONE 505-333-3630

For State Use Only  
 APPROVED BY Charles L SUPERVISOR DISTRICT # 3 DATE FEB 28 2011  
 TITLE \_\_\_\_\_

Conditions of Approval (if any):

**Allocations for the Bolack C LS 15**

Wells producing from the Chacra drilled after 2000 surrounding the Bolack C LS 15

LEASE NAME	NO.	RESERVOIR	SECTION	TOWNSHIP	RANGE	FIELD	OPERATOR	1st PROD
BOLACK C	10C	CHACRA	28	27 N	8 W	OTERO	XTO ENERGY	20020601
BOLACK C	22	CHACRA	28	27 N	8 W	OTERO	XTO ENERGY	20051001
BOLACK C LS	15A	CHACRA	33	27 N	8 W	OTERO	XTO ENERGY	20010901
BOLACK C LS	12A	CHACRA	29	27 N	8 W	OTERO	XTO ENERGY	20011101
BOLACK C	21	CHACRA	28	27 N	8 W	OTERO	XTO ENERGY	20050901
BOLACK C	11B	CHACRA	28	27 N	8 W	OTERO	XTO ENERGY	20020701
BOLACK C	13B	CHACRA	29	27 N	8 W	OTERO	XTO ENERGY	20021001
BOLACK C	23	CHACRA	29	27 N	8 W	OTERO	XTO ENERGY	20050101
Average								

**Bolack C LS 15 Current Production**

LEASE NAME	NO.	RESERVOIR	SECTION	TOWNSHIP	RANGE	FIELD	1st PROD	LAST PROD
Bolack C LS	15	MESAVERDE	33	27 N	8 W	BLANCO	19581031	20101201

**Allocations**

	Oil	Gas	Water
Chacra	87%	73%	30%
Mesaverde	13%	27%	70%

**Last 6 Months Production For the Bolack C LS 15**

*Mesaverde Production*

	<b>Oil Prod (BBL)</b>	<b>Gas Prod (MCF)</b>	<b>Water Prod (BBL)</b>	<b>Days On</b>	<b>Oil (BBL/D)</b>	<b>Gas (MCF/D)</b>	<b>Water (BBL/D)</b>
7/31/2010	0	427	0	31	0.00	13.77	0.00
8/31/2010	0	423	60	23	0.00	18.39	2.61
9/30/2010	0	463	0	30	0.00	15.43	0.00
10/31/2010	2	1021	120	31	0.06	32.94	3.87
11/30/2010	0	875	0	30	0.00	29.17	0.00
12/31/2010	0	899	60	31	0.00	29.00	1.94
<b>AVERAGE</b>					0.01	23.12	1.40

**District I**  
1625 N. French Dr., Hobbs, NM 88240  
**District II**  
811 South First, Artesia, NM 88210  
**District III**  
1000 Rio Brazos Rd., Aztec, NM 87410  
**District IV**  
1220 S. St. Francis Dr., Santa Fe, NM 87505

State of New Mexico  
Energy, Minerals & Natural Resources Department  
**OIL CONSERVATION DIVISION**  
1220 South St. Francis Dr.  
Santa Fe, NM 87505

Form C-102  
Revised October 12, 2005  
Submit to Appropriate District Office  
Fee Lease - 3 Copies  
State Lease - 4 Copies

AMENDED REPORT

WELL LOCATION AND ACREAGE DEDICATION PLAT

<sup>1</sup> API Number 30-045-06127		<sup>2</sup> Pool Code 82329		<sup>3</sup> Pool Name OTERO CHACRA	
<sup>4</sup> Property Code 22596		<sup>5</sup> Property Name BOLACK CLS			<sup>6</sup> Well Number #15
<sup>7</sup> OGRID No. 5380		<sup>8</sup> Operator Name XTO Energy, Inc.			<sup>9</sup> Elevation 6780

<sup>10</sup>Surface Location

UL or lot no.	Section	Township	Range	Lot Idn	Feet from the	North/South line	Feet from the	East/West line	County
L	33	27N	8W		1800'	SOUTH	1180'	WEST	SAN JUAN

<sup>11</sup>Bottom Hole Location If Different From Surface

UL or lot no.	Section	Township	Range	Lot Idn	Feet from the	North/South line	Feet from the	East/West line	County
SAME									

<sup>12</sup> Dedicated Acres CH 160	<sup>13</sup> Joint or Infill	<sup>14</sup> Consolidation Code	<sup>15</sup> Order No.
---	-------------------------------	----------------------------------	-------------------------

NO ALLOWABLE WILL BE ASSIGNED TO THIS COMPLETION UNTIL ALL INTERESTS HAVE BEEN CONSOLIDATED OR A NON-STANDARD UNIT HAS BEEN APPROVED BY THE DIVISION

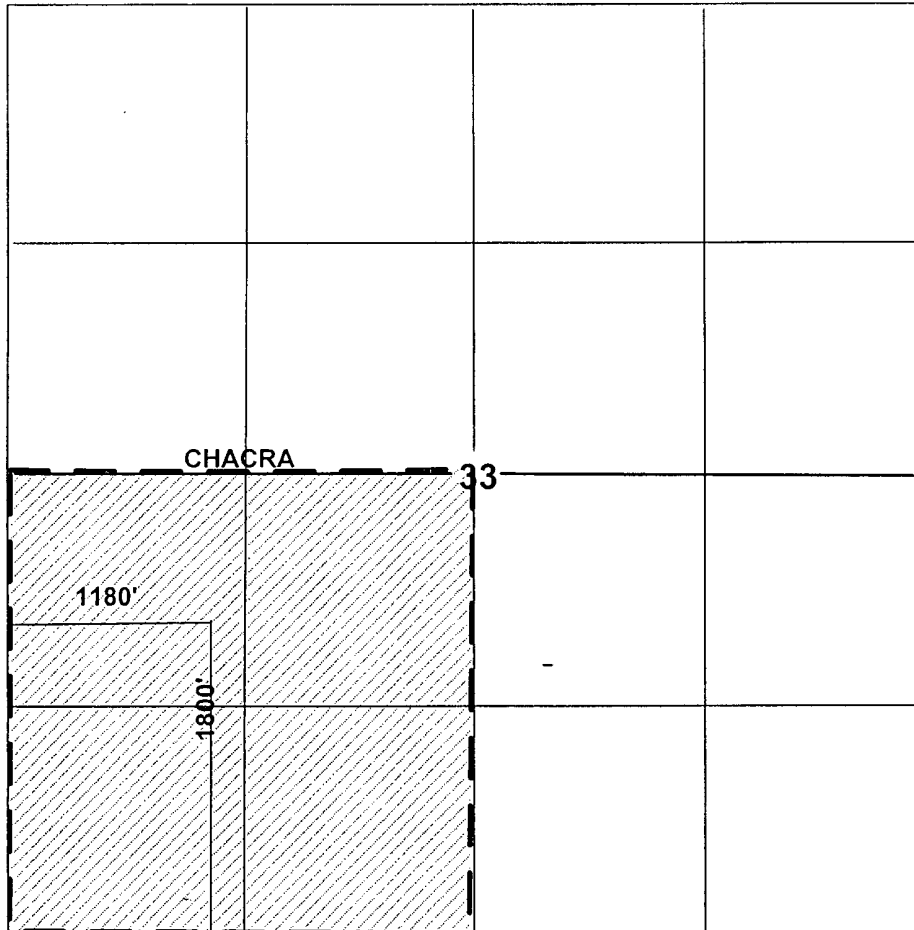

**<sup>17</sup> OPERATOR CERTIFICATION**  
*I hereby certify that the information contained herein is true & complete to the best of my knowledge & belief and that this organization either owns a working interest or unleased mineral interest in the land including the proposed bottom hole location or has a right to drill this well at this location pursuant to a contract with an owner of such a mineral or working interest, or to a voluntary pooling agreement or a compulsory pooling order heretofore entered by the division.*

Signature  
*Teena M. Whiting*  
Printed Name  
TEENA M. WHITING

Title  
REGULATORY COMP TECH

Date  
2/23/2011

**<sup>18</sup> SURVEYOR CERTIFICATION**  
*I hereby certify that the well location shown on this plat was plotted from field notes of actual surveys made by me or under my supervision, and that the same is true & correct to the best of my belief.*

6/23/1984  
Date of Survey

Original Survey Signed By:  
*John A. Vukonich*

14831  
Certificate Number