

UNITED STATES
DEPARTMENT OF THE INTERIOR
BUREAU OF LAND MANAGEMENT

RECEIVED

APPLICATION FOR PERMIT TO DRILL, DEEPEN, OR PLUG BACK

1a. Type of Work DRILL	5. Lease Number NMSF - 078215-A Unit Reporting Number 070 Farmington, NM
1b. Type of Well GAS	6. If Indian, All. or Tribe
2. Operator BURLINGTON RESOURCES Oil & Gas Company	7. Unit Agreement Name
3. Address & Phone No. of Operator PO Box 4289, Farmington, NM 87499 (505) 326-9700	8. Farm or Lease Name Vanderslice 9. Well Number #100S
4. Location of Well 1850' FNL, 805' FWL Latitude 36° 59.2246'N, Longitude 107° 55.7550' W	10. Field, Pool, Wildcat Basin Fruitland Coal 11. Sec., Twn, Rge, Mer. (NMPM) E Sec. 18, T32N, R10W API # 30-045- 30029
14. Distance in Miles from Nearest Town 17.2 miles to Aztec, NM	12. County San Juan 13. State NM
15. Distance from Proposed Location to Nearest Property or Lease Line 805'	17. Acres Assigned to Well 318.37 N/2
16. Acres in Lease	
18. Distance from Proposed Location to Nearest Well, Drig, Compl, or Applied for on this Lease 21'	
19. Proposed Depth 3276'	20. Rotary or Cable Tools Rotary
21. Elevations (DF, FT, GR, Etc.) 6474' GR	22. Approx. Date Work will Start
23. Proposed Casing and Cementing Program See Operations Plan attached	
24. Authorized by: <u>Doni Clark</u> Regulatory/Compliance Specialist	<u>10-20-03</u> Date

PERMIT NO. _____ APPROVAL DATE _____
APPROVED BY WAYNE TOWNSEND TITLE Acting AFM DATE 3/10/04

Archaeological Report attached

Threatened and Endangered Species Report attached

NOTE: This format is issued in lieu of U.S. BLM Form 3160-3

Title 18 U.S.C. Section 1001, makes it a crime for any person knowingly and willfully to make to any department or agency of the United States any false, fictitious or fraudulent statements or presentations as to any matter within its jurisdiction.

DRILLING OPERATIONS AUTHORIZED ARE
SUBJECT TO THE FOLLOWING ATTACHED
"GENERAL REQUIREMENTS".

This action is subject to technical and
procedural review pursuant to 43 CFR 3165.3
and appeal pursuant to 43 CFR 3165.4

NMCCD

DISTRICT I
1825 N. French Dr., Hobbs, N.M. 88240

State of New Mexico
Energy, Minerals & Natural Resources Department

Form C-102
Revised August 15, 2000

DISTRICT II
811 South First, Artesia, N.M. 88210

DISTRICT III
1000 Rio Brazos Rd., Aztec, N.M. 87410

DISTRICT IV
2040 South Pacheco, Santa Fe, NM 87505

OIL CONSERVATION DIVISION
2040 South Pacheco
Santa Fe, NM 87505

Submit to Appropriate District Office
State Lease - 4 Copies
Fee Lease - 3 Copies

☐ AMENDED REPORT

WELL LOCATION AND ACREAGE DEDICATION PLAT

*API Number 30-045- 30029		*Pool Code 71629	*Pool Name Basin Fruitland Coal
*Property Code 18633	*Property Name VANDERSLICE		*Well Number 100S
*GRID No. 14538	*Operator Name BURLINGTON RESOURCES OIL & GAS, INC.		*Elevation 6474'

¹⁰ Surface Location

UL or lot no.	Section	Township	Range	Lot Idn	Feet from the	North/South line	Feet from the	East/West line	County
E	18	32-N	10-W		1850'	NORTH	805'	WEST	SAN JUAN

¹¹ Bottom Hole Location If Different From Surface

UL or lot no.	Section	Township	Range	Lot Idn	Feet from the	North/South line	Feet from the	East/West line	County
*Dedicated Acres N/318.37			*Joint or Infill		*Consolidation Code		*Order No.		

NO ALLOWABLE WILL BE ASSIGNED TO THIS COMPLETION UNTIL ALL INTERESTS HAVE BEEN CONSOLIDATED
OR A NON-STANDARD UNIT HAS BEEN APPROVED BY THE DIVISION

FD 3 1/4" B.L.M. BC 1953	N 89-45-30 E	5291.57' (M)	FD 3 1/4" B.L.M. BC 1969
LOT 8	LOT 7	LOT 6	LOT 5
1850'	USA SF-078215-A		MAR 2004 RECEIVED OIL CONSERV. DIV. DIST. 3
534'	LAT. 36°59.2246' N (NAD 27) LONG. 107°55.7550' W		LOT 12
805'	LOT 10	LOT 11	
781'	18		
FD 3 1/4" B.L.M. BC 1953	LOT 15	LOT 14	LOT 13
LOT 16			
LOT 17	LOT 18	LOT 19	LOT 20

17 OPERATOR CERTIFICATION

I hereby certify that the information contained herein
is true and complete to the best of my knowledge and
belief

Joni Clark
Signature
Joni Clark
Printed Name
Regulatory Specialist
Title
10-20-03
Date

18 SURVEYOR CERTIFICATION

I hereby certify that the well location shown on this plat
was plotted from field notes of actual surveys made by
me or under my supervision, and that the same is true
and correct to the best of my belief.

OCT 6 2002
Date of Survey
NEW MEXICO
Signature and Seal of Professional Surveyor:
14827
14827
Certificate Number

BURLINGTON RESOURCES

RECEIVED

SAN JUAN DIVISION

2004 FEB 11 AM 10:18

February 10, 2004

070 Farmington, NM

Bureau of Land Management
1235 La Plata Highway
Farmington, New Mexico 87401

Dear Adrienne Garcia:

The surface cement slurry has been changed for the following wells to:

Cement with Type III cement with 0.25 pps Celloflake, 3% calcium chloride. (1.28 yeild, 15.2 ppg, 200% excess, bring cement to surface). Wait on cement appropriate time until cement achieves 250 psi compressive strength at 60 degrees F. prior to nipple up of BOPE. Wait on cement for 8 hrs for conventionally set holes before pressure testing or drilling out from under surface. Test casing to 600 psi for 30 minutes.

9-5/8" csg set @ 120'
88 sxs cmt
113 cu. ft. of slurry

Allison Unit 120S, NWSE, Sec. 30, T-32-N, R-6-W, Federal lease NM-04207.
Allison Unit 121S, SENW, Sec. 30, T-32-N, R-6-W, Federal lease SF-081155.
Carson SRC 101S, SWNW, Sec. 1, T-30-N, R-5-W, Federal lease NM-4453.
Federal G 1N, SESW, Sec. 35, T-31-N, R-12-W, Federal lease SF-078120A.
Hale 351S, SWNW, Sec. 34, T-31-N, R-8-W, Federal lease SF-079037.
Hale 352S, NWSE, Sec. 27, T-31-N, R-8-W, Federal lease SF-079037.
Howell A 301S, NENW, Sec. 4, T-30-N, R-8-W, Federal lease SF-078580.
Howell Com J 301S, NWNW, Sec. 11, T-30-N, R-8-W, Federal lease NM-010468.
Howell D 350S, SWSW, Sec. 28, T-31-N, R-8-W, Federal lease SF-078387.
Howell D 351S, SENW, Sec. 29, T-31-N, R-8-W, Federal lease SF-078387.
Johnston Federal 15S, NWSW, Sec. 35, T-31-N, R-9-W, Federal lease SF-078439.
Johnston Federal 26S, SWNW, Sec. 7, T-31-N, R-9-W, Federal lease SF-078439.
Johnston Federal 29S, SWSE, Sec. 7, T-31-N, R-9-W, Federal lease SF-078439.
San Juan 32-9 Unit 250S, SWSE, Sec. 4, T-31-N, R-9-W, Federal lease SF-080875.
San Juan 32-9 Unit 277S, SENW, Sec. 30, T-32-N, R-9-W, Federal lease SF-078509.
San Juan 32-9 Unit 283S, NENW, Sec. 33, T-32-N, R-9-W, Federal lease SF-079048.
Scott 100S, SENW, Sec. 29, T-32-N, R-10-W, Federal lease SF-078604.
Scott Com 291S, NESE, Sec. 29, T-32-N, R-10-W, Federal lease SF-078604.
Vanderslice 100S, SWNW, Sec. 18, T-32-N, R-10-W, Federal lease SF-078215A.
Waller 100S, SESE, Sec. 11, T-32-N, R-11-W, Federal lease SF-078119A.
Wilmer Canyon 101S, NENW, Sec. 25, T-32-N, R-8-W, Federal lease NM-6893.



Sincerely,

Tammy Wimsatt

Tammy Wimsatt
Regulatory Specialist

NMOCD

OPERATIONS PLAN

Well Name: Vanderslice #100S
Location: 1850' FNL, 805' FWL Section 18, T-32-N, R-10-W
Latitude 36° 59.2246'N, Longitude 107° 55.7550'W
San Juan County, NM
Formation: Basin Fruitland Coal
Elevation: 6474' GR

Formation:	Top	Bottom	Contents
Surface	San Jose	1281'	
Ojo Alamo	1281'	1361'	aquifer
Kirtland	1361'	2776'	
Fruitland	2776'	2901'	
Intermediate TD	2851'		
Fruitland Coal	2901'	3191'	gas
B/Basal Coal	3191'	3201'	gas
Pictured Cliffs	3201'		
Total Depth	3276'		

Logging Program: none
Mudlog: from 7" to 3276'
Coring Program: none

Mud Program:

Interval	Type	Weight	Vis.	Fluid Loss
0- 120'	Spud Mud/Air/Air Mist	8.4-9.0	40-50	no control
120-2851'	Non-dispersed	8.4-9.0	30-60	no control
2851-3276'	Air/Mist			

Casing Program (as listed, the equivalent, or better):

Hole Size	Depth Interval	Csg. Size	Wt.	Grade
12 1/4"	0' - 120'	9 5/8"	32.3#	H-40
8 3/4"	0' - 2851'	7"	20.0#	J-55
6 1/4"	2851' - 3276'	open hole		

Alternate Casing Program (as listed, the equivalent, or better):

Hole Size	Depth Interval	Csg. Size	Wt.	Grade
12 1/4"	0' - 120'	9 5/8"	32.3#	H-40
8 3/4"	0' - 2851'	7"	20.0#	J-55
6 1/4"	2811' - 3276'	5 1/2"	15.5#	J-55

Tubing Program:

0' - 3276'	2 3/8"	4.7#	J-55
------------	--------	------	------

Float Equipment: 9 5/8" surface casing - saw tooth guide shoe. Centralizers will be run in accordance with Onshore Order #2.

7" intermediate casing - guide shoe and self-fill float collar. Standard centralizers run every other joint above shoe. Two turbolizing type centralizers - one below and one into the base of the Ojo Alamo @ 1361'. Standard centralizers thereafter every fourth joint up to the base of the surface pipe.

Wellhead Equipment: 9 5/8" x 7" x 2 3/8" x 11" 2000 psi xmas tree assembly.

Cementing:

9 5/8" surface casing -

Pre-Set Drilled Cement with 23 sx Type I, II cement with 20% flyash mixed at 14.5 ppg, 1.61 cu ft per sack yield. (37 cu ft of slurry, bring cement to surface) Wait on cement for 24 hours for pre-set holes before pressure testing or drilling out from under surface.

Conventionally Drilled

Cement with 80 sx Type III cement with 0.25 pps Celloflake, 2% CaCl. (113 cu ft of slurry, 200% excess, bring cement to surface) Wait on cement for 8 hrs for conventionally set holes before pressure testing or drilling out from under surface.

~~Waive the 6 hours WOC in lieu of 4 hours prior to NU of BOPE.~~ See BLM General Requirements

7" intermediate casing - lead w/243 sacks Premium Lite with 3% calcium chloride, 5 pps LCM-1, and 1/4#/sack flocele, 0.4% FL-52, & 0.4% SMS. Tail with 90 sacks Type III cmt with 1% calcium chloride, 1/4#/sack flocele and 0.2% FL-52 (643 cu.ft., 50% excess to circulate to surface).

5 1/2" liner - will not be cemented if run.

Note: If open hole logs are run, cement volumes will be based on 25% excess over caliper volumes.

BOP and tests:

Surface to intermediate TD - 11" 2000 psi (minimum) double gate BOP stack (Reference Figure #1). Prior to drilling out surface casing, test rams to 600#/30 min.

Intermediate TD to Total Depth - 7 1/6" 2000 psi (minimum) double gate BOP stack (Reference Figure #2). Prior to drilling out intermediate casing, test blind rams and casing to 1500 psi for 30 minutes; all pipe rams and casing to 1500 psi for 30 minutes each.

From surface to TD - choke manifold (Reference Figure #3).

Pipe rams will be actuated at least once each day and blind rams actuated once each trip to test proper functioning. An upper kelly cock valve with handle and drill string safety valves to fit each drill string will be maintained and available on the rig floor.

Additional information:

- * The Fruitland Coal formation will be completed.
- * Anticipated pore pressure for the Fruitland is less than 500 psi.
- * This gas is dedicated.
- * The north half of Section 18 is dedicated to the Fruitland Coal.

Date: 12-16-03

Drilling Engineer:

Jim McCarthy

BURLINGTON RESOURCES

SAN JUAN DIVISION

Released
3-12-04

November 13, 2003

(Certified Mail – Return Receipt Requested)

Re: Vanderslice 100S
Basin Fruitland Coal
1850'FNL, 805'FWL Section 18, T-32-N, R-10-W
San Juan County, New Mexico

To the Affected Persons:

Burlington Resources Oil & Gas Company LP is submitting the enclosed Application for Permit to Drill to the appropriate regulatory agency(s) for approval. This well is located inside the High Productivity Area of the Basin-Fruitland Coal Pool as indicated on the attached plat. Notice is being made pursuant to New Mexico Oil Conservation Commission Order R-8768-F dated July 17, 2003.

The affected parties have twenty (20) days from receipt of this notice in which to file with the District Office of the New Mexico Oil Conservation Division written objection to the proposed Application for Permit to Drill.

Sincerely,

Frances Bond

Frances Bond
Regulatory Assistant



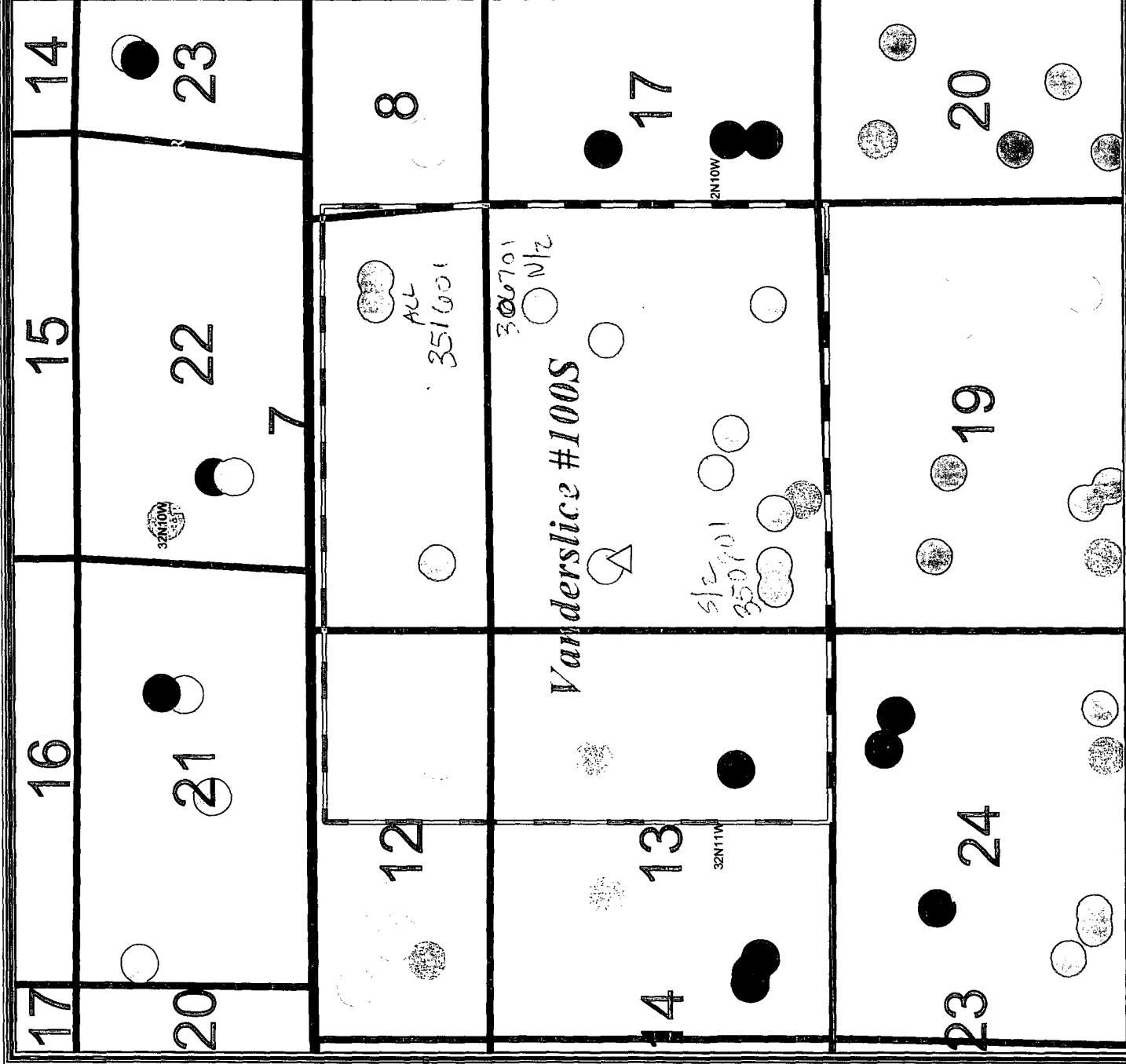

Legend

P2000 Well Header 32-10

Current Operator

- unknown
- AMOCO PRODUCTION COMPANY
- BP AMERICA PRODUCTION COMPANY
- VASTAR RESOURCES INCORPORATED
- BURLINGTON RESOURCES
- BURLINGTON RESOURCES O&G CO LP
- BURLINGTON RESOURCES OIL & GAS COMPANY
- EL PASO NATURAL GAS COMPANY
- MERIDIAN OIL INCORPORATED
- SOUTHLAND ROYALTY COMPANY
- CONOCO INCORPORATED
- CONOCOPHILLIPS COMPANY
- PHILLIPS PETROLEUM COMPANY
- WILLIAMS PRODUCTION COMPANY
- MCDEVITT OIL & GAS PROPERTIES
- ENERGEN RESOURCES CORPORATION
- COLEMAN OIL & GAS INCORPORATED
- AZTEC OIL & GAS COMPANY
- RED WILLOW PRODUCTION COMPANY



BURLINGTON
RESOURCES



GCS Assumed Geographic 1

BURLINGTON RESOURCES

San Juan

Vanderslice #100S

32-10
Sep 18

Prepared By: hmc Date: 9/10/2003
File Number: Revised Date: 9/10/2003
File Name: r:\data\hmc\Projects\hmc\910\hmc910.mxd

<p>2. Article Number</p> <p>1. Article Addressed to: IBEX PARTNERSHIP LTD PO BOX 911 PO BOX 911 Breckenridge, TX 76424-0911</p>	<p style="text-align: center;">COMPLETE THIS SECTION ON DELIVERY</p> <p>A. Signature <input checked="" type="checkbox"/> Agent <input checked="" type="checkbox"/> Addressee <i>Christie Spencer</i></p> <p>B. Received by (Printed Name) <i>Christie Spencer</i></p> <p>C. Date of Delivery <i>11-17</i></p> <p>D. Is delivery address different from Item 12? <input type="checkbox"/> Yes If YES enter delivery address below: 0000 00277</p>
<p>3. Service Type <input checked="" type="checkbox"/> Certified</p>	
<p>4. Restricted Delivery? (Extra Fee) <input type="checkbox"/> Yes</p>	

PS Form 3811

7:50 AM 9/18/2003

Code: Vanderslice 100S

File:

PS Form 3811

Danderslice 100s

COMPLETE THIS SECTION ON DELIVERY

X A. Signature

Agent

Address

B. Received by (Printed Name) AIN C. Dale of Library

D. Is delivery address different from Item 1? ☐ Yes

D. Is delivery address different from item 1? ☐ Yes

1. Article 1000 Phillips Company

Chief Landman San Jaun/Rockies

PO Box 2197

PO Box 2197

Houston, TX 77252-2197

3. Service Type



Certified

4. Restricted Delivery? (Extra Fee)

Yes

PS Form 3811

3:27 PM 9/15/2003

Code: **FTC Domestic Return Receipt**

File:

Vanderstee 100s

7110 6605 9590 0007 0079

RETURN
RECEIPT
SERVICE

POSTAGE

POSTMARK OR DATE

RESTRICTED DELIVERY FEE

\$0.37

CERTIFIED FEE

\$0.00

RETURN RECEIPT FEE

\$2.30

SENT TO:

TOTAL POSTAGE AND FEES

\$4.42

9/15/2003
3:27 PM

Code: FTC HPA Infill
File:

Vanderslice 1005

BP America

Attn: Bryan Anderson

PO Box 3092

PO Box 3092

Houston, TX 77253-3092

PS FORM 3800



RECEIPT FOR CERTIFIED MAIL

NO INSURANCE COVERAGE PROVIDED
NOT FOR INTERNATIONAL MAIL
(SEE OTHER SIDE)