

NO. OF COPIES RECEIVED	5
DISTRIBUTION	
SANTA FE	1
FILE	1
U.S.G.S.	2
LAND OFFICE	
OPERATOR	1

NEW MEXICO OIL CONSERVATION COMMISSION

Form C-101
Revised 1-1-65

APPLICATION FOR PERMIT TO DRILL, DEEPEN, OR PLUG BACK

1a. Type of Work

b. Type of Well DRILL DEEPEN PLUG BACK
 OIL WELL GAS WELL OTHER **Water Injection** SINGLE ZONE MULTIPLE ZONE

2. Name of Operator
Worldwide Petroleum Corporation

3. Address of Operator *4150 E. McKinnley Ave - McKinley, Okla. 73222*
406 Mutual Savings Building, Fort Worth, Texas 76102

4. Location of Well UNIT LETTER **B** LOCATED **660** FEET FROM THE **North** LINE
AND **1980** FEET FROM THE **East** LINE OF SEC. **19** TWP. **18N** RGE. **10W** NMPM

19. Proposed Depth **500'** 19A. Formation **Manefee Sand** 20. Rotary or C.T. **Rotary**

21. Elevations (Show whether DF, RT, etc.) **6548' G.L.** 21A. Kind & Status Plug. Bond **\$10,000 blanket** 21B. Drilling Contractor **O. L. Ray Drilling Co.** 22. Approx. Date Work will start **Immediately**

5A. Indicate Type of Lease
STATE FEE

5. State Oil & Gas Lease No.

7. Unit Agreement Name

8. Farm or Lease Name
Santa Fe

9. Well No.
6-W

10. Field and Pool, or Wildcat
Seven Lakes Field

12. County
McKinley

PROPOSED CASING AND CEMENT PROGRAM

SIZE OF HOLE	SIZE OF CASING	WEIGHT PER FOOT	SETTING DEPTH	SACKS OF CEMENT	EST. TOP
5 1/8"	2 7/8"		500'	40	Surface



IN ABOVE SPACE DESCRIBE PROPOSED PROGRAM; IF PROPOSAL IS TO DEEPEN OR PLUG BACK, GIVE DATA ON PRESENT PRODUCTIVE ZONE AND PROPOSED NEW PRODUCTIVE ZONE. GIVE BLOWOUT PREVENTER PROGRAM, IF ANY.

I hereby certify that the information above is true and complete to the best of my knowledge and belief.

Signed Martha C. Withers Title Assistant Secretary Date January 19, 1965

(This space for State Use)

APPROVED BY Ernest C. Arnold TITLE _____ DATE 6-1-65

CONDITIONS OF APPROVAL, IF ANY:

NEW MEXICO OIL CONSERVATION COMMISSION
WELL LOCATION AND ACREAGE DEDICATION PLAT

SECTION A.

DATE January 19, 1965

OPERATOR Worldwide Petroleum Corporation LEASE Santa Fe
 WELL NO. 6 - W UNIT LETTER B SECTION 19 TOWNSHIP 18 North RANGE 10 West NMPM
 LOCATED 660 FEET FROM North LINE, 1980 FEET FROM East LINE
 COUNTY McKimley G. L. ELEVATION 6548 DEDICATED ACREAGE _____ ACRES
 NAME OF PRODUCING FORMATION _____ POOL _____

1. IS THE OPERATOR THE ONLY OWNER* IN THE DEDICATED ACREAGE OUTLINED ON THE PLAT BELOW? YES _____ NO _____
2. IF THE ANSWER TO QUESTION ONE IS "NO," HAVE THE INTERESTS OF ALL THE OWNERS BEEN CONSOLIDATED BY COMMUNITIZATION AGREEMENT OR OTHERWISE? YES _____ NO _____ IF ANSWER IS "YES," TYPE OF CONSOLIDATION _____

3. IF THE ANSWER TO QUESTION TWO IS "NO," LIST ALL THE OWNERS AND THEIR RESPECTIVE INTERESTS BELOW:

OWNER	LAND DESCRIPTION



SECTION B.

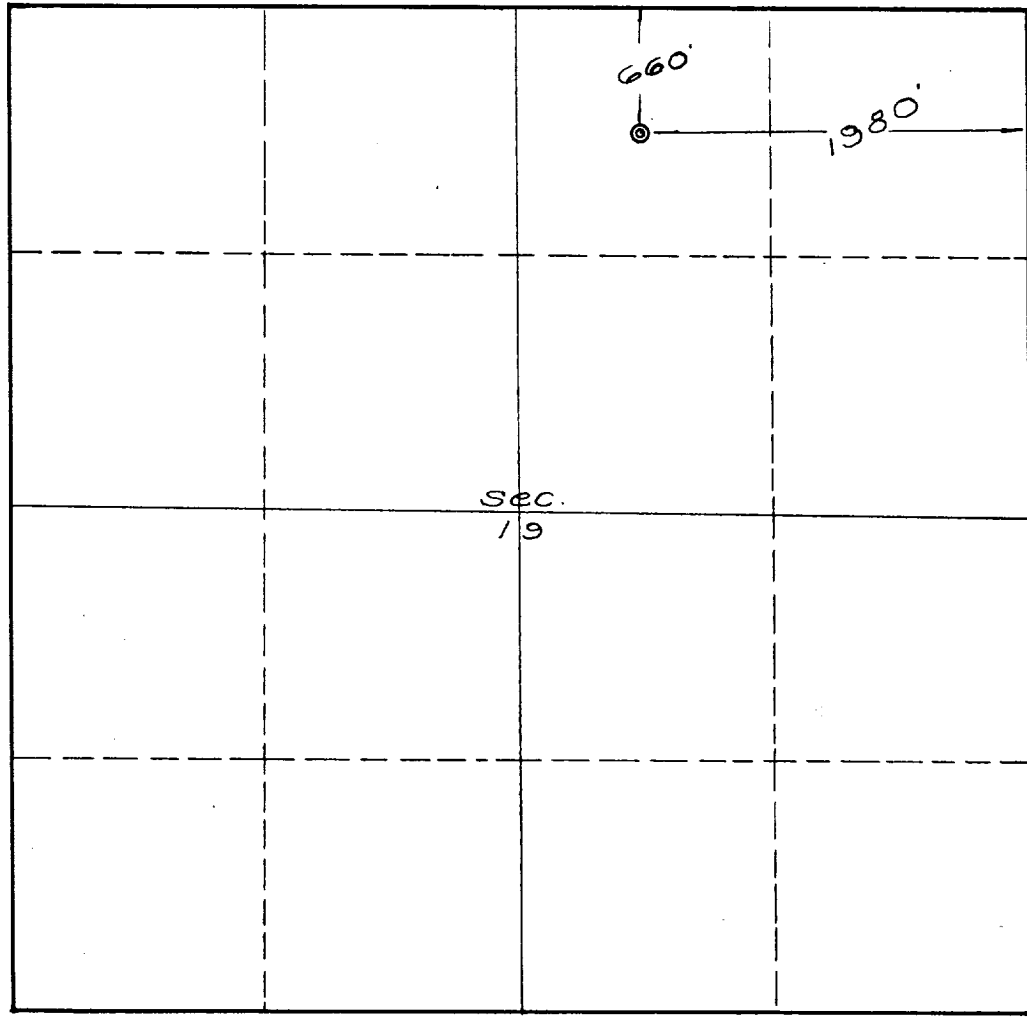

THIS IS TO CERTIFY THAT THE INFORMATION IN SECTION A ABOVE IS TRUE AND COMPLETE TO THE BEST OF MY KNOWLEDGE AND BELIEF.

WORLDWIDE PETROLEUM CORP.
 (OPERATOR)
Martha C. Withers
 (REPRESENTATIVE)
406 Mutual Savings Bldg.
Fort Worth, Texas 76102
 (ADDRESS)

THIS IS TO CERTIFY THAT THE WELL LOCATION SHOWN ON THE PLAT IN SECTION B WAS PLOTTED FROM FIELD NOTES OF ACTUAL SURVEYS MADE BY ME OR UNDER MY SUPERVISION AND THAT THE SAME IS TRUE AND CORRECT TO THE BEST OF MY KNOWLEDGE AND BELIEF.

DATE SURVEYED Jan. 2, 1965
FOUR STATES ENGINEERING CO.
 FARMINGTON, NEW MEXICO
Ernest J. Edwards
 REGISTERED ENGINEER OR LAND SURVEYOR

CERTIFICATE NO. 3602