

NO. OF COPIES RECEIVED	5
DISTRIBUTION	
SANTA FE	1
FILE	1
U.S.G.S.	2
LAND OFFICE	
OPERATOR	1

# NEW MEXICO OIL CONSERVATION COMMISSION

Form O-101  
Revised 11-65 30-033-20102

5A. Indicate Type of Lease  
STATE ☐ FEE ☒

5. State Oil & Gas Lease No.

---

## APPLICATION FOR PERMIT TO DRILL, DEEPEN, OR PLUG BACK

1a. Type of Work DRILL <input checked="" type="checkbox"/> DEEPEN <input type="checkbox"/> PLUG BACK <input type="checkbox"/>		7. Unit Agreement Name ---	
b. Type of Well OIL WELL <input checked="" type="checkbox"/> GAS WELL <input type="checkbox"/> OTHER <input type="checkbox"/>		8. Farm or Lease Name Santa Fe	
2. Name of Operator Tesoro Petroleum Corporation		9. Well No. 17	
3. Address of Operator 533 Busby Drive, San Antonio, Texas 78209		10. Field and Pool, or Wildcat Undesignated	
4. Location of Well UNIT LETTER F LOCATED 1950 FEET FROM THE North LINE AND 1950 FEET FROM THE West LINE OF SEC. 7 TWP. 17 N RGE. 8 W NMPM		12. County McKinley	
19. Proposed Depth 2,900'		19A. Formation Dakota	
20. Rotary or C.T. Rotary			
21. Elevations (Show whether DP, RT, etc.) 6,984 G.L.		21A. Kind & Status Plug. Bond Blanket	
21B. Drilling Contractor T.G. Whigham		22. Approx. Date Work will start Immediately	

23.

### PROPOSED CASING AND CEMENT PROGRAM

SIZE OF HOLE	SIZE OF CASING	WEIGHT PER FOOT	SETTING DEPTH	SACKS OF CEMENT	EST. TOP
12 - 1/4	8-5/8	24	120	100	Circulate
7 - 7/8	5-1/2	15-1/2	2,900	120	2,000

Propose to drill 12-1/4 hole to 120' and set 120' 8-5/8" surface casing. Cement with 100 sacks cement. Drill out from under surface with 7-7/8" hole to 2,900'. Will core any potentially productive zone in the Dakota series.

If productive, will run 5-1/2" casing to total depth and cement with 120 sacks. Will perforate for production.

Will use blowout preventers below 120'.

APPROVAL VALID  
FOR 90 DAYS UNLESS  
DRILLING COMMENCED,

EXPIRES July 29, 1969



IN ABOVE SPACE DESCRIBE PROPOSED PROGRAM: IF PROPOSAL IS TO DEEPEN OR PLUG BACK, GIVE DATA ON PRESENT PRODUCTIVE ZONE AND PROPOSED NEW PRODUCTIVE ZONE. GIVE BLOWOUT PREVENTER PROGRAM, IF ANY.

I hereby certify that the information above is true and complete to the best of my knowledge and belief.

Signed Harold Vaytough Title Vice President Date April 28, 1969

(This space for State Use)

APPROVED BY Emmy Clunif TITLE Sgt. Dist. III DATE 4-30-69

CONDITIONS OF APPROVAL, IF ANY:

**NEW MEXICO OIL CONSERVATION COMMISSION  
WELL LOCATION AND ACREAGE DEDICATION PLAT**

Form C-102  
Supersedes C-128  
Effective 1-1-65

All distances must be from the outer boundaries of the Section.

Operator <b>TESORO PETROLEUM CORPORATION</b>			Lease <b>Santa Fe Railroad</b>		Well No. <b>17</b>
Unit Letter <b>E</b>	Section <b>7</b>	Township <b>17 North</b>	Range <b>8 West</b>	County <b>McKinley</b>	
Actual Footage Location of Well: <b>1950</b> feet from the <b>North</b> line and <b>1950</b> feet from the <b>West</b> line					
Ground Level Elev. <b>6984</b>	Producing Formation <b>Dakota</b>		Pool <b>Undesignated Dakota</b>		Dedicated Acreage: <b>40</b> Acres

1. Outline the acreage dedicated to the subject well by colored pencil or hachure marks on the plat below.
2. If more than one lease is dedicated to the well, outline each and identify the ownership thereof (both as to working interest and royalty).
3. If more than one lease of different ownership is dedicated to the well, have the interests of all owners been consolidated by communitization, unitization, force-pooling, etc?

☐ Yes   ☐ No   If answer is "yes," type of consolidation \_\_\_\_\_

If answer is "no," list the owners and tract descriptions which have actually been consolidated. (Use reverse side of this form if necessary.) \_\_\_\_\_

No allowable will be assigned to the well until all interests have been consolidated (by communitization, unitization, forced-pooling, or otherwise) or until a non-standard unit, eliminating such interests, has been approved by the Commission.

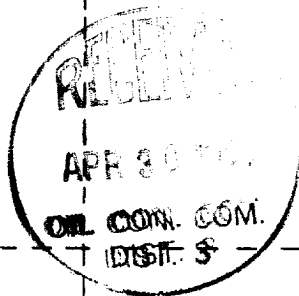
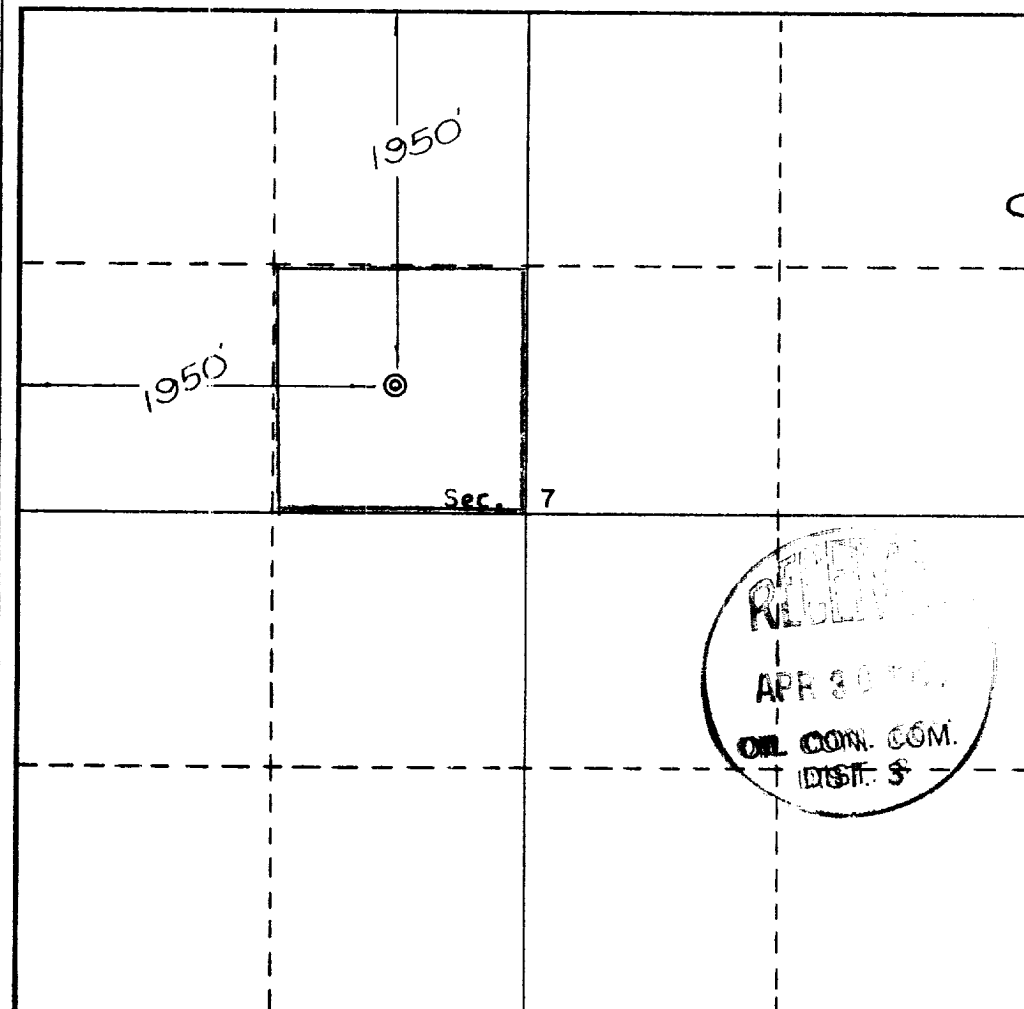

**CERTIFICATION**

I hereby certify that the information contained herein is true and complete to the best of my knowledge and belief.

*Harold Vagtborg, Jr.*  
Name

Harold Vagtborg, Jr.

Position

Vice President

Company

Tesoro Petroleum Corporation

Date

April 28, 1969

*[Signature]*  
I hereby certify that the well location shown on this plat was plotted from field notes of actual surveys made by me or under my supervision, and that the same is true and correct to the best of my knowledge and belief.

Date Surveyed

April 8, 1969

Registered Professional Engineer  
and/or Land Surveyor

*[Signature]*

Certificate No. 3602

