

NO. OF COPIES RECEIVED	5
DISTRIBUTION	
SANTA FE	1
FILE	1
U.S.G.S.	2
LAND OFFICE	
OPERATOR	1

NEW MEXICO OIL CONSERVATION COMMISSION

Form C-101  
Revised 1-1-65 30-031-20133

5A. Indicate Type of Lease	
STATE <input type="checkbox"/>	FEE <input checked="" type="checkbox"/>

5. State Oil & Gas Lease No.

APPLICATION FOR PERMIT TO DRILL, DEEPEN, OR PLUG BACK

1a. Type of Work		7. Unit Agreement Name	
b. Type of Well OIL WELL <input checked="" type="checkbox"/> GAS WELL <input type="checkbox"/> OTHER <input type="checkbox"/>		8. Farm or Lease Name Santa Fe R.R. "A"	
2. Name of Operator Tesoro Petroleum Corporation		9. Well No. 80	
3. Address of Operator 8520 Crownhill Boulevard, San Antonio, Texas 78209		10. Field and Pool, or Wildcat South Hospah-Lower Sand	
4. Location of Well UNIT LETTER P LOCATED 1350 FEET FROM THE East LINE AND 660 FEET FROM THE South LINE OF SEC. 1 TWP. 17N RGE. 9W NMPM		12. County McKinley	
19. Proposed Depth 1650'		19A. Formation Lower Hospah	
20. Rotary or C.T. Rotary		21. Elevations (Show whether DF, RT, etc.) See C-102	
21A. Kind & Status Plug. Bond Blanket		21B. Drilling Contractor Young Drilling Co.	
22. Approx. Date Work will start December 9, 1969			

PROPOSED CASING AND CEMENT PROGRAM

SIZE OF HOLE	SIZE OF CASING	WEIGHT PER FOOT	SETTING DEPTH	SACKS OF CEMENT	EST. TOP
12-3/4"	8-5/8"	24#	60'	40 sx +2%CaCl	Circulate
7-7/8"	5-1/2"	14.0#	1650'	60 sx +2%CaCl	700'

Propose to drill to Lower Hospah, set casing in top of sand, and drill in using power swivel and oil for open hole completion.

APPROVAL VALID  
FOR 90 DAYS UNLESS  
DRILLING COMMENCED,  
EXPIRES March 11, 1970



IN ABOVE SPACE DESCRIBE PROPOSED PROGRAM: IF PROPOSAL IS TO DEEPEN OR PLUG BACK, GIVE DATA ON PRESENT PRODUCTIVE ZONE AND PROPOSED NEW PRODUCTIVE ZONE. GIVE BLOWOUT PREVENTER PROGRAM, IF ANY.

I hereby certify that the information above is true and complete to the best of my knowledge and belief.

Signed R. H. Newman Title Petroleum Engineer Date December 5, 1969

(This space for State Use)

APPROVED BY \_\_\_\_\_ TITLE \_\_\_\_\_ DATE \_\_\_\_\_

CONDITIONS OF APPROVAL, IF ANY:

**NEW MEXICO OIL CONSERVATION COMMISSION  
WELL LOCATION AND ACREAGE DEDICATION PLAT**

Form C-102  
Supersedes C-128  
Effective 1-1-65

All distances must be from the outer boundaries of the Section.

Operator <b>TESORO PETROLEUM CORPORATION</b>			Lease <b>Santa Fe Railroad</b> <i>A</i>		Well No. <b>80</b>
Unit Letter <b>P</b>	Section <b>I</b>	Township <b>17 North</b>	Range <b>9 West</b>	County <b>McKinley</b>	
Actual Footage Location of Well: <b>660</b> feet from the <b>South</b> line and <b>1300</b> feet from the <b>East</b> line					
Ground Level Elev. <b>6992</b>	Producing Formation <b>Hospah</b>		Pool <b>Lower Sand</b>		Dedicated Acreage: <i>100</i> <b>Joint</b> Acres

1. Outline the acreage dedicated to the subject well by colored pencil or hachure marks on the plat below.
2. If more than one lease is dedicated to the well, outline each and identify the ownership thereof (both as to working interest and royalty).
3. If more than one lease of different ownership is dedicated to the well, have the interests of all owners been consolidated by communitization, unitization, force-pooling, etc?

☐ Yes ☐ No If answer is "yes," type of consolidation \_\_\_\_\_

If answer is "no," list the owners and tract descriptions which have actually been consolidated. (Use reverse side of this form if necessary.) \_\_\_\_\_

No allowable will be assigned to the well until all interests have been consolidated (by communitization, unitization, forced-pooling, or otherwise) or until a non-standard unit, eliminating such interests, has been approved by the Commission.

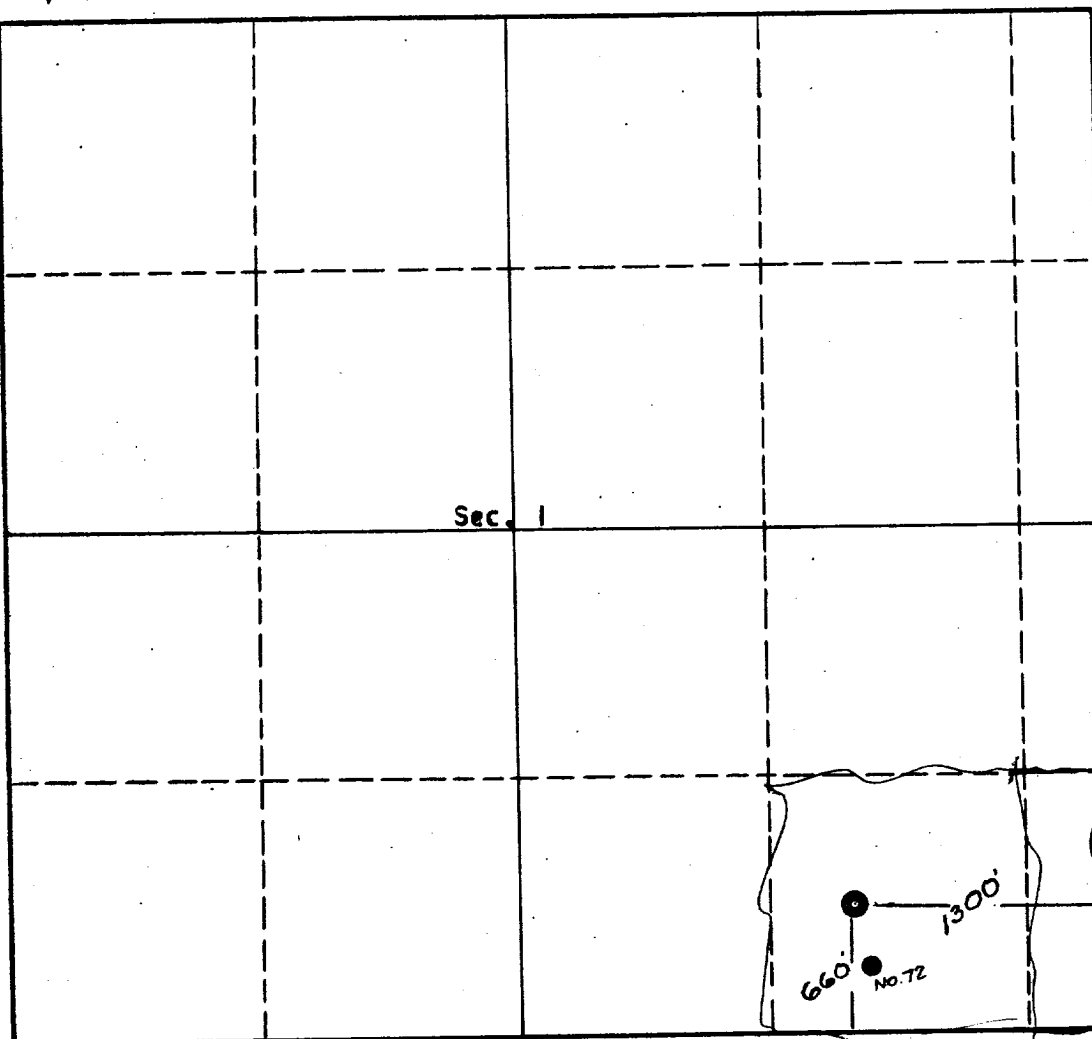
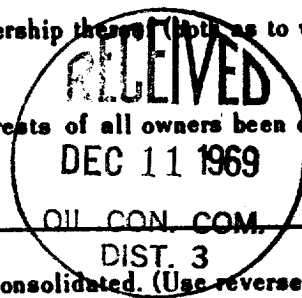

**CERTIFICATION**

I hereby certify that the information contained herein is true and complete to the best of my knowledge and belief.

**R. H. DENMAN**  
Name  
**R. H. Denman**  
Position  
**PETROLEUM ENGINEER**  
Company  
**TESORO PETROLEUM CORP.**  
Date  
**Dec. 10, 1969**

I hereby certify that the well location shown on this plat was plotted from field notes of actual surveys made by me or under my supervision, and that the same is true and correct to the best of my knowledge and belief.

Date Surveyed  
**December 5, 1969**  
Registered Professional Engineer and/or Land Surveyor

**E. J. [Signature]**  
Certificate No.  
**3602**