

NO. OF COPIES RECEIVED	5
DISTRIBUTION	
SANTA FE	1
FILE	1
U.S.G.S.	2
LAND OFFICE	
OPERATOR	1

NEW MEXICO OIL CONSERVATION COMMISSION

Form C-101
Revised 1-1-65 *30-031-20206*

5A. Indicate Type of Lease	
STATE <input type="checkbox"/>	FEE <input checked="" type="checkbox"/>
5. State Oil & Gas Lease No.	

APPLICATION FOR PERMIT TO DRILL, DEEPEN, OR PLUG BACK

1a. Type of Work DRILL <input checked="" type="checkbox"/> DEEPEN <input type="checkbox"/> PLUG BACK <input type="checkbox"/>		7. Unit Agreement Name
b. Type of Well OIL WELL <input checked="" type="checkbox"/> GAS WELL <input type="checkbox"/> OTHER <input type="checkbox"/> SINGLE ZONE <input checked="" type="checkbox"/> MULTIPLE ZONE <input type="checkbox"/>		8. Farm or Lease Name Santa Fe Railroad
2. Name of Operator Tesoro Petroleum Corporation		9. Well No. 28
3. Address of Operator 8520 Crownhill Boulevard, San Antonio, Texas 78209		10. Field and Pool, or Wildcat Lone Pine - Dakota "D"
4. Location of Well UNIT LETTER <u>H</u> LOCATED <u>2160</u> FEET FROM THE <u>North</u> LINE AND <u>380</u> FEET FROM THE <u>East</u> LINE OF SEC. <u>7</u> TWP. <u>17N</u> RGE. <u>8W</u> NMPM		12. County McKinley
19. Proposed Depth 3000'		19A. Formation Dakota
20. Rotary or C.T. Rotary		
21. Elevations (Show whether DF, RT, etc.) 6955' GR	21A. Kind & Status Plug. Bond Blanket	21B. Drilling Contractor Aztec Well Servicing Co.
22. Approx. Date Work will start March 20, 1971		

PROPOSED CASING AND CEMENT PROGRAM

SIZE OF HOLE	SIZE OF CASING	WEIGHT PER FOOT	SETTING DEPTH	SACKS OF CEMENT	EST. TOP
12-1/4"	8-5/8"	28#	130' KB	100 sx	Surface
7-7/8"	5-1/2"	15.5#	3000' KB	100 sx	2200'

Propose to drill to an approximate total depth of 3000'. 8-5/8" surface pipe is to be set at -130' KB and 5-1/2" production casing is to be set and cemented at total depth. Proposed completion is to be in the Dakota with interval for perforating to be selected upon evaluation of an I.E.S. Log.

APPROVAL VALID
FOR 90 DAYS UNLESS
DRILLING COMMENCED,
EXPIRES June 15, 1971



IN ABOVE SPACE DESCRIBE PROPOSED PROGRAM: IF PROPOSAL IS TO DEEPEN OR PLUG BACK, GIVE DATA ON PRESENT PRODUCTION ZONE AND PROPOSED NEW PRODUCTION ZONE. GIVE BLOWOUT PREVENTER PROGRAM, IF ANY.

I hereby certify that the information above is true and complete to the best of my knowledge and belief.

Signed *R. H. Newman* Title Mgr. of Production Engineering Date March 12, 1971

(This space for State Use)

APPROVED BY *Ernest C. Arnold* TITLE SUPERVISOR DIST. 3 DATE MAR 17 1971
CONDITIONS OF APPROVAL, IF ANY:

**NEW MEXICO OIL CONSERVATION COMMISSION
WELL LOCATION AND ACREAGE DEDICATION PLAT**

Form C-102
Supersedes C-128
Effective 1-1-65

All distances must be from the outer boundaries of the Section.

Operator TESORO PETROLEUM CORPORATION			Lease Santa Fe Railroad		Well No. 28
Unit Letter H	Section 7	Township 17 North	Range 8 West	County McKinley	
Actual Footage Location of Well: 2160 feet from the North line and 380 feet from the East line					
Ground Level Elev. 6955	Producing Formation Dakota	Pool Lone Pine - Dakota "D"		Dedicated Acreage: 80 Acres	

1. Outline the acreage dedicated to the subject well by colored pencil or hachure marks on the plat below.
2. If more than one lease is dedicated to the well, outline each and identify the ownership thereof (both as to working interest and royalty).
3. If more than one lease of different ownership is dedicated to the well, have the interests of all owners been consolidated by communitization, unitization, force-pooling, etc?

☐ Yes ☐ No If answer is "yes," type of consolidation _____

If answer is "no," list the owners and tract descriptions which have actually been consolidated. (Use reverse side of this form if necessary.) _____

No allowable will be assigned to the well until all interests have been consolidated (by communitization, unitization, forced-pooling, or otherwise) or until a non-standard unit, eliminating such interests, has been approved by the Commission.

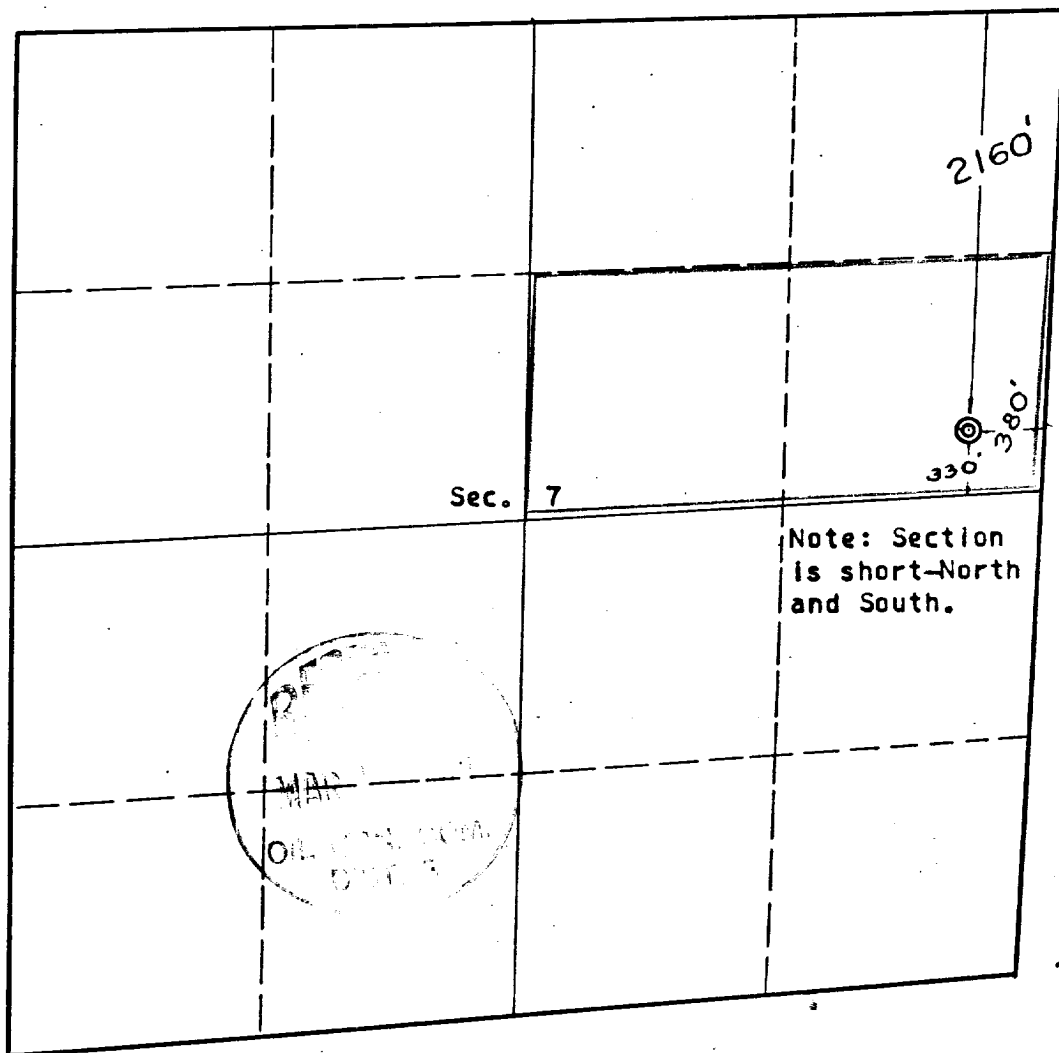

CERTIFICATION

I hereby certify that the information contained herein is true and complete to the best of my knowledge and belief.

R. H. Denman

Name

R. H. Denman

Position

Mgr. of Prod. Engineering

Company

TESORO PETROLEUM CORPORATION

Date

March 12, 1971

STATE OF NEW MEXICO
I hereby certify that the well location shown on this plat is from field notes of actual surveys made by me or under my supervision, and that the same are true and correct to the best of my knowledge and belief.

Date Surveyed

March 8, 1971

Registered Professional Engineer and/or Land Surveyor

E. V. Echot Hawk

Certificate No. 3602

E. V. Echot Hawk LS