

NO. OF COPIES RECEIVED	5
DISTRIBUTION	
SANTA FE	1
FILE	1
U.S.G.S.	2
LAND OFFICE	
OPERATOR	1

NEW MEXICO OIL CONSERVATION COMMISSION



30-031-20286
Form C-101
Revised 1-1-65

5A. Indicate Type of Lease
STATE ☐ FEE ☒
5. State Oil & Gas Lease No.
N/A

APPLICATION FOR PERMIT TO DRILL, DEEPEN, OR PLUG BACK

1a. Type of Work b. Type of Well OIL WELL <input checked="" type="checkbox"/> GAS WELL <input type="checkbox"/> OTHER <input type="checkbox"/> DEEPEN <input type="checkbox"/> PLUG BACK <input type="checkbox"/> SINGLE ZONE <input type="checkbox"/> MULTIPLE ZONE <input type="checkbox"/>		7. Unit Agreement Name N/A 8. Farm or Lease Name San Fe Railroad 9. Well No. 31 10. Field and Pool, or Wildcat Wildcat 12. County McKinley
2. Name of Operator Tesoro Petroleum Corporation 3. Address of Operator 8520 Crownhill San Antonio, Texas 78209 4. Location of Well UNIT LETTER C LOCATED 330 FEET FROM THE South LINE AND 2310 FEET FROM THE East LINE OF SEC. 31 TWP. 18 N RGE. 8 W NMPM		
21. Elevations (Show whether DJ, RL, etc.) 7079' GR 21A. Kind & Status Plug, Bond Blanket 21B. Drilling Contractor Young Drilling Company		19. Proposed Depth 3000' 19A. Formation Morrison/Dakota 20. Rotary or C.T. Rotary 22. Approx. Date Work will start 11-3-72

23. PROPOSED CASING AND CEMENT PROGRAM					
SIZE OF HOLE	SIZE OF CASING	WEIGHT PER FOOT	SETTING DEPTH	SACKS OF CEMENT	EST. TOP
12-1/4"	8-5/8"	24#	130' KB	100 SX	Surface
7-7/8"	5-1/2"	14# 15.5#	3000' KB	350 SX	2000'

Propose to drill a Dakota test at the above location. Estimated objective depth 3000'. If evaluation by coring and testing warrant completion attempt, 5-1/2" casing will be set through the sand and perforated.

APPROVAL VALID
FOR 90 DAYS UNLESS
DRILLING COMMENCED,

EXPIRES 2-1-73



IN ABOVE SPACE DESCRIBE PROPOSED PROGRAM: IF PROPOSAL IS TO DEEPEN OR PLUG BACK, GIVE DATA ON PRESENT PRODUCTIVE ZONE AND PROPOSED NEW PRODUCTIVE ZONE, GIVE BLOWOUT PREVENTER PROGRAM, IF ANY.

I hereby certify that the information above is true and complete to the best of my knowledge and belief.

Signed A. H. Kinnaman Title Manager of Production Engineering Date October 30, 1972

(This space for State Use)

APPROVED BY Ernest Chavez TITLE SUPERVISOR DIST. #3 DATE NOV 1 1972
CONDITIONS OF APPROVAL, IF ANY:

**NEW MEXICO OIL CONSERVATION COMMISSION
WELL LOCATION AND ACERAGE DEDICATION PLAT**

All distances must be from the corner boundaries of the Section

Operator TESORO PETROLEUM CORPORATION			Lease Santa Fe Railroad		Well No. 31
Unit Letter 0	Section 31	Township 18 North	Range 8 West	County McKinley	
Actual Footage Location of Well: 330 feet from the South line and 2310 feet from the East line					
Ground Level Elev. 7079	Producing Formation Dakota	Pool Wildcat	Dedicated Average: 40 Acres		

1. Outline the acreage dedicated to the subject well by colored pencil or hatchure marks on the plat below.
2. If more than one lease is dedicated to the well, outline each and identify the ownership thereof (both as to working interest and royalty),
3. If more than one lease of different ownership is dedicated to the well, have the interests of all owners been consolidated by communitization, unitization, force-pooling, etc?

() Yes (X) No If answer is "yes," type of consolidation

If answer is "no," list the owners and tract descriptions which have actually consolidated (Use reverse side of this form if necessary.) Single Ownership

No allowable will be assigned to the well until all interests have been consolidated (by communitization, unitization, force-pooling, or otherwise) or until a non standard unit, eliminating such interests, has been approved by the Commission.

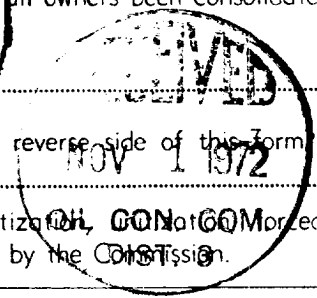

CERTIFICATION

I hereby certify that the information contained herein is true and complete to the best of my knowledge and belief.

R. H. Denman
 Name **R. H. Denman**
 Manager of Production Engineering
 Position
Tesoro Petroleum Corporation
 Company
October 30, 1972
 Date

I hereby certify that the well location shown on this plat was plotted from field notes of actual survey made by E. V. Echohawk under my supervision, and that the same is true and correct to the best of my knowledge and belief.

October 25, 1972
 Date Surveyed
 Registered Professional Engineer
 and/or Land Surveyor

E. V. Echohawk
 Certificate No. **3602**
E. V. Echohawk LS

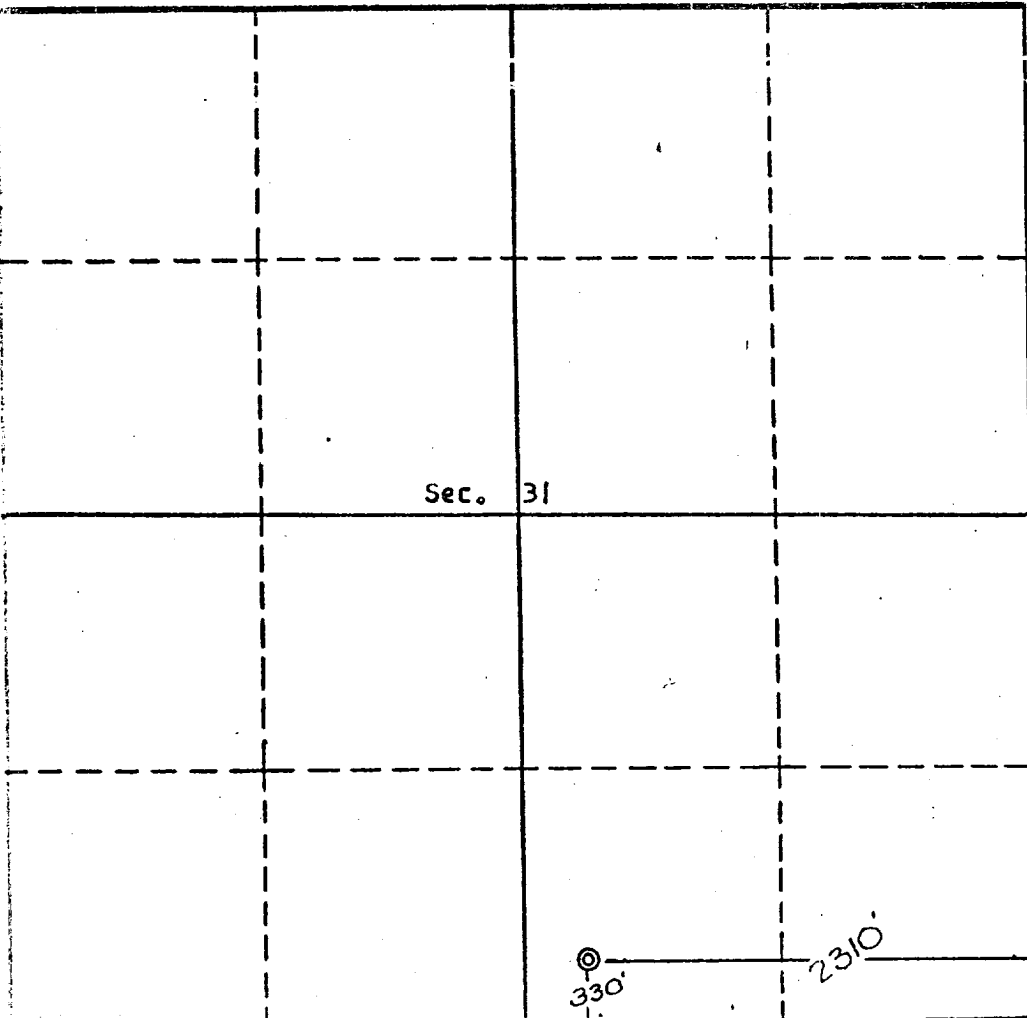

Scale, 1 inch = 1,000 feet