

NO. OF COPIES RECEIVED	5
DISTRIBUTION	
SANTA FE	1
FILE	1 ✓
U.S.G.S.	2
LAND OFFICE	
OPERATOR	1

# NEW MEXICO OIL CONSERVATION COMMISSION

30-031-20296

Form O-191  
Revised 1-4-65

5A. Indicate Type of Lease	
STATE <input type="checkbox"/>	FILE <input checked="" type="checkbox"/>
6. State Oil & Gas Lease No.	

## APPLICATION FOR PERMIT TO DRILL, DEEPEN, OR PLUG BACK

1a. Type of Work		7. Unit Agreement Name	
b. Type of Well OIL WELL <input checked="" type="checkbox"/> GAS WELL <input type="checkbox"/> OTHER <input type="checkbox"/>		8. Term or Lease Name Santa Fe Monback	
2. Name of Operator CHACO OIL COMPANY		9. Well No. 2	
3. Address of Operator c/o P. O. Box 537, Farmington, New Mexico 87401		10. Field and Pool, or Wildcat undesignated Menefee	
4. Location of Well UNIT LETTER J LOCATED 1650 FEET FROM THE South LINE AND 1650 FEET FROM THE East LINE OF SEC. 29 TWP. 20N RGE. 9W NMPM		12. County McKinley	
19. Proposed Depth 600'		19A. Formation Menefee	
20. Rotary or C.T. Rotary		21. Elevations (Show whether DF, RT, etc.) 6629	
21A. Kind & Status Plug. Bond on file		21B. Drilling Contractor Stewart Bros.	
22. Approx. Date Work will start March 20, 1973			

23.

### PROPOSED CASING AND CEMENT PROGRAM

SIZE OF HOLE	SIZE OF CASING	WEIGHT PER FOOT	SETTING DEPTH	SACKS OF CEMENT	EST. TOP
6 3/4 "	4 1/2 "	9#	600	50	surface

We propose to drill this well to 600' to test a closed untested surface structure in this section.

APPROVAL VALID  
FOR 90 DAYS UNLESS  
DRILLING COMMENCED,

EXPIRES 6-13-73



IN ABOVE SPACE DESCRIBE PROPOSED PROGRAM: IF PROPOSAL IS TO DEEPEN OR PLUG BACK, GIVE DATA ON PRESENT PRODUCTIVE ZONE AND PROPOSED NEW PRODUCTIVE ZONE. GIVE BLOWOUT PREVENTER PROGRAM, IF ANY.

I hereby certify that the information above is true and complete to the best of my knowledge and belief.

Signed Bruce A. Black Title President, Colorado Plateau Geological Soc., agent for Chaco Oil Co. Date 3/9/73

APPROVED BY Emmy Church TITLE SUPERVISOR DIST. #3 DATE MAR 15 1973

CONDITIONS OF APPROVAL, IF ANY:

N MEXICO OIL CONSERVATION COMMISSION  
WELL LOCATION AND ACREAGE DEDICATION PLAT

Form No. 1  
Supersedes O-128  
Effective 1-1-65

All distances must be from the outer boundaries of the Section

Operator <b>Chaco Oil Company</b>			Lease <b>Santa Fe Monback</b>		Well No. <b>2</b>
Unit Letter <b>J</b>	Section <b>29</b>	Township <b>20N</b>	Range <b>9W</b>	County <b>McKinley</b>	
Actual Footage Location of Well					
<b>1650</b>	feet from the	<b>South</b>	line and	<b>1650</b>	feet from the
					<b>East</b>
Ground Level Elev. <b>6629</b>	Producing Formation <b>Menefee</b>		Pool <b>undesignated</b>		Dedicated Acreage <b>40</b>

1. Outline the acreage dedicated to the subject well by colored pencil or hatchure marks on the plat below.
2. If more than one lease is dedicated to the well, outline each and identify the ownership thereof (both as to working interest and royalty).
3. If more than one lease of different ownership is dedicated to the well, have the interests of all leases consolidated by communitization, unitization, force-pooling, etc?

☐ Yes ☐ No If answer is "yes," type of consolidation \_\_\_\_\_

If answer is "no," list the owners and tract descriptions which have actually been consolidated (by communitization, unitization, force-pooling, or otherwise) or until a non-standard unit, eliminating such interests, has been approved by the Commission.

No allowable will be assigned to the well until all interests have been consolidated (by communitization, unitization, forced-pooling, or otherwise) or until a non-standard unit, eliminating such interests, has been approved by the Commission.

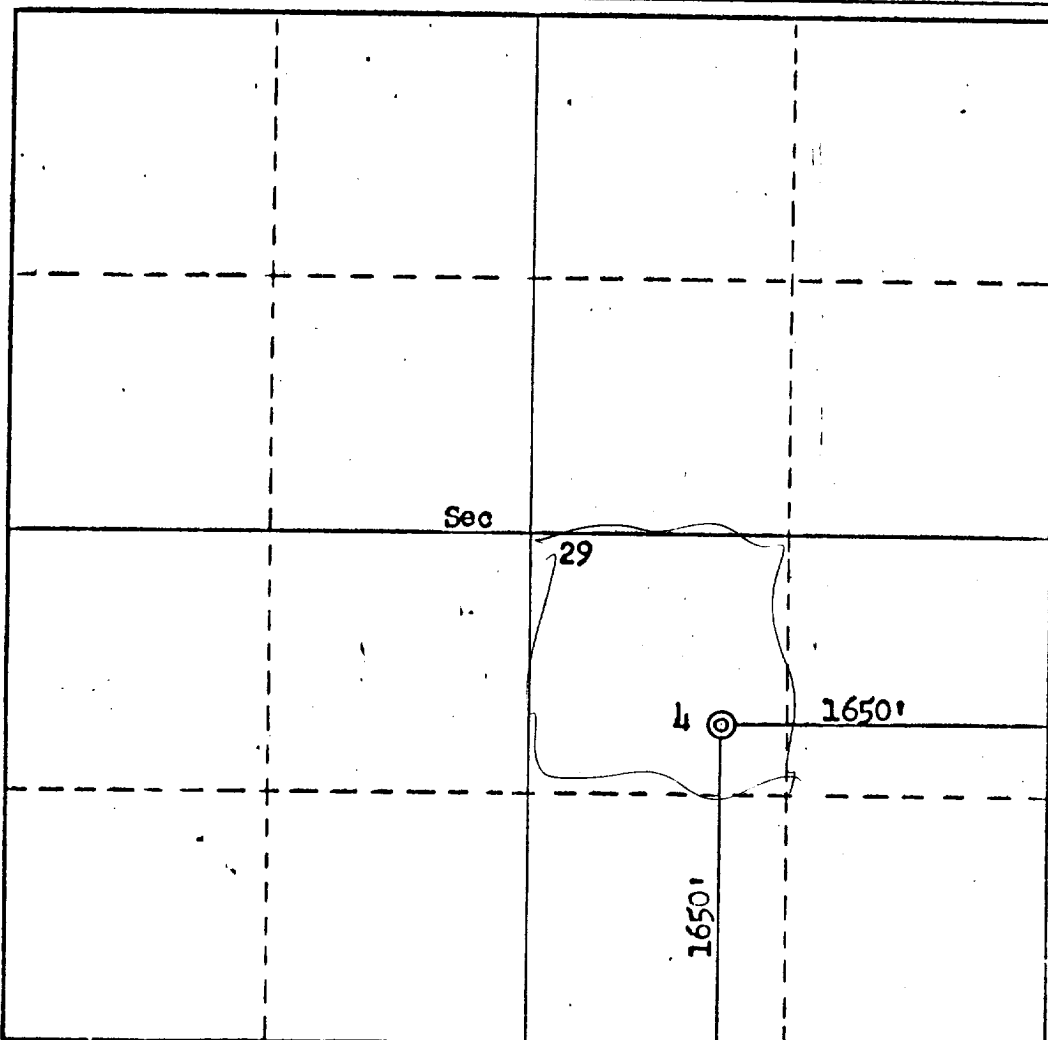

**CERTIFICATION**

I hereby certify that the information contained herein is true and complete to the best of my knowledge and belief.

*Bruce A. Black*

Name

**Bruce A. Black**

Position

**Agent**

Company

**Chaco Oil Company**

Date

**March 7, 1973**

I hereby certify that the well location shown on this plat was plotted from field notes of actual surveys made by me or under my supervision, and that the same is true and correct to the best of my knowledge and belief.

Date Surveyed

**March 7, 1973**

Surveyed by (for Section Platting)  
and Certified by Surveyor

*Fred B. Kerr Jr.*  
**Fred B. Kerr Jr.**

Certificate No.

**3950**

