

NO. 8	DATE RECEIVED
DISTRIBUTION	
SANTA FE	
FILE	
U.S.G.S.	
LAND OFFICE	
OPERATOR	

5A. Indicate Type of Lease STATE <input type="checkbox"/> REC <input checked="" type="checkbox"/>
5. Lease Oil & Gas Lease No. 09725
7. Unit Agreement Name Miguel Creek
8. Form or Lease Name SFPRR
9. Well No. #49
10. Field and Pool, or Wildcat Miguel Creek-Gallup
12. County McKinley

APPLICATION FOR PERMIT TO DRILL, DEEPEN, OR PLUG BACK

1a. Type of Work
DRILL ☒ DEEPEN ☐ PLUG BACK ☐

b. Type of Well
OIL WELL ☒ GAS WELL ☐ OTHER ☐ SINGLE ZONE ☐ MULTIPLE ZONE ☐

2. Name of Operator
Capital Oil & Gas Corporation

3. Address of Operator
P. O. Box 1038, Kilgore, Texas 75662

4. Location of Well
UNIT LETTER L LOCATED 1650' FEET FROM THE South LINE
AND 990' FEET FROM THE West LINE OF SEC. 21 TWP. 16N RGE. 6W NADP

19. Proposed Depth
850'

19A. Formation
Hospah

19B. History or C.T.
RT

21. Elevations (Show whether DF, RI, etc.)
6409'

21A. Kind & Status Plug. Bond
50,000 Blanket

21B. Drilling Contractor
Salazar

22. Approx. Date Work will start
6-27-81

23. PROPOSED CASING AND CEMENT PROGRAM

SIZE OF HOLE	SIZE OF CASING	WEIGHT PER FOOT	SETTING DEPTH	SACKS OF CEMENT	EST. TOP
7 7/8"	4 1/2"	9.5#	850'	150sx	Surf.

APPROVAL VALID
FOR 90 DAYS UNLESS
DRILLING COMMENCED,

EXPIRES 12-26-81



IN ABOVE SPACE DESCRIBE PROPOSED PROGRAM: IF PROPOSAL IS TO DEEPEN OR PLUG BACK, GIVE DATA ON PRESENT PRODUCTIVE ZONE AND PROPOSED NEW PRODUCTIVE ZONE. GIVE BLOWOUT PREVENTER PROGRAM, IF ANY.

I hereby certify that the information above is true and complete to the best of my knowledge and belief.

Signed Dary Blank Title Representative Date 6/22/81

APPROVED BY Frank J. Day TITLE SUPERVISOR DISTRICT # 3 DATE JUN 26 1981

CONDITIONS OF APPROVAL, IF ANY:

**NEW MEXICO OIL CONSERVATION COMMISSION
WELL LOCATION AND ACREAGE DEDICATION PLAT**

Form C-102
Supersedes C-128
Effective 1-1-65

All distances must be from the outer boundaries of the Section.

Operator Capital Oil & Gas Corporation			Lease 09725		Well No. 49
Unit Letter L	Section 21	Township 16N	Range 6W	County McKinley	
Actual Footage Location of Well: <div style="display: flex; justify-content: space-between;"> 1650 feet from the South line and 990 feet from the West line </div>					
Ground Level Elev: 6409	Producing Formation: Hospah-Gallup	Pool Miguel Creek		Dedicated Acreage: 10 40 Acres	

1. Outline the acreage dedicated to the subject well by colored pencil or hatchure marks on the plat below.
2. If more than one lease is dedicated to the well, outline each and identify the ownership thereof (both as to working interest and royalty).
3. If more than one lease of different ownership is dedicated to the well, have the interests of all owners been consolidated by communitization, unitization, force-pooling, etc?

☐ Yes ☐ No If answer is "yes," type of consolidation _____

If answer is "no," list the owners and tract descriptions which have actually been consolidated. (Use reverse side of this form if necessary.) _____

No allowable will be assigned to the well until all interests have been consolidated (by communitization, unitization, forced-pooling, or otherwise) or until a non-standard unit, eliminating such interests, has been approved by the Commission.

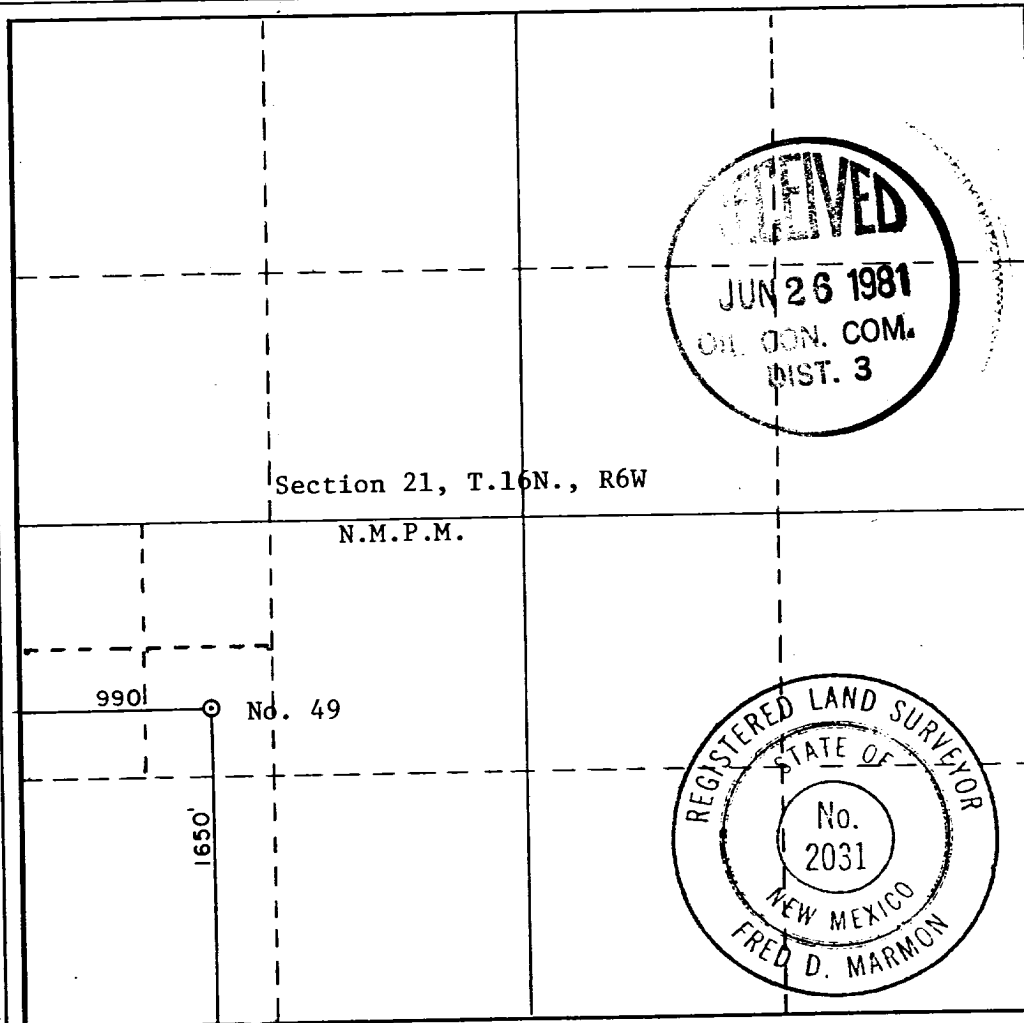

CERTIFICATION

I hereby certify that the information contained herein is true and complete to the best of my knowledge and belief.

Name *Darryl Blanks*
Position *Rup*
Company *Capital*
Date *6-22-81*

I hereby certify that the well location shown on this plat was plotted from field notes of actual surveys made by me or under my supervision, and that the same is true and correct to the best of my knowledge and belief.

Date Surveyed
June 17, 1981
Registered Professional Engineer
and/or Land Surveyor

F.D. Marmion
Certificate No.

2031