

30-031-20759

NO. OF COPIES RECEIVED		
DISTRIBUTION		
SANTA FE		
FILE		
U.S.G.S.		
LAND OFFICE		
OPERATOR		

NEW MEXICO OIL CONSERVATION COMMISSION

Form C-101
Revised 1-1-65

5A. Indicate Type of Lease	
STATE <input type="checkbox"/>	FEE <input checked="" type="checkbox"/>
5. State Oil & Gas Lease No.	

APPLICATION FOR PERMIT TO DRILL, DEEPEN, OR PLUG BACK

1a. Type of Work b. Type of Well OIL WELL <input checked="" type="checkbox"/> GAS WELL <input type="checkbox"/> OTHER <input type="checkbox"/> DRILL <input checked="" type="checkbox"/> DEEPEN <input type="checkbox"/> PLUG BACK <input type="checkbox"/> SINGLE ZONE <input type="checkbox"/> MULTIPLE ZONE <input type="checkbox"/>			7. Unit Agreement Name
2. Name of Operator Santa Fe Energy Company			8. Farm or Lease Name Fajada West
3. Address of Operator 7200 I-40 West, Amarillo, TX 79106			9. Well No. 1
4. Location of Well UNIT LETTER <u>H</u> LOCATED <u>1980</u> FEET FROM THE <u>north</u> LINE AND <u>660</u> FEET FROM THE <u>east</u> LINE OF SEC. <u>14</u> TWP. <u>20-N</u> RGE. <u>11-W</u> NMPM			10. Field and Pool, or Wildcat Wildcat <u>Entrada</u> <u>40</u>
			12. County McKinley
19. Proposed Depth 5100'			19A. Formation Entra
20. Rotary or C.T. Rotary			
21. Elevations (Show whether DF, RT, etc.) 6402' GL	21A. Kind & Status Plug. Bond Blanket/Current	21B. Drilling Contractor Four Corners Drilling Co.	22. Approx. Date Work will start December 10, 1981

23. PROPOSED CASING AND CEMENT PROGRAM

SIZE OF HOLE	SIZE OF CASING	WEIGHT PER FOOT	SETTING DEPTH	SACKS OF CEMENT	EST. TOP
12 1/4	8 5/8	24 lb.	200'	150	Circulate
7 7/8	5 1/2	15.5 lb.	3400'	200	2000'

Cover 7/8" mud

1. Drill a 12 1/4" hole to 200' and run 8 5/8" casing. Cement circulating cement to the surface. WOC 10-12 hours. Nipple up BOPs and test to their full working pressure.
2. Drill a 7 7/8" hole to TD with sufficient mud weight to control formation pressures.
3. Run open hole logs.
4. Depending on log evaluation either run and cement 5 1/2" production casing or plug and abandon hole as directed by the New Mexico Oil Conservation Commission.

APPROVAL VALID
FOR 90 DAYS UNLESS
DRILLING COMMENCED

IN ABOVE SPACE DESCRIBE PROPOSED PROGRAM: IF PROPOSAL IS TO DEEPEN OR PLUG BACK, GIVE DATA ON PRESENT PRODUCTIVE ZONE AND PROPOSED NEW PRODUCTIVE ZONE. GIVE BLOWOUT PREVENTER PROGRAM, IF ANY.

I hereby certify that the information above is true and complete to the best of my knowledge and belief.

Signed *Sammy H. Morgan* Title Drilling Engineer Date November 17, 1981

(This space for State Use)

APPROVED BY *3rd Lt. [Signature]* TITLE SUPERVISOR DISTRICT #3 DATE NOV 23 1981

CONDITIONS OF APPROVAL, IF ANY:

OIL CONSERVATION DIVISION

STATE OF NEW MEXICO
OIL AND MINERALS DEPARTMENT

P. O. BOX 2088

SANTA FE, NEW MEXICO 87501

Form C-107
Revised 10-1-78

All distances must be from the outer boundaries of the Section.

Operator Santa Fe Energy Company		Lease Fajada West		Well No. 1	
Section Letter H	Section 14	Township 20N	Range 11W	County McKinley	
Actual Footage Location of Well: 1980 feet from the North line and 660 feet from the East line					
Ground Level Elev. 6402.4'	Producing Formation Entrada		Pool WC	Dedicated Acreage: 40 Acres	

1. Outline the acreage dedicated to the subject well by colored pencil or hachure marks on the plat below.
2. If more than one lease is dedicated to the well, outline each and identify the ownership thereof (both as to working interest and royalty).
3. If more than one lease of different ownership is dedicated to the well, have the interests of all owners been consolidated by communitization, unitization, force-pooling, etc?

☐ Yes ☐ No If answer is "yes," type of consolidation _____

If answer is "no," list the owners and tract descriptions which have actually been consolidated. (Use reverse side of this form if necessary.) _____

No allowable will be assigned to the well until all interests have been consolidated (by communitization, unitization, forced-pooling, or otherwise) or until a non-standard unit, eliminating such interests, has been approved by the Commission.

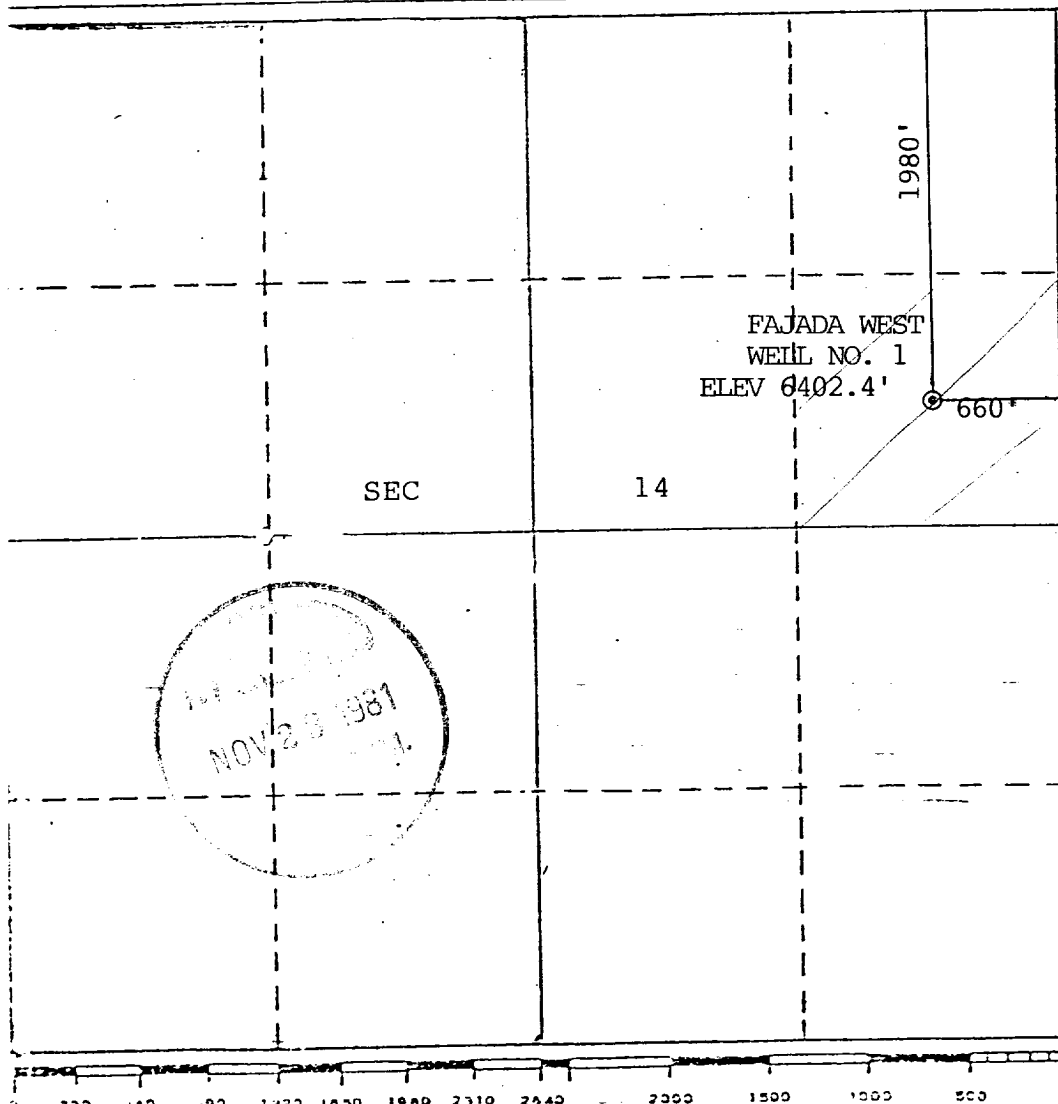

CERTIFICATION

I hereby certify that the information contained herein is true and complete to the best of my knowledge and belief.

Sammy N. Morgan
Name

Sammy N. Morgan

Position

Drilling Engineer

Company

Santa Fe Energy Company

Date

November 13, 1981

I hereby certify that the well location shown on this plat was plotted from field notes of actual surveys made by me or under my supervision, and that the same is true and correct to the best of my knowledge and belief.

Date Surveyed

20

Registered Professional Engineer and/or Land Surveyor

Melvin F. Bautista
Melvin F. Bautista

Certificate No.

NM 7437