

UNITED STATES
DEPARTMENT OF THE INTERIOR
GEOLOGICAL SURVEY

APPLICATION FOR PERMIT TO DRILL, DEEPEN, OR PLUG BACK

1. TYPE OF WORK
a. TYPE OF WELL
OIL WELL ☐ GAS WELL ☐ **XX Injection** SINGLE ZONE ☐ MULTIPLE ZONE ☐
2. NAME OF OPERATOR
Tesoro Petroleum Corporation
3. ADDRESS OF OPERATOR
8700 Tesoro Drive, San Antonio, TX 78286 Telephone (512) 828-8484
4. LOCATION OF WELL (Report location clearly and in accordance with any State requirements.)
At surface 330' FSL, 1980' FWL **RECEIVED**
At proposed prod. zone same **APR 02 1984**

5. LEASE DESIGNATION AND SERIAL NO.
NM-052931
6. IF INDIAN, ALLOTTEE OR TRIBE NAME
Navajo
7. UNIT AGREEMENT NAME
Hanson
8. FARM OR LEASE NAME
Hanson
9. WELL NO.
44
10. FIELD AND POOL, OR WILDCAT
South Hospah, Lower Hospah **Sand**
11. SEC., T., R., M., OR B.L.R. AND SURVEY OR AREA
N Sec. 6-T17N-R8W
12. COUNTY OR PARISH
McKinley
13. STATE
NM

14. DISTANCE IN MILES AND DIRECTION FROM NEAREST TOWN OR POST OFFICE
7 miles South of White Horse Post Office **BUREAU OF LAND MANAGEMENT**
15. DISTANCE FROM PROPOSED LOCATION TO NEAREST PROPERTY OR LEASE LINE, FT. (Also to nearest drilg. unit line, if any)
330' FWL
16. NO. OF ACRES IN LEASE
511.94 ±
17. NO. OF ACRES ASSIGNED TO THIS WELL
40
18. DISTANCE FROM PROPOSED LOCATION TO NEAREST WELL, DRILLING, COMPLETED, OR APPLIED FOR, ON THIS LEASE, FT.
400' from the Hanson #36
19. PROPOSED DEPTH
1605 ±
20. ROTARY OR CABLE TOOLS
Rotary
21. ELEVATIONS (Show whether DF, RT, GR, etc.)
6888' GL
22. APPROX. DATE WORK WILL START
April 20, 1984

DRILLING OPERATIONS AUTHORIZED ARE SUBJECT TO COMPLIANCE WITH ATTACHED "GENERAL REQUIREMENTS"
PROPOSED LEASE AND CEMENTING PROGRAM
This action is subject to administrative appeal pursuant to 30 CFR 290.
circulate to surface
150 sx ± (TOC @ 900')

SIZE OF HOLE	SIZE OF CASING	WEIGHT PER FOOT	SETTING DEPTH
12 1/4"	8 5/8"	24#	90' +
6 3/4"	4 1/2"	9.5#	1605 ±

We propose to drill the captioned well to use as an injection well in our polymer augmented water injection project known as the Tesoro South Hospah Lower Sand Oil Pool Project. This project is a qualified tertiary recovery project under the Crude Oil Windfall Profits Tax Act of 1980. This qualification was given by the New Mexico Oil Conservation Division by Order No. R-4558-A.

RECEIVED
JUN 28 1984
OIL CON. DIV.
DIST. 3

IN ABOVE SPACE DESCRIBE PROPOSED PROGRAM: If proposal is to deepen or plug back, give data on present productive zone and location of new productive zone. If proposal is to drill or deepen directionally, give pertinent data on subsurface locations and measured and true vertical depths. Give blowout preventer program, if any.

SIGNED *Gavino Perez, Jr.* TITLE Area Production Manager DATE 3/29/84
(This space for Federal or State office use)

PERMIT NO. APPROVAL DATE
APPROVED BY AS AMENDED
CONDITIONS OF APPROVAL, IF ANY

Well injection for WFX order
*See Instructions On Reverse Side
JUN 25 1984
(ISGD.) MATHEW N. MILLENBACH
M. MILLENBACH
AREA MANAGER
NMOCC

OIL CONSERVATION DIVISION

P. O. BOX 2088

SANTA FE, NEW MEXICO 87501

Form C-107
Revised 10-1-78

STATE OF NEW MEXICO

ENERGY AND MINERALS DEPARTMENT

All distances must be from the outer boundaries of the Section.

Operator TESORO PETROLEUM CORPORATION			Lease HANSON		Well No. 44
Unit Letter N	Section 6	Township 17N	Range 8W	County McKinley	
Actual Footage Location of Well: 330 feet from the South line and 1980 feet from the West line					
Ground Level Elev. 6888	Producing Formation		Pool	Dedicated Acreage Acres	

1. Outline the acreage dedicated to the subject well by colored pencil or hachure marks on the plat below.
2. If more than one lease is dedicated to the well, outline each and identify the ownership thereof (both as to working interest and royalty).
3. If more than one lease of different ownership is dedicated to the well, have the interests of all owners been consolidated by communitization, unitization, force-pooling, etc?

☐ Yes ☐ No If answer is "yes," type of consolidation _____

If answer is "no," list the owners and tract descriptions which have actually been consolidated. (Use reverse side of this form if necessary.) _____

No allowable will be assigned to the well until all interests have been consolidated (by communitization, unitization, forced-pooling, or otherwise) or until a non-standard unit, eliminating such interests, has been approved by the Commission.

Sec.		RECEIVED APR 02 1984 BUREAU OF LAND MANAGEMENT FARMINGTON RESOURCE AREA	
6		RECEIVED JUN 28 1984 OIL CON. DIV. SANTA FE	
1980'		330'	

Scale: 1"=1000'

CERTIFICATION

I hereby certify that the information contained herein is true and complete to the best of my knowledge and belief.

Name **Gravino Perez Jr.**

Position **Area Production Mgr.**

Company **Tesoro Petroleum Corp.**

Date **3-29-84**

I hereby certify that the well location shown on this plat was plotted from field notes of actual surveys made by me or under my supervision, and that the same is true and correct to the best of my knowledge and belief.

Date Surveyed **December 13, 1983**

Registered Professional Engineer and Land Surveyor

Fred B. Kerr Jr.

Certificate No. **3950**

GEOLOGICAL SURVEY

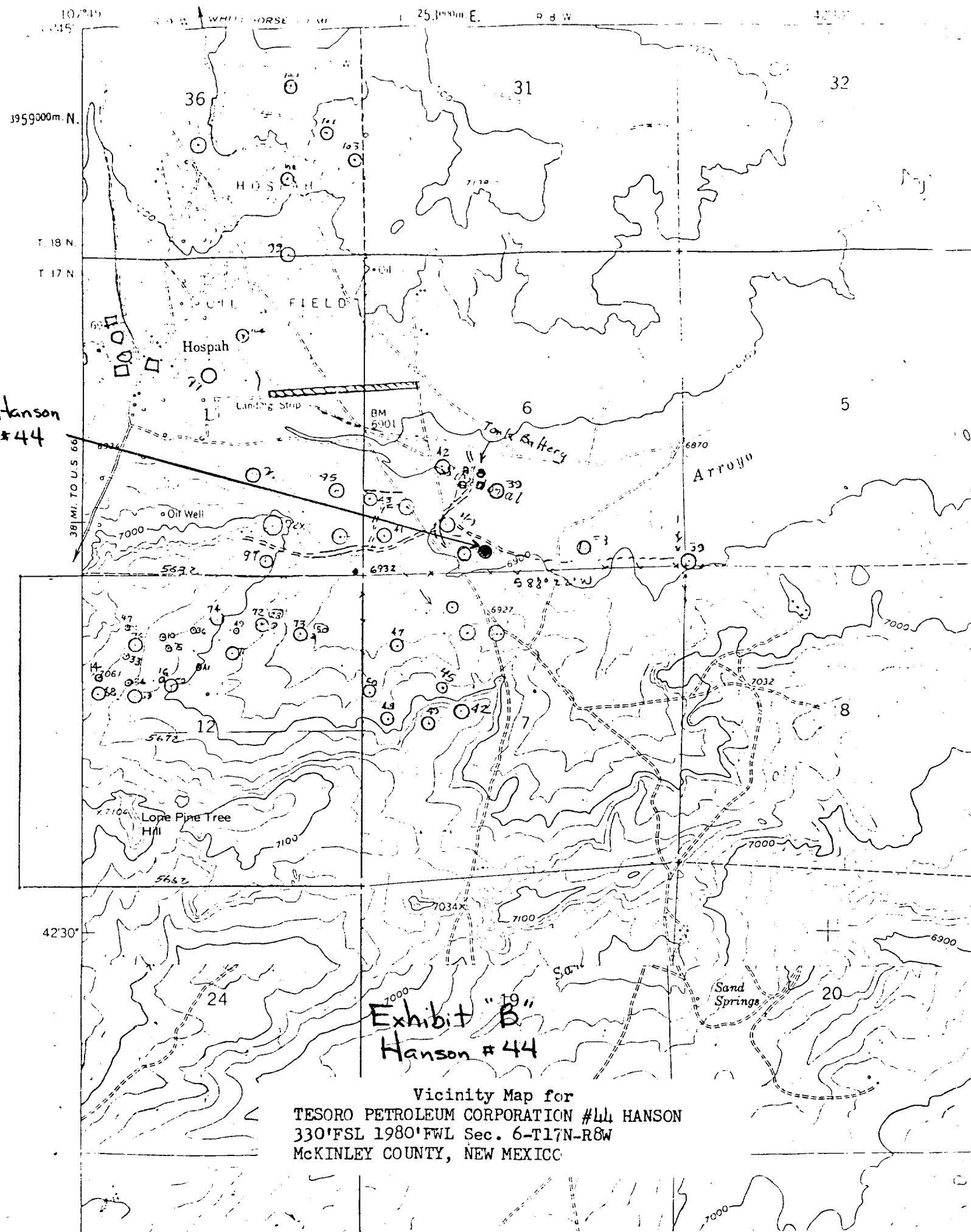

Exhibit "B"
Hanson #44

Vicinity Map for
TESORO PETROLEUM CORPORATION #44 HANSON
330'FSL 1980'FWL Sec. 6-T17N-R8W
MCKINLEY COUNTY, NEW MEXICO