

STATE OF NEW MEXICO
ENERGY AND MINERALS DEPARTMENT

OIL CONSERVATION DIVISION
P. O. BOX 2088
SANTA FE, NEW MEXICO 87501

30-031-20941
Form C-101
Revised 10-1-78

NO. OF COPIES RECEIVED	
DISTRIBUTION	
SANTA FE	
FILE	
U.S.G.S.	
LAND OFFICE	
OPERATOR	

5A. Indicate Type of Lease
STATE ☒ FEE ☐
5. State Oil & Gas Lease No.
VA-80

APPLICATION FOR PERMIT TO DRILL, DEEPEN, OR PLUG BACK

1a. Type of Work DRILL <input checked="" type="checkbox"/> DEEPEN <input type="checkbox"/> PLUG BACK <input type="checkbox"/>		7. Unit Agreement Name
b. Type of Well OIL WELL <input checked="" type="checkbox"/> GAS WELL <input type="checkbox"/> OTHER <input type="checkbox"/> SINGLE ZONE <input checked="" type="checkbox"/> MULTIPLE ZONE <input type="checkbox"/>		8. Farm or Lease Name Enchantment 36
2. Name of Operator Diversified Operating Corporation		9. Well No. 15
3. Address of Operator 1600 Stout Street, Suite 1900 Denver, Colorado 80202		10. Field and Pool, or Wildcat Wildcat-DAKOTA
4. Location of Well UNIT LETTER <u>0</u> LOCATED <u>1980</u> FEET FROM THE <u>East</u> LINE AND <u>990</u> FEET FROM THE <u>South</u> LINE OF SEC. <u>36</u> TWP. <u>16 N</u> RGE. <u>7 W</u> NMPM		12. County McKinley
19. Proposed Depth 2050'		19A. Formation Dakota
20. Rotary or C.T. Rotary		
21. Elevations (Show whether DF, RT, etc.) 6474' G.L.	21A. Kind & Status Plug. Bond Single Well Cash	21B. Drilling Contractor Unknown
22. Approx. Date Work will start ASAP		

23. PROPOSED CASING AND CEMENT PROGRAM

SIZE OF HOLE	SIZE OF CASING	WEIGHT PER FOOT	SETTING DEPTH	SACKS OF CEMENT	EST. TOP
12-1/4"	8-5/8"	24	100'	388 sks/ft.	surface
7-7/8"	4-1/2" or	10.5	2050'	190 sks 50/50	surface
	5-1/2"	15.5	2050'	145 sks 50/50	surface

BOP will be installed during drilling operations.

RECEIVED
JAN 8 1989
OIL CON. DIV.

APPROVAL EXPIRES 7/16/92
UNLESS DRILLING IS COMMENCED.
SPUD NOTICE MUST BE SUBMITTED
WITHIN 90 DAYS

RECEIVED
DEC 12 1988
OIL CON. DIV.
JAN 8

IN ABOVE SPACE DESCRIBE PROPOSED PROGRAM; IF PROPOSAL IS TO DEEPEN OR PLUG BACK, GIVE DATA ON PRESENT PRODUCTIVE ZONE AND PROPOSED NEW PRODUCTIVE ZONE. GIVE BLOWOUT PREVENTER PROGRAM, IF ANY.

I hereby certify that the information above is true and complete to the best of my knowledge and belief.

Signed [Signature] Title Manager of Operations Date December 8, 1988

(This space for State Use)

APPROVED BY [Signature] TITLE DEPUTY OIL & GAS INSPECTOR, DIST. #3 DATE JAN 16 1989

CONDITIONS OF APPROVAL, IF ANY:

**NEW MEXICO OIL CONSERVATION COMMISSION
WELL LOCATION AND ACREAGE DEDICATION PLAT**

Form C-102
Supersedes C-128
Effective 1-1-85

All distances must be from the outer boundaries of the Section.

Operator Diversified Operating Corporation			Lease ENCHANTMENT State VA-80		Well No. Enchantment 36-15
Unit Letter 0	Section 36	Township 16 North	Range 7 West	County McKinley	
Actual Footage Location of Well: 1980 feet from the East line and 990 feet from the South line					
Ground Level Elev. 6474	Producing Formation Dakota		Pool Wildcat		Dedicated Acreage: 40 Acres

1. Outline the acreage dedicated to the subject well by colored pencil or hatchure marks on the plat below.
2. If more than one lease is dedicated to the well, outline each and identify the ownership thereof (both as to working interest and royalty).
3. If more than one lease of different ownership is dedicated to the well, have the interests of all owners been consolidated by communitization, unitization, force-pooling, etc?

☐ Yes ☐ No If answer is "yes," type of consolidation _____

If answer is "no," list the owners and tract descriptions which have actually been consolidated. (Use reverse side of this form if necessary.) _____

No allowable will be assigned to the well until all interests have been consolidated (by communitization, unitization, forced-pooling, or otherwise) or until a non-standard unit, eliminating such interests, has been approved by the Commission.

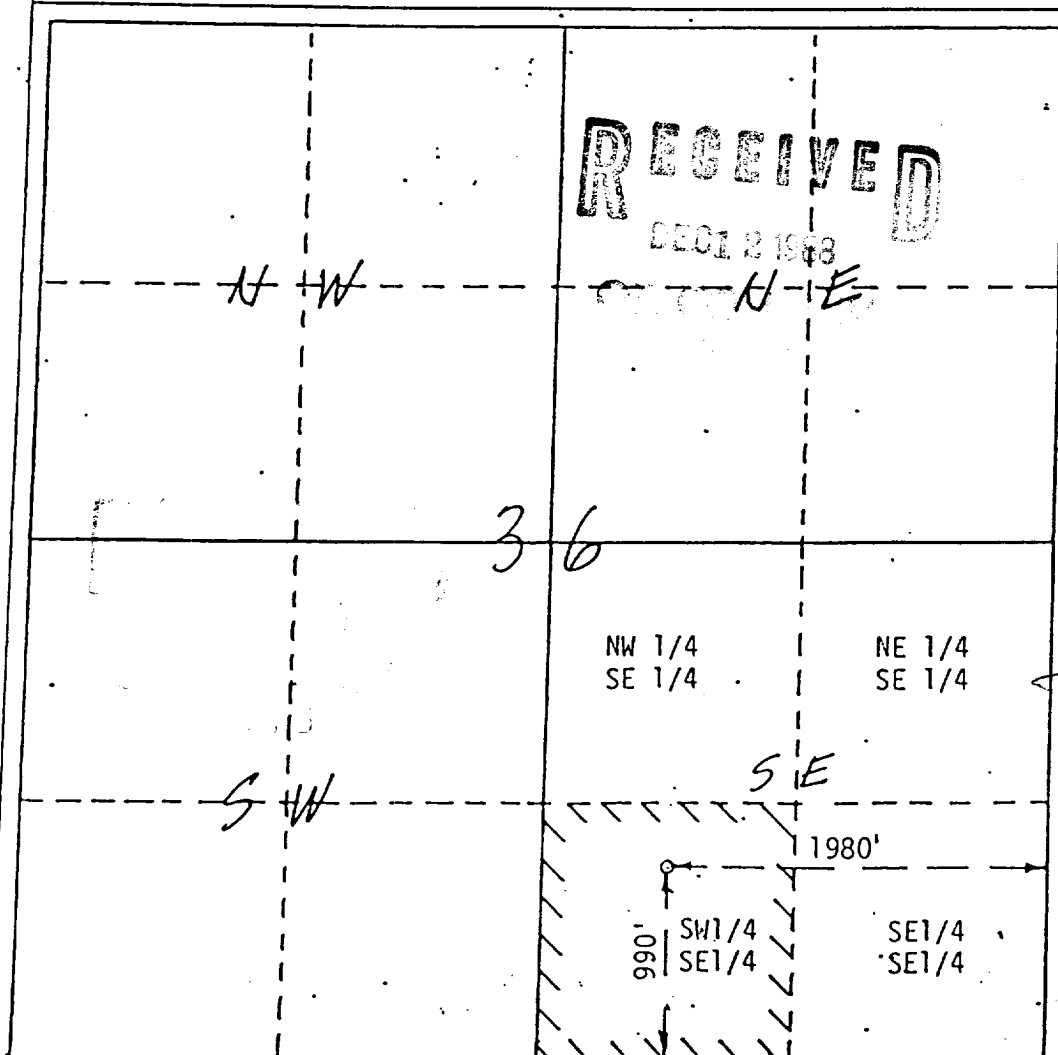

CERTIFICATION

I hereby certify that the information contained herein is true and complete to the best of my knowledge and belief.

Name
Steven Youtsey

Position
Field Survey Party Chief

Company
Gannett Fleming/Matotan, Inc.

Date
November 18, 1988

I hereby certify that the well location shown on this plat was plotted from field notes of actual survey made by me or under my supervision, and that the same is true and correct to the best of my knowledge and belief.

STEVEN YOUTSEY
7248

Date Surveyed
November 17, 1988

Registered Professional Engineer and Land Surveyor
Steven Youtsey

Certificate No.
NMPS 7248

0 330 660 990 1320 1650 1980 2310 2640 2000 1500 1000 500 0