

Submit to Appropriate
District Office
State Lease - 6 copies
Fee Lease - 5 copies

State of New Mexico
Energy, Minerals and Natural Resources Department

Form C-101
Revised 1-1-89

OIL CONSERVATION DIVISION

P.O. Box 2088
Santa Fe, New Mexico 87504-2088

DISTRICT I
P.O. Box 1980, Hobbs, NM 88240

DISTRICT II
P.O. Drawer DD, Artesia, NM 88210

DISTRICT III
1000 Rio Brazos Rd., Aztec, NM 87410

API NO. (assigned by OCD on New Wells)

30-031-20946

5. Indicate Type of Lease

STATE ☒ FEE ☐

6. State Oil & Gas Lease No.

VA-8

APPLICATION FOR PERMIT TO DRILL, DEEPEN, OR PLUG BACK

1a. Type of Work:

DRILL ☒ RE-ENTER ☐ DEEPEN ☐ PLUG BACK ☐

b. Type of Well:

OIL WELL ☒ GAS WELL ☐ OTHER ☐ SINGLE ZONE ☒ MULTIPLE ZONE ☐

2. Name of Operator

High Plains Petroleum Corporation

8. Well No.

1

3. Address of Operator

3860 Carlock Dr., Boulder, Colorado 80303

9. Pool name or Wildcat

Wildcat
HOSPAN

4. Well Location

Unit Letter E : 330 Feet From The West Line and 1750 Feet From The North Line

Section 16 36 Township 17 North, Range 5 West, NMPMs McKinley County

10. Proposed Depth

1410'

11. Formation

Hospah

12. Rotary or C.T.

Rotary

13. Elevations (Show whether DF, RT, GR, etc.)

6234' GR

14. Kind & Status Plug. Bond

Cash

15. Drilling Contractor

Wayne Smith Drlg.

16. Approx. Date Work will start

8/15/89

17.

PROPOSED CASING AND CEMENT PROGRAM

SIZE OF HOLE	SIZE OF CASING	WEIGHT PER FOOT	SETTING DEPTH	SACKS OF CEMENT	EST. TOP
8 3/4"	7"	20	150'	50	surface
6 1/4"	4 1/2"	10.5	1410'	110	700'

Plan to spud an 8 3/4" hole, drill to 150' and set approx. 150' of 7" casing with sufficient cement to circulate to surface. Then we plan to drill a 6 1/4" hole to 1410' or the depth necessary to test the Hospah Formation and run logs to evaluate any oil or gas shows. If production is indicated, we will run 4 1/2" casing, cover the prospective zones with cement, perforate, test and stimulate if required.

A 6" Schaffer Hydraulic BOP tested to 3000 psi will be on the well during all drilling operations.

RECEIVED

AUG 04 1989

IN ABOVE SPACE DESCRIBE PROPOSED PROGRAM: IF PROPOSAL IS TO DEEPEN OR PLUG BACK, GIVE DATA ON PRESENT PRODUCTIVE ZONE AND PROPOSED NEW PRODUCTIVE ZONE. GIVE BLOWOUT PREVENTER PROGRAM, IF ANY.

I hereby certify that the information above is true and complete to the best of my knowledge and belief.

SIGNATURE

John B. Somers II

TITLE

President & Engineer

DATE

8/1/89

303-494-4529

TELEPHONE NO.

TYPE OR PRINT NAME

(This space for State Use)

APPROVED BY

Emile Busch

TITLE

DEPUTY OIL & GAS INSPECTOR, DIST. #3

DATE

AUG 11 1989

CONDITIONS OF APPROVAL, IF ANY:

APPROVAL EXPIRES 2-11-90
UNLESS DRILLING IS COMMENCED.
SPUD NOTICE MUST BE SUBMITTED
WITHIN 10 DAYS.

Submit to Appropriate
District Office
State Lease - 4 copies
Fee Lease - 3 copies

State of New Mexico
Energy, Minerals and Natural Resources Department

Form C-102
Revised 1-1-89

OIL CONSERVATION DIVISION

DISTRICT I
P.O. Box 1980, Hobbs, NM 88240

P.O. Box 2088

Santa Fe, New Mexico 87504-2088

DISTRICT II
P.O. Drawer DD, Artesia, NM 88210

DISTRICT III
1000 Rio Brazos Rd., Aztec, NM 87410

WELL LOCATION AND ACREAGE DEDICATION PLAT

All Distances must be from the outer boundaries of the section

Operator HIGH PLAINS PETROLEUM CORPORATION			Lease ALIMENTO STATE		Well No. 1
Unit Letter E	Section 36	Township 17 N	Range 5 W	County McKinley	
Actual Footage Location of Well: 1750 feet from the North line and 330 feet from the West line					
Ground level Elev. 6234	Producing Formation HOSPAN		Pool W. C.	Dedicated Acreage: 40 Acres	

1. Outline the acreage dedicated to the subject well by colored pencil or hatchure marks on the plat below.
2. If more than one lease is dedicated to the well, outline each and identify the ownership thereof (both as to working interest and royalty).
3. If more than one lease of different ownership is dedicated to the well, have the interest of all owners been consolidated by communitization, unitization, force-pooling, etc?
☐ Yes ☐ No If answer is "yes" type of consolidation _____
If answer is "no" list the owners and tract descriptions which have actually been consolidated. (Use reverse side of this form if necessary). _____
No allowable will be assigned to the well until all interests have been consolidated (by communitization, unitization, forced-pooling, or otherwise) or until a non-standard unit, eliminating such interest, has been approved by the Division.

OPERATOR CERTIFICATION

I hereby certify that the information contained herein is true and complete to the best of my knowledge and belief.

Signature *John B. Somers II*

Printed Name
John B. Somers II
President & Engineer

Position High Plains
Petroleum Corporation

Company
August 1, 1989

Date

SURVEYOR CERTIFICATION

I hereby certify that the well location shown on this plat was plotted from field notes of actual surveys made by me or under my supervision, and that the same is true and correct to the best of my knowledge and belief.

7-18-89

Date Surveyed

William E. Mahnke II

Signature *William E. Mahnke II*
Professional Surveyor

NEW MEXICO
#8466
PROFESSIONAL LAND SURVEYOR

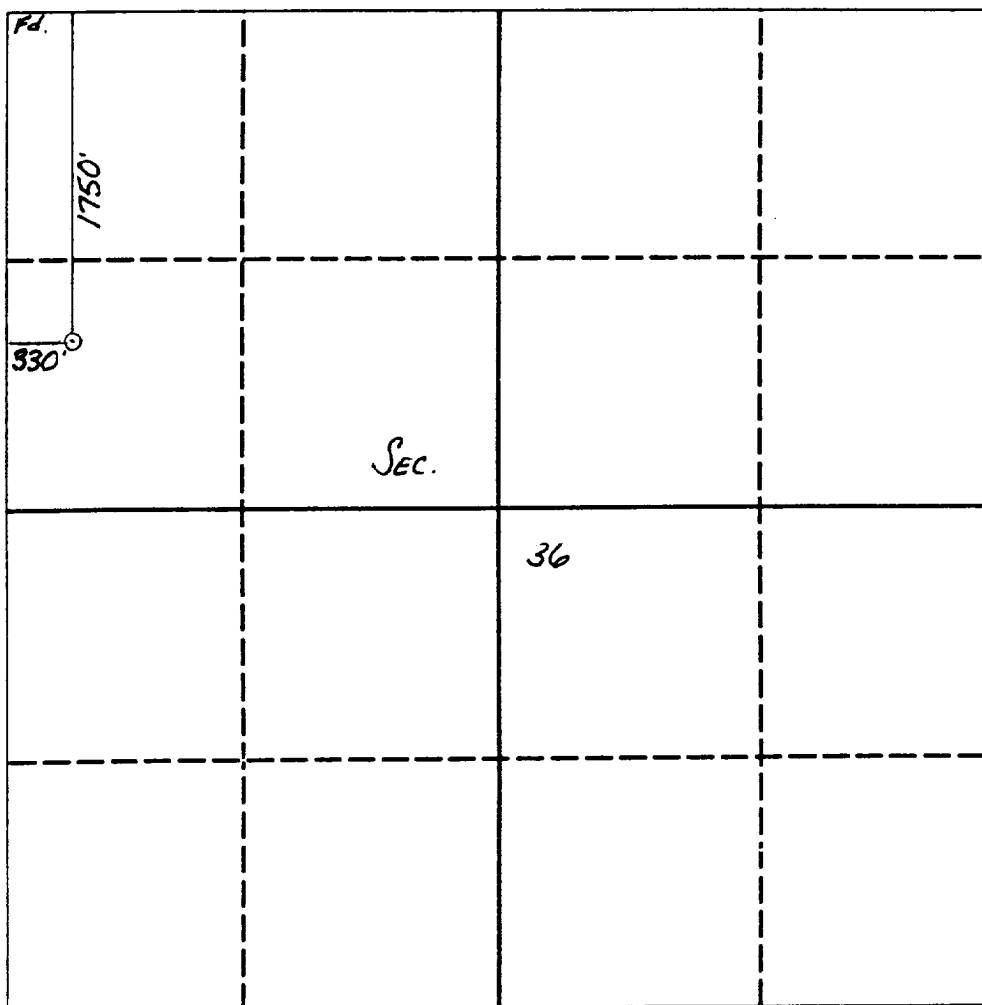

0 330 660 990 1320 1650 1980 2310 2640 2000 1500 1000 500 0