

UNITED STATES
DEPARTMENT OF THE INTERIOR
BUREAU OF LAND MANAGEMENT

APPLICATION FOR PERMIT TO DRILL, DEEPEN, OR PLUG BACK

1a. TYPE OF WORK

DRILL ☒

DEEPEN ☐

PLUG BACK ☐

b. TYPE OF WELL

OIL
WELL ☒

GAS
WELL ☐

OTHER ☐

SINGLE
ZONE ☐

MULTIPLE
ZONE ☐

2. NAME OF OPERATOR

MERRION OIL & GAS CORPORATION

3. ADDRESS OF OPERATOR

P. O. Box 840, Farmington, New Mexico 87499

4. LOCATION OF WELL (Report location clearly and in accordance with any State requirements.)

At surface

1,785' FSL & 1,785' FEL

At proposed prod. zone

14. DISTANCE IN MILES AND DIRECTION FROM NEAREST TOWN OR POST OFFICE*

21 miles South of Counselors, New Mexico

15. DISTANCE FROM PROPOSED*

LOCATION TO NEAREST
PROPERTY OR LEASE LINE, FT.
(Also to nearest drlg. unit line, if any)

1,785'

16. NO. OF ACRES IN LEASE

1,565.56

18. DISTANCE FROM PROPOSED LOCATION*

TO NEAREST WELL, DRILLING, COMPLETED,
OR APPLIED FOR, ON THIS LEASE, FT.

1,350'

19. PROPOSED DEPTH

3,180'

17. NO. OF ACRES ASSIGNED

TO THIS WELL 40

20. ROTARY OR CABLE TOOLS

Rotary

21. ELEVATIONS (Show whether DF, RT, GR, etc.)

6,880' GR

22. APPROX. DATE WORK WILL START*

July, 1990

23.

This action is subject to procedural review and appeal pursuant to 43 CFR 15.106-1. PROPOSED CASING AND CEMENTING PROGRAM

DRILLING OPERATIONS AUTHORIZED ARE
SUBJECT TO COMPLIANCE WITH ATTACHED
"GENERAL REQUIREMENTS"

SIZE OF HOLE	SIZE OF CASING	WEIGHT PER FOOT	SETTING DEPTH	QUANTITY OF CEMENT
12-1/4"	8-5/8", J-55	24 lb/ft	100 ft.	80 sx (94.4 ft ³) Class B 2% CaCl ₂
7-7/8"	5-1/2", J-55	14, 15.5 lb/ft	3,180 ft.	400 sx (614 ft ³) Class H 2% Gel

Propose to drill 12-1/4" surface hole to 100' KB. Will set approximately 100 ft. of 8-5/8", J-55, 24 lb/ft surface casing at 100 ft KB with 80 sx (94 cu. ft.) Class "B", 2% CaCl₂. Top of cement at the surface. Wait on cement 10 hrs. Nipple up BOP's. Pressure test casing to 600 psi for 30 mins. Drill 7-7/8" hole to total depth at 3,180 ft. Will run open hole logs. If well appears productive will set 5-1/2", J-55, 14, 15.5 lb/ft production casing at total depth with 150 sx class "B" 2% D79 (309 ft³) followed by 250 sx (305 cu ft) class "H", 2% gel. Estimated top of cement at the surface. Will perforate and stimulate as necessary to test well. Additional drilling program details attached.

IN ABOVE SPACE DESCRIBE PROPOSED PROGRAM: If proposal is to deepen or plug back, give data on present productive zone and proposed new productive zone. If proposal is to drill or deepen directionally, give pertinent data on subsurface locations and measured and true vertical depths. Give blowout preventer program, if any.

24.

SIGNED

Steven S. Dunn
Steven S. Dunn

TITLE

Operations Manager

DATE 3/29/90

(This space for Federal or State office use)

PERMIT NO.

APPROVAL DATE

APPROVED BY

TITLE

CONDITIONS OF APPROVAL, IF ANY:

NMOCD

cc: Well File

*See Instructions On Reverse Side

Title 18 U.S.C. Section 1001, makes it a crime for any person knowingly and willfully to make to any department or agency of the United States any false, fictitious or fraudulent statements or representations as to any matter within its jurisdiction.

APPROVED
AS AMENDED

APR 25 1990
[Signature]
AREA MANAGER

RECEIVED

DEC 10 1961

OFFICE OF THE
DIRECTOR

NEW MEXICO OIL CONSERVATION COMMISSION
WELL LOCATION AND ACREAGE DEDICATION PLAT

Form C-102
Supersedes C-128
Effective 1-1-65

All distances must be from the outer boundaries of the Section.

Operator MERRION OIL & GAS CORPORATION			Lease Corrales		Well No. 5
Unit Letter J	Section 3	Township 20 North	Range 6 West	County McKinley	
Actual Footage Location of Well: 1785 feet from the South line and 1785 feet from the East line					
Ground Level Elev: 6880	Producing Formation Mesaverde		Pool POT MESA Mesaverde EXT	Dedicated Acreage: 40 Acres	

1. Outline the acreage dedicated to the subject well by colored pencil or hachure marks on the plat below.
2. If more than one lease is dedicated to the well, outline each and identify the ownership thereof (both as to working interest and royalty).
3. If more than one lease of different ownership is dedicated to the well, have the interests of all owners been consolidated by communitization, unitization, force-pooling, etc?

☐ Yes ☐ No If answer is "yes," type of consolidation _____

If answer is "no," list the owners and tract descriptions which have actually been consolidated. (Use reverse side of this form if necessary.) _____

No allowable will be assigned to the well until all interests have been consolidated (by communitization, unitization, forced-pooling, or otherwise) or until a non-standard unit, eliminating such interests, has been approved by the Commission.

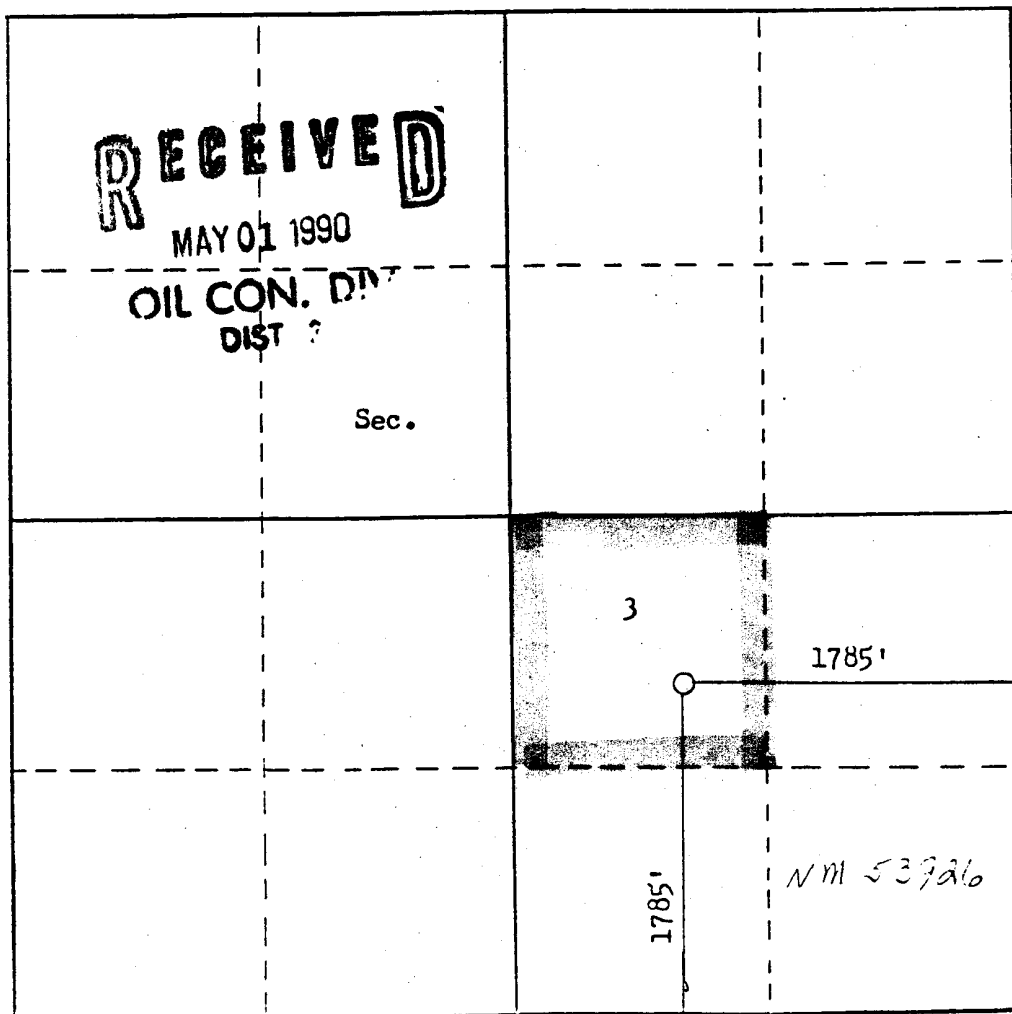

Scale: 1"=1000'

CERTIFICATION

I hereby certify that the information contained herein is true and complete to the best of my knowledge and belief.

Name
Steven S. Dunn
Position
Operations Manager
Company
Merrion Oil & Gas Corporation
Date
3/29/90

I hereby certify that the well location shown on this plat was plotted from field notes of actual surveys made by me or under my supervision, and that the same is true and correct to the best of my knowledge and belief.

Date Surveyed
Dec. 12, 1985
Registered Professional Engineer and Land Surveyor
Fred B. Kerr Jr.
Certificate No.
3950

3 3 3 3 3 3 3
CER TO
10 100 100
C Tele

INTERIOR KEY

276000m.E.

R6W

2730'

