

Submit to Appropriate  
District Office  
State Lease - 6 copies  
Fee Lease - 5 copies

State of New Mexico  
Energy, Minerals and Natural Resources Department

Form C-101  
Revised 1-1-89

OIL CONSERVATION DIVISION

DISTRICT I  
P.O. Box 1980, Hobbs, NM 88240

P.O. Box 2088  
Santa Fe, New Mexico 87504-2088

DISTRICT II  
P.O. Drawer DD, Artesia, NM 88210

DISTRICT III  
1000 Rio Brazos Rd., Aztec, NM 87410

API NO. (assigned by OCD on New Wells)

30-031-20967

5. Indicate Type of Lease

STATE ☒

FEE ☐

6. State Oil & Gas Lease No.

LG 2779

APPLICATION FOR PERMIT TO DRILL, DEEPEN, OR PLUG BACK

1a. Type of Work:

DRILL ☒

RE-ENTER ☐

DEEPEN ☐

PLUG BACK ☐

b. Type of Well:

OIL  
WELL ☒

GAS  
WELL ☐

OTHER ☐

SINGLE  
ZONE ☒

MULTIPLE  
ZONE ☐

7. Lease Name or Unit Agreement Name

State

8. Well No.

303

9. Pool name or Wildcat

Chaco Wash Mesa Verde

4. Well Location

Unit Letter

G

2310

Feet From The

North

Line and

1980

Feet From The

East

Line

Section

28

Township

20N

Range

9W

NMPM

McKinley

County

10. Proposed Depth

460' GR

11. Formation

Menefee

12. Rotary or C.T.

Rotary

13. Elevations (Show whether DE, RT, GR, etc.)

6434' GR

14. Kind & Status Plug Bond

In Process

15. Drilling Contractor

Wayne Smith Drilling

16. Approx. Date Work will start

November 12, 1991

17.

PROPOSED CASING AND CEMENT PROGRAM

Joint w/ 302, 301

SIZE OF HOLE

6 1/2"

SIZE OF CASING

4 1/2"

WEIGHT PER FOOT

10.50 lb.

SETTING DEPTH

460' GR

SACKS OF CEMENT

44 sks (52 c.f.)

EST. TOP

GR

Operator proposes to drill a 6 1/2" hole to a depth of 460' GR, using water based drilling mud. The Menefee sandstone will be analyzed by examining drill cuttings and by evaluating resistivity and porosity logs. If our analysis concludes that the Menefee sandstone has potential for producing oil, 4 1/2" casing will be set at total depth and cemented to surface with 44 sks (52 c.f.) class "B" cement.

APPROVAL EXPIRES 5-5-92  
UNLESS DRILLING IS COMMENCED.  
SPUD NOTICE MUST BE SUBMITTED  
WITHIN 10 DAYS.

RECEIVED

OCT 28 1991

OIL CON. DIV.  
DIST. 3

IN ABOVE SPACE DESCRIBE PROPOSED PROGRAM: IF PROPOSAL IS TO DEEPEN OR PLUG BACK, GIVE DATA ON PRESENT PRODUCTIVE ZONE AND PROPOSED NEW PRODUCTIVE ZONE. GIVE BLOWOUT PREVENTER PROGRAM, IF ANY.

I hereby certify that the information above is true and complete to the best of my knowledge and belief.

SIGNATURE

Frank Welker

TITLE

Vice President

DATE

10-19-91

TYPE OR PRINT NAME

Frank Welker

291-9502

TELEPHONE NO.

(This space for State Use)

APPROVED BY

3-5-8

TITLE

SUPERVISOR DISTRICT # 3

DATE

NOV 05 1991

CONDITIONS OF APPROVAL, IF ANY:

# OIL CONSERVATION DIVISION

DISTRICT I  
P.O. Box 1980, Hobbs, NM 88240

P.O. Box 2088

Santa Fe, New Mexico 87504-2088

DISTRICT II  
P.O. Drawer DD, Artesia, NM 88210

DISTRICT III  
1000 Rio Brazos Rd., Aztec, NM 87410

## WELL LOCATION AND ACREAGE DEDICATION PLAT

All Distances must be from the outer boundaries of the section

Operator <b>Enerdyne Corporation</b>			Lease <b>State</b>		Well No. <b>303</b>
Unit Letter <b>G</b>	Section <b>28</b>	Township <b>20 North</b>	Range <b>9 West</b>	NMPM	County <b>Mc Kinley</b>
Actual Footage Location of Well: <b>2310</b> feet from the <b>North</b> line and <b>1980</b> feet from the <b>East</b> line					
Ground level Elev. <b>6434'</b>	Producing Formation <b>Menefee</b>		Pool <b>Chaco Wash Mesa Verde</b>		Dedicated Acreage: <b>40 joint Acres</b>

- Outline the acreage dedicated to the subject well by colored pencil or hachure marks on the plat below.
- If more than one lease is dedicated to the well, outline each and identify the ownership thereof (both as to working interest and royalty).
- If more than one lease of different ownership is dedicated to the well, have the interest of all owners been consolidated by communitization, unitization, force-pooling, etc.?  
☐ Yes ☐ No If answer is "yes" type of consolidation \_\_\_\_\_  
If answer is "no" list the owners and tract descriptions which have actually been consolidated. (Use reverse side of this form if necessary.)  
No allowable will be assigned to the well until all interests have been consolidated (by communitization, unitization, forced-pooling, or otherwise) or until a non-standard unit, eliminating such interest, has been approved by the Division.

### OPERATOR CERTIFICATION

I hereby certify that the information contained herein is true and complete to the best of my knowledge and belief.

Signature

Printed Name

**Frank Welker**

Position

**Vice President**

Company

**Enerdyne Corporation**

Date

**10-21-91**

### SURVEYOR CERTIFICATION

I hereby certify that the well location shown on this plat was plotted from field notes of actual surveys made by me or under my supervision, and that the same is true and correct to the best of my knowledge and belief.

**10-15-91**

Date Surveyed

**C. Edwards**

Signature of State or Professional Surveyor

**6357**

Certificate No.

**6857**

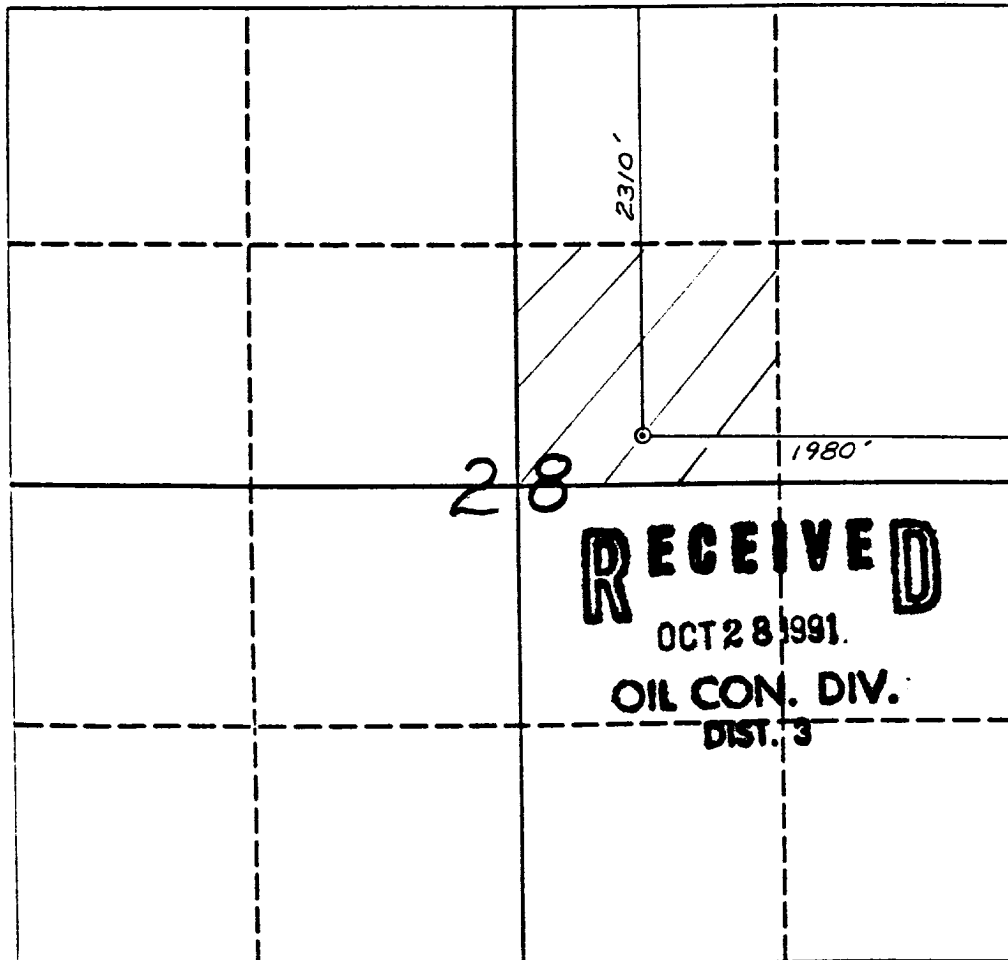

0 330 660 990 1320 1650 1980 2310 2640 2000 1500 1000 500 0