

UNITED STATES
DEPARTMENT OF THE INTERIOR
BUREAU OF LAND MANAGEMENT

APPLICATION FOR PERMIT TO DRILL, DEEPEN, OR PLUG BACK

1a. TYPE OF WORK

DRILL ☒

DEEPEN ☐

PLUG BACK ☐

b. TYPE OF WELL

OIL
WELL ☒

GAS
WELL ☐

OTHER

SINGLE
ZONE ☐

MULTIPLE
ZONE ☐

2. NAME OF OPERATOR

High Plains Petroleum Corporation

3. ADDRESS OF OPERATOR

3860 Carlock Drive, Boulder, CO 80303

4. LOCATION OF WELL (Report location clearly and in accordance with any State requirements.)*

At surface

960' FSL x 660' FEL

At proposed prod. zone

Same

14. DISTANCE IN MILES AND DIRECTION FROM NEAREST TOWN OR POST OFFICE*

25 miles southwest of Cuba, New Mexico

15. DISTANCE FROM PROPOSED*

LOCATION TO NEAREST
PROPERTY OR LEASE LINE, FT.
(Also to nearest drlg. unit line, if any)

16. NO. OF ACRES IN LEASE

520.00

18. DISTANCE FROM PROPOSED LOCATION*

TO NEAREST WELL, DRILLING, COMPLETED,
OR APPLIED FOR, ON THIS LEASE, FT.

19. PROPOSED DEPTH

2050'

21. ELEVATIONS (Show whether DF, RT, GR, etc.)

6623 GR' This action is subject to technical and

procedural review pursuant to 43 CFR 3165.4
and appeal pursuant to 43 CFR 3165.4.

SIZE OF HOLE	SIZE OF CASING	WEIGHT PER FOOT	SETTING DEPTH	GENERAL QUANTITY OF CEMENT
8 3/4"	7"	20 K-55	200'	95 Ft ³
6 1/4"	4 1/2"	10.5# K-55	2050'	252 Ft ³ *

Exact Volume to be deter-
mined by logging.

Prospective producing intervals in the Menefee and Point Lookout Formations
will be tested and stimulated as necessary.

EXHIBITS:

- A. Location and Elevation Plat
- B. Ten Point Compliance Program
- C. Blowout Preventor Diagram
- D. Multi-point Requirements of APD.
- E. Access to Location
- F. Drill Rig Layout
- G. Completion Program Layout
- H. Location Profile

CONFIDENTIAL

IN ABOVE SPACE DESCRIBE PROPOSED PROGRAM: If proposal is to deepen or plug back, give data on present productive zone and proposed new productive zone. If proposal is to drill or deepen directionally, give pertinent data on subsurface locations and measured and true vertical depths. Give blowout preventer program, if any.

24.

SIGNED

John B. Somers II

TITLE

President

DATE

11/11/91

(This space for Federal or State office use)

PERMIT NO.

RECEIVED

APPROVAL DATE

APPROVED
AS AMENDED

APPROVED BY

MAR 30 1992

TITLE

CONDITIONS OF APPROVAL

OIL CON. DIV.
DIST. 3

*See Instructions On Reverse Side

DEC 16 1991
AREA MANAGER

10-11-60

RECEIVED
NOV 11 1960
U.S. AIR FORCE
OFFICE OF THE
JOINT CHIEFS OF STAFF
WASHINGTON, D.C.

UNITED STATES
DEPARTMENT OF THE INTERIOR
BUREAU OF LAND MANAGEMENT

FORM APPROVED
Budget Bureau No. 1004-0135
Expires: March 31, 1993

SUNDRY NOTICES AND REPORTS ON WELLS

Do not use this form for proposals to drill or to deepen or reentry to a different reservoir.
Use "APPLICATION FOR PERMIT—" for such proposals

5. Lease Designation and Serial No.

NM 86471

6. If Indian, Allottee or Tribe Name

7. If Unit or CA, Agreement Designation

SUBMIT IN TRIPLICATE

1. Type of Well

☒ Oil Well ☐ Gas Well ☐ Other

2. Name of Operator

High Plains Petroleum Corporation

3. Address and Telephone No.

3860 Carlock Dr., Boulder, CO 80303 Ph. No. 303-494-4529

4. Location of Well (Footage, Sec., T., R., M., or Survey Description)

960' FSL & 660' FEL Section 27, T19N, R5W

8. Well Name and No.

Mammoth Federal No. 1

9. API Well No.

10. Field and Pool, or Exploratory Area

Wildcat

11. County or Parish, State

Makinley County, New Mexico

12. CHECK APPROPRIATE BOX(s) TO INDICATE NATURE OF NOTICE, REPORT, OR OTHER DATA

TYPE OF SUBMISSION

- ☐ Notice of Intent
☒ Subsequent Report
☐ Final Abandonment Notice

TYPE OF ACTION

- ☐ Abandonment
☐ Recompletion
☐ Plugging Back
☐ Casing Repair
☐ Altering Casing
☐ Other _____
- ☒ Change of Plans
☐ New Construction
☐ Non-Routine Fracturing
☐ Water Shut-Off
☐ Conversion to Injection
☐ Dispose Water

(Note: Report results of multiple completion on Well Completion or Recompletion Report and Log form.)

13. Describe Proposed or Completed Operations (Clearly state all pertinent details, and give pertinent dates, including estimated date of starting any proposed work. If well is directionally drilled, give subsurface locations and measured and true vertical depths for all markers and zones pertinent to this work.)*

The original location was in the bottom of a drainage, so Mr. Dale Wirth, the BLM's inspector, recommended moving it 50' east, which is out of the drainage. As a result, the new location is 960' FSL & 610' FEL, Section 27, Twp. 19 North, Rge. 5 West, NMPM.

RECEIVED
BLM

DEC 10 PM 4:28

FARMINGTON, N.M.

CONFIDENTIAL

RECEIVED

MAR 3 01992

OIL CON. DIV
DIST. 2

14. I hereby certify that the foregoing is true and correct

Signed

John B. Somers II

Title

President

Date

Dec. 10, 1991

(This space for Federal or State office use)

Approved by

Title

Date

Conditions of approval, if any:

RECEIVED
JUN 10 1965
OIL CONT. DIV.
DIST. 3

EXHIBIT "A"

State of New Mexico
Energy, Minerals and Natural Resources Department

Form C-102
Revised 1-1-89

Submit to Appropriate
District Office
State Lease - 4 copies
Fee Lease - 3 copies

OIL CONSERVATION DIVISION

P.O. Box 2088
Santa Fe, New Mexico 87504-2088

DISTRICT I
P.O. Box 1980, Hobbs, NM 88240

DISTRICT II
P.O. Drawer DD, Artesia, NM 88210

DISTRICT III
1000 Rio Brazos Rd., Aztec, NM 87410

WELL LOCATION AND ACREAGE DEDICATION PLAT

All Distances must be from the outer boundaries of the section

Operator HIGH PLAINS PETROLEUM CORPORATION			Lease MAMMOTH FEDERAL			Well No. 1		
Unit Letter P	Section 27	Township 19 N	Range 5 W	County McKinley				
Actual Footage Location of Well: 960 feet from the South line and 660 610 feet from the East line								
Ground level Elev. 6623	Producing Formation <i>Mesa Verde</i>			Pool <i>Wildcat</i>		Dedicated Acreage: 70 Acres		
<p>1. Outline the acreage dedicated to the subject well by colored pencil or hatchure marks on the plat below.</p> <p>2. If more than one lease is dedicated to the well, outline each and identify the ownership thereof (both as to working interest and royalty).</p> <p>3. If more than one lease of different ownership is dedicated to the well, have the interest of all owners been consolidated by communitization, unitization, force-pooling, etc.? <input type="checkbox"/> Yes <input type="checkbox"/> No If answer is "yes" type of consolidation _____ If answer is "no" list the owners and tract descriptions which have actually been consolidated. (Use reverse side of this form if necessary.) _____ No allowable will be assigned to the well until all interests have been consolidated (by communitization, unitization, forced-pooling, or otherwise) or until a non-standard unit, eliminating such interest, has been approved by the Division.</p>								

0 330 660 990 1320 1650 1980 2310 2640 2000 1500 1000 500 0

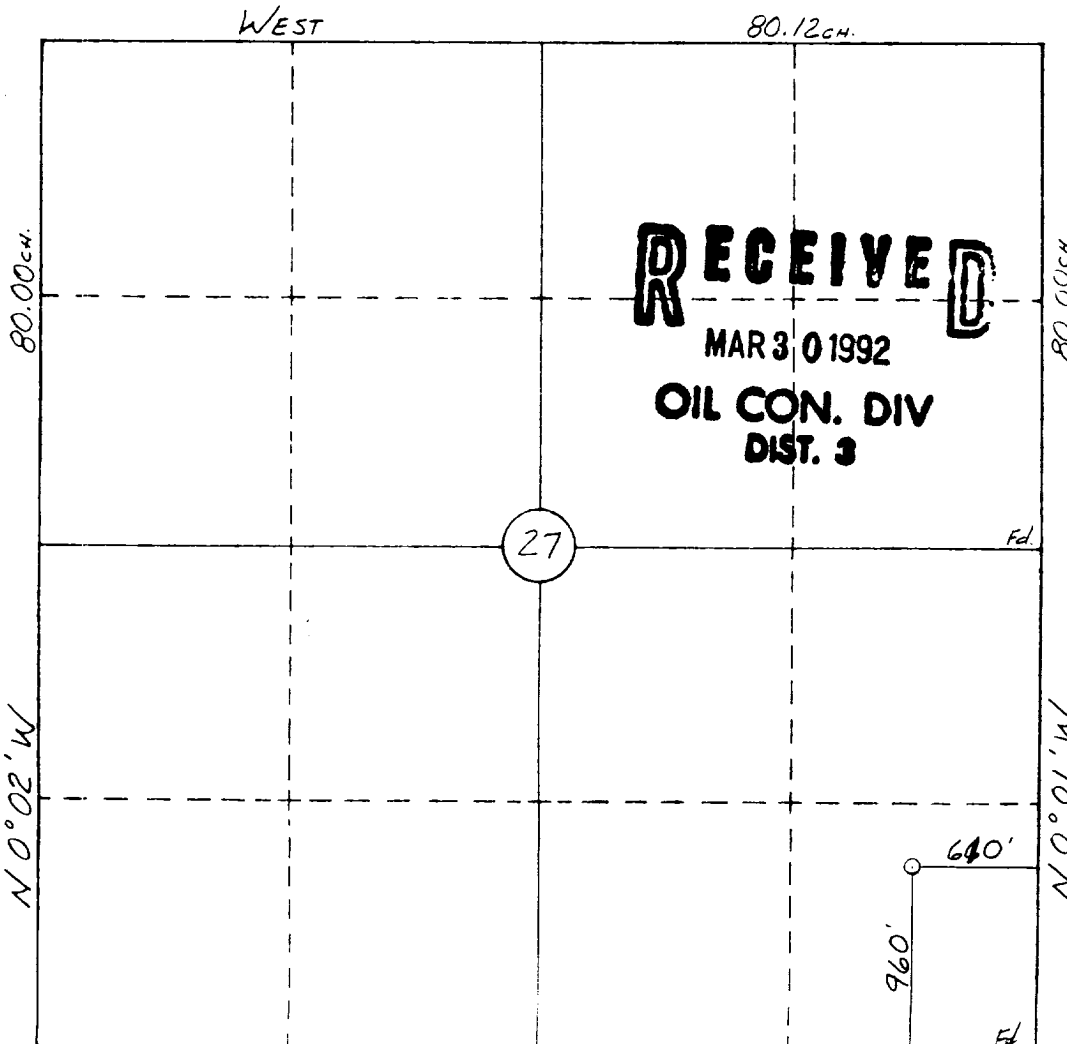

OPERATOR CERTIFICATION

I hereby certify that the information contained herein is true and complete to the best of my knowledge and belief.

John B. Somers II
Signature

John B. Somers II
Printed Name

President
Position

High Plains Petroleum Corp
Company

11/11/91
Date

11/11/91
Date

SURVEYOR CERTIFICATION

I hereby certify that the well location shown on this plat was plotted from field notes of actual surveys made by me or under my supervision, and that the same is true and correct to the best of my knowledge and belief.

11-8-91

William F. Mahnke II
Date Surveyed

William F. Mahnke II
Signature and Seal of Professional Surveyor

WILSON MAHNKE II
#8466
PROFESSIONAL LAND SURVEYOR

8466
Certificate No.

8466
Certificate No.

RECEIVED
JUN 1 1964
U.S. AIR FORCE
HONOLULU, HAWAII

EXHIBIT "B"
TEN-POINT COMPLIANCE PROGRAM
OF NTL-6 APPROVAL OF OPERATIONS

Attached to Form 9-331C

High Plains Petroleum Corporation
Mammoth Federal #1
960' FSL, 660' FEL
Sec. 27, T19N, R5W
McKinley County, New Mexico

1. The Geologic Surface Formation

Lewis Shale

2. Estimated Tops of Important Geologic Markers

Lewis Shale	0
Cliff House SS.	740
Menefee	765
Point Lookout SS.	1910
Mancos Shale	2050 (TD)

3. Estimated Depths of Anticipated Water, Oil, Gas or Minerals

Menefee	Oil
Point Lookout	Oil

CONFIDENTIAL

4. The Proposed Casing Program

<u>Hole Size</u>	<u>Interval</u>	<u>Section Length</u>	<u>Size (OD)</u>	<u>Weight, Grade and Type</u>
8-3/4"	0' - 200'	200'	7"	20.0# K55 New
6-1/4"	200' - 2050'	1850'	4-1/2"	10.5# K55 New

Cement Program

Surface - 200' of 7" 20# csg. will be cmt'd. w/ 95 ft³ of ClB w/ 2% CaCl₂

Production - 2050' 4½" 10.5# csg. will be cmt'd. w/ 252 ft³ of 50-50 poz containing 2% gel and 2% KCL, which will isolate and seal off all porous zones and coal bearing strata in the Cliff House, Menefee and Point Lookout Formations. An adequate number of centralizers will be run through any useable water zone(s) that may be encountered.

5. The Operator's Minimum Specifications for Pressure Control

Exhibit "C" is a schematic diagram of the blowout preventer equipment. The BOP's will be hydraulically tested to the full working pressure after nipping up and after any use under pressure. Pipe rams will be operationally checked each 24-hour period, as will blind rams each time pipe is pulled out of the hole. Such checks of BOP will be noted on daily drilling reports.

Accessories to BOP will include floor safety valve, and choke manifold with pressure rating equivalent to the BOP stack.

6. The Type and Characteristics of the Proposed Circulating Muds

The surface hole will be drilled with native mud. Then, the 6¼" hole will be drilled with KCL water containing sufficient polymer to obtain good samples. Mud and weight additives will be on location to be added if pressure requires.

7. The Auxiliary Equipment to be Used

- (a) A float will be used at the bit.
- (b) The mud system will be monitored visually.
- (c) A stabbing valve will be on the floor to be stabbed into the drill pipe when the kelly is not in the string.
- (d) Upper kelly cock valve with handle available.

8. The Testing, Logging and Coring Programs to be Followed

(a) DST - None

(b) Logging - CNL - FDC - IES with GR

(c) Coring - None

9. Any Anticipated Abnormal Pressures or Temperatures

No abnormal pressures or temperatures have been noted or reported in wells drilled in the area nor at the depths anticipated in this well. Bottom hole pressure expected is 500 psi.

No hydrogen sulfide or other hazardous fluids or gases have been found, reported or known to exist at these depths in the area.

10. Anticipated Starting Date and Duration of the Operations

The anticipated starting date is set for December 15, 1991 or as soon as possible after examination and approval of drilling requirements. Operations should be completed within 5 days.

High Plains Petroleum Corporation
Mammoth Federal #1
960' FSL, 660' FEL
Sec. 27 - T19N - R5W
McKinley County, New Mexico

EXHIBIT "C"

RECEIVED
BLM

91 NOV 29 AM 11:37

019 HARRINGTON, N.M.

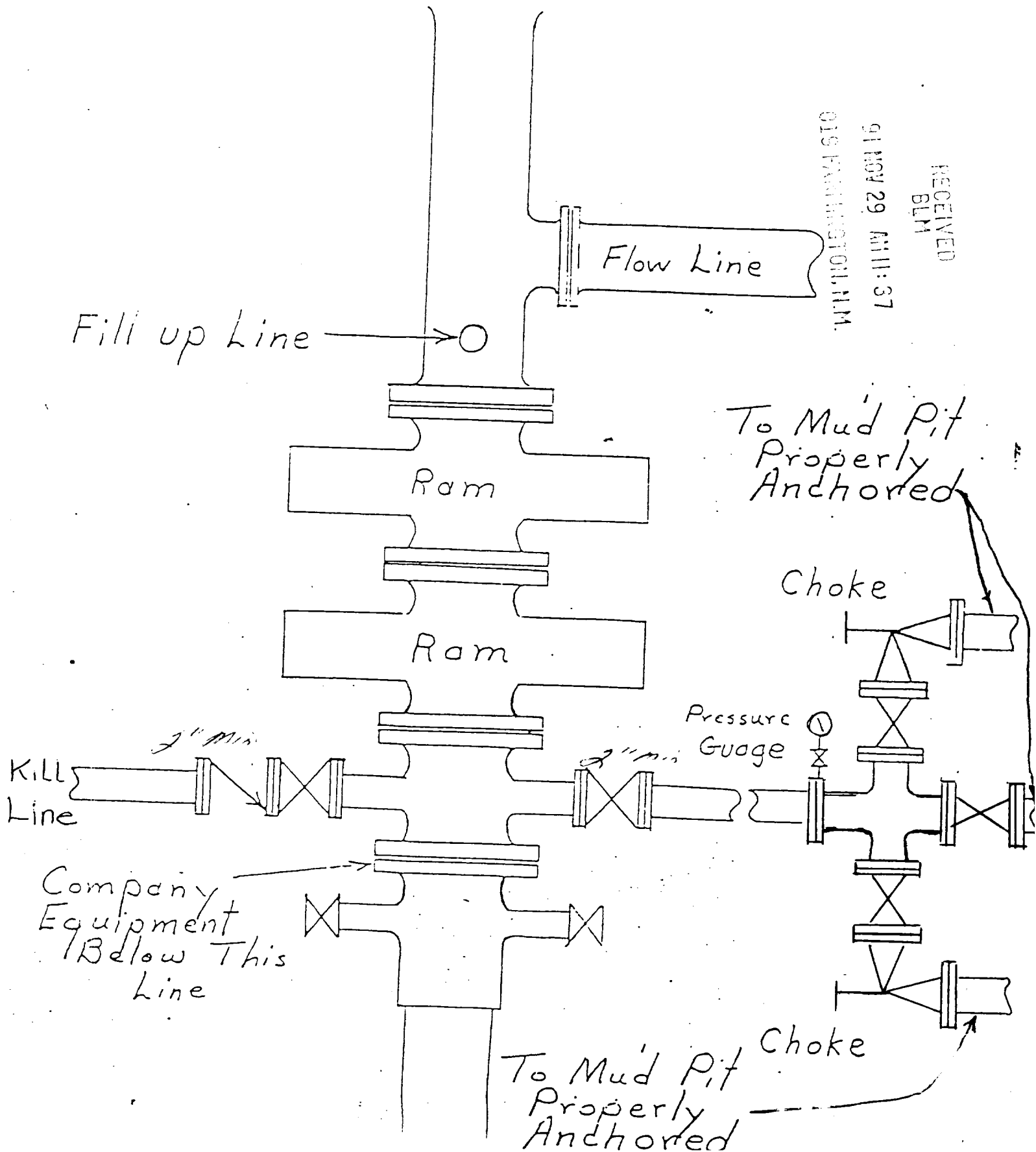

EXHIBIT "D"

MULTI-POINT REQUIREMENTS TO ACCOMPANY A.P.D.

Attached to Form 9-331C

High Plains Petroleum Corporation
Mammoth Federal #1
960' FSL, 660' FEL
Sec. 27, T19N, R5W
McKinley County, New Mexico

1. Existing Roads

- A. The proposed site and elevation plat is shown as Exhibit "A".
- B. Directions: Turn right (north) off of State Highway 197 approximately $5\frac{1}{4}$ miles northwest of Torreon Trading Post. Proceed west approximately $\frac{3}{4}$ mi. on a gravel road. Turn right (north) and proceed northeast about $1\frac{1}{4}$ mi. on another gravel road. Turn left (north) and proceed about $\frac{1}{2}$ mi. on an improved dirt road to the access road. Turn left (southwest) and go about $\frac{1}{8}$ mi. to the location.
- C. All roads to location are indicated on Exhibit "E". Existing roads will be improved, or maintained in the same or better condition.
- D. Exploration wells, existing roads: See Exhibit "E"
- E. Development wells, existing roads: N/A
- F. Improvement and maintenance: As needed

2. Planned Access Roads

The proposed access road, as shown on Exhibit "E" will be constructed as a one track road with a 8'-10' driving surface width. Road bed will be constructed of surrounding material. Grade will be consistent with local terrain. The proposed access road and location are on Lease No. NM86471.

3. Location of Existing Wells

For all existing wells within one mile radius of development well, see Exhibit "E".

- (1) There are no Known water wells within a one mile radius of this location.
- (2) There are five (5) abandoned wells within a one mile radius. Those wells are: Federal Tinian #26-1 in the SW/4 of Sec. 26; 1-27 Federal in the SE/4 of Sec. 27; Paperthin #1 in the SENW of Sec. 26; Paperthin #2 in the NWNW of Sec. 26; and Irma #1 in the SW/4 of Sec. 35.

- (3) There are no temporarily abandoned wells.
- (4) There are no disposal wells.
- (5) There are no wells presently being drilled.
- (6) There are no producing wells within this one mile radius.
- (7) There are no shut-in wells.
- (8) There are no injection wells.
- (9) There are no monitoring or observation wells for other uses.

4. Location of Existing and/or Proposed Facilities

- A. Within one mile radius of location, there are no existing facilities that are owned or controlled by lessee/operator:
 - (1) Tank Batteries:
 - (2) Production Facilities:
 - (3) Oil Gathering Lines:
 - (4) Gas Gathering Lines:
 - (5) Injection Lines:
 - (6) Disposal Lines:
- B. If production is obtained, new facilities will be as follows:
 - (1) All production facilities will be located on the pad.
 - (2) All well flow lines will be buried and will be on the well site and battery site.
 - (3) Drill pad will be 150 feet long and 60 feet wide.
 - (4) No construction materials for battery site and pad will be necessary.
 - (5) Any necessary pits will be fenced and flagged to protect livestock and wildlife.
 - (6) Rehabilitation whether well is productive or dry, will be made on all unused acres in accordance with BLM stipulations.

5. Location and Type of Water Source

- A. The source of water will be the Torreon Trading Post.
- B. Water will be transported by truck over existing roadways.
- C. No water well is to be drilled on this lease.

6. Construction Materials

- A. No construction materials are needed for drilling and access roads into drilling location unless production is obtained. The surface soil materials will be sufficient or will be provided by the Dirt Contractor as needed.
- B. No construction materials will be taken off Federal or Indian Lands.
- C. All surface soil materials for construction of access roads are sufficient.
- D. All major access roads presently exist as shown on Exhibit "E".

7. Handling of Waste Materials and Disposal

- (1) Drill cuttings will be buried in the mud pit and covered.
- (2) Drilling fluids will be handled in the mud pit.
- (3) Any fluids provided during drilling test or while making production test will be collected in a test tank. If a test tank is not available during drilling, fluids will be handled in reserve pit. Any spills of oil, gas, salt waters or other noxious fluids will be cleaned up and removed.
- (4) Chemical facilities will be provided for human waste.
- (5) Garbage and non-flammable waste and salts and other chemicals produced during drilling or testing will be handled in trash pit. Flammable waste will be disposed of in burn pit. Drill fluids, water drilling mud and tailings will be kept in reserve pit, as shown on EXHIBIT "G". Reserve pit will be fenced on three sides and the fourth side fenced upon removal of the rig.
- (6) After the rig moves out, all materials will be cleaned up and no adverse materials will be left on location. Any dangerous open pit will be fenced during drilling and kept closed until such time as the pit is leveled.

8. Ancillary Facilities

No air strip, camp or other facilities will be built during Drilling of this well.

9. Well Site Layout

- (1) EXHIBIT "F" is the Drill Pad Layout.

Topsoil, if removal required, will be stockpiled per specifications determined at time of pre-drill inspection.

- (2) EXHIBIT "F" is a plan diagram of the proposed rig and equipment mud pit, burn and trash pit, and pipe rack. No permanent living facilities are planned. There will be a mud logging trailer on site.

10. Plans for Restoration

- (1) Backfilling, leveling and contouring are planned as soon as all pits have dried. Waste disposal and spoils materials will be buried or hauled away immediately after drilling is completed. If production is obtained, the unused area will be restored as soon as possible.
- (2) The soil banked material, if removal required, will be spread over the area. Revegetation will be accomplished by planting mixed grasses as per formula provided by the BLM.
- (3) Three sides of the reserve pit will be fenced during drilling operations. Prior to rig release, the reserve pit will be fenced on the fourth side to prevent livestock or wildlife from becoming entrapped; and the fencing will be maintained until leveling and cleanup is accomplished.
- (4) The rehabilitation operations will begin as soon as possible after the drilling rig is removed. Removal of oil or other adverse substances will begin immediately or area will be flagged and fenced. Other cleanup will be done as needed. Planting and revegetation is considered best from July 15 to September 15, unless requested otherwise.

11. Other Information

(1) Soil - shale and silt clay

Vegetation - sparse Sagebrush

(2) The primary surface use is for grazing. The surface is owned by the Federal Government.

(3) The closest live water is - None

The closest occupied dwellings - Are located in the W/2 NW/4 Sec. 26, about $\frac{1}{2}$ mi. north northeast of the location.

There are no known archaeological, historical, or cultural Heritages that will be disturbed by this drilling.

(4) Restriction: None

(5) Drilling is planned for on or about December 15, 1991. Operations should be completed within 5 days.

12. Lessee's or Operator's Representative

John B. Somers II
3860 Carlock Dr.
Boulder, CO 80303

Office: (303) 494-4529

Home: (303) 494-4529

13. Certification

I hereby certify that I, or persons under my direct supervision, have inspected the proposed drillsite and access route; that I am familiar with the conditions which presently exist; that the statements made in this plan are, to the best of my knowledge, true and correct; and that the work associated with the operations proposed herein will be performed by High Plains Petroleum and its contractors and subcontractors in conformity with this plan and the terms and conditions under which it is approved.

November 11, 1991
Date

John B. Somers II

HIGH PLAINS PET. CORP.
MAMMOTH FEDERAL #1
960' FSL & 660' FEL
Sec. 27, T19N, R5W
McKinley Co., N.M.

EXHIBIT "E"

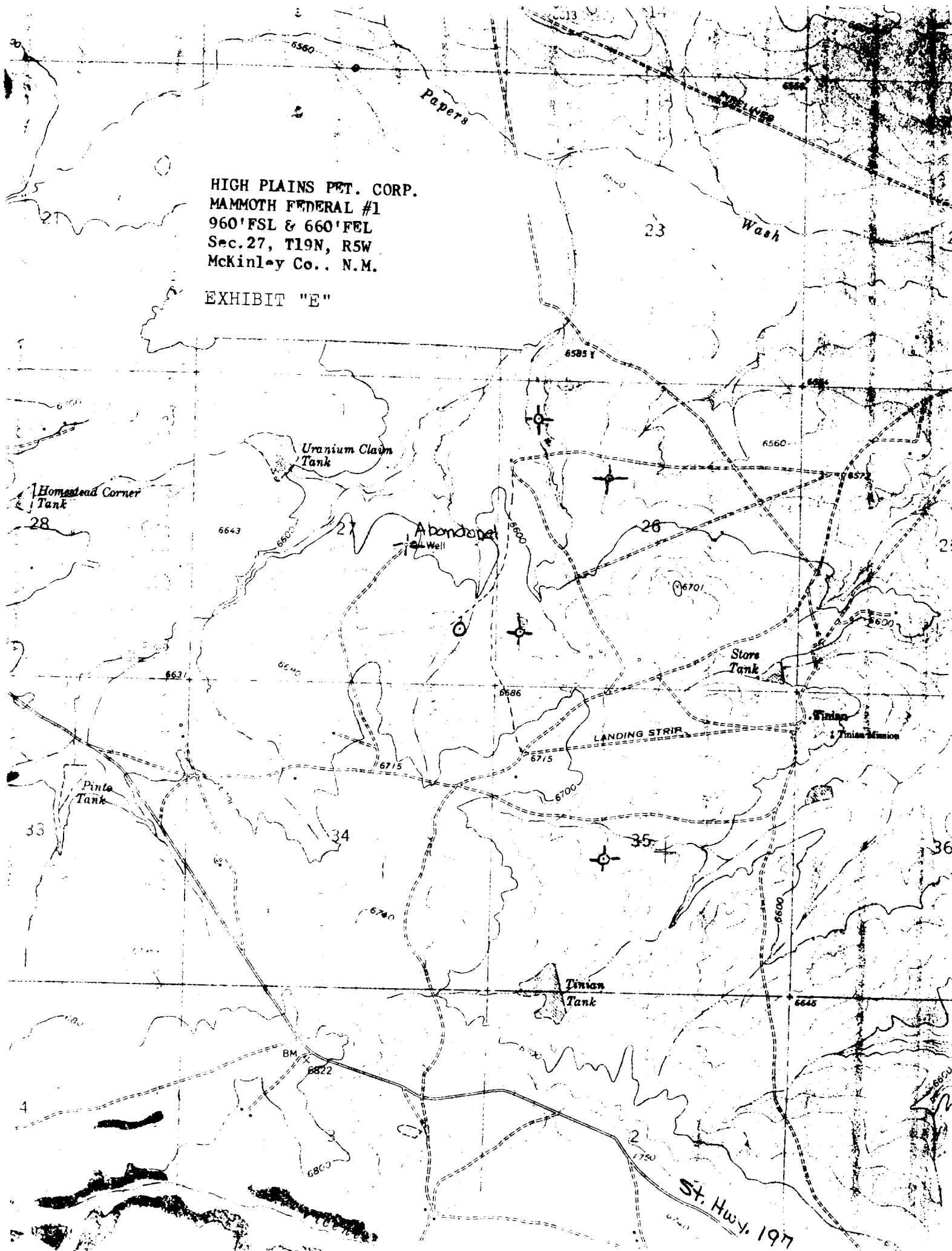
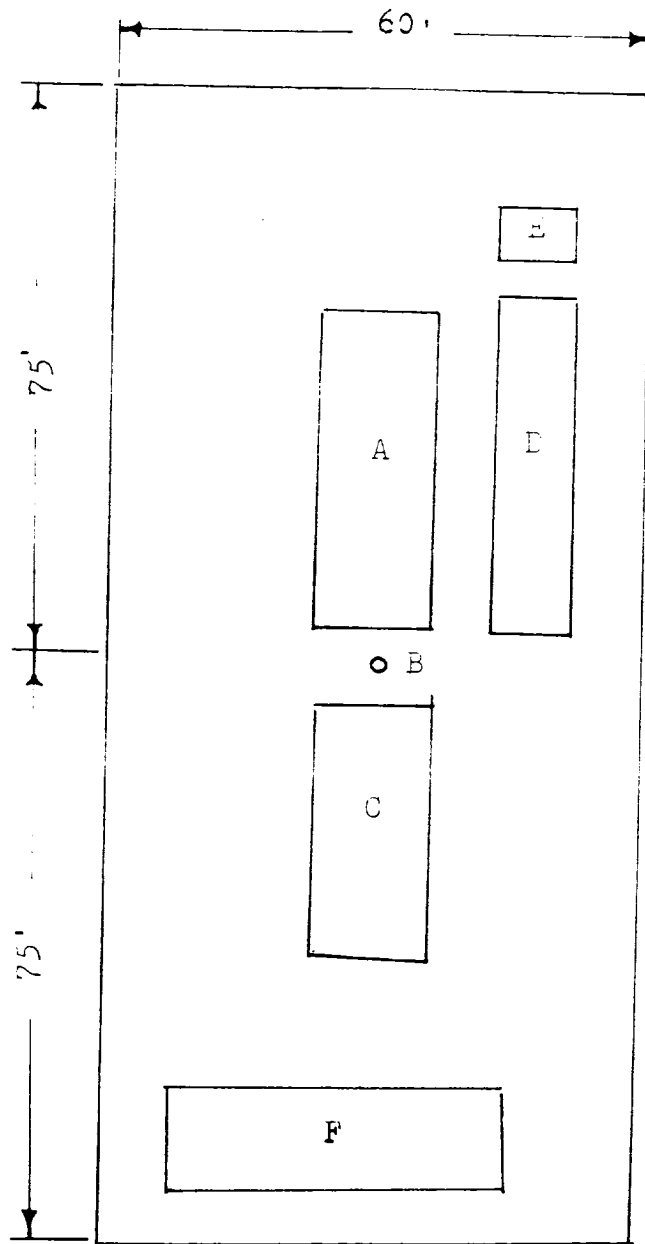

EXHIBIT "F"
DRILL RIG LAYOUT



- A - Rig
- B - Drill Hole
- C - Pipe Rack
- D - Reserve Pit
- E - Burn Pit
- F - Mud Logging Trailer

EXHIBIT "G"

COMPLETION RIG LAYOUT

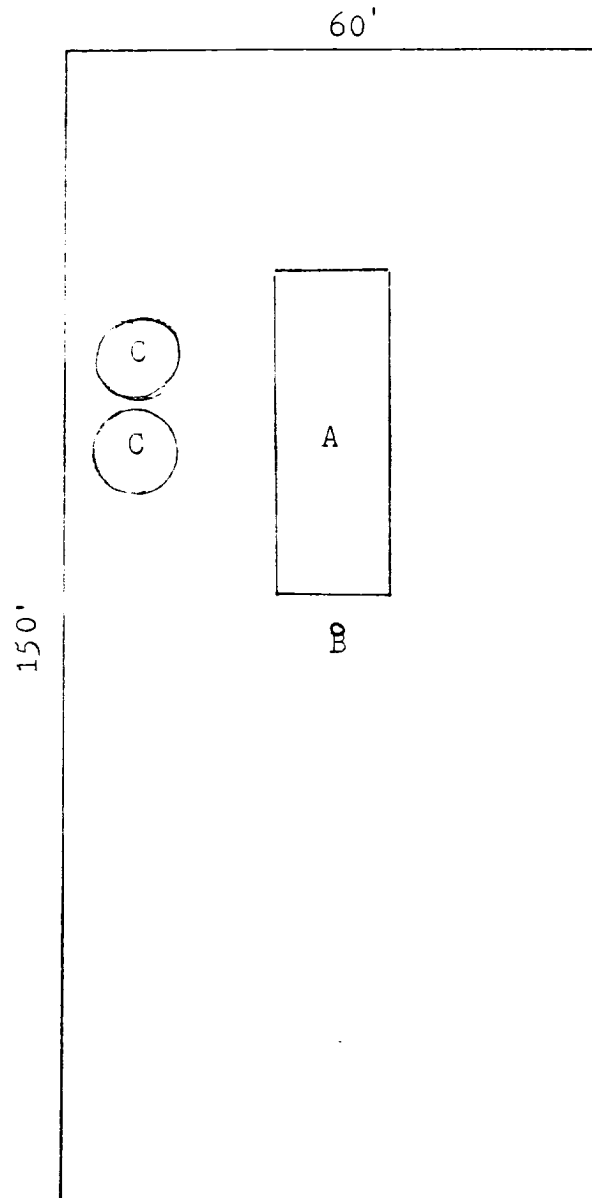

- A - Completion Rig
- B - Cased Hole
- C - Test Tanks

EXHIBIT "H"
HIGH PLAINS PET. CORP.
MAMMOTH FEDERAL #1
960' FSL & 660' FEL
Sec. 27, T19N, R5W
McKinley Co., N.M.

