

UNITED STATES  
DEPARTMENT OF THE INTERIOR  
GEOLOGICAL SURVEY

## APPLICATION FOR PERMIT TO DRILL, DEEPEN, OR PLUG BACK

## 1a. TYPE OF WORK

DRILL ☒DEEPEN ☐PLUG BACK ☐

## b. TYPE OF WELL

OIL  
WELL ☐GAS  
WELL ☒

OTHER

SINGLE  
ZONE ☒MULTIPLE  
ZONE ☐

## 2. NAME OF OPERATOR

Sherman F. Wagenseller

## 3. ADDRESS OF OPERATOR

170 S. Beverly Drive, Beverly Hills, California

## 4. LOCATION OF WELL (Report location clearly and in accordance with any State requirements.)\*

At surface

1650' fsi and 1850' fsi

At proposed prod. zone

Same

## 14. DISTANCE IN MILES AND DIRECTION FROM NEAREST TOWN OR POST OFFICE\*

## 10. DISTANCE FROM PROPOSED\*

LOCATION TO NEAREST  
PROPERTY OR LEASE LINE, FT.  
(Also to nearest drlg. unit line, if any)

1650'

## 16. NO. OF ACRES IN LEASE

1x 640

17. NO. OF ACRES ASSIGNED  
TO THIS WELL

160

## 18. DISTANCE FROM PROPOSED LOCATION\*

TO NEAREST WELL, DRILLING, COMPLETED,  
OR APPLIED FOR, ON THIS LEASE, FT.

1680'

## 19. PROPOSED DEPTH

3200

## 20. ROTARY OR CABLE TOOLS

Rotary

## 21. ELEVATIONS (Show whether DF, RT, GR, etc.)

7350 Gr. 8st.

## 22. APPROX. DATE WORK WILL START\*

May 20, 1965

## 23.

## PROPOSED CASING AND CEMENTING PROGRAM

SIZE OF HOLE	SIZE OF CASING	WEIGHT PER FOOT	SETTING DEPTH	QUANTITY OF CEMENT
12 1/4	8 5/8	24.0	100	60 sxs
7 7/8	4 1/2	9.5	3200 TD	180 sxs

## PROSPOED:

Drill to 100 feet and set 8 5/8" surface casing. Drill 7 7/8" hole to 3200' and run electric logs to TD. Set 4 1/2" production casing through Pictured Cliffs zone.

XXXXX XPMX

Perf. pay with 2 SPF and SWF

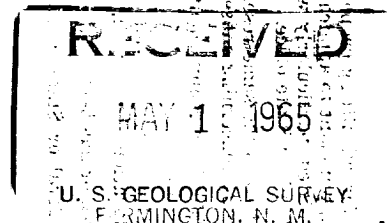

IN ABOVE SPACE DESCRIBE PROPOSED PROGRAM: If proposal is to deepen or plug back, give data on present productive zone and proposed new productive zone. If proposal is to drill or deepen directionally, give pertinent data on subsurface locations and measured and true vertical depths. Give blowout preventer program, if any.

## 24.

Original Signed by

SIGNED MORRIS B. JONES M. B. Jones

TITLE Engineer

DATE May 18, 1965

(This space for Federal or State office use)

PERMIT NO.

APPROVAL DATE

APPROVED BY

TITLE

DATE

CONDITIONS OF APPROVAL, IF ANY:

**NEW MEXICO OIL CONSERVATION COMMISSION**  
**WELL LOCATION AND ACREAGE DEDICATION PLAT**

SECTION A

DATE May 12, 1965

OPERATOR Sherman F. Wagenseller LEASE Pecos Apache  
WELL NO. 1 UNIT LETTER J SECTION 16 TOWNSHIP 23 North RANGE 2 West NMFM  
LOCATED 1850 FEET FROM South LINE, 1650 FEET FROM East LINE  
COUNTY Rio Arriba G. L. ELEVATION 7300 DEDICATED ACREAGE 100 ACRES  
NAME OF PRODUCING FORMATION Pictured Cliffs POOL South Pecos

1. IS THE OPERATOR THE ONLY OWNER\* IN THE DEDICATED ACREAGE OUTLINED ON THE PLAT BELOW? YES ☒ NO ☐  
2. IF THE ANSWER TO QUESTION ONE IS "NO," HAVE THE INTERESTS OF ALL THE OWNERS BEEN CONSOLIDATED BY COMMUNITIZATION AGREEMENT OR OTHERWISE? YES ☐ NO ☐ IF ANSWER IS "YES," TYPE OF CONSOLIDATION \_\_\_\_\_

3. IF THE ANSWER TO QUESTION TWO IS "NO," LIST ALL THE OWNERS AND THEIR RESPECTIVE INTERESTS BELOW:
- | OWNER | INTEREST |
|-------|----------|
|       |          |
|       |          |
|       |          |
|       |          |

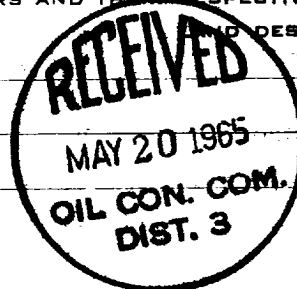

SECTION B.

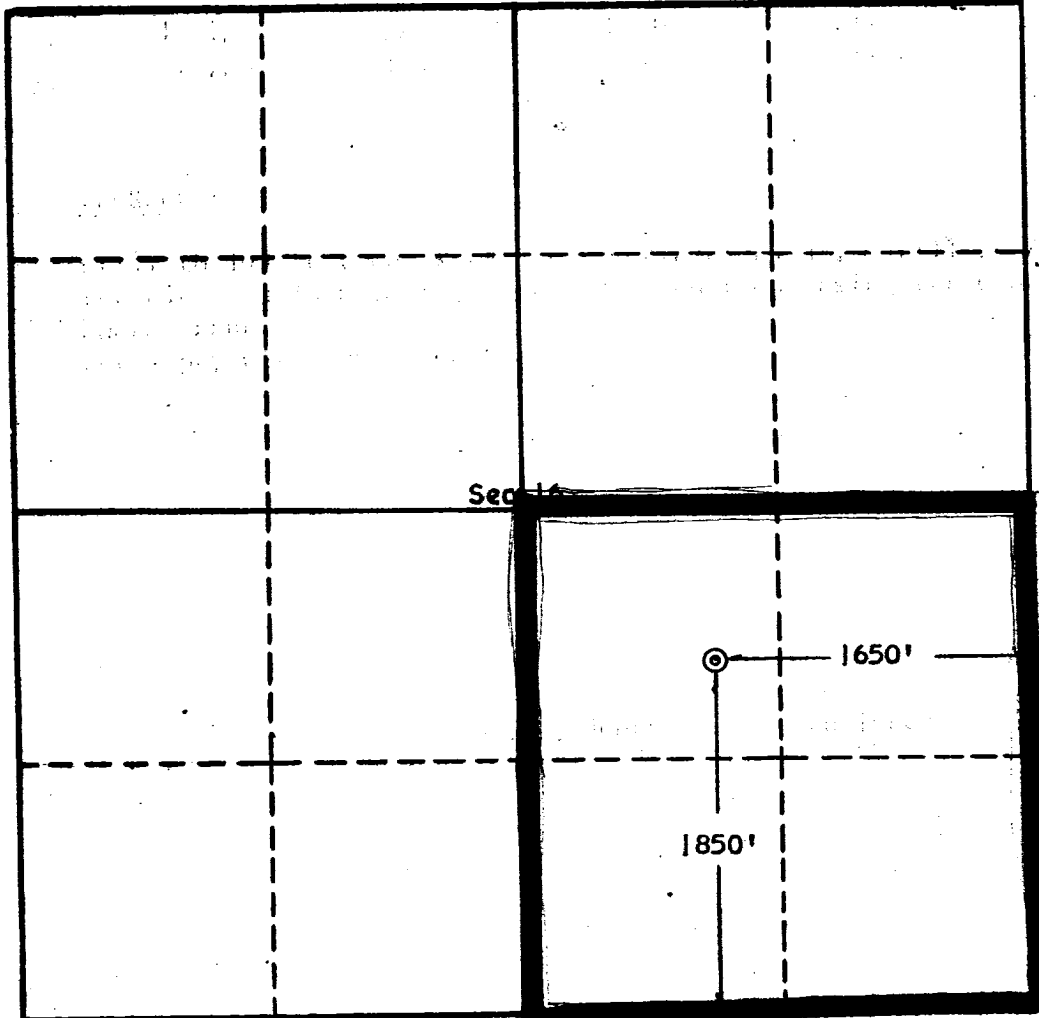

THIS IS TO CERTIFY THAT THE INFORMATION IN SECTION A ABOVE IS TRUE AND COMPLETE TO THE BEST OF MY KNOWLEDGE AND BELIEF.

SHERMAN F. WAGENSELLER

(OPERATOR)

Original Signed by

MORRIS B. JONES

(REPRESENTATIVE)

203 East of San Antonio St.,  
Albuquerque, New Mexico

THIS IS TO CERTIFY THAT THE WELL LOCATION SHOWN ON THE PLAT IN SECTION B WAS PLOTTED FROM FIELD NOTES OF ACTUAL SURVEYS MADE BY ME OR UNDER MY SUPERVISION AND THAT THE SAME IS TRUE AND CORRECT TO THE BEST OF MY KNOWLEDGE AND BELIEF.

DATE SURVEYED April 16, 1965

**FOUR STATES  
ENGINEERING CO.**

FARMINGTON, NEW MEXICO

Ernest V. Cochran

REGISTERED ENGINEER OR  
LAND SURVEYOR

CERTIFICATE NO. 3602

Scale, 1 inch = 1,000 feet