

(SUBMIT IN TRIPLICATE)

UNITED STATES
DEPARTMENT OF THE INTERIOR
GEOLOGICAL SURVEY

Indian Agency _____

~~Jicarilla Apache~~

Allottee ~~None~~

Lease No. ~~432~~

•			

SUNDRY NOTICES AND REPORTS ON WELLS

RECEIVED

NOTICE OF INTENTION TO DRILL <input checked="" type="checkbox"/>	SUBSEQUENT REPORT OF WATER SHUT-OFF	
NOTICE OF INTENTION TO CHANGE PLANS	SUBSEQUENT REPORT OF SHOOTING OR ACIDIZING	OCT 2 1959
NOTICE OF INTENTION TO TEST WATER SHUT-OFF	SUBSEQUENT REPORT OF ALTERING CASING	
NOTICE OF INTENTION TO REDRILL OR REPAIR WELL	SUBSEQUENT REPORT OF REDRILLING OR REPAIR	
NOTICE OF INTENTION TO SHOOT OR ACIDIZE	SUBSEQUENT REPORT OF ABANDONMENT	
NOTICE OF INTENTION TO PULL OR ALTER CASING	SUPPLEMENTARY WELL HISTORY	U. S. GEOLOGICAL SURVEY WASHINGTON, NEW MEXICO
NOTICE OF INTENTION TO ABANDON WELL		

(INDICATE ABOVE BY CHECK MARK NATURE OF REPORT, NOTICE, OR OTHER DATA)

September 21, 1959

Well No. P-2 is located 220 ft. from N line and 290 ft. from W line of sec. 18

NE 1/4 Sec. 18 (1/4 Sec. and Sec. No.) 23N 4W (Twp.) 101W (Range) MTM (Meridian)
Undesignated P.C. (Field) Rio Arriba (County or Subdivision) N.M. (State or Territory)

The elevation of the derrick floor above sea level is 6330 ft.

DETAILS OF WORK

(State names of and expected depths to objective sands; show sizes, weights, and lengths of proposed casings; indicate mudding jobs, cementing points, and all other important proposed work)

100' - 85/8" surface pipe, 70 sack cement.
2400' - 5 1/2" 14# production casing, 100 sack cement.

Objective Pictured Cliffs formation 2350'.
Hydrofract Pictured Cliffs with 40,000# sand.



I understand that this plan of work must receive approval in writing by the Geological Survey before operations may be commenced.

Company Sherman P. Wagenseeller

Address 170 S. Beverly Drive
Beverly Hills, Calif.

By Mary E. Gredel

Title Representative



NEW MEXICO OIL CONSERVATION COMMISSION

Well Location and Acreage Dedication Plat

Section A.

Date Sept. 20, 1959

Operator Sherris F. Wagonmiller
Well No. 1 Unit Letter Section 18 Township 23 North Range 4 West N.M.P.
Located 990' Feet From North Line, 990' Feet From West Line
County De Baca G. L. Elevation 6839 Dedicated Acreage 1.40 Acres
Name of Producing Formation San Juan Pool San Juan

1. Is the Operator the only owner* in the dedicated acreage outlined on the plat below?
Yes X No
2. If the answer to question one is "no," have the interests of all the owners been consolidated by communitization agreement or otherwise? Yes No . If answer is "yes,"
Type of Consolidation
3. If the answer to question two is "no," list all the owners and their respective interests below:

Owner

Land Description

Section B

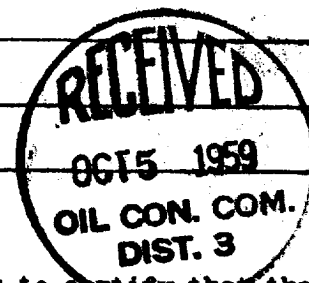
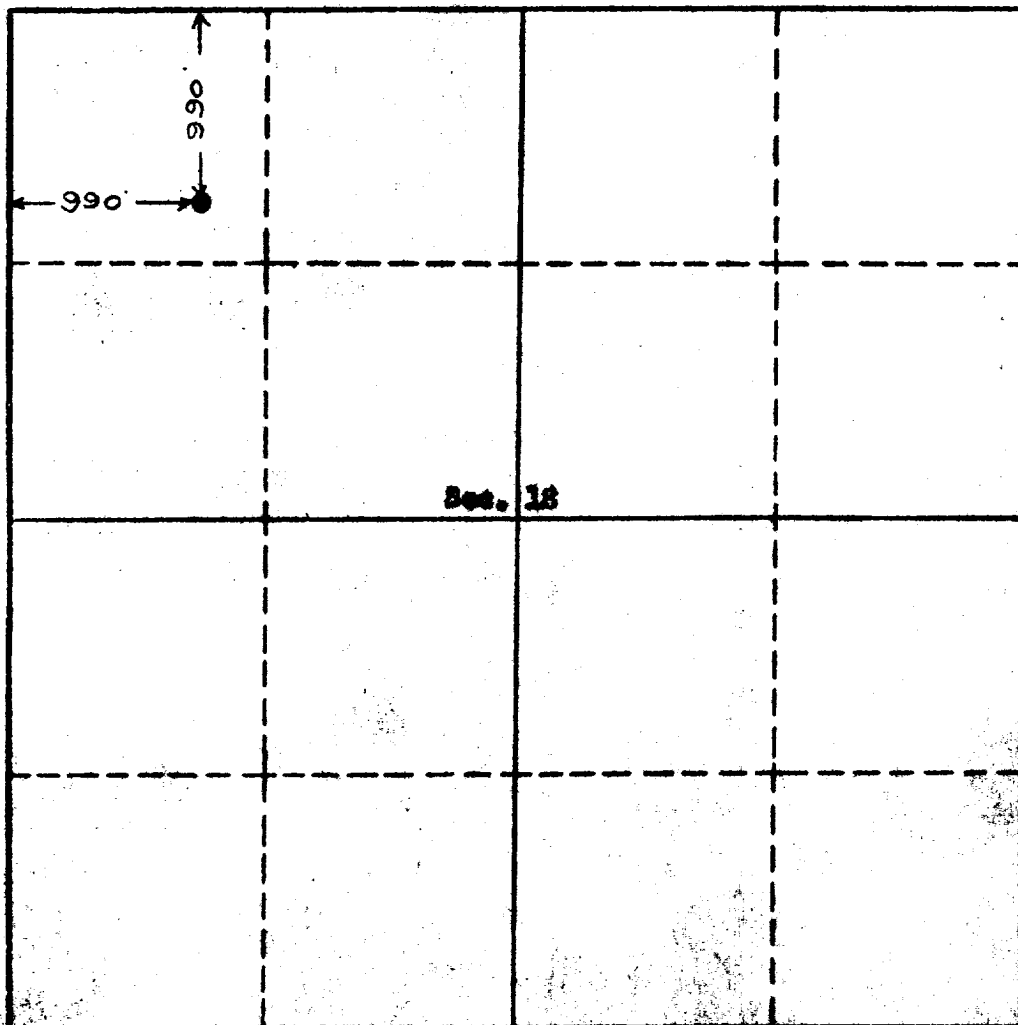

This is to certify that the information in Section A above is true and complete to the best of my knowledge and belief.

Sherris F. Wagonmiller

(Operator)

Mary Gradil
(Representative)
170 S. Beverly Drive
Beverly Hills, Calif.

Address

This is to certify that the well location shown on the plat in Section A is correct from field notes and all survey measurements and my supervision and to the best of my knowledge and belief.

Date Surveyed August 5, 1959

Ernest V. Echobayk
Ernest V. Echobayk
Registered Land Surveyor.

Certificate No. 1546

