

5 USGS
1 File

Budget Bureau No. 42-R358.4.
Approval expires 12-31-60.

Form 9-331a
(Feb. 1951)

(SUBMIT IN TRIPLICATE)

UNITED STATES
DEPARTMENT OF THE INTERIOR
GEOLOGICAL SURVEY

Land Office Santa Fe
Lease No. SF 078359
Unit _____

X				

SUNDRY NOTICES AND REPORTS ON WELLS

NOTICE OF INTENTION TO DRILL.....	<input checked="" type="checkbox"/>	SUBSEQUENT REPORT OF WATER SHUT-OFF.....
NOTICE OF INTENTION TO CHANGE PLANS.....		SUBSEQUENT REPORT OF SHOOTING OR ACIDIZING.....
NOTICE OF INTENTION TO TEST WATER SHUT-OFF.....		SUBSEQUENT REPORT OF ALTERING CASING.....
NOTICE OF INTENTION TO RE-DRILL OR REPAIR WELL.....		SUBSEQUENT REPORT OF RE-DRILLING OR REPAIR.....
NOTICE OF INTENTION TO SHOOT OR ACIDIZE.....		SUBSEQUENT REPORT OF ABANDONMENT.....
NOTICE OF INTENTION TO PULL OR ALTER CASING.....		SUPPLEMENTARY WELL HISTORY.....
NOTICE OF INTENTION TO ABANDON WELL.....		

RECEIVED
DEC 8 1959
U. S. GEOLOGICAL SURVEY
FARMINGTON, NEW MEXICO

(INDICATE ABOVE BY CHECK MARK NATURE OF REPORT, NOTICE, OR OTHER DATA)

December 7, 1959

VanDemburgh

Well No. **1-11** is located **790** ft. from **N** line and **890** ft. from **E** line of sec. **11**

SW/4 SW/4 Sec. 11
(1/4 Sec. and Sec. No.)

23N
(Twp.)

7W
(Range)

NMPM
(Meridian)

Wildcat
(Field)

Rio Arriba
(County or Subdivision)

New Mexico
(State or Territory)

Ground Level

The elevation of the ~~surface~~ above sea level is **7108** ft.

DETAILS OF WORK

(State names of and expected depths to objective sands; show sizes, weights, and lengths of proposed casings; indicate mudding jobs, cementing points, and all other important proposed work)

A 12" hole will be drilled to approximately 200' and 8-5/8" O.D. 24# casing will be run and cemented with 200 sx. A 7-5/8" hole will be drilled to a total depth of approximately 3730' to test the Gallup formation. In the event commercial production is encountered in the Gallup formation production casing will be run and the well sand-water fractured, tubing run and the well completed.

I understand that this plan of work must receive approval in writing by the Geological Survey before operations may be commenced.

Company **Val R. Reese & Assoc, Inc.**

Address **Lobby of Simms Bldg.**

Albuquerque, N. Mex.

By John S. Jacobs
Title **Geologist**

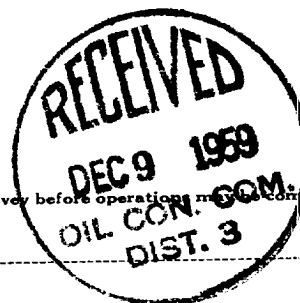

NEW MEXICO OIL CONSERVATION COMMISSION

Well Location and Acreage Dedication Plat

Section A.

Date 12-7-59

Operator Val R. Reese and Associates, Inc. Lease VanDunbar
Well No. 1-11 Unit Letter M Section 11 Township 23 North Range 7 West NMPM
Located 790 Feet From South Line, 890 Feet From West Line
County Rio Arriba G. L. Elevation 7108 Dedicated Acreage 60 Acres
Name of Producing Formation Gallup Pool Wildcat

1. Is the Operator the only owner* in the dedicated acreage outlined on the plat below?
Yes X No
2. If the answer to question one is "no," have the interests of all the owners been consolidated by communitization agreement or otherwise? Yes No . If answer is "yes,"
Type of Consolidation
3. If the answer to question two is "no," list all the owners and their respective interests below:

Owner

Land Description

Section. B

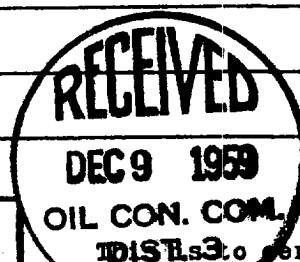
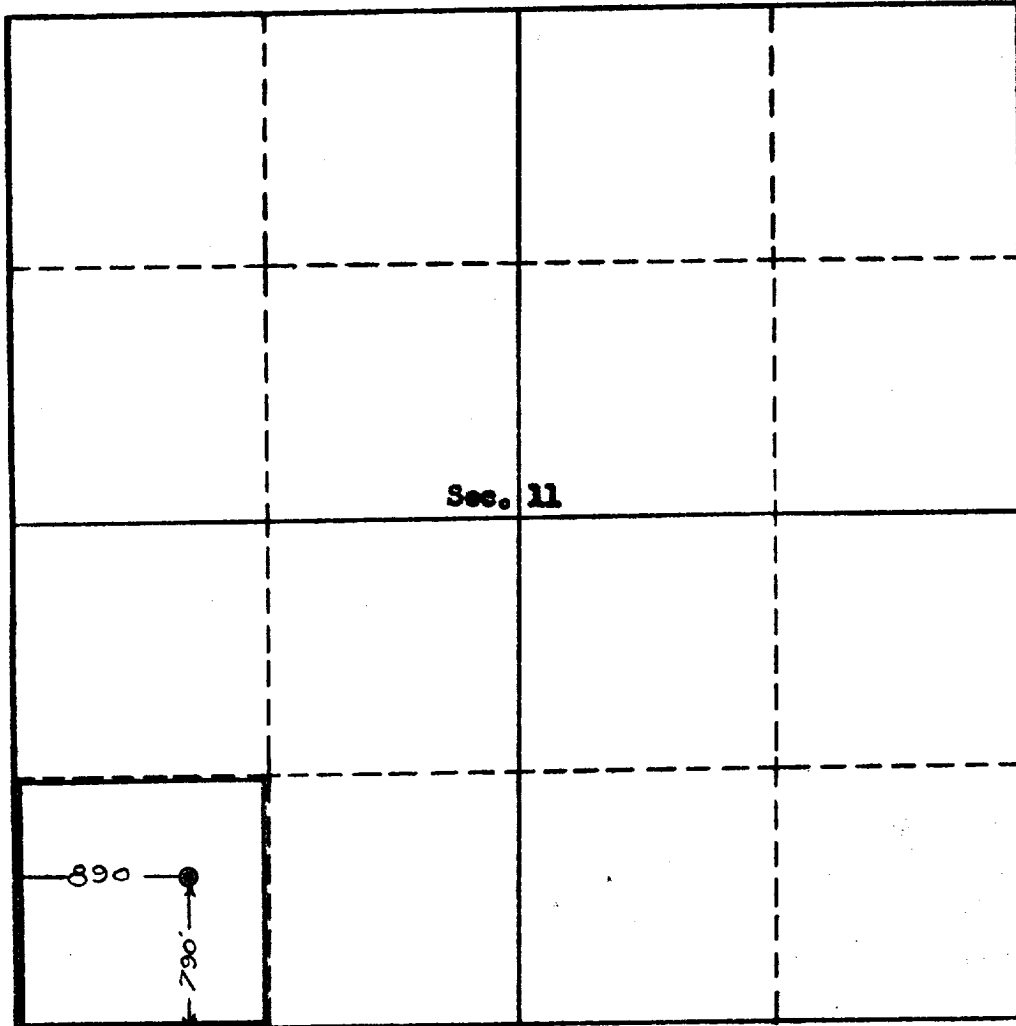

DIS: To certify that the information in Section A above is true and complete to the best of my knowledge and belief.

Val R. Reese & Assoc., Inc.
(Operator)

James S. Jacobs
(Representative)

Lobby of Starns Bldg.

Address
Albuquerque, N. Mex.

This is to certify that the well location on the plat is correct as determined from field notes of actual survey made by me or under my supervision and that the same is true to the best of my knowledge and belief.

Date Surveyed Nov. 24, 1959

Ernest V. Echobawk
Ernest V. Echobawk
Registered Land Surveyor.

Certificate No. 1545

