

NEW MEXICO
OIL CONSERVATION COMMISSION

Form C-128

Well Location and/or Gas Proration Plat

Date 5-15-56

Operator HUMBLE OIL & REFINING COMPANY Lease JICARILLA APACHE TRIBE OF INDIANS "G"

Well No. 1 Section 8 Township - 23 - N Range - 5 - W NMPM

Located 990 Feet From NORTH Line, 990 Feet From EAST Line,

RIO ARRIBA County, New Mexico. G. L. Elevation _____

OTERO

Name of Producing Formation PICTURED CLIFFS Pool PICTURED CLIFFS Dedicated Acreage 160

(Note: All distances must be from outer boundaries of Section)

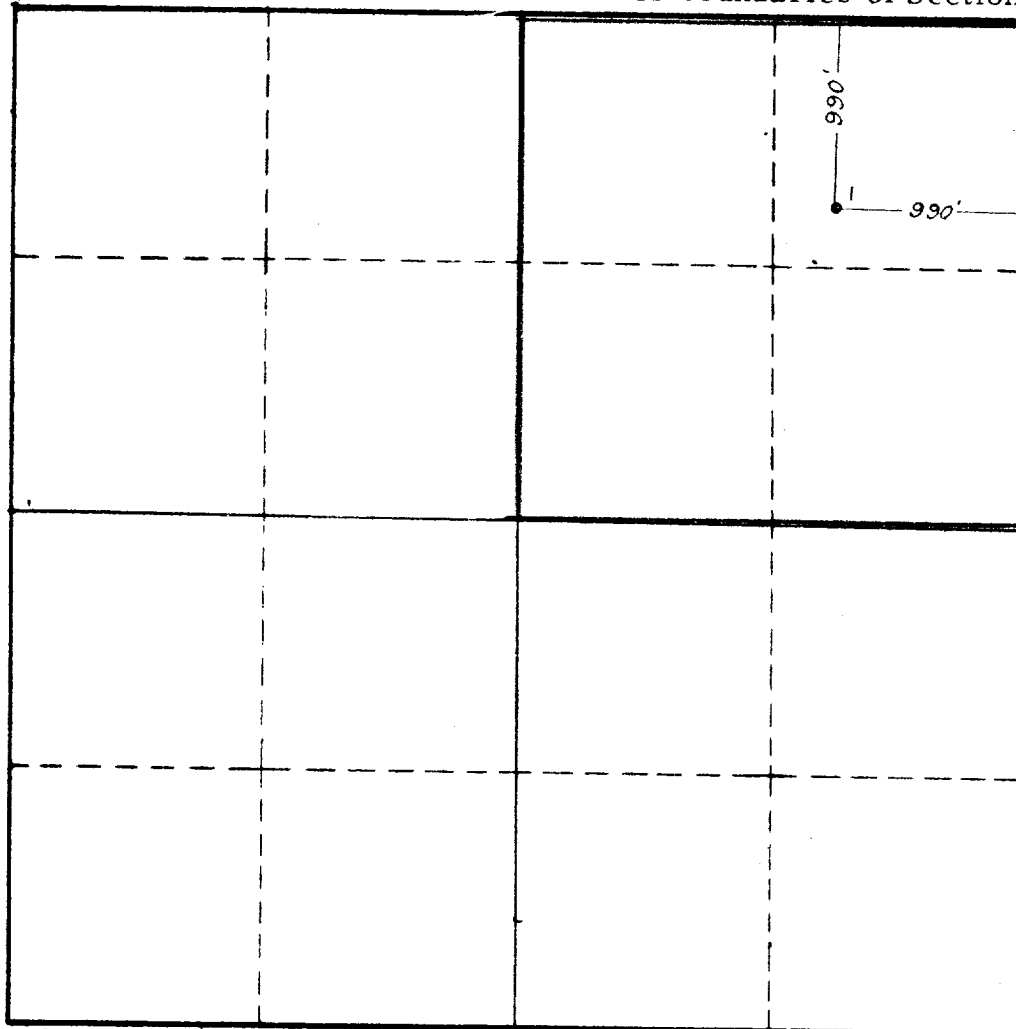

SCALE: 1" = 1000'



1. Is this Well a Dual Comp. ? ~~Yes~~ No.
2. If the answer to Question 1 is yes, are there any other dually completed wells within the dedicated acreage? Yes _____ No _____.

This is to certify that the above plat was prepared from field notes of actual surveys made by me or under my supervision and that the same are true and correct to the best of my knowledge and belief.

Name N. L. Henole
Position ASSISTANT DIVISION SUPERINTENDENT
Representing HUMBLE OIL & REFINING COMPANY
Address BOX 1600, MIDLAND, TEXAS

Date Surveyed 9-6-55
E. T. Shahan
Registered Professional Engineer and/or
Land Surveyor
Lease 166395
Contract No. _____

OIL CONSERVATION COMMISSION
ATTENDING OFFICIAL
 No. 100
 U. S. G. S.
 Transferred
 Eng.