

UNITED STATES  
DEPARTMENT OF THE INTERIOR  
GEOLOGICAL SURVEY

30-039-21099

5. LEASE DESIGNATION AND SERIAL NO.

NM 084735

6. IF INDIAN, ALLOTTEE OR TRIBE NAME

7. UNIT AGREEMENT NAME

8. FARM OR LEASE NAME

REGINA

9. WELL NO.

#4

10. FIELD AND POOL, OR WILDCAT

South Blanco, PC

11. SEC., T., R., M., OR BLK.  
AND SURVEY OR AREA

Sec. 8 T23N R1W

12. COUNTY OR PARISH

Rio Arriba

13. STATE

New Mexico

## APPLICATION FOR PERMIT TO DRILL, DEEPEN, OR PLUG BACK

1a. TYPE OF WORK

DRILL ☒DEEPEN ☐PLUG BACK ☐

b. TYPE OF WELL

OIL  
WELL ☐GAS  
WELL ☒

OTHER

SINGLE  
ZONE ☒MULTIPLE  
ZONE ☐

2. NAME OF OPERATOR

LYNCO OIL CORPORATION

3. ADDRESS OF OPERATOR

7890 E. Prentice Ave. Englewood, Colorado 80110

4. LOCATION OF WELL (Report location clearly and in accordance with any State requirements.)\*

At surface

1090' FNL &amp; 1850' FEL

At proposed prod. zone

SAME

14. DISTANCE IN MILES AND DIRECTION FROM NEAREST TOWN OR POST OFFICE\*

4 miles North of Regina, New Mexico

15. DISTANCE FROM PROPOSED\*

LOCATION TO NEAREST  
PROPERTY OR LEASE LINE, FT.  
(Also to nearest drlg. line, if any)

790'

16. NO. OF ACRES IN LEASE

160

17. NO. OF ACRES ASSIGNED  
TO THIS WELL

160

18. DISTANCE FROM PROPOSED LOCATION\*  
TO NEAREST WELL, DRILLING, COMPLETED,  
OR APPLIED FOR, ON THIS LEASE, FT.

850'

19. PROPOSED DEPTH

3400

20. ROTARY OR CABLE TOOLS

Rotary

21. ELEVATIONS (Show whether DF, RT, GR, etc.)

7439 GR

22. APPROX. DATE WORK WILL START\*

May 15, 1975

23.

## PROPOSED CASING AND CEMENTING PROGRAM

SIZE OF HOLE	SIZE OF CASING	WEIGHT PER FOOT	SETTING DEPTH	QUANTITY OF CEMENT
12 1/4"	8 5/8"	24#	100'	100 sxs. Circulate
6 3/4"	2 7/8"	6.4#	3400	200 sxs.

Drill 12 1/4" hole to 100 feet. Set 8 5/8" surface casing at 100 feet and circulate cement to surface using 100 sacks. Mud drill 6 3/4" hole to 3400 feet. Run 2 7/8" casing to 3300 feet and cement with 200 sacks. Perforate and sand water frac Pictured Cliffs sand. Test and complete well.

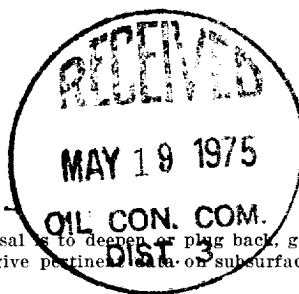

IN ABOVE SPACE DESCRIBE PROPOSED PROGRAM: If proposal is to deepen or plug back, give data on present productive zone and proposed new productive zone. If proposal is to drill or deepen directionally, give pertinent data on subsurface locations and measured and true vertical depths. Give blowout preventer program, if any.

24. ORIGINAL SIGNED BY  
E. L. FUNDINGSLAND, JR.

SIGNED

TITLE

Vice President

DATE

4-29-75

(This space for Federal or State office use)

PERMIT NO.

APPROVAL DATE

APPROVED BY

TITLE

DATE

CONDITIONS OF APPROVAL, IF ANY:

## Instructions

**General:** This form is designed for submitting proposals to perform certain well operations, as indicated, on all types of lands and leases for appropriate action by either a Federal or a State agency, or both, pursuant to applicable Federal and/or State laws and regulations. Any necessary special instructions concerning the use of this form and the number of copies to be submitted, particularly with regard to local, area, or regional procedures and practices, either are shown below or will be issued by, or may be obtained from, the local Federal and/or State office.

**Item 1:** If the proposal is to redrill to the same reservoir at a different subsurface location or to a new reservoir, use this form with appropriate notations. Consult applicable State or Federal regulations concerning subsequent work proposals or reports on the well.

**Item 4:** If there are no applicable State requirements, locations on Federal or Indian land should be described in accordance with Federal requirements. Consult local State or Federal office for specific instructions.

**Item 14:** Needed only when location of well cannot readily be found by road from the land or lease description. A plat, or plats, separate or on this reverse side, showing the roads to, and the surveyed location of, the well, and any other required information, should be furnished when required by Federal or State agency offices.

**Items 15 and 18:** If well is to be, or has been directionally drilled, give distances for subsurface location of hole in any present or objective production zone.

**Item 22:** Consult applicable Federal or State regulations, or appropriate officials, concerning approval of the proposal before operations are started.

NEW MEXICO OIL CONSERVATION COMMISSION  
WELL LOCATION AND ACREAGE DEDICATION PLAT

Form C-102  
Supersedes C-128  
Effective 1-1-65

All distances must be from the outer boundaries of the Section.

Operator <b>Lynco Oil Corporation</b>		Lease		Well No. <b>Regina #4</b>	
Unit Letter <b>B</b>	Section <b>8</b>	Township <b>23 North</b>	Range <b>1 West</b>	County <b>Rio Arriba</b>	
Actual Footage Location of Well: <b>1090</b> feet from the <b>North</b> line and <b>1850</b> feet from the <b>East</b> line					
Ground Level Elev. <b>7439</b>	Producing Formation <b>PICTURED CLIFFS</b>	Pool <b>SOUTH BLANCO PC</b>	Dedicated Acreage: <b>160</b> Acres		

1. Outline the acreage dedicated to the subject well by colored pencil or hachure marks on the plat below.
2. If more than one lease is dedicated to the well, outline each and identify the ownership thereof (both as to working interest and royalty).
3. If more than one lease of different ownership is dedicated to the well, have the interests of all owners been consolidated by communitization, unitization, force-pooling, etc?  
  
☐ Yes   ☐ No   If answer is "yes," type of consolidation \_\_\_\_\_  
 If answer is "no," list the owners and tract descriptions which have actually been consolidated. (On reverse side of this form if necessary.) \_\_\_\_\_  
 No allowable will be assigned to the well until all interests have been consolidated (by communitization, unitization, forced-pooling, or otherwise) or until a non-standard unit, eliminating such interests, has been approved by the Commission.

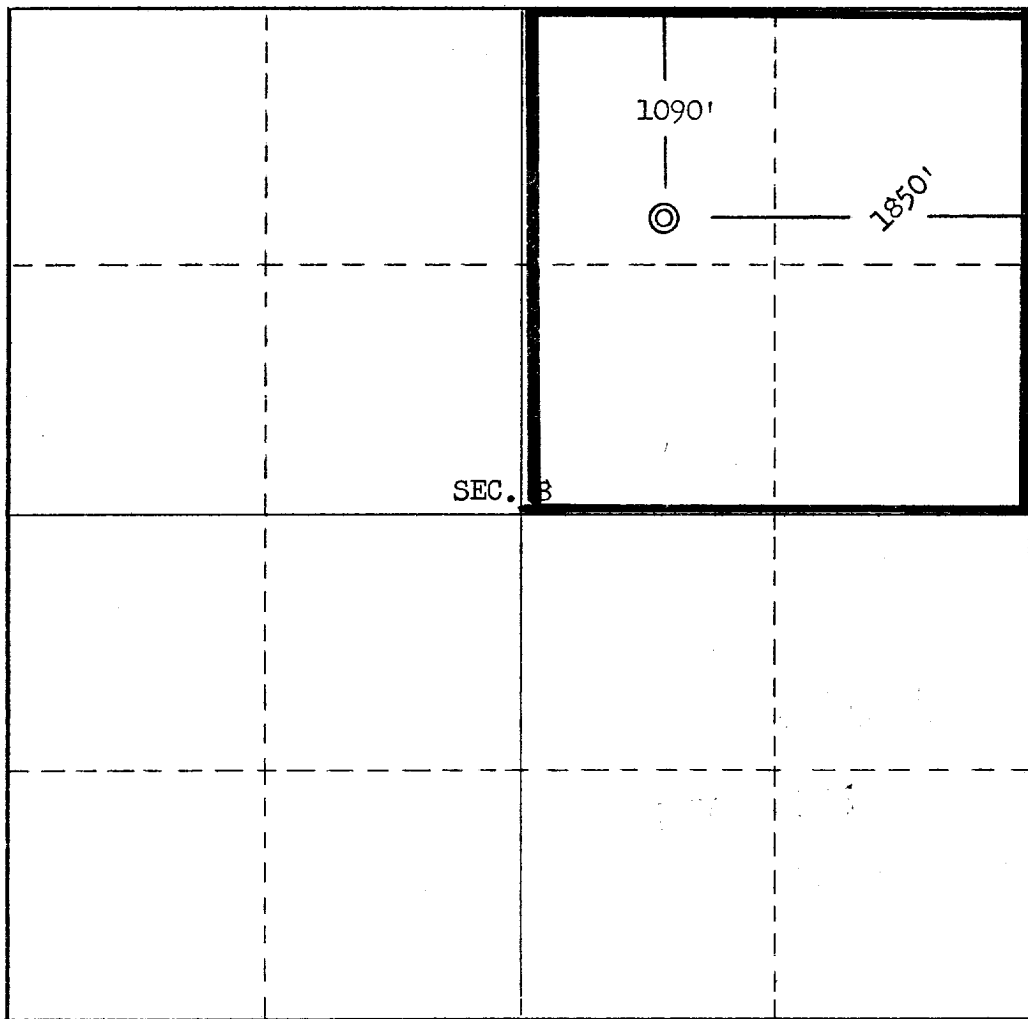
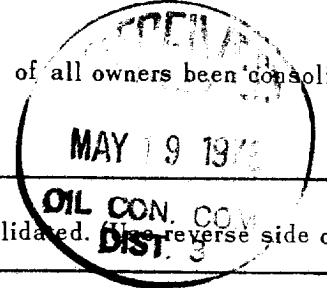

**CERTIFICATION**

I hereby certify that the information contained herein is true and complete to the best of my knowledge and belief.

Name  
**E. L. FUNDINGS LAND, JR.**

Position  
**VICE PRESIDENT**

Company  
**LYNCO OIL CORPORATION**

Date  
**APRIL 28, 1975**

I hereby certify that the well location shown on this plat was plotted from field notes of actual surveys made by me or under my supervision, and that the same is true and correct to the best of my knowledge and belief.

**REGISTERED LAND SURVEYOR**  
Reg. No. **3602**  
**W. ECHOHAWK**  
**HERBERT V. ECHOHAWK**

Date Surveyed  
**April 22, 1975**

Registered Professional Engineer and/or Land Surveyor  
**E. V. Echohawk**

Certificate No. **3602**  
**E. V. Echohawk LS**