

UNITED STATES
DEPARTMENT OF THE INTERIOR
GEOLOGICAL SURVEY

APPLICATION FOR PERMIT TO DRILL, DEEPEN, OR PLUG BACK

1a. TYPE OF WORK
DRILL ☒ DEEPEN ☐ PLUG BACK ☐b. TYPE OF WELL
OIL WELL ☒ GAS WELL ☐ OTHER ☐
SINGLE ZONE ☒ MULTIPLE ZONE ☐

2. NAME OF OPERATOR

Dietrich Exploration Company

3. ADDRESS OF OPERATOR

80202
602 Midland Savings Bldg., 444 Seventeenth St, Denver, CO4. LOCATION OF WELL (Report location clearly and in accordance with any State requirements.*)
At surface

480' FNL & 1680' FWL

At proposed prod. zone

same

14. DISTANCE IN MILES AND DIRECTION FROM NEAREST TOWN OR POST OFFICE*

15. DISTANCE FROM PROPOSED*
LOCATION TO NEAREST
PROPERTY OR LEASE LINE, FT.
(Also to nearest drg. unit line, if any)16. NO. OF ACRES IN LEASE
16017. NO. OF ACRES ASSIGNED
TO THIS WELL 4018. DISTANCE FROM PROPOSED LOCATION*
TO NEAREST WELL, DRILLING, COMPLETED,
OR APPLIED FOR, ON THIS LEASE, FT.19. PROPOSED DEPTH
5500

20. ROTARY OR CABLE TOOLS

rotary

21. ELEVATIONS (Show whether DF, RT, GR, etc.)

22. APPROX. DATE WORK WILL START*

November 28, 1977

23.

PROPOSED CASING AND CEMENTING PROGRAM

SIZE OF HOLE	SIZE OF CASING	WEIGHT PER FOOT	SETTING DEPTH	QUANTITY OF CEMENT
12 1/4	8 5/8	24	300	200 sacks
7 7/8	4 1/2	10.5		400 sacks

Drill 12 1/4 hole and set 8 5/8 casing as above. A 10" 900 series blow out preventer will be installed and tested to 1000 psi (schematic attached). Auxiliary equipment will include a bit float and full opening stabbing valve at the surface.

A 7 7/8 " hole will be drilled from under surface using a low solids, non-dispersed mud with wt 8.5-8.9, viscosity 34-40, and w.l. of 8-10 cc.

Open hole logs will consist of Dual Induction Lateral Log and formation Density log, with Gamma Ray and Caliper.

No abnormal temperatures, pressures or hazardous gases are anticipated.

Should the well be commercial, 4 1/2" casing will be run and set as above.

IN ABOVE SPACE DESCRIBE PROPOSED PROGRAM: If proposal is to deepen or plug back, give data on present productive zone and proposed new productive zone. If proposal is to drill or deepen directionally, give pertinent data on subsurface locations and measured and true vertical depths. Give blowout preventer program, if any.

24.

SIGNED

John Alexander
John Alexander

TITLE

Agent

DATE

11-22-77

PERMIT NO.

APPROVAL DATE

APPROVED BY

TITLE

DATE

CONDITIONS OF APPROVAL, IF ANY:

OK

*See Instructions On Reverse Side

U. S. GEOLOGICAL SURVEY
DENVER, COLO.

NOV 23 1977

RECEIVED

NEW MEXICO OIL CONSERVATION COMMISSION
WELL LOCATION AND ACREAGE DEDICATION PLAT

Form C-102
Supersedes C-128
Effective 1-1-65

All distances must be from the outer boundaries of the Section.

Operator Dietrich Exploration Co., Inc.			Lease Hat-Tah-E-Yazza		Well No. 1
Unit Letter C	Section 8	Township 23N	Range 7W	County Rio Arriba	
Actual Footage Location of Well: 480 feet from the North line and 1680 feet from the West line					
Ground Level Elev. 7054	Producing Formation Gallup		Pool Lybrook Gallup Extension	Dedicated Acreage: 40 Acres	

1. Outline the acreage dedicated to the subject well by colored pencil or hachure marks on the plat below.
2. If more than one lease is dedicated to the well, outline each and identify the ownership thereof (both as to working interest and royalty).
3. If more than one lease of different ownership is dedicated to the well, have the interests of all owners been consolidated by communitization, unitization, force-pooling, etc?

☐ Yes ☐ No If answer is "yes," type of consolidation _____

If answer is "no," list the owners and tract descriptions which have actually been consolidated. (Use reverse side of this form if necessary.) _____

No allowable will be assigned to the well until all interests have been consolidated (by communitization, unitization, forced-pooling, or otherwise) or until a non-standard unit, eliminating such interests, has been approved by the Commission.

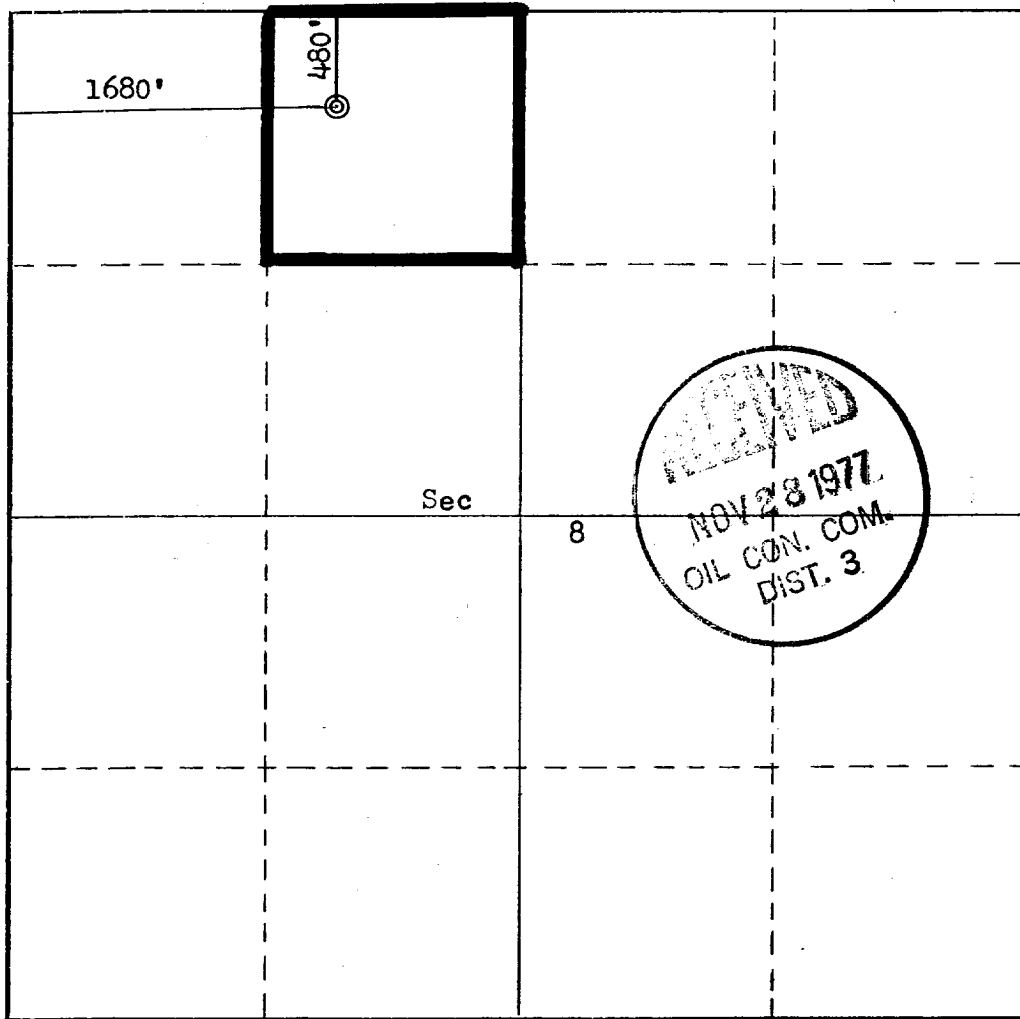

CERTIFICATION

I hereby certify that the information contained herein is true and complete to the best of my knowledge and belief.

John Alexander
Name
John Alexander

Position
Agent

Company
Dietrich Exploration Company

Date
November 22, 1977

I hereby certify that the well location shown on this plat was plotted from field notes of actual surveys made by me or under my supervision, and that the same is true and correct to the best of my knowledge and belief.

Date Surveyed
November 22, 1977

Registered Professional Engineer
and/or Land Surveyor

Fred B. Kerr Jr.
Fred B. Kerr Jr.

Certificate No.
3950

0 330 660 990 1320 1650 1980 2310 2640 2000 1500 1000 500 0

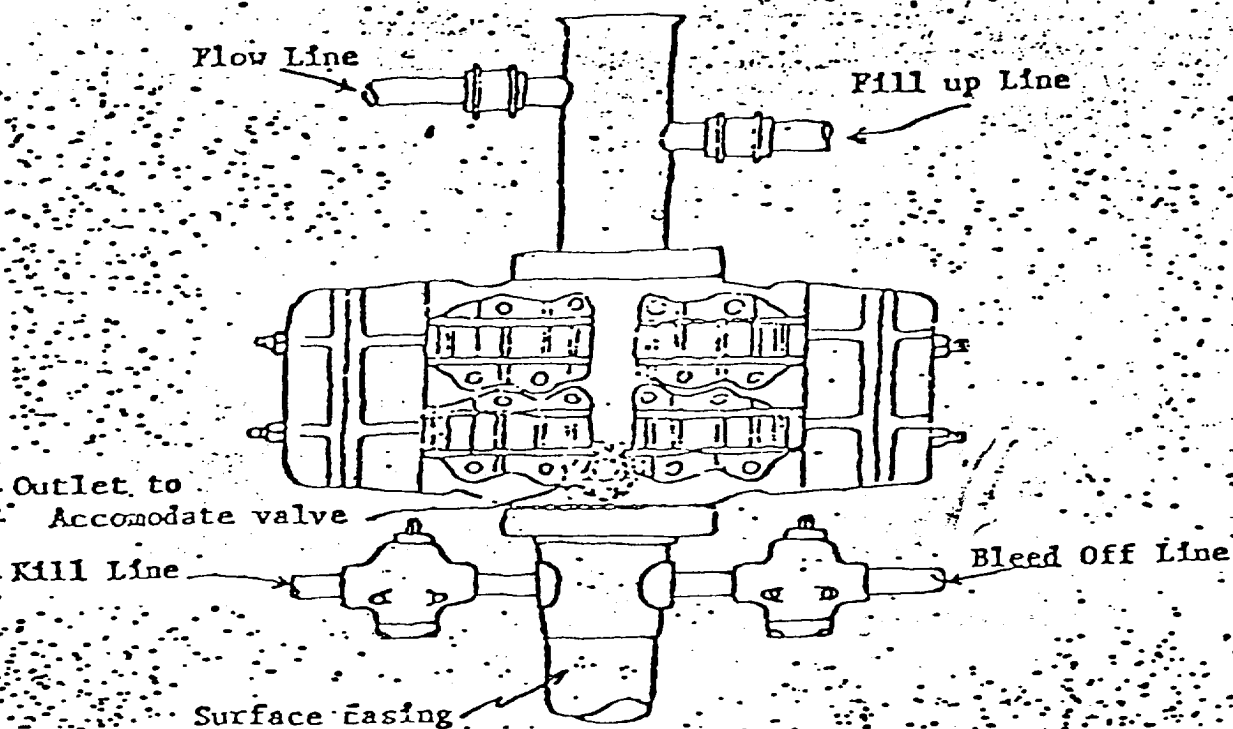

Blowout preventer is Shaffer double hydraulic equipped with drill pipe rams in the top and blind rams in the bottom.

Blowout preventer closing unit is Koomey 30 gallon accumulator unit.

When choke manifold is used, it will be installed downstream from bleed off valve.

Kill line or bleed off line may be installed at flanged opening in blowout preventer.

3E COMPANY, INC.

Engineering • Energy • Exploration

P. O. Box 190 —:— 505/327-4020

FARMINGTON, NEW MEXICO 87401

November 22, 1977

U.S. Department of Interior
Geological Survey
P.O. Box 1809
Durango, CO 81301

Attention: Mr. Jerry Long
District Engineer

RE: Development Plan for Surface Use
Dietrich Exploration Company
Hat Tah E Yazza #1
480' FNL & 1680' FWL
Sec 8, T23N, R7W
Lybrook Gallup Extension
Rio Arriba County, New Mexico

Gentlemen:

Attached is the "Application for Permit to Drill" (form #9-331C) for the subject well. Also attached is the surveyor's plat, drill site plat, and vicinity map.

The development plan for surface use is as follows:

Points 1, 3, 4, 6, & 9 Vicinity map and drill site plat attached.

Point 2. Water bars will be used on all roads where necessary.

Point 5. Water will be hauled from Lybrook approximately 2 miles to the south.

Point 7. A waste disposal pit will be provided for garbage and trash. Its location is shown on the drill site plat. Drilling fluids will be contained in the reserve pit until such time as evaporation occurs and then pits will be covered.

Point 8. No camps or airstrip.

Point 10. Should the well be a commercial producer, it will be equipped to facilitate producing operations with all drilling pits filled, location leveled and well site reseeded. During dry out time, reserve pit will be fenced to prevent livestock entry. All facilities will be painted grey: Federal Standard 595-36357.

Point 11. This location is on Navajo allotted land. It is situated in a flat area. Native vegetation is mainly sage brush. An existing trail to the north of the location will be improved to provide access.

Point 12.

John Alexander
3E Company, Inc.
P.O. Box 190
Farmington, New Mexico 87401
Phone: 505-327-4020

Point 13. I hereby certify that I or persons under my direct supervision, have inspected the proposed drill site and access route; that I am familiar with the conditions which presently exist; that the statements made in this plan are to the best of my knowledge, true and correct; and, that the work associated with the operations proposed herein will be performed by Dietrich Exploration Company and its contractors and sub-contractors in conformity with this plan and the terms and conditions under which it is approved.

November 22, 1977

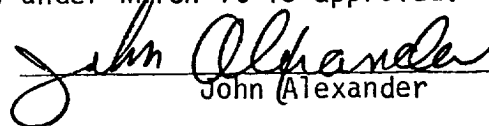
John Alexander

Should further information be desired, please advise.

Sincerely yours,

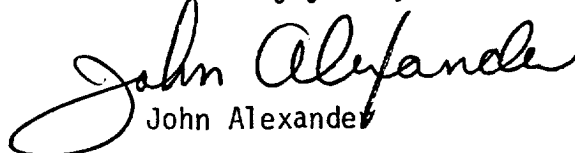
John Alexander

JA:st

Attachments

3E COMPANY, INC.

Engineering • Energy • Exploration

P. O. BOX 190 — 505/327-4020

FARMINGTON, NEW MEXICO 87401

DIETRICH EXPLORATION COMPANY

HAT TAH E YAZZA #1

480' FNL & 1680' FWL

Sec 8, T23N, R7W

Rio Arriba County, New Mexico

FORMATION TOP ESTIMATION

GL 7054' - DF 7067'

Pictured Cliff	2017 (+5050)
Cliff House	3367 (+3700)
Point Lookout	4322 (+2745)
Mancos	4542 (+2525)
Gallup	5347 (+1720)

Well site Plat

access road

300'

earthen.
reserve
Pit

S-100-1-3

d-p-l-s

KEEP OUT

R
I
G

NORTH

200'

scale 1"=40'

DIETRICH EXPLORATION COMPANY

HAT TAH E YAZZA #1

480' FNL & 1680' FWL

Sec 8, T23N, R7W

Lybrook Gallup Extension

Rio Arriba County, New Mexico

