

SUBMIT 1 COPY TO  
NATURAL  
RESOURCE DEPT  
AND OIL -GAS  
ADMINISTRATION

## PIT REMEDIATION AND CLOSURE REPORT

<b>Operator:</b> <u>PNM Gas Services (Bayless)</u>		<b>Telephone:</b> <u>324-3764</u>	
<b>Address:</b> <u>603 W. Elm Street Farmington, NM 87401</u>			
<b>Facility or Well Name:</b> <u>Axi Apache A-10</u>			
<b>Location:</b>	Unit: <u>0</u>	Sec. <u>10</u>	T. <u>23</u> N R. <u>5</u> W County <u>Rio Arriba</u>
<b>Pit Type:</b>	Separator <input checked="" type="checkbox"/>	Dehydrator <input type="checkbox"/>	Other <input type="checkbox"/>
<b>Land Type:</b> <u>Jicarilla Apache</u>			

<b>Pit Location:</b>	<b>Pit dimensions:</b>	length <u>20'</u>	width <u>15'</u>	depth <u>12'</u>
(Attach diagram)	<b>Reference:</b>	wellhead <input checked="" type="checkbox"/>	other <input type="checkbox"/>	
	<b>Footage from reference:</b>	<u>75'</u>		
	<b>Direction from reference:</b>	<u>Straight</u> Degrees <u>    </u> East <u>    </u> North <u>    </u>	of <u>    </u> South <u>    </u>	
		<u>X</u> West <u>    </u>		

<b>Depth to Ground Water:</b> <small>(Vertical distance from contaminants to seasonal high water elevation or ground water)</small>	Less than 50 feet	(20 points)	<u>0</u>
	50 feet to 99 feet	(10 points)	
	Greater than 100 feet	(0 points)	
<b>Wellhead Protection Area:</b> <small>(Less than 200 feet from a private domestic water source, or, less than 1,000 feet from all other water sources)</small>	Yes	(20 points)	<u>0</u>
	No	(0 points)	
<b>Distance to Surface Water:</b> <small>(Horizontal distance to perennial lakes, ponds, rivers, streams, creeks, irrigation canals and ditches)</small>	Less than 200 feet	(20 points)	
	200 feet to 1,000 feet	(10 points)	<u>0</u>
	Greater than 1,000 feet	(0 points)	
<b>Distance to Ephemeral Stream (dry wash):</b> <small>(Horizontal distance to all downgradient streams having a width of at least 10 feet)</small>	Less than or equal to 100 feet	(10 points)	
	Greater than 100 feet	(0 points)	<u>0</u>
<b>Distance to Nearest Lake, Playa, or Watering Pond:</b> <small>(Horizontal distance to all downgradient lakes, playas, and livestock or wildlife water ponds)</small>	Less than or equal to 100 feet	(10 points)	
	Greater than 100 feet	(0 points)	<u>0</u>
<b>RANKING SCORE (TOTAL POINTS):</b>			<u>0</u>

Date Remediation Started: 10/8/96 Date Completed: 11-14-96

Remediation Method: Excavation X Approx. Cubic Yards 133

(Check all appropriate sections) Landfarmed X Amount Landfarmed (cubic yds): 133

Other \_\_\_\_\_

Remediation Location: Onsite X Offsite \_\_\_\_\_

(i.e., landfarmed onsite, name and location of offsite facility)

General Description of Remedial Action:

Removed contaminated soil from all four side walls as to get a below 100 ppm head space reading. Bottom was solid rock.

Ground Water Encountered: No X Yes \_\_\_\_\_ Depth \_\_\_\_\_

Final Pit Closure Sampling:

Sample Location North, East, South and West side walls

(if multiple samples, attach sample result and diagram of sample locations and depths.)

Sample depth 11'

Sample date 10/8/96 Sample time 1650

Sample Results

Soil: Benzene (ppm) 0.0016 Water: Benzene (ppb) \_\_\_\_\_

Total BTEX (ppm) 0.0188 Toluene (ppb) \_\_\_\_\_

Field headspace (ppm) 17.6 Ethylbenzene (ppb) \_\_\_\_\_

TPH <5.0 ppm Method 8015 Total Xylenes (ppb) \_\_\_\_\_

Ground Water Sample: Yes \_\_\_\_\_ No X (If yes, attach sample results)

I HEREBY CERTIFY THAT THE INFORMATION ABOVE IS TRUE AND COMPLETE TO THE BEST OF MY KNOWLEDGE AND MY BELIEF

DATE 10/11/96

PRINTED NAME Roy Burnham

SIGNATURE Roy Burnham

AND TITLE Environmental Technician II

AFTER REVIEW OF THE PIT CLOSURE INFORMATION, PIT CLOSURE IS APPROVED IN ACCORDANCE TO JICARILLA APACHE TRIBE PIT CLOSURE ORDINANCE.

APPROVED: YES ✓ NO \_\_\_\_\_ (REASON): Spray / Close

SIGNED: Gabriel J. [Signature] DATE: 10/15/96

Sec. 10 T23N R5W  
Bay 1255

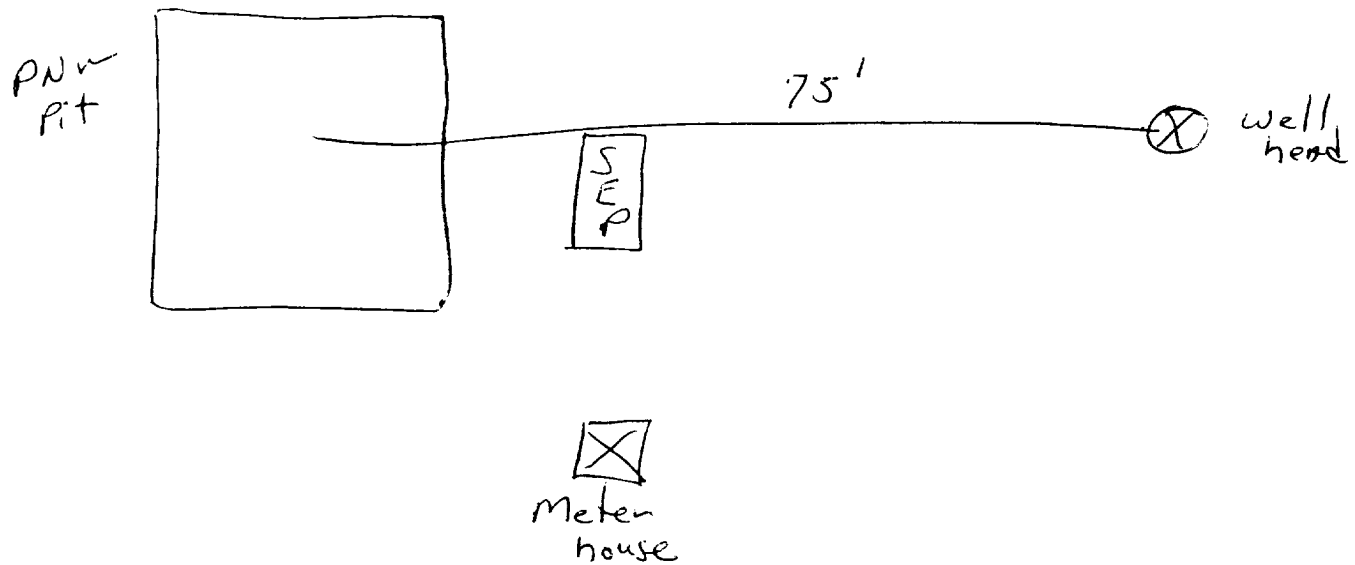

OFF: (505) 325-5667



LAB: (505) 325-1556

### *Diesel Range Organics*

Attn: *Denver Bearden*  
Company: *PNM Gas Services*  
Address: *603 W. Elm*  
City, State: *Farmington, NM 87401*

Date: *11-Oct-96*  
COC No.: *5341*  
Sample No. *12545*  
Job No. *2-1000*

Project Name: *PNM Gas Services - Axi Apache A-10 Run 116*  
Project Location: *9610081650; 4pt. Composite*  
Sampled by: *PA* Date: *8-Oct-96* Time: *16:50*  
Analyzed by: *DC/HR* Date: *11-Oct-96*  
Sample Matrix: *Soil*

### *Laboratory Analysis*

<i>Parameter</i>	<i>Result</i>	<i>Unit of Measure</i>	<i>Detection Limit</i>	<i>Unit of Measure</i>
<i>Diesel Range Organics (C10 - C28)</i>	<i>&lt;5.0</i>	<i>mg/kg</i>	<i>5.0</i>	<i>mg/kg</i>

### *Quality Assurance Report*

DRO QC No.: *0489-QC*

### *Calibration Check*

<i>Parameter</i>	<i>Method Blank</i>	<i>Unit of Measure</i>	<i>True Value</i>	<i>Analyzed Value</i>	<i>% Diff</i>	<i>Limit</i>
<i>Diesel Range (C10 - C28)</i>	<i>&lt;5.0</i>	<i>ppm</i>	<i>100</i>	<i>108</i>	<i>8.5</i>	<i>15%</i>

### *Matrix Spike*

<i>Parameter</i>	<i>1 - Percent Recovered</i>	<i>2 - Percent Recovered</i>	<i>Limit</i>	<i>%RSD</i>	<i>Limit</i>
<i>Diesel Range (C10-C28)</i>	<i>105</i>	<i>114</i>	<i>(70-130)</i>	<i>6</i>	<i>20%</i>

**Method** - SW-846 EPA Method 8015A mod. - Nonhalogenated Volatile Hydrocarbons by Gas Chromatography

Approved by: *[Signature]*  
Date: *10/11/96*

OFF: (505) 325-5667



LAB: (505) 325-1556

### AROMATIC VOLATILE ORGANICS

Attn: *Denver Bearden*  
Company: *PNM Gas Services*  
Address: *603 W. Elm*  
City, State: *Farmington, NM 87401*

Date: *11-Oct-96*  
COC No.: *5341*  
Sample No.: *12545*  
Job No.: *2-1000*

Project Name: *PNM Gas Services - Axi Apache A-10 Run 116*  
Project Location: *9610081650; 4pt. Composite*  
Sampled by: *PA* Date: *8-Oct-96* Time: *16:50*  
Analyzed by: *DC* Date: *11-Oct-96*  
Sample Matrix: *Soil*

#### Laboratory Analysis

<i>Parameter</i>	<i>Result</i>	<i>Unit of Measure</i>	<i>Detection Limit</i>	<i>Unit of Measure</i>
<i>Benzene</i>	<i>1.6</i>	<i>ug/kg</i>	<i>0.2</i>	<i>ug/kg</i>
<i>Toluene</i>	<i>8.8</i>	<i>ug/kg</i>	<i>0.2</i>	<i>ug/kg</i>
<i>Ethylbenzene</i>	<i>1.7</i>	<i>ug/kg</i>	<i>0.2</i>	<i>ug/kg</i>
<i>m,p-Xylene</i>	<i>6.7</i>	<i>ug/kg</i>	<i>0.2</i>	<i>ug/kg</i>
<i>o-Xylene</i>	<i>&lt;0.2</i>	<i>ug/kg</i>	<i>0.2</i>	<i>ug/kg</i>
<i>TOTAL</i>	<i>18.8</i>	<i>ug/kg</i>		

**Method** - *SW-846 EPA Method 8020 Aromatic Volatile Organics by Gas Chromatography*

Approved by: *[Signature]*  
Date: *10/11/96*

JICARILLA APACHE TRIBE  
ENVIRONMENTAL  
PROTECTION OFFICE  
P.O. BOX 507  
DULCE, NEW MEXICO 87528

SUBMIT 1 COPY TO  
NATURAL  
RESOURCE DEPT  
AND OIL-GAS  
ADMINISTRATION

ON-SITE SOIL REMEDIATION REPORT

Operator: <u>PNM Gas Services (Bayless)</u> Telephone: <u>324-3764</u>	
Address: <u>603 W. Elm Street Farmington, NM 87401</u>	
Facility or Well Name: <u>Axi Apache A-10</u>	
Location: Unit: <u>0</u> Sec. <u>10</u> T. <u>23</u> N. R. <u>5</u> W. County <u>Rio Arriba</u>	
Land Type: <u>Jicarilla Apache</u>	
Date Remediation Started: <u>10/8/96</u> Date Completed: <u>10/16/96</u>	
Remediation Method: Landfarmed <u>X</u> Approx. cubic yards <u>133</u> Composted <u>    </u> Other <u>    </u>	
Depth to Ground Water: (pts.) <u>0</u>	Final Closure Sampling: Sampling Date: <u>10/16/96</u> Time <u>1439</u> Sampling Results: Field Headspace (ppm) <u>43.8</u> TPH (ppm) <u>&lt;5.0</u> Method <u>8015</u> Other <u>    </u>
Distance to an Ephemeral Stream: (pts.) <u>0</u>	
Distance to Nearest Lake, Playa, or Watering Pond: (pts.) <u>0</u>	
Wellhead Protection Area: (pts.) <u>0</u>	
Distance to Surface Water: (pts.) <u>0</u>	
Ranking Score (Total Points): <u>0</u>	
I HEREBY CERTIFY THAT THE INFORMATION ABOVE IS TRUE AND COMPLETE TO THE BEST OF MY KNOWLEDGE AND BELIEF	
DATE <u>10/16/96</u> PRINTED NAME <u>ROY BURNHAM</u>	
SIGNATURE <u>Roy Burnham</u> AND TITLE <u>Environmental Technician II</u>	
AFTER REVIEW OF THE SOIL REMEDIATION INFORMATION, ON-SITE REMEDIATION APPROVED IN ACCORDANCE TO THE JICARILLA APACHE TRIBE PIT CLOSURE ORDINANCE	
APPROVED: YES <u>✓</u> NO <u>    </u> (REASON) <u>    </u>	
SIGNED: <u>Hector Julian</u> DATE: <u>10/22/96</u>	

Sec. 10 T23N R5W  
Bayless

Land farm

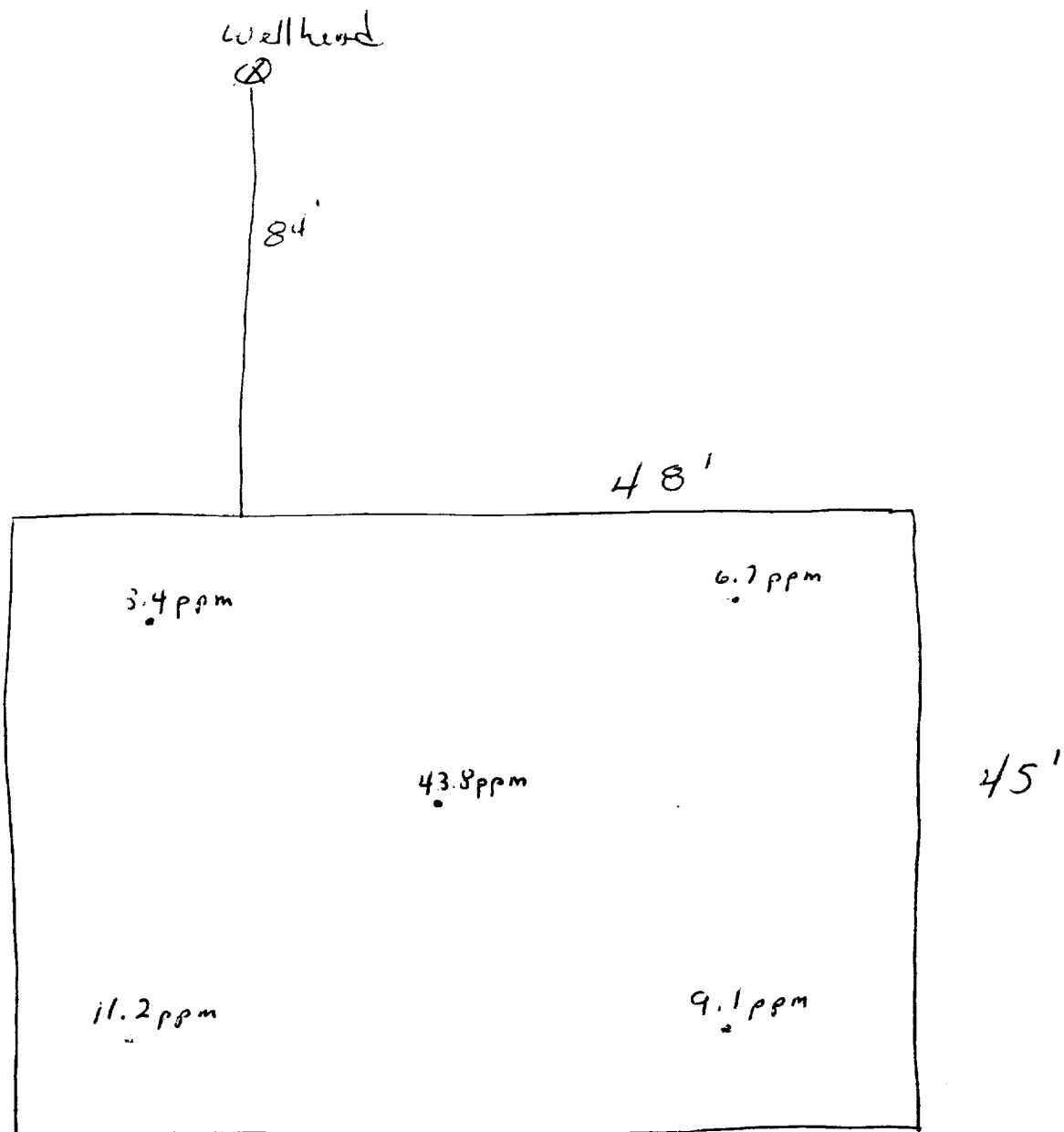

OFF: (505) 325-5667



LAB: (505) 325-1556

### *Diesel Range Organics*

Attn: *Denver Bearden*  
Company: *PNM Gas Services*  
Address: *603 W. Elm*  
City, State: *Farmington, NM 87401*

Date: *18-Oct-96*  
COC No.: *5363*  
Sample No. *12613*  
Job No. *2-1000*

Project Name: *PNM Gas Services - Axi Apache A-10 Landfarm Run 116*  
Project Location: *9610161439; 5pt. Composite*  
Sampled by: *RB* Date: *16-Oct-96* Time: *14:39*  
Analyzed by: *DC/HR* Date: *18-Oct-96*  
Sample Matrix: *Soil*

### *Laboratory Analysis*

<i>Parameter</i>	<i>Result</i>	<i>Unit of Measure</i>	<i>Detection Limit</i>	<i>Unit of Measure</i>
<i>Diesel Range Organics (C10 - C28)</i>	<i>&lt;5.0</i>	<i>mg/kg</i>	<i>5.0</i>	<i>mg/kg</i>

### *Quality Assurance Report*

*DRO QC No.: 0489-QC*

#### *Calibration Check*

<i>Parameter</i>	<i>Method Blank</i>	<i>Unit of Measure</i>	<i>True Value</i>	<i>Analyzed Value</i>	<i>% Diff</i>	<i>Limit</i>
<i>Diesel Range (C10 - C28)</i>	<i>&lt;5.0</i>	<i>ppm</i>	<i>100</i>	<i>102</i>	<i>1.6</i>	<i>15%</i>

#### *Matrix Spike*

<i>Parameter</i>	<i>1- Percent Recovered</i>	<i>2 - Percent Recovered</i>	<i>Limit</i>	<i>%RSD</i>	<i>Limit</i>
<i>Diesel Range (C10-C28)</i>	<i>93</i>	<i>97</i>	<i>(70-130)</i>	<i>3</i>	<i>20%</i>

**Method** - SW-846 EPA Method 8015A mod. - Nonhalogenated Volatile Hydrocarbons by Gas Chromatography

Approved by:   
Date: *10/18/96*