

30-039-22777

UNITED STATES
DEPARTMENT OF THE INTERIOR
GEOLOGICAL SURVEY

APPLICATION FOR PERMIT TO DRILL, DEEPEN, OR PLUG BACK

1a. TYPE OF WORK DRILL ☒ DEEPEN ☐ PLUG BACK ☐

b. TYPE OF WELL OIL WELL ☒ GAS WELL ☐ OTHER ☐ SINGLE ZONE ☐ MULTIPLE ZONE ☐

2. NAME OF OPERATOR Reading & Bates Petroleum Co.

3. ADDRESS OF OPERATOR 1125 17th St. Suite 2300 Denver, CO 80202

4. LOCATION OF WELL (Report location clearly and in accordance with any State requirements.*)
AT SURFACE 1650' FNL 1650' FEL

At proposed prod. zone same

14. DISTANCE IN MILES AND DIRECTION FROM NEAREST TOWN OR POST OFFICE*
Approximately 93 miles SE of Bloomfield, N.M.

15. DISTANCE FROM PROPOSED* LOCATION TO NEAREST PROPERTY OR LEASE LINE, FT.
(Also to nearest drlg. unit line, if any.) 2560

18. DISTANCE FROM PROPOSED LOCATION* TO NEAREST WELL DRILLING COMPLETED, OR APPLIED FOR, ON THIS LEASE, FT. 7700'

21. ELEVATIONS (Show whether DF, RT, GR, etc.)
7265' Gr DRILLING OPERATIONS AUTHORIZED ARE

23. SUBJECT TO COMPLIANCE WITH ATTACHED PROPOSED CASING AND CEMENTING PROGRAM "GENERAL REQUIREMENTS"

SIZE OF HOLE	SIZE OF CASING	WEIGHT PER FOOT	SETTING DEPTH
12 1/4"	8 5/8"	24#	350'
7 7/8"	4 1/2"	11.6#	7700'

5. LEASE DESIGNATION AND SERIAL NO.

#156

6. IF INDIAN, ALLOTTEE OR TRIBE NAME

Jicarilla

7. UNIT AGREEMENT NAME

8. FARM OR LEASE NAME

Jicarilla Apache 3

9. WELL NO.

1

10. FIELD AND POOL, OR WILDCAT

Wildcat Dakota

11. SEC., T., R., M., OR BLK. AND SURVEY OR AREA

Sec. 3, T23N, R2W

12. COUNTY OR PARISH 13. STATE

Rio Arriba New Mexico

17. NO. OF ACRES ASSIGNED TO THIS WELL

160 40

20. ROTARY OR CABLE TOOLS

Rotary

22. APPROX. DATE WORK WILL START*

June 15, 1981

This action is subject to administrative appeal pursuant to 30 CFR 290.

Cement to surface
900 sks.

We propose to drill the above described well to 7700' to test the Gallup and Dakota Formations. See attachments for additional APD information.



IN ABOVE SPACE DESCRIBE PROPOSED PROGRAM: If proposal is to deepen or plug back, give data on present productive zone and proposed new productive zone. If proposal is to drill or deepen directionally, give pertinent data on subsurface locations and measured and true vertical depths. Give blowout preventer program, if any.

24. SIGNED David L. Blosser TITLE Division Engineer DATE 5/13/81

(This space for Federal or State office use)

PERMIT NO.

APPROVAL DATE

APPROVED BY
CONDITIONS OF APPROVAL, IF ANY:

TITLE

DATE

APPROVED
AS AMENDED

JUN 20 1981

E.A. Schmidt
for JAMES F. SIMS
SUPERVISOR

ch 3-

APPROVED

All distances must be from the outer boundaries of the Section.

READING & BATES PETROLEUM COMPANY			Lease JICARILLA APACHE 3		Well No. 1
Letter G	Section 3	Township 23N	Range 2W	County Rio Arriba	
Actual Footage Location of Well: 1650 feet from the North line and 1650 feet from the East line					
Ground Level Elev. 7265	Producing Formation Gallup/Dakota		Pool Wildcat	Dedicated Acreage: 40 160 Acres	

1. Outline the acreage dedicated to the subject well by colored pencil or hatchure marks on the plat below.
2. If more than one lease is dedicated to the well, outline each and identify the ownership thereof (both as to working interest and royalty).
3. If more than one lease of different ownership is dedicated to the well, have the interests of all owners been consolidated by communitization, unitization, force-pooling, etc?

☒ Yes ☐ No If answer is "yes," type of consolidation Operating Agreement

If answer is "no," list the owners and tract descriptions which have actually been consolidated. (Use reverse side of this form if necessary.)

No allowable will be assigned to the well until all interests have been consolidated (by communitization, unitization, forced-pooling, or otherwise) or until a non-standard unit, eliminating such interests, has been approved by the Commission.

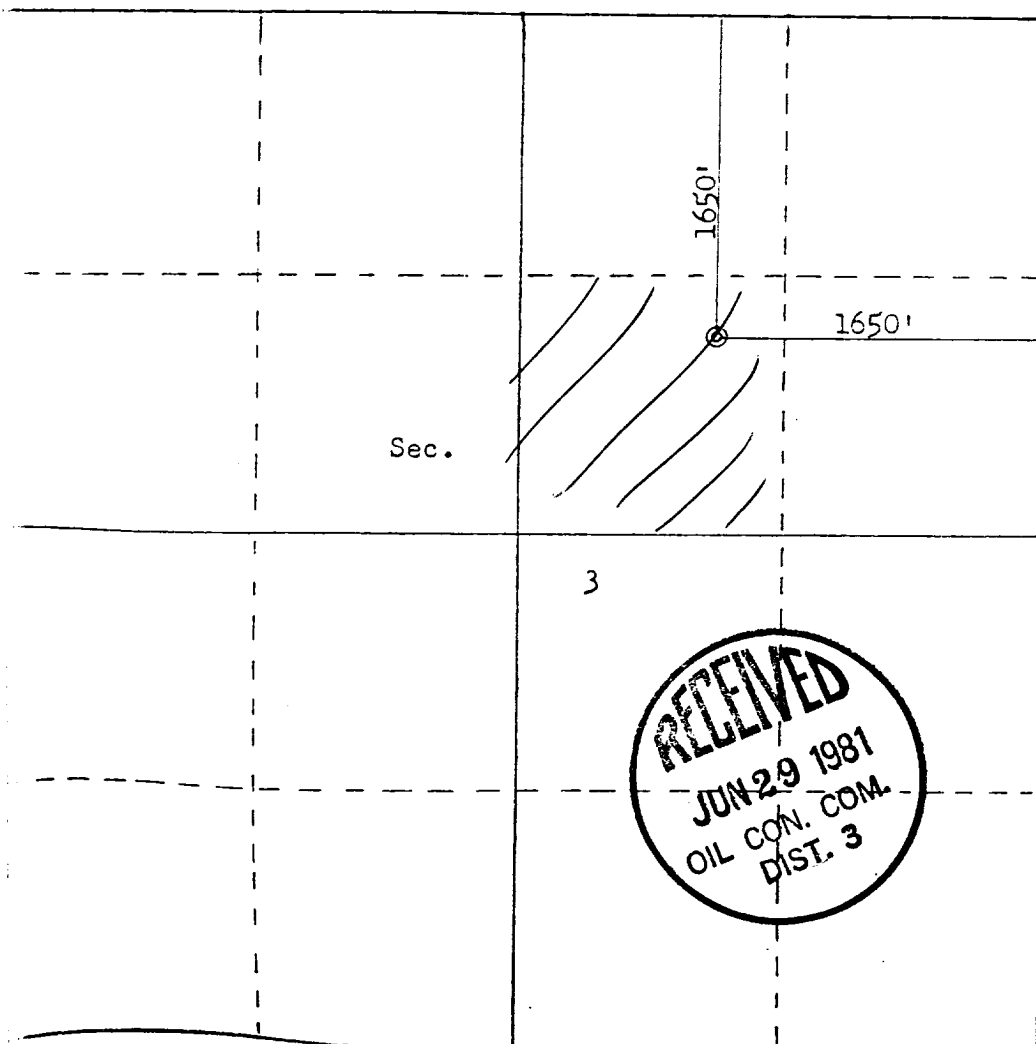

CERTIFICATION

I hereby certify that the information contained herein is true and complete to the best of my knowledge and belief.

Name

David L. Blosser

Position

Division Engineer

Company

Reading & Bates Petroleum Co.

Date

5/14/81

I hereby certify that the well location shown on this plat was plotted from field notes of actual surveys made by me or under my supervision, and that the same is true and correct to the best of my knowledge and belief.

Date Surveyed

May 6, 1981

Registered Professional Engineer
and Land Surveyor

Fred B. Kerr, Jr.

Certificate No.

3950

F. B. KERR, JR.