

OIL CONSERVATION DIVISION

STATE OF NEW MEXICO
ENERGY AND MINERALS DEPARTMENTP. O. BOX 2088
SANTA FE, NEW MEXICO 87501Form C-102
Revised 10-1-78

All distances must be from the outer boundaries of the Section.

Operator Dugan Production Corporation			Lease Lough Erne		Well No. 1
Unit Letter G	Section 4	Township 23 North	Range 6 West	County Rio Arriba	
Actual Footage Location of Well:					
2160 feet from the North line and		2310 feet from the East line			
Ground Level Elev. 6725	Producing Formation Gallup	Pool Counselors Gallup		Dedicated Acreage; 160 Acres	

1. Outline the acreage dedicated to the subject well by colored pencil or hachure marks on the plat below.
2. If more than one lease is dedicated to the well, outline each and identify the ownership thereof (both as to working interest and royalty).
3. If more than one lease of different ownership is dedicated to the well, have the interests of all owners been consolidated by communitization, unitization, force-pooling, etc?

☐ Yes ☐ No If answer is "yes," type of consolidation _____

If answer is "no," list the owners and tract descriptions which have actually been consolidated. (Use reverse side of this form if necessary.) _____

No allowable will be assigned to the well until all interests have been consolidated (by communitization, unitization, forced-pooling, or otherwise) or until a non-standard unit, eliminating such interests, has been approved by the Division.

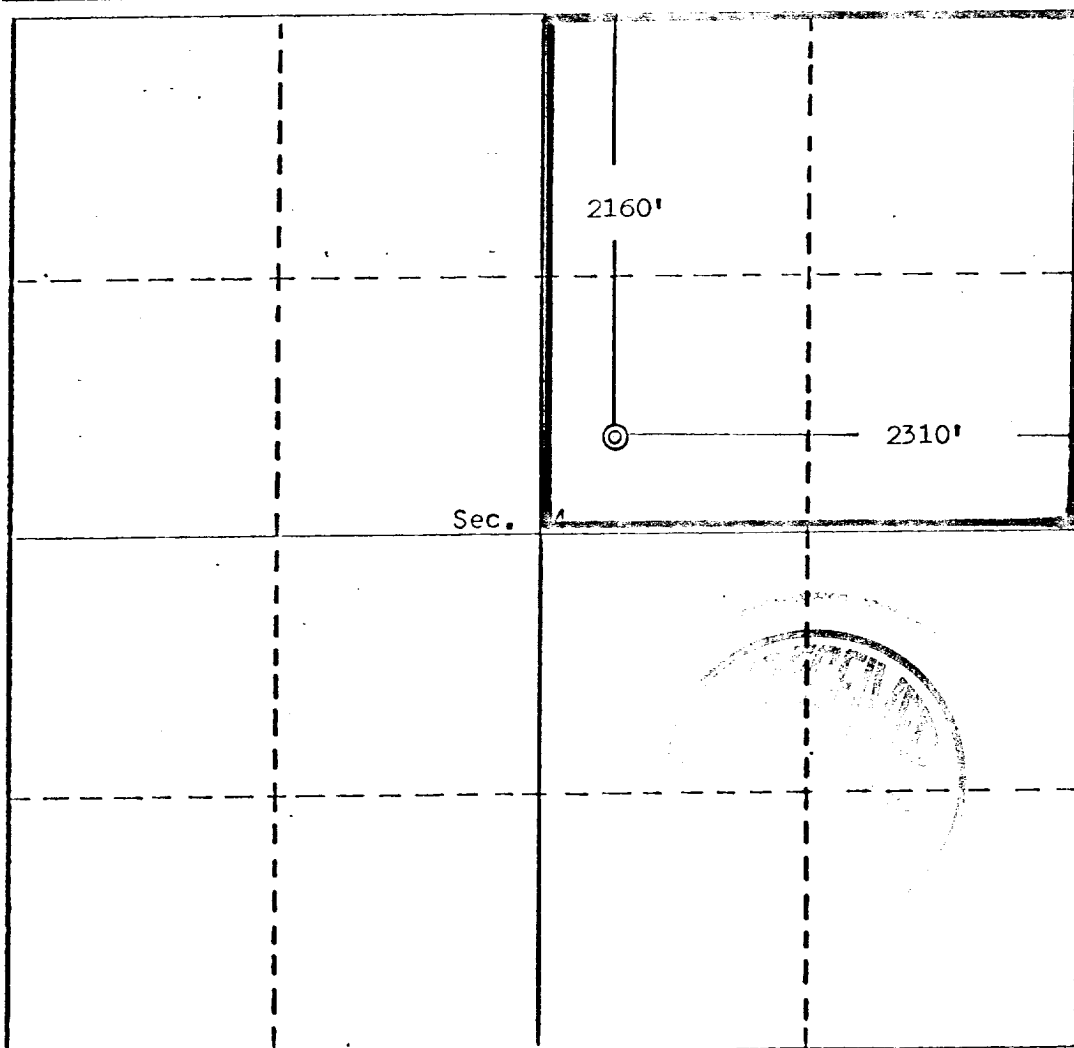

CERTIFICATION

I hereby certify that the information contained herein is true and complete to the best of my knowledge and belief.

Name
Thomas A. Dugan

Position
Petroleum Engineer

Company
DUGAN PRODUCTION CORP.

Date
8-27-82

I hereby certify that the location shown on this plat was taken from field notes or observations made by me or under my supervision, and that the same is correct to the best of my knowledge and belief.

EDGAR L. RISENHOVER
REGISTERED LAND SURVEYOR
NEW MEXICO
5979

Date Surveyed
August 24, 1981

Registered Professional Engineer
and/or Land Surveyor

Edgar L. Risenhoover
Certificate No. 5979
Edgar L. Risenhoover, L.S.