

UNITED STATES
DEPARTMENT OF THE INTERIOR
GEOLOGICAL SURVEY

SUNDRY NOTICES AND REPORTS ON WELLS

(Do not use this form for proposals to drill or to deepen or plug back to a different reservoir. Use Form 9-331-C for such proposals.)

1. oil ☒ well gas ☐ well other ☐

2. NAME OF OPERATOR
Amoco Production Company

3. ADDRESS OF OPERATOR
501 Airport Drive, Farmington, NM 87401

4. LOCATION OF WELL (REPORT LOCATION CLEARLY. See space 17 below.)
AT SURFACE: 1120' FSL x 820' FEL
AT TOP PROD. INTERVAL: Same
AT TOTAL DEPTH: Same

16. CHECK APPROPRIATE BOX TO INDICATE NATURE OF NOTICE, REPORT, OR OTHER DATA

REQUEST FOR APPROVAL TO:		SUBSEQUENT REPORT OF:	
TEST WATER SHUT-OFF	<input type="checkbox"/>		<input type="checkbox"/>
FRACTURE TREAT	<input type="checkbox"/>		<input type="checkbox"/>
SHOOT OR ACIDIZE	<input type="checkbox"/>		<input type="checkbox"/>
REPAIR WELL	<input type="checkbox"/>		<input type="checkbox"/>
PULL OR ALTER CASING	<input type="checkbox"/>		<input type="checkbox"/>
MULTIPLE COMPLETE	<input type="checkbox"/>		<input type="checkbox"/>
CHANGE ZONES	<input type="checkbox"/>		<input type="checkbox"/>
ABANDON*	<input type="checkbox"/>		<input type="checkbox"/>
(other) <u>Horizon Change</u>			

5. LEASE
Jicarilla Tribal 396

6. IF INDIAN, ALLOTTEE OR TRIBE NAME
Jicarilla Apache

7. UNIT AGREEMENT NAME

8. FARM OR LEASE NAME
Jicarilla Tribal 396

9. WELL NO.
2

10. FIELD OR WILDCAT NAME
Chacon Dakota/Undes. Gallup

11. SEC., T., R., M., OR BLK. AND SURVEY OR AREA SE/4, SE/4,
Section 8-T23N-R3W

12. COUNTY OR PARISH
Rio Arriba

13. STATE
New Mexico

14. API NO.
30-039-22921

15. ELEVATIONS (SHOW DF, KDB, AND WD)
7506' GL

(NOTE: Report results of multiple completion or zone change on Form 9-330.)

17. DESCRIBE PROPOSED OR COMPLETED OPERATIONS (Clearly state all pertinent details, and give pertinent dates, including estimated date of starting any proposed work. If well is directionally drilled, give subsurface locations and measured and true vertical depths for all markers and zones pertinent to this work.)*

Due to change in plans, Amoco Production Company will complete the subject well as a Chacon Dakota/Undes. Gallup well, and not just as a single zone Dakota as indicated by our APD dated March 26, 1982. Please find attached a copy of the revised survey plat.

Subsurface Safety Valve: Manu. and Type _____ Set @ _____ Ft.

18. I hereby certify that the foregoing is true and correct

SIGNED Wayne L. Peterson TITLE District Engineer DATE April 15, 1982

(This space for Federal or State office use)

APPROVED BY _____ TITLE _____ DATE _____
CONDITIONS OF APPROVAL, IF ANY:

*See Instructions on Reverse Side

NMOC D

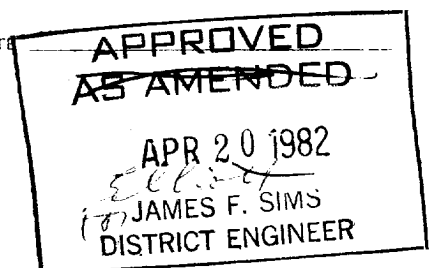

OIL CONSERVATION DIVISION

P. O. BOX 2088

Form C-102
Revised 10-1-78

STATE OF NEW MEXICO

ENERGY AND MINERALS DEPARTMENT

SANTA FE, NEW MEXICO 87501

All distances must be from the outer boundaries of the Section.

Operator AMOCO PRODUCTION COMPANY			Lease JICARILLA TRIBAL 396		Well No. 2
Unit Letter P	Section 8	Township 23N	Range 3W	County Rio Arriba	
Actual Footage Location of Well: 1120 feet from the South line and 820 feet from the East line					
Ground Level Elev. 7506	Producing Formation Dakota /Gallup		Pool Chacon Dakota /Undes. Gallup		Dedicated Acreage: 160/40 Acres

1. Outline the acreage dedicated to the subject well by colored pencil or hachure marks on the plat below.
2. If more than one lease is dedicated to the well, outline each and identify the ownership thereof (both as to working interest and royalty).
3. If more than one lease of different ownership is dedicated to the well, have the interests of all owners been consolidated by communitization, unitization, force-pooling, etc?

☐ Yes ☐ No If answer is "yes," type of consolidation _____

If answer is "no," list the owners and tract descriptions which have actually been consolidated. (Use reverse side of this form if necessary.) _____

No allowable will be assigned to the well until all interests have been consolidated (by communitization, unitization, forced-pooling, or otherwise) or until a non-standard unit, eliminating such interests, has been approved by the Commission.

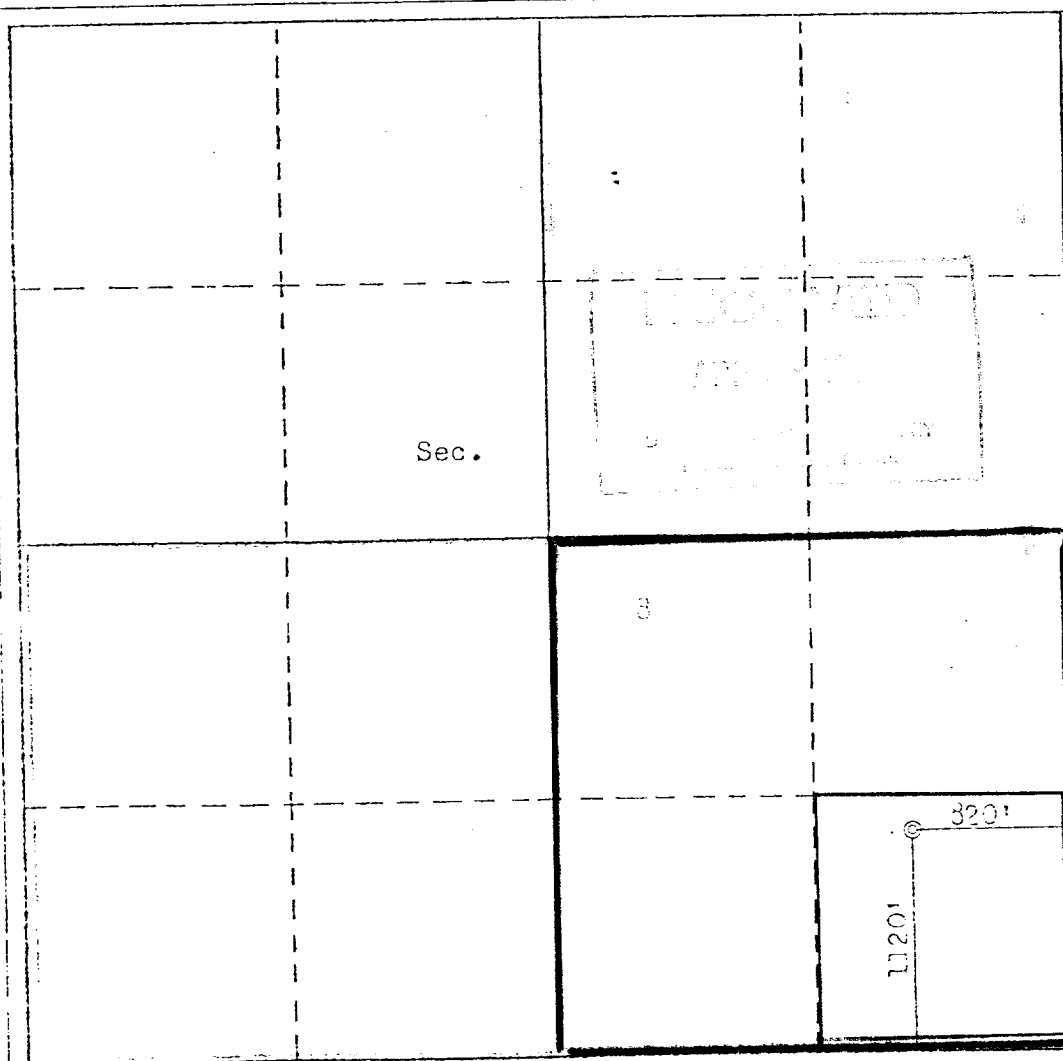

CERTIFICATION

I hereby certify that the information contained herein is true and complete to the best of my knowledge and belief.

Wayne L. Peterson

Name

Wayne L. Peterson

Position

District Engineer

Company

Amoco Production Company

Date

April 15, 1982

I hereby certify that the well location shown on this plat was plotted from field notes of actual surveys made by me or under my supervision, and that the same is true and correct to the best of my knowledge and belief.

Date Surveyed

March 1982

 Registered Professional Engineer
and/or Land Surveyor

Fred B. Kern Jr.
Fred B. Kern Jr.

Certificate No.

3950