

UNITED STATES
DEPARTMENT OF THE INTERIOR
GEOLOGICAL SURVEY

APPLICATION FOR PERMIT TO DRILL, DEEPEN, OR PLUG BACK

1a. TYPE OF WORK

DRILL ☒DEEPEN ☐PLUG BACK ☐

b. TYPE OF WELL

OIL
WELL ☒GAS
WELL ☐

OTHER

SINGLE
ZONE ☐MULTIPLE
ZONE ☒

2. NAME OF OPERATOR

Chace Oil Company, Inc.

3. ADDRESS OF OPERATOR

313 Washington, SE, Albuquerque, NM 87108

4. LOCATION OF WELL (Report location clearly and in accordance with any State requirements.)

At surface

Unit 'F' - 1980' FNL & 1980' FWL

At proposed prod. zone

14. DISTANCE IN MILES AND DIRECTION FROM NEAREST TOWN OR POST OFFICE

12 miles SW of Lindrith New Mexico

15. DISTANCE FROM PROPOSED* 1980' Lease Line

LOCATION TO NEAREST

PROPERTY OR LEASE LINE, FT.

(Also to nearest drlg. unit line, if any) 660' Unit Line

18. DISTANCE FROM PROPOSED LOCATION*

TO NEAREST WELL, DRILLING, COMPLETED,

OR APPLIED FOR, ON THIS LEASE, FT.

1100'

21. ELEVATIONS (Show whether DF, RT, GR, etc.)

7221 GL

23. PROPOSED CASING AND CEMENTING PROGRAM

SIZE OF HOLE	SIZE OF CASING	WEIGHT PER FOOT	SETTING DEPTH	QUANTITY OF CEMENT
9 3/4"	8 5/8"	22# (J-55)	225'	225 sxs (405 CF) Class B cement
7 7/8"	4 1/2"	11.6# (N-80)	7540'	1st stage: 750 sxs (1350 CF) 50/50 pozmix 2nd stage: 510 sxs (918 CF) 40/60 pozmix, 12% gel 50 sxs (90 CF) Class B cement.

Drill 230' of 9 3/4" surface hole. Set 225' of 8 5/8" casing. Cement to surface with 225 sxs (405 CF) cement. Use an oil base mud, (15% oil), and Schaeffer 5000# standard doublegate hydraulic BOP. Drill 7 7/8" hole to 7540' to test Dakota formation.

Wasatch formation on surface. Estimated tops: Ojo-2515'; Pictured Cliffs-2990'; Chacra-3340'; Cliff House-4495'; Pt. Lookout-5075'; Gallup-6165'; Tocoito-6920'; Greenhorn-7130'; Dakota 'A'-7215'; Dakota 'D'-7340'; Burro Canyon-7400'.

D. V. Tool @ 3040'. Float Collar @ 7510'.

RECEIVED

MAY 24 1983

OIL CON. DIV.

IN ABOVE SPACE DESCRIBE PROPOSED PROGRAM: If proposal is to deepen or plug back, give data on present productive zone and proposed new productive zone. If proposal is to drill or deepen directionally, give pertinent data on subsurface locations and measured and true vertical depths. Give blowout preventer program, if any.

24.

SIGNED

TITLE Geologist

DATE

5-12-83

(This space for Federal or State office use)

PERMIT NO.

APPROVAL DATE

APPROVED BY

TITLE

CONDITIONS OF APPROVAL, IF ANY:

APPROVED
DATE
AS AMENDED

MAY 23 1983

JAMES F. SIMS
DISTRICT ENGINEER

*See Instructions On Reverse Side

All distances must be from the outer boundaries of the Section.

Operator CHACE OIL COMPANY, INC.			Lease 11 CARILLA TRIBAL #71		Well No. 18
Unit Letter F	Section 3	Township 23 NORTH	Range 4 WEST	County PIO ABRIJA	
Actual Footage Location of Well: 1980 feet from the NORTH line and 1980 feet from the WEST line Ground Level Elev. 7221 Producing Formation Gallup-DAKOTA Pool S. Lindrith Gallup DAKOTA Dedicated Acreage 40 Acres					

1. Outline the acreage dedicated to the subject well by colored pencil or hatchure marks on the plat below.
2. If more than one lease is dedicated to the well, outline each and identify the ownership thereof (both as to working interest and royalty).
3. If more than one lease of different ownership is dedicated to the well, have the interests of all owners been consolidated by communitization, unitization, force-pooling, etc?

☐ Yes ☐ No If answer is "yes," type of consolidation _____

If answer is "no," list the owners and tract descriptions which have actually been consolidated. (Use reverse side of this form if necessary.) _____

No allowable will be assigned to the well until all interests have been consolidated (by communitization, unitization, forced-pooling, or otherwise) or until a non-standard unit, eliminating such interests, has been approved by the Division.

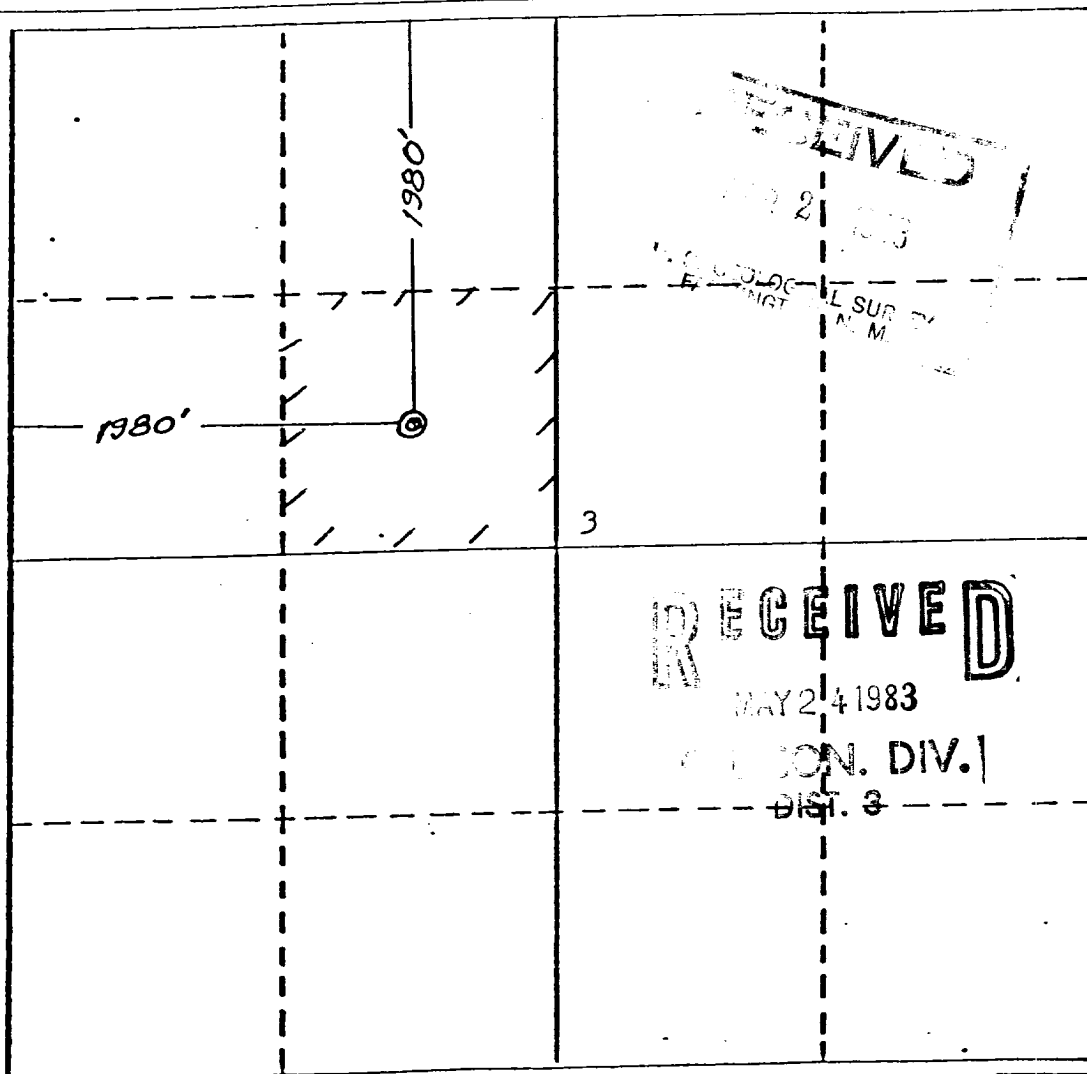

CERTIFICATION

I hereby certify that the information contained herein is true and complete to the best of my knowledge and belief.

Name **James P. Leese**
 Position **Geologist**
 Company **Chace Oil Co.**
 Date **1-11-83**

I hereby certify that the location shown on this plat was plotted from field notes of actual surveys made by me or under my supervision and that the same is true and correct to the best of my knowledge and belief.

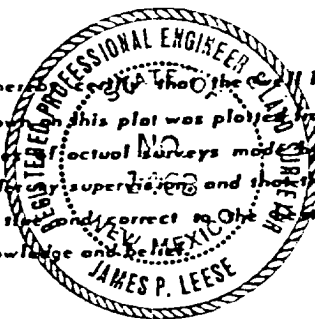

Date Surveyed
November 18, 1982

Registered Professional Engineer
and/or Land Surveyor

James P. Leese
James P. Leese

Certificate No.
1463

