

UNITED STATES
DEPARTMENT OF THE INTERIOR
BUREAU OF LAND MANAGEMENT

APPLICATION FOR PERMIT TO DRILL, DEEPEN, OR PLUG BACK

1a. TYPE OF WORK

DRILL ☒

DEEPEN ☐

PLUG BACK ☐

b. TYPE OF WELL

OIL
WELL ☒

GAS
WELL ☐

OTHER

SINGLE
ZONE ☒

MULTIPLE
ZONE ☒

2. NAME OF OPERATOR

Chace Oil Company, Inc.

BUREAU OF LAND MANAGEMENT
FARMINGTON RESOURCE AREA

3. ADDRESS OF OPERATOR

313 Washington SE, Albuquerque, New Mexico 87108

4. LOCATION OF WELL (Report location clearly and in accordance with any State requirements.)

At surface

Unit 'H', Section 11, T23N, R4W

At proposed prod. zone

2064' FNL & 358' FEL

14. DISTANCE IN MILES AND DIRECTION FROM NEAREST TOWN OR POST OFFICE*

15 miles W-SW of Lindrith, New Mexico

15. DISTANCE FROM PROPOSED* LOCATION TO NEAREST PROPERTY OR LEASE LINE, FT. (Also to nearest drig. unit line, if any)

2064' from lease line

358' from unit line

16. NO. OF ACRES IN LEASE

2560

18. DISTANCE FROM PROPOSED LOCATION* TO NEAREST WELL, DRILLING, COMPLETED, OR APPLIED FOR, ON THIS LEASE, FT.

1700'

19. PROPOSED DEPTH

7688'

17. NO. OF ACRES ASSIGNED TO THIS WELL

40

21. ELEVATIONS (Show whether DF, RT, GR, etc.)

7437' GR

DRILLING OPERATIONS AUTHORIZED ARE
SUBJECT TO COMPLIANCE WITH ATTACHED
"GENERAL REQUIREMENTS"

22. APPROX. DATE WORK WILL START*

July 15, 1987

23. PROPOSED CASING AND CEMENTING PROGRAM

This action is subject to technical and
procedural review pursuant to 43 CFR 3165.3
and appeal pursuant to 43 CFR 3165.4.

SIZE OF HOLE	SIZE OF CASING	WEIGHT PER FOOT	SETTING DEPTH	
12 1/4"	8 5/8"	24# (J-55)	225'	225 sxs (405 cf) Class B. cement
7 7/8"	4 1/2"	11.6# (N-80)	7688'	1st stage: 750 sxs (1350 cf) 50/50 posmix 1073 2nd stage: 505 sxs (909 cf) 40/60 pozmix (12% gel) 1177 40 sxs (72 cf) Class B neat DV tool @ ~ 3473

Drill 230' of 12 1/4" surface hole. Set 225' of 8 5/8" casing. Cement to surface with 225 sxs (405 cf) cement. Using a water base mud (15% oil) and Schaeffer 5000# standard doublegate hydraulic BOP, drill 7 7/8" hole to 7688' to test the Dakota formation. Logging program: Run Dil, Caliper, GR, SP, FDC-CNL from T.D. to surface.

Ojo Alamo	2745'	Point Lookout	5306'	Dakota 'A'	7426'
Pictured Cliff	3173'	Gallup	5979'	Dakota 'D'	7511'
Chacra	3521'	Tocito	6979'	Burro Canyon	7613'
Cliff House	4713'	Greenhorn	7281'		

IN ABOVE SPACE DESCRIBE PROPOSED PROGRAM: If proposal is to deepen or plug back, give data on present productive zone and proposed new productive zone. If proposal is to drill or deepen directionally, give pertinent data on subsurface locations and measured and true vertical depths. Give blowout preventer program, if any.

24.

SIGNED

Monte Anderson

TITLE

Geologist

DATE

June 15, 1987

(This space for Federal or State office use)

PERMIT NO.

APPROVAL DATE

APPROVED BY

TITLE

CONDITIONS OF APPROVAL, IF ANY:

NMOCC

*See Instructions On Reverse Side

All distances must be from the outer boundaries of the Section.

Operator CHACE OIL COMPANY		Lease JICARILLA Tribal Cont. 47		Well No. 3-19
Unit Letter H	Section 11	Township 23 NORTH	Range 4 WEST	County RIO ARRIBA

Actual Footage Location of Well:

2064 feet from the **NORTH** line and **358** feet from the **EAST** line

Ground Level Elev. 7437'	Producing Formation Gallup - Dakota	Pool S. Lindvith Gallup - Dakota	Dedicated Acreage: 40 Acres
------------------------------------	---	--	---------------------------------------

1. Outline the acreage dedicated to the subject well by colored pencil or hachure marks on the plat below.
2. If more than one lease is dedicated to the well, outline each and identify the ownership thereof (both as to working interest and royalty).
3. If more than one lease of different ownership is dedicated to the well, have the interests of all owners been consolidated by communitization, unitization, force-pooling, etc?

☐ Yes ☐ No If answer is "yes," type of consolidation _____

If answer is "no," list the owners and tract descriptions which have actually been consolidated. (Use reverse side of this form if necessary.) _____

No allowable will be assigned to the well until all interests have been consolidated (by communitization, unitization, forced-pooling, or otherwise) or until a non-standard unit, eliminating such interests, has been approved by the Division.

RECEIVED

JUN 16 1987

BUREAU OF LAND MANAGEMENT
FARMINGTON RESOURCE AREA

2064'

LOC. O
358'

RECEIVED

MAY 06 1985

BUREAU OF LAND MANAGEMENT
FARMINGTON RESOURCE AREA

RECEIVED
AUG 20 1987
OIL CO
DIST

CERTIFICATION

I hereby certify that the information contained herein is true and complete to the best of my knowledge and belief.

Monte Anderson

Name

Geologist

Position

Chace Oil Company

Company

3-29-85

Date

I hereby certify that the well location shown on this plat was plotted from field notes of actual surveys made by me or under my supervision and that the same is true and correct to the best of my knowledge and belief.

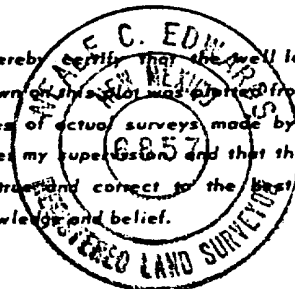

Date Surveyed

3-21-85

Registered Professional Engineer and/or Land Surveyor

Hal C. Edwards

Certificate No.

6857

0 330 660 990 1320 1650 1980 2310 2640 2970 3300 3630 3960 4290 4620 4950 5280 5610 5940 6270 6600

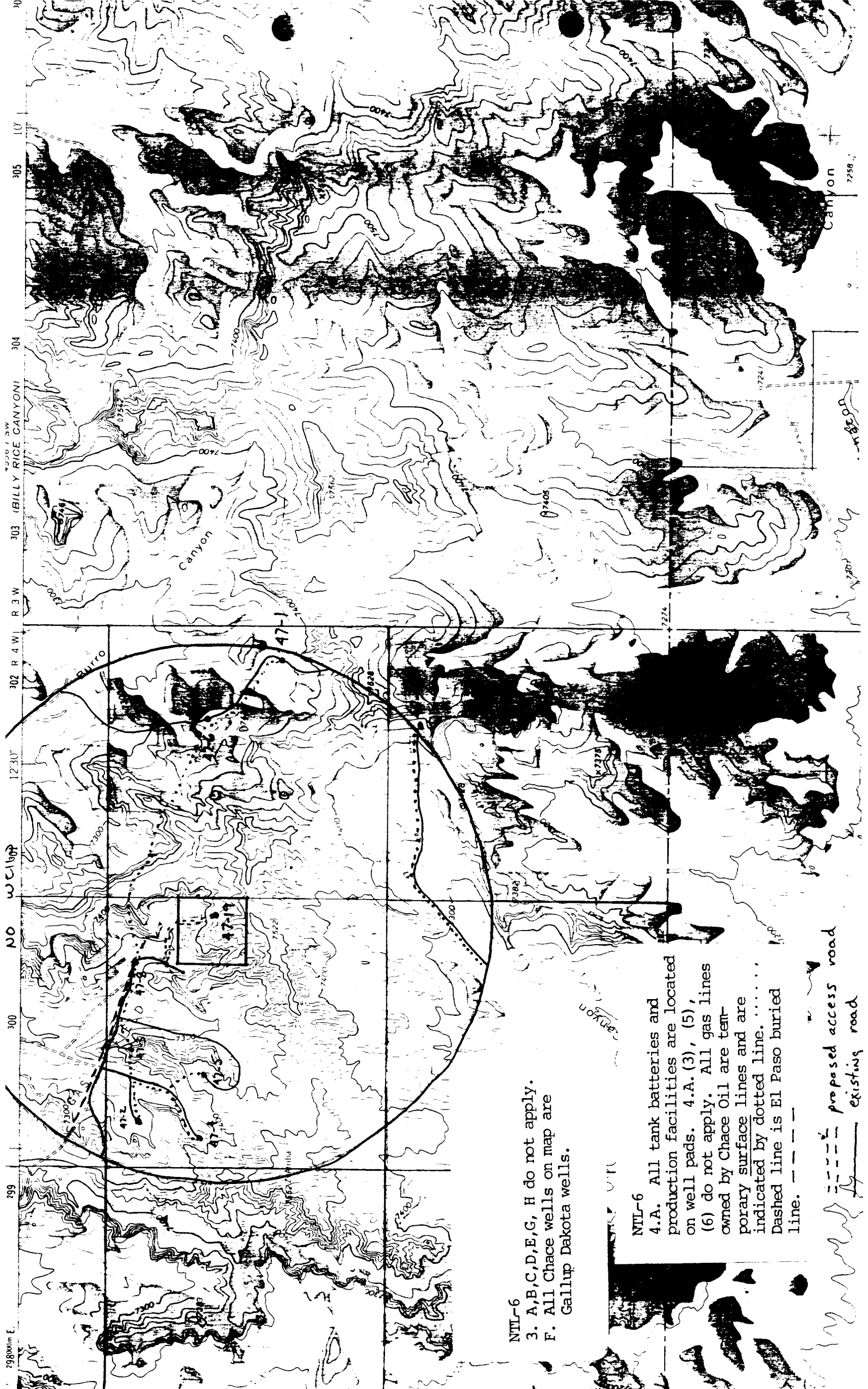

NTL-6

3. A,B,C,D,E,G, H do not apply.
F. All Chace wells on map are Gallup Dakota wells.

NTL-6

- 4.A. All tank batteries and production facilities are located on well pads. 4.A. (3), (5), (6) do not apply. All gas lines owned by Chace Oil are temporary surface lines and are indicated by dotted line. Dashed line is El Paso buried line. - - - -

- proposed access road
--- existing road