

H. K. Keesee
P. O. Box 1995
Farmington, New Mexico 87401

December 4, 1968

Mr. A. L. Porter, Jr.
Secretary - Director
New Mexico Oil & Gas Commission
P. O. Box 2088
Santa Fe, New Mexico



Re: Cinco Diablos #11
1090' From South Line
790' From East Line
Unit Letter P, Section 19
Township 23 North, Range 3 West
Sandoval County, New Mexico

Dear Mr. Porter:

We would like to ask approval of a Non - Standard Gas Proration Unit in the Ballard Pictured Cliffs Pool under terms of Order Number R-1670, Rule 5B, Paragraph 3. The Cinco Diablos #11 Well is located in the Southeast Quarter of Section 19, Township 23 North, Range 3 West, Sandoval County, New Mexico.

Section 19 is composed of 2 Quarter Sections of 160 Acres each plus 4 lots on West Side. Our well is in the South $\frac{1}{4}$ of Section 19, which would include 160 Acre Quarter Side plus 2 Lots; one consisting of 19.00 Acres and one consisting of 18.97 Acres.

This acreage was originally surveyed by the Arizona Engineering Co. on July 6, 1954 and all surveys of the above described acreage are being used by all oil and gas operators in this area. I own valid leases on the following acreage bordering the Cinco Diablos #11 Well:

- (1) North $\frac{1}{4}$ of Section 19, Township 23 North,
Range 3 West
- (2) West $\frac{1}{4}$ of Section 20, Township 23 North,
Range 3 West

We are also enclosing letters addressed to Mr. A. L. Porter, Jr. advising that Reynolds Mining Corporation and Cities Service Oil Company and Pan American Petroleum Corporation have no objection to the New Mexico Oil & Gas Commission granting the Non - Standard Gas Proration unit.

W. F. Keesee
P. O. Box 1000
Birmingham, New Mexico 87401

December 4, 1968

Mr. J. W. Hargrove, Jr.
Secretary - Director
New Mexico Oil Conservation
P. O. Box 1000
Santa Fe, New Mexico

Enclosed Mining Corporation and Office Service Oil
Company own the following acreage as outlined in their
letter dated October 15, 1968:

Section 30, Township 13 North, Range 2 West
San Juan County, New Mexico

San American Petroleum Corporation owns the following
acreage as outlined in their letter dated October 15, 1968:

Sections 14 and 15, Township 13 North, Range 2 West,
San Juan County, New Mexico

We trust the enclosures will be found in order and
that our request for this approval will be considered.

Yours very truly,

W. F. Keesee

William F. Keesee
By: William F. Keesee

Mr. J. W. Hargrove, Jr.
New Mexico Oil Conservation
1000 Rio Arriba Road
Albuquerque, New Mexico 87410

(3) Enc

REYNOLDS MINING CORPORATION
REYNOLDS METALS BUILDING
RICHMOND, VIRGINIA 23218

October 15, 1968

Mr. A. L. Porter, Jr.
Secretary-Director
New Mexico Oil & Gas Commission
P. O. Box 2088
Santa Fe, New Mexico

Dear Sir:

The undersigned, Reynolds Mining Corporation and Cities Service Oil Company, own a current oil and gas lease covering, among others, Section 30, T-23-N, R-3-W, Sandoval County, New Mexico.

The undersigned understand that H. K. Keesee, oil and gas operator of the Cinco Diablos Well No. 11, located in the SE/4 of Section 19, T-23-N, R-3-W, Sandoval County, New Mexico, is applying to you for a proration unit composed of 197.97 acres around said well in said Section 19. The undersigned's lease covering said Section 30 adjoins Keesee's Section 19 lease.

The execution hereof by the undersigned evidences our agreement to such enlarged proration unit and that we have no objection thereto.

Very truly yours,

REYNOLDS MINING CORPORATION

By

Joel Denton

Van J. Deaton

Attorneys-in-Fact

CITIES SERVICE OIL COMPANY

By

WILEY C. HILL

Attorney-in-Fact

H. K. Keesee
P. O. Box 1995
Farmington, New Mexico 87401

December 4, 1968

Mr. A. L. Porter, Jr.
Secretary - Director
New Mexico Oil & Gas Commission
P. O. Box 2088
Santa Fe, New Mexico

Reynolds Mining Corporation and Cities Service Oil
Company own the following acreage as outlined in their
letter dated October 15, 1968:

Section 30, Township 23 North, Range 3 West
Sandoval County, New Mexico

Pan American Petroleum Corporation owns the following
acreage as outlined in their letter dated October 16, 1968:

Sections 24 and 25, Township 23 North, Range 4 West,
Sandoval County, New Mexico

We trust the enclosures will be found in order and
that our request for this approval will be considered.

Yours very truly,

H. K. Keesee

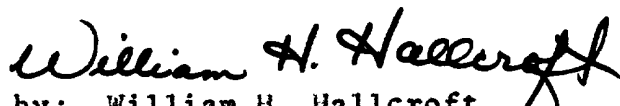
by: William H. Hallcroft

WHH: tm

CC: Mr. Emery Arnold
New Mexico Oil Conservation Commission
1000 Rio Brazos Road
Aztec, New Mexico 87410

Enc: (3)

W. W. Keesee
P. O. Box 1003
Birmingham, New Mexico 87401

October 4, 1968

Mr. W. L. Harter, Jr.
Secretary - Director
New Mexico Oil Conservation
P. O. Box 1003
Santa Fe, New Mexico

Re: Reynolds Mining Corporation and Oil Service Oil
Company own the following acreage as outlined in their
letter dated October 12, 1968:

Section 30, Township 13 North, Range 3 West
Sandoval County, New Mexico

The American Petroleum Corporation owns the following
acreage as outlined in their letter dated October 10, 1968:

Sections 14 and 25, Township 13 North, Range 4 West,
Sandoval County, New Mexico

We trust the enclosures will be found in order and
that our request for this approval will be considered.

Yours very truly,

W. W. Keesee

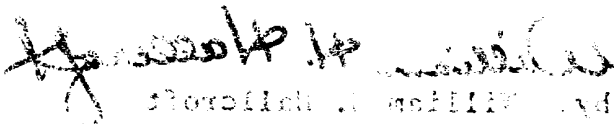
W. W. Keesee

Mr. W. L. Harter, Jr.
New Mexico Oil Conservation Commission
1003 Rio Grande Road
Albuquerque, New Mexico 87102

Enc: (3)

PAN AMERICAN PETROLEUM CORPORATION

SECURITY LIFE BUILDING
DENVER, COLORADO 80202

October 16, 1966

File: AMR-2341-986.511

Re: Non-Standard Proration Unit
H. K. Kessee, Operator
Cinco Diablos No. 11
Sec. 19, T23N-R3W
Sandoval County, New Mexico

Mr. A. L. Porter, Jr.
Secretary Director
New Mexico Oil Conservation Commission
P. O. Box 2088
Santa Fe, New Mexico 87501

Dear Mr. Porter:

Mr. H. K. Kessee drilled and completed in July, 1968, its Cinco Diablos No. 11 well in Unit "P" of Section 19, T23N-R3W, Sandoval County, New Mexico. Kessee desires to include the two lots on the west side of Section 19 in order to increase the allowable for their referenced well from 160 acres to 197.97 acres.

This will constitute our waiver letter to you indicating that Pan American, as leasehold owner of adjoining Sections 24 and 25, T23N-R4W, to the west and southwest of said Section 19, has no objection to the Commission's granting Kessee such an allowance due to the irregular size of Section 19.

Yours very truly,

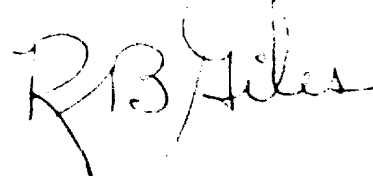

cc: William H. Hallcroft
Office Manager
Arapahoe Drilling Co.
P. O. Box 2078
Farmington, New Mexico 87401

NEW MEXICO OIL CONSERVATION COMMISSION WELL LOCATION AND ACERAGE DEDICATION PLAT

All distances must be from the outer boundaries of the Section

Operator **CINCO DIABLOS DEVELOPMENT COMPANY** Lease **CINCO DIABLOS** Well No. **11**

Unit Section **19** Township **23 NORTH** Range **3 WEST** County **SANDOVAL**

Actual Surface Location of Well: **1090** feet from the **SOUTH** line east **790** feet from the **EAST** line

Producing Formation _____ Pool _____ Disturbed Acreage _____ Acres

7191.0

Outline the acreage dedicated to the subject well by colored pencil or hatchure marks on the plat below.

2. If more than one lease is dedicated to the well, outline each and identify the ownership thereof (both as to working interest and royalty).

3. If more than one lease of different ownership is dedicated to the well, have the interests of all owners been consolidated by communitization, unitization, force-pooling, etc?

☐ Yes ☐ No If answer is "yes," type of consolidation _____

If answer is "no" list the owners and tract descriptions which have actually consolidated. (Use reverse side of this Form if necessary) _____

No allowable will be assigned to the well until all interests have been consolidated (by communitization, unitization, forced-pooling, or otherwise) or until a non standard unit, eliminating such interests, has been approved by the Commission.

CERTIFICATION

I hereby certify that the information contained herein is true and complete to the best of my knowledge and belief.

Name _____
Position _____
Company _____
Date _____

I hereby certify that the well location shown on this plat was plotted from field notes of actual surveys made by me or under my supervision, and that the same is true and correct to the best of my knowledge and belief.

Date Entered **14 June 1968**
James P. Lerts
Registered Professional Engineer
and/or Licensed Surveyor

JAMES P. LERTS

1467

Certificate No. _____

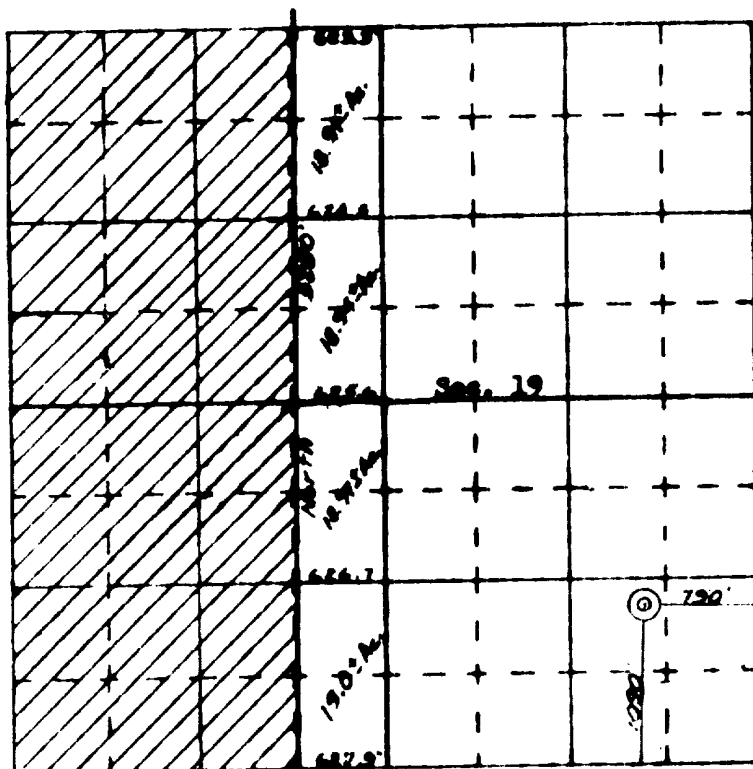

SCALE—4 INCHES EQUALS 1 MILE

SAN JUAN ENGINEERING COMPANY, FARMINGTON, N. M.