

**NEW MEXICO OIL CONSERVATION COMMISSION
WELL LOCATION AND ACERAGE DEDICATION PLAT**

All distances must be from the outer boundaries of the Section

Operator H. K. Keesee KEESSEE DEVELOPMENT CORPORATION Keetom Apache Well No. 1
Unit Letter A Section 19 Township 23 NORTH Range 3 WEST County SANDOVAL
Actual Footage Location of Well: 790 feet from the NORTH line 790 feet from the EAST line
Ground Level Elevation 7260.0 Existing Formation Pictured Cliffs Ballard 160 Acres

- Outline the acreage dedicated to the subject well by color, pencil or machine marks on the plat below.
- If more than one lease is dedicated to the well, outline each and identify the ownership thereof (both as to working interest and royalty).
- If more than one lease of different ownership is dedicated to the well, have the interests of all owners been consolidated by communitization, unitization, force-pooling, etc?

() Yes () No If answer is "yes," type of consolidation _____
If answer is "no," list the owners and tract descriptions which have actually consolidated. (Use reverse side of this form if necessary) _____

No allowable will be assigned to the well until all interests have been consolidated (by communitization, unitization, force-pooling, or otherwise) or until a non standard unit, eliminating such interests, has been approved by the Commission.

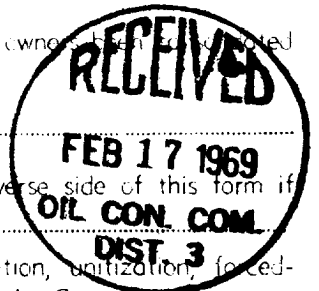

CERTIFICATION

I hereby certify that the information contained herein is true and complete to the best of my knowledge and belief.

Dave M. Thomas, Jr.
Name Dave M. Thomas, Jr.
Position Petroleum Geologist
Company H.K. Keesee
Date 2-12-69

I hereby certify that the well location shown on this plat was plotted from field notes of actual surveys made by me or under my supervision, and that the same is true and correct to the best of my knowledge and belief.

24 JANUARY 1969
Date Surveyed
James P. Leane
Registered Professional Engineer
and/or Land Surveyor

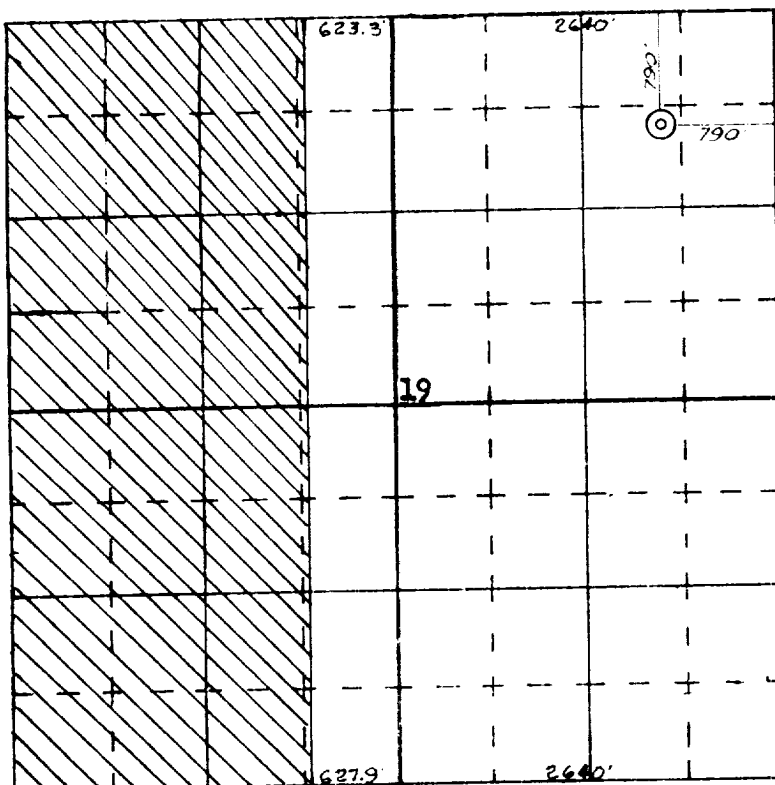

SCALE—4 INCHES EQUALS 1 MILE

SAN JUAN ENGINEERING COMPANY, FARMINGTON, N. M.

Certificate No. 1463