

UNITED STATES
DEPARTMENT OF THE INTERIOR
GEOLOGICAL SURVEY

APPLICATION FOR PERMIT TO DRILL, DEEPEN, OR PLUG BACK

1a. TYPE OF WORK DRILL <input checked="" type="checkbox"/> DEEPEN <input type="checkbox"/> PLUG BACK <input type="checkbox"/>		5. LEASE DESIGNATION AND SERIAL NO. # 421	
b. TYPE OF WELL OIL WELL <input checked="" type="checkbox"/> GAS WELL <input type="checkbox"/> OTHER <input type="checkbox"/>		6. IF INDIAN, ALLOTTEE OR TRIBE NAME Jicarilla Apache Tribal	
2. NAME OF OPERATOR North American Exploration Co., and Tesoro Petroleum Corporation		7. UNIT AGREEMENT NAME -	
3. ADDRESS OF OPERATOR 408 First State Bank Bldg., Abilene, Texas 79604		8. FARM OR LEASE NAME El Stretcho	
4. LOCATION OF WELL (Report location clearly and in accordance with State requirements.)* At surface 1750' FSL & 890' FWL Sec. 35, T23N R5W 22 At proposed prod. zone		9. WELL NO. 1	
14. DISTANCE IN MILES AND DIRECTION FROM NEAREST TOWN OR POST OFFICE* 6 miles southeast Counselor, New Mexico		10. FIELD AND POOL, OR WILDCAT Wildcat	
15. DISTANCE FROM PROPOSED* LOCATION TO NEAREST PROPERTY OR LEASE LINE, FT. (Also to nearest drlg. unit line, if any) 430'		11. SEC., T., R., M., OR BLK. AND SURVEY OR AREA Section 26 T23N R5W	
16. NO. OF ACRES IN LEASE 80		12. COUNTY OR PARISH Sandoval	
17. NO. OF ACRES ASSIGNED TO THIS WELL 40		13. STATE N.M.	
18. DISTANCE FROM PROPOSED LOCATION* TO NEAREST WELL, DRILLING COMPLETED, OR APPLIED FOR, ON THIS LEASE, FT. None		19. PROPOSED DEPTH 7000'	
20. ROTARY OR CABLE TOOLS Rotary		21. APPROX. DATE WORK WILL START* 1 September 71	
21. ELEVATIONS (Show whether DF, RT, GR, etc.) 7062 GL			

23. PROPOSED CASING AND CEMENTING PROGRAM

SIZE OF HOLE	SIZE OF CASING	WEIGHT PER FOOT	SETTING DEPTH	QUANTITY OF CEMENT
12 1/4"	8 5/8"	24#	250'	200 sacks to circ.

Drill surface hole to 250 feet, set 250 feet 8 5/8" OD 24# casing at 250 feet, cement to surface with 200 sacks regular plus 2% calcium chloride cement. Drill 7 7/8" hole to 7000 feet, set 5 1/2" OD casing if productive.

IN ABOVE SPACE DESCRIBE PROPOSED PROGRAM: If proposal is to drill or deepen directionally, give blowout preventer program, if any.

If proposal is to plug back, give data on present productive zone and proposed new productive zone, including surface locations and measured and true vertical depths. Give blowout preventer program, if any.

24. Gordon H. Gray Project Engineer DATE 19 August 71
SIGNED Gordon H. Gray

(This space for Federal or State office use)

PERMIT NO. _____ APPROVAL DATE _____

APPROVED BY Go TITLE _____ DATE _____

CONDITIONS OF APPROVAL, IF ANY:

*See Instructions On Reverse Side

COPY TO ROSWELL BMC

**NEW MEXICO OIL CONSERVATION COMMISSION
WELL LOCATION AND ACERAGE DEDICATION PLAT**

All distances must be from the outer boundaries of the Section

Owner: ~~NORTH AMERICAN EXPLORATION CO.~~
TESORO PETROLEUM CORPORATION

EL STRETCHO

Well No. **1**

Section: **35** Township: **22 NORTH** Range: **5 WEST** County: **SANDOVAL**

Acres to be Dedicated of Well: **1750** Section: **SOUTH** Township: **22 NORTH** Range: **5 WEST** County: **SANDOVAL**

Area of Section: **7062.0** Section: **35** Township: **22 NORTH** Range: **5 WEST** County: **SANDOVAL**

1. Out of the acreage dedicated to the well, it will be _____ acres, more or less, on the plat below.
2. If more than one owner is dedicated to the well, state the name of each owner and the ownership thereof (both as to working interest and royalty).
3. If more than one lease of different ownership is dedicated to the well, state the name of each lease and the ownership thereof (both as to working interest and royalty).

I, the undersigned, being a duly qualified surveyor in the State of New Mexico, do hereby certify that the above information is true and correct to the best of my knowledge and belief. (Use reverse side of this form if necessary.)

I, the undersigned, being a duly qualified surveyor in the State of New Mexico, do hereby certify that the above information is true and correct to the best of my knowledge and belief. (Use reverse side of this form if necessary.)

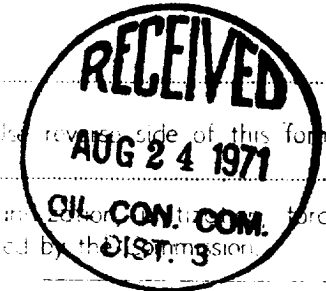

CERTIFICATION

I hereby certify that the information contained herein is true and complete to the best of my knowledge and belief.

Name: **Gordon H. Gray**
Position: **Project Engineer**
Company: **North American Exploration and Tesoro Petroleum Corporation**
Date: **19 Aug 71**

I hereby certify that the well location shown on this plat was plotted from field notes of actual surveys made by me or under my supervision, and that the same is true and correct to the best of my knowledge and belief.

Date: **16 August, 1971**
Signature: **James P. Leese**
Title: **Professional Engineer and/or Land Surveyor**
Name: **JAMES P. LEESE**
Number: **1463**
Certificate No. _____

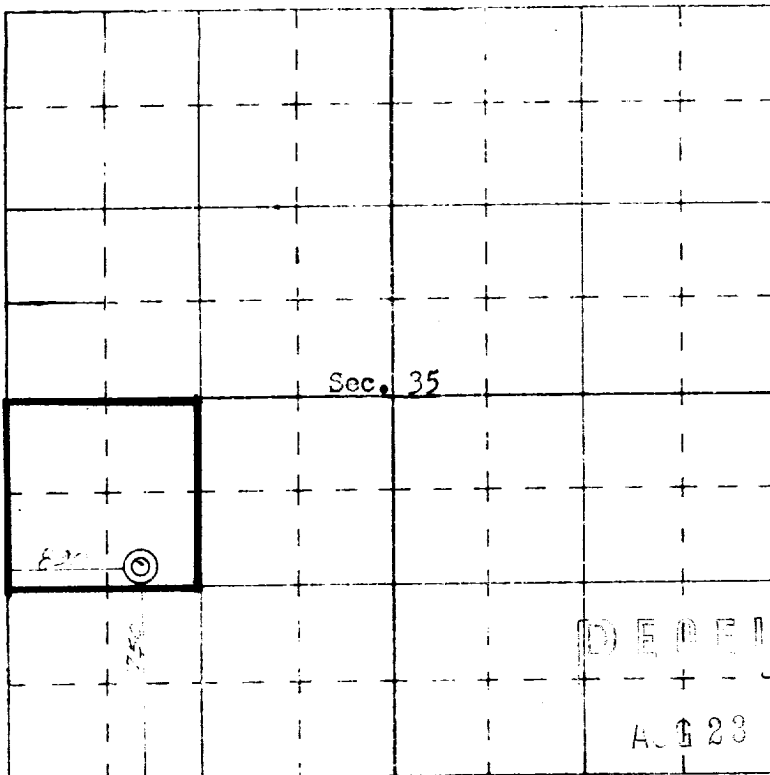

SCALE—4 INCHES EQUALS 1 MILE

U. S. GEOLOGICAL SURVEY
FARMINGTON, N. M.

SAN JUAN ENGINEERING COMPANY, FARMINGTON, N. M.