

UNITED STATES
DEPARTMENT OF THE INTERIOR
GEOLOGICAL SURVEY

APPLICATION FOR PERMIT TO DRILL, DEEPEN, OR PLUG BACK

1a. TYPE OF WORK

DRILL ☒DEEPEN ☐PLUG BACK ☐

b. TYPE OF WELL

OIL
WELL ☐GAS
WELL ☒

OTHER

SINGLE
ZONE ☒MULTIPLE
ZONE ☐

2. NAME OF OPERATOR

AMOCO PRODUCTION COMPANY

3. ADDRESS OF OPERATOR

501 Airport Drive, Farmington, New Mexico 87401

4. LOCATION OF WELL (Report location clearly and in accordance with any State requirements.*)

At surface

820' FWL & 1150' FWL

At proposed prod. zone

Same

14. DISTANCE IN MILES AND DIRECTION FROM NEAREST TOWN OR POST OFFICE*

10 miles northwest from Cuba, New Mexico

15. DISTANCE FROM PROPOSED*

LOCATION TO NEAREST
PROPERTY OR LEASE LINE, FT.
(Also to nearest drlg. unit line, if any)

4500'

16. NO. OF ACRES IN LEASE

2560

17. NO. OF ACRES ASSIGNED
TO THIS WELL

160

18. DISTANCE FROM PROPOSED LOCATION*

TO NEAREST WELL, DRILLING, COMPLETED,
OR APPLIED FOR, ON THIS LEASE, FT.

None

19. PROPOSED DEPTH

2650'

20. ROTARY OR CABLE TOOLS

Rotary

21. ELEVATIONS (Show whether DF, RT, GR, etc.)

7215' GL est.

22. APPROX. DATE WORK WILL START*

June, 1973

23.

PROPOSED CASING AND CEMENTING PROGRAM

| SIZE OF HOLE | SIZE OF CASING | WEIGHT PER FOOT | SETTING DEPTH | QUANTITY OF CEMENT |
|--------------|----------------|-----------------|---------------|--------------------|
| 12-1/4" | 8-5/8" | 24# | 200' | 175 sx |
| 7-7/8" | 4-1/2" | 9.5# | 2650' | 500 sx |

Well to be drilled to test the Pictured Cliffs Formation.

Completion interval and stimulation will be determined after review of open hole logs.

Copy of Location Plat, Development Plan, and location sketch are attached.

Copies of logs will be sent you upon completion of the well.

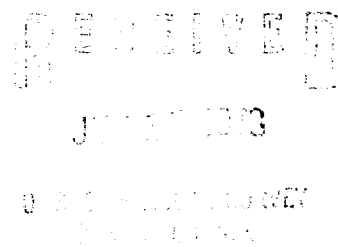

IN ABOVE SPACE DESCRIBE PROPOSED PROGRAM: If proposal is to deepen or plug back, give data on present productive zone and proposed new productive zone. If proposal is to drill or deepen directionally, give pertinent data on subsurface locations and measured and true vertical depths. Give blowout preventer program, if any.

24.

Original Signed by
J. ARNOLD SHELL

SIGNED

TITLE

Area Engineer

DATE

June 14, 1973

(This space for Federal or State office use)

PERMIT NO.

APPROVAL DATE

APPROVED BY

TITLE

DATE

CONDITIONS OF APPROVAL, IF ANY:

*See Instructions On Reverse Side

Instructions

General: This form is designed for submitting proposals to perform certain well operations, as indicated, on all types of lands and leases for appropriate action by either a Federal or a State agency, or both, pursuant to applicable Federal and/or State laws and regulations. Any necessary special instructions concerning the use of this form and the number of copies to be submitted, particularly with regard to local, area, or regional procedures and practices, either are shown below or will be issued by, or may be obtained from, the local Federal and/or State office.

Item 1: If the proposal is to redrill to the same reservoir at a different subsurface location or to a new reservoir, use this form with appropriate notations. Consult applicable State or Federal regulations concerning subsequent work proposals or reports on the well.

Item 4: If there are no applicable State requirements, locations on Federal or Indian land should be described in accordance with Federal requirements. Consult local State or Federal office for specific instructions.

Item 14: Needed only when location of well cannot readily be found by road from the land or lease description. A plat, or plats, separate or on this reverse side, showing the roads to, and the surveyed location of, the well, and any other required information, should be furnished when required by Federal or State agency offices.

Items 15 and 18: If well is to be, or has been directionally drilled, give distances for subsurface location of hole in any present or objective production zone.

Item 22: Consult applicable Federal or State regulations, or appropriate officials, concerning approval of the proposal before operations are started.



NEW MEXICO OIL CONSERVATION COMMISSION

WELL LOCATION AND ACERAGE DEDICATION PLAT

All distances must be from the outer boundaries of the Section

| | | | | | |
|---|---|-----------------------------|--------------------------------------|--|----------------------|
| Operator Amoco Production Company | | | Lease Jicarilla Tribal 359 | | Well No. 1 |
| Unit Letter D | Section 19 | Township 22 North | Range 2 West | County Sandoval | |
| Actual Footage Location of Well: 820 feet from the North line and 1150 feet from the West line | | | | | |
| Ground Level Elev 7215 est. | Producing Formation Pictured Cliffs | | Pool Wildcat | Dedicated Acreage: 160 Acres | |

- Outline the acreage dedicated to the subject well by colored pencil or hachure marks on the plat below.
- If more than one lease is dedicated to the well, outline each and identify the ownership thereof (both as to working interest and royalty).
- If more than one lease of different ownership is dedicated to the well, have the interests of all owners been consolidated by communitization, unitization, force-pooling, etc?

() Yes () No If answer is "yes," type of consolidation

If answer is "no," list the owners and tract descriptions which have actually consolidated. (Use reverse side of this form if necessary.)

No allowable will be assigned to the well until all interests have been consolidated (by communitization, unitization, forced-pooling, or otherwise) or until a non standard unit, eliminating such interests, has been approved by the Commission.

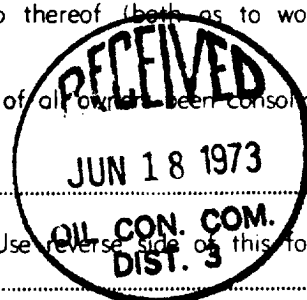

CERTIFICATION

I hereby certify that the information contained herein is true and complete to the best of my knowledge and belief.

J. Arnold Snell
Name

J. Arnold Snell
Position

Area Engineer
Company

AMOCO PRODUCTION COMPANY
Date

June 14, 1973

I hereby certify that the well location shown on this plat was plotted from field notes of actual surveys made by me or under my supervision, and that the same is true and correct to the best of my knowledge and belief.

Date Surveyed

June 12, 1973
Registered Professional Engineer
and/or Land Surveyor

E. V. Echohawk
Certificate No. 3602
E. V. Echohawk LS

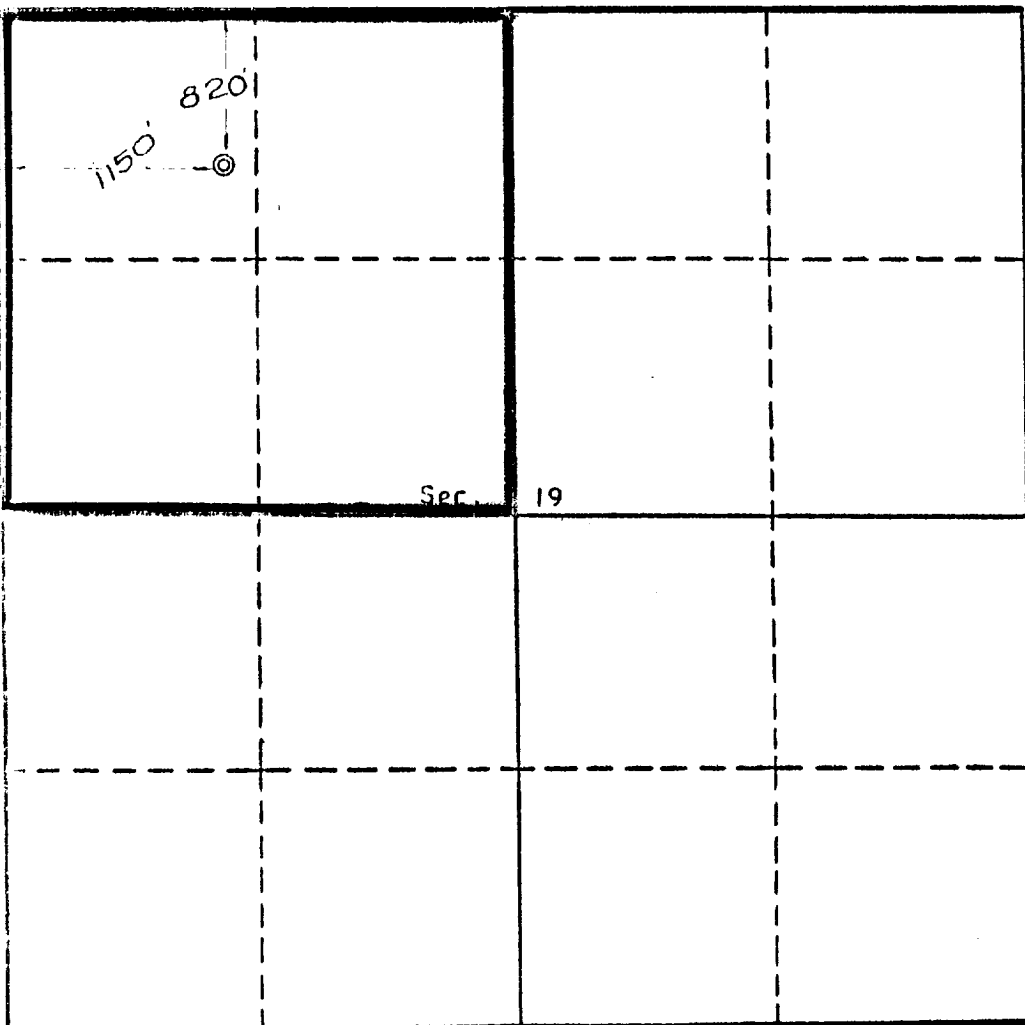

Scale, 1 inch = 1,000 feet

DEVELOPMENT PLAN
JICARILLA TRIBAL 359 NO. 1

The location is very near an existing road and only 0.1 mile of new road will have to be constructed. Approximately 4.3 miles of existing road will be improved. The road and location are in a flat area of sagebrush and no timber will be involved. Approval for surface work will be obtained from the Jicarilla Apache Tribe.

There are no camps or airstrips nearby. Arrangements have been made to truck water from Largo Canyon for drilling purposes. Hauling distance is 41 miles. Upon completion of the well the location will be cleaned, leveled and the reserve pits backfilled. The attached sketches show in detail the location of the proposed well.

Location SKETCH

Jicarilla Tribal 359-1

820' FNL, 1150' FWL SECTION 19, Twn 22, Rge 2w

Sandoval County, New Mexico

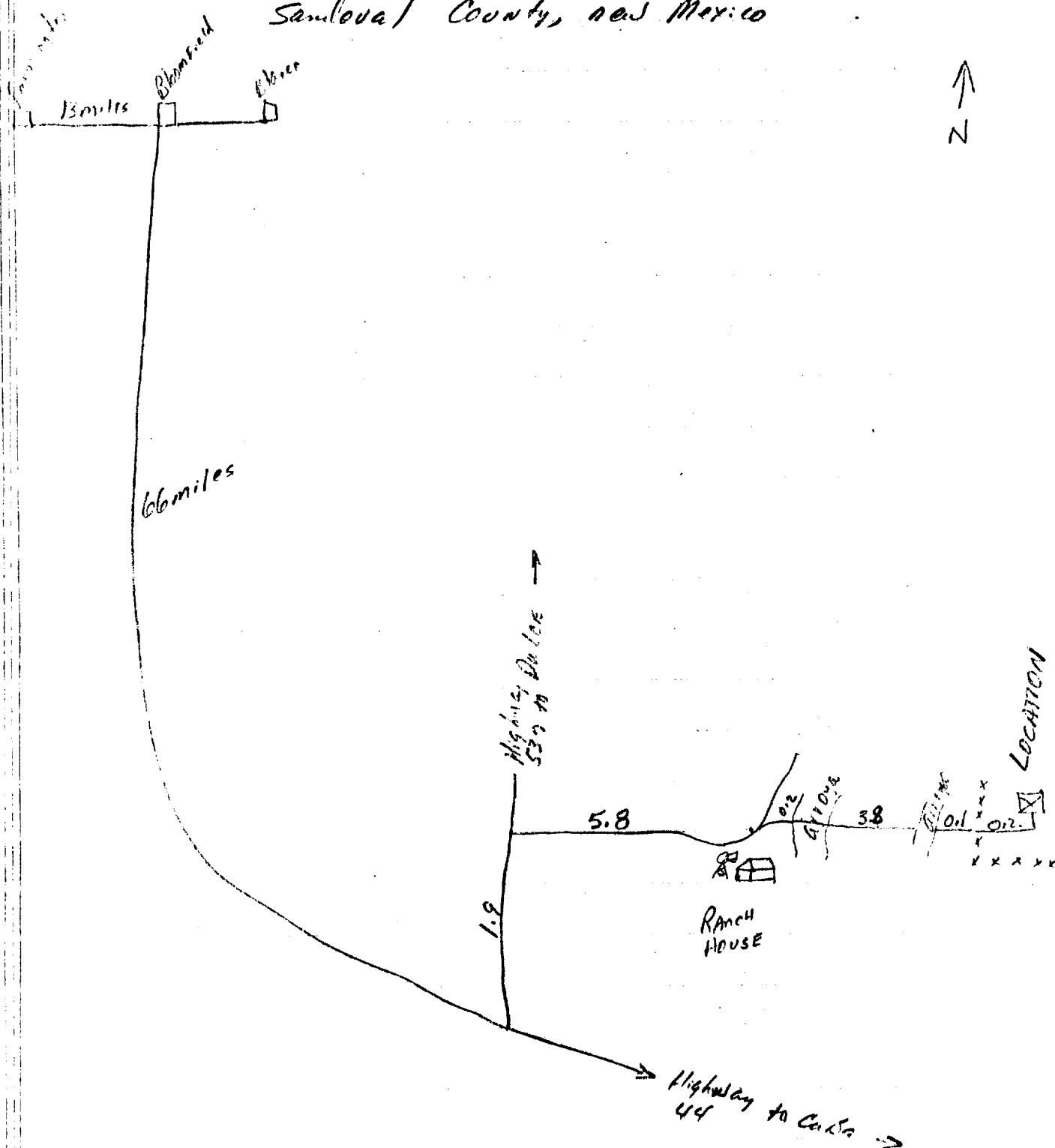

VICARILLA TRIBAL 359 No. 1
 820'FWL X 1150'FWL, SEC 19, T22N, R2W
 SANDOVAL COUNTY, NEW MEXICO

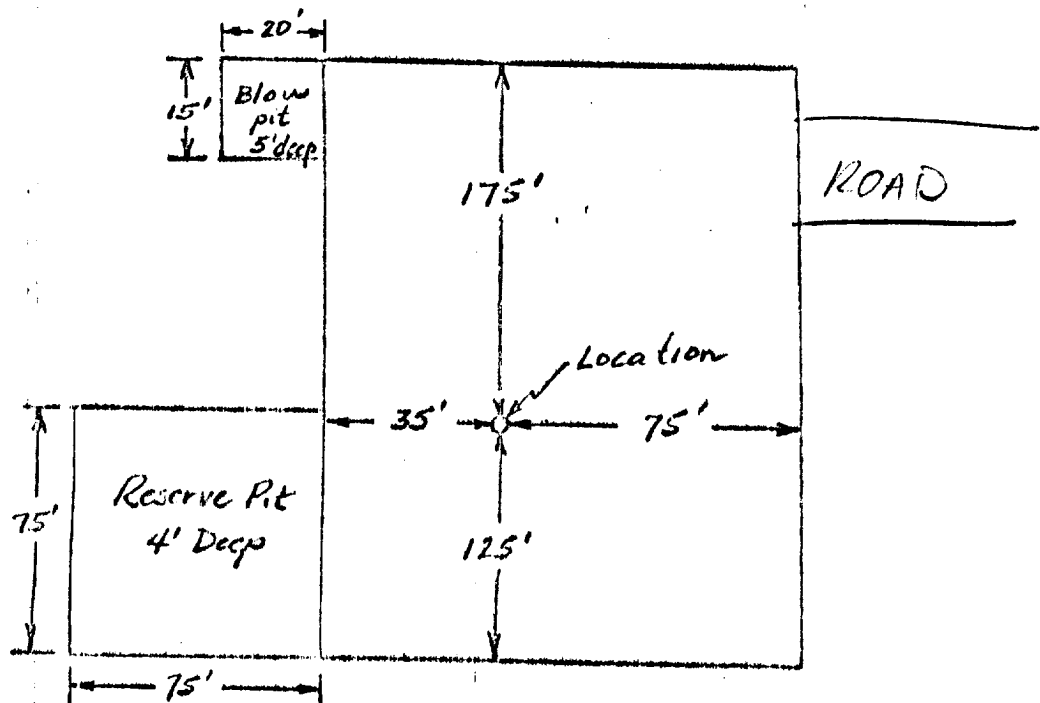

Amoco Production Company

SCALE: NONE

DRILLING LOCATION SPECIFICATION

DRG.