

UNITED STATES
DEPARTMENT OF THE INTERIOR
GEOLOGICAL SURVEY

APPLICATION FOR PERMIT TO DRILL, DEEPEN, OR PLUG BACK

1a. TYPE OF WORK DRILL <input checked="" type="checkbox"/> DEEPEN <input type="checkbox"/> PLUG BACK <input type="checkbox"/>			5. LEASE DESIGNATION AND SERIAL NO. NM 0557103	
b. TYPE OF WELL OIL WELL <input checked="" type="checkbox"/> GAS WELL <input type="checkbox"/> OTHER <input type="checkbox"/> SINGLE ZONE <input type="checkbox"/> MULTIPLE ZONE <input type="checkbox"/>			6. IF INDIAN, ALLOTTEE OR TRIBE NAME	
2. NAME OF OPERATOR VAL R. REESE, INC.			7. UNIT AGREEMENT NAME None	
3. ADDRESS OF OPERATOR 900 Bank of New Mexico Building, Albuquerque, New Mexico 87101			8. FARM OR LEASE NAME Cabezon	
4. LOCATION OF WELL (Report location clearly and in accordance with any State requirements.)* At surface 945' fs1, 1970' fwl At proposed prod. zone 945' fs1, 1970' fwl			9. WELL NO. 5	
14. DISTANCE IN MILES AND DIRECTION FROM NEAREST TOWN OR POST OFFICE* 12 miles south of Torreon, New Mexico			10. FIELD AND POOL, OR WILDCAT Wildcat	
16. DISTANCE FROM PROPOSED* LOCATION TO NEAREST PROPERTY OR LEASE LINE, FT. (Also to nearest drlg. unit line, if any) 945'			11. SEC., T., R., M., OR BLK. AND SURVEY OR AREA Sec 29, T17N-R4N, NMPM	
18. DISTANCE FROM PROPOSED LOCATION* TO NEAREST WELL, DRILLING, COMPLETED, OR APPLIED FOR, ON THIS LEASE, FT. 330'			12. COUNTY OR PARISH Sandoval	
19. PROPOSED DEPTH 500'			13. STATE New Mexico	
20. ROTARY OR CABLE TOOLS Rotary			22. APPROX. DATE WORK WILL START* November 5, 1973	
21. ELEVATIONS (Show whether DF, RT, GR, etc.) 6331' CR				

23. PROPOSED CASING AND CEMENTING PROGRAM				
SIZE OF HOLE	SIZE OF CASING	WEIGHT PER FOOT	SETTING DEPTH	QUANTITY OF CEMENT
6-3/4"	4-1/2"	9.5#	500'	40 sx

Propose to drill well to 500' or to bottom of Menefee sands to test Menefee.

If production encountered in Menefee, will set casing and complete.

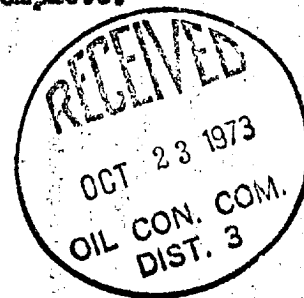

IN ABOVE SPACE DESCRIBE PROPOSED PROGRAM: If proposal is to deepen or plug back, give data on present productive zone and proposed new productive zone. If proposal is to drill or deepen directionally, give pertinent data on subsurface locations and measured and true vertical depths. Give blowout preventer program, if any.

24. SIGNED Val R. Reese TITLE President DATE October 16, 1973

(This space for Federal or State office use)

PERMIT NO. _____ APPROVAL DATE _____

APPROVED BY 24 TITLE _____ DATE _____

CONDITIONS OF APPROVAL, IF ANY:

NEW MEXICO OIL CONSERVATION COMMISSION
WELL LOCATION AND ACREAGE DEDICATION PLAT

Form C-128
Supersedes C-128
Effective 1-1-65

All distances must be from the outer boundaries of the Section.

Operator VAL R. REESE, INC.			Lease Federal Lease NM 0557203 - Cabezon		Well No. 5
Unit Letter M	Section 29	Township 17 North	Range 4 West	County Sandoval	
Actual Footage Location of Well: 945 feet from the South line and 1970 feet from the West line					
Ground Level Elev. 6331	Producing Formation Menofco		Pool Mildcat	Dedicated Acreage: 1.0 Acres	

1. Outline the acreage dedicated to the subject well by colored pencil or hachure marks on the plat below.
2. If more than one lease is dedicated to the well, outline each and identify the ownership thereof (both as to working interest and royalty).
3. If more than one lease of different ownership is dedicated to the well, have the interests of all owners been consolidated by communitization, unitization, force-pooling, etc?

☐ Yes ☐ No If answer is "yes," type of consolidation _____

If answer is "no," list the owners and tract descriptions which have actually been consolidated. (Use reverse side of this form if necessary.) _____

No allowable will be assigned to the well until all interests have been consolidated (by communitization, unitization, forced-pooling, or otherwise) or until a non-standard unit, eliminating such interests, has been approved by the Commission.

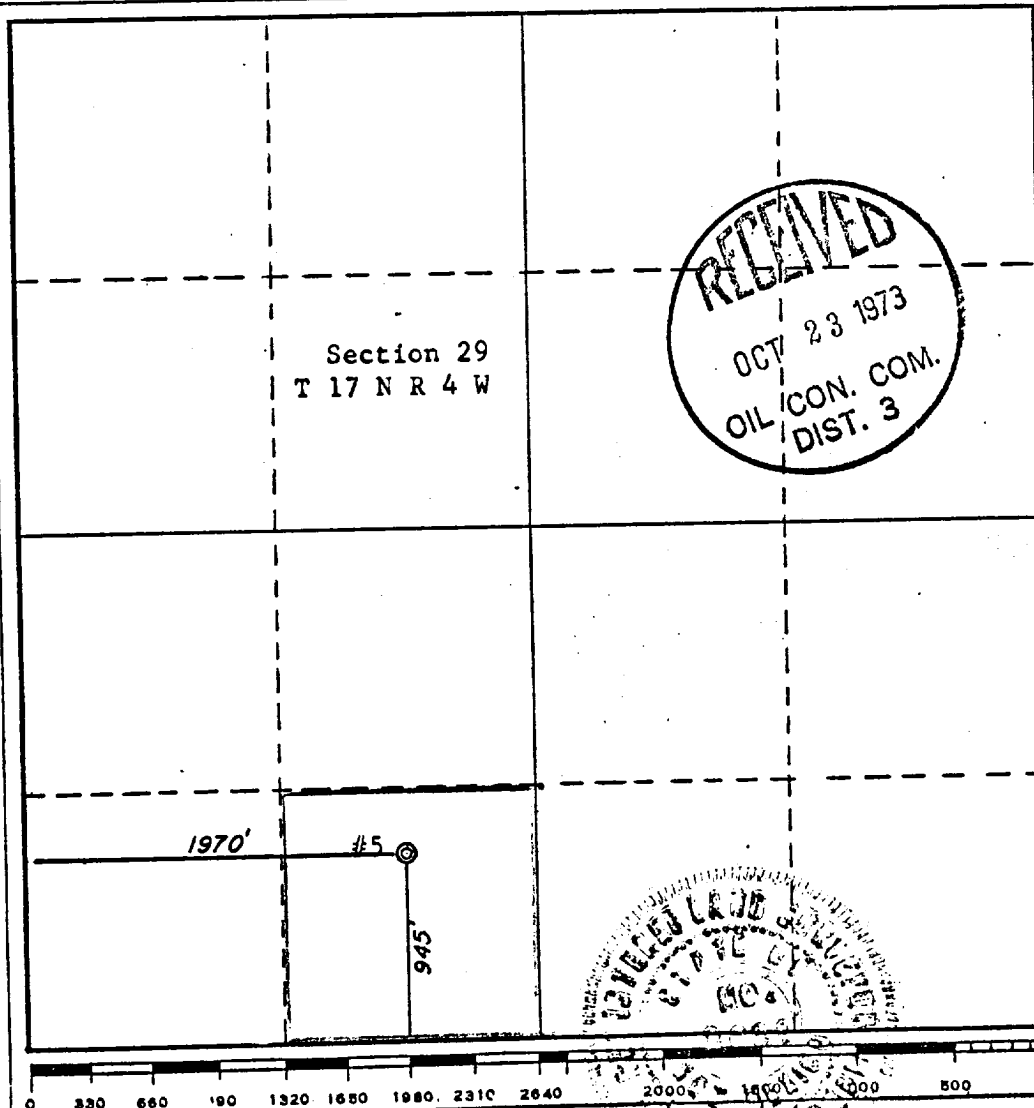

CERTIFICATION

I hereby certify that the information contained herein is true and complete to the best of my knowledge and belief.

Name
Val R. Reese

Position
President

Company
VAL R. REESE, INC.

Date
October 16, 1973

I hereby certify that the well location shown on this plat was plotted from field notes of actual surveys made by me or under my supervision, and that the same is true and correct to the best of my knowledge and belief.

Date Surveyed

October 8, 1973

Registered Professional Engineer and/or Land Surveyor

Ed S. Therman

Certificate No.

2031

MORRIS B. JONES
CONSULTING PETROLEUM ENGINEER
823 BANK OF NEW MEXICO BLDG.
ALBUQUERQUE, NEW MEXICO 87101

October 16, 1973

Mr. Jerry W. Long, District Engineer
U. S. Geological Survey
P. O. Box 1809
Durango, Colorado 81301

Re: Development Plan for Surface Use
Federal Lease No. NM 0557103
Val R. Reese, Inc. No. 5 Cabezon
945' fsl, 1970' fwl Sec 29-T17N-R4W
Sandoval County, New Mexico

Dear Jerry:

Attached is an Application for Permit to Drill on the above referenced well together with a map showing information required for Items 1, 2, 3, and 4 of the U.S.G.S. requirements for development.

If the well is successful, the tank battery will be set at the well site. The well is to be drilled with air, and there will be no water supply or waste disposal.

We do not plan to do any surface damage, but plan to use the existing roads which have been recently graded in the area. We plan to use a small portable, truck-mounted rotary and drill with air and will not be constructing a location or digging pits.

Sincerely,

Morris B. Jones

MBJ:mb



