

NO. OF COPIES RECEIVED	7
DISTRIBUTION	
SANTA FE	1
FILE	1
U.S.G.S.	2
LAND OFFICE	
OPERATOR	3

NEW MEXICO OIL CONSERVATION COMMISSION

30-043-26271
Form C-101
Revised 1-1-65.

5A. Indicate Type of Lease
STATE <input checked="" type="checkbox"/> FEE <input type="checkbox"/>
5. State Oil & Gas Lease No.
K-4844

APPLICATION FOR PERMIT TO DRILL, DEEPEN, OR PLUG BACK

1a. Type of Work		7. Unit Agreement Name	
b. Type of Well OIL WELL <input type="checkbox"/> GAS WELL <input checked="" type="checkbox"/> OTHER <input type="checkbox"/>		N/A	
DRILL <input checked="" type="checkbox"/> DEEPEN <input type="checkbox"/> PLUG BACK <input type="checkbox"/>		8. Farm or Lease Name	
SINGLE ZONE <input type="checkbox"/> MULTIPLE ZONE <input checked="" type="checkbox"/>		Mesa State <u>22</u>	
2. Name of Operator		9. Well No.	
Basin Fuels, Incorporated		1	
3. Address of Operator		10. Field and Pool, or Wildcat	
Suite 300, 300 W. Arrington, Farmington, N.M. 87401		Bastya Chacra	
4. Location of Well		12. County	
UNIT LETTER <u>F</u> LOCATED <u>1520</u> FEET FROM THE <u>North</u> LINE		Sandoval	
AND <u>1685'</u> FEET FROM THE <u>West</u> LINE OF SEC. <u>32</u> TWP. <u>22N</u> RGE. <u>7W</u> NMPM			
19. Proposed Depth		19A. Formation	
1900'		Chacra	
20. Rotary or C.T.		Rotary	
21. Elevations (Show whether DF, RT, etc.)		22. Approx. Date Work will start	
6638' GL		May 15, 1977	
21A. Kind & Status Plug. Bond		21B. Drilling Contractor	
Statewide		Lee Wilson	

PROPOSED CASING AND CEMENT PROGRAM

SIZE OF HOLE	SIZE OF CASING	WEIGHT PER FOOT	SETTING DEPTH	SACKS OF CEMENT	EST. TOP
9-7/8"	7"	28 lb.	100'	75	Circulate Cement
6-1/4"	4 1/2"	9 1/2 lb.	1900'	100	1400'

Set 7" surface casing at 100' and circulate cement. Drill to 1900', run logs, if production is indicated set and cement 4 1/2" production casing with 100 sacks cement. Gun perforate, fracture treat in a completion attempt. If non-commercial, will plug and abandon in accordance with state abandonment regulations and restore surface.

A single manual blow-out preventer with drill rams will be used at all times material to the drilling of the well.

The well is not dedicated to a pipeline.

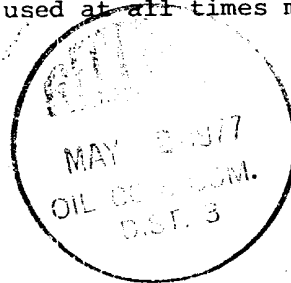

EXPIRES 7-31-77

IN ABOVE SPACE DESCRIBE PROPOSED PROGRAM: IF PROPOSAL IS TO DEEPEN OR PLUG BACK, GIVE DATA ON PRESENT PRODUCTIVE ZONE AND PROPOSED NEW PRODUCTIVE ZONE. GIVE BLOWOUT PREVENTER PROGRAM, IF ANY.

I hereby certify that the information above is true and complete to the best of my knowledge and belief.

Signed John B. Bunn Title President Date 4/29/77

(This space for State Use)

APPROVED BY AR Hendrick TITLE SECRETARY DIST. 3 DATE MAY 2 1977

CONDITIONS OF APPROVAL, IF ANY:

**NEW MEXICO OIL CONSERVATION COMMISSION
WELL LOCATION AND ACERAGE DEDICATION PLAT**

All distances must be from the outer boundaries of the Section

Operator BASIN FUELS, INCORPORATED		Lease Mesa State 32		Well No. 22-1
Unit Letter F	Section 32	Township 22 NORTH	Range 7 WEST	County SANDOVAL
Actual Footage Location of Well: <div style="display: flex; justify-content: space-between;"> 1520 feet from the NORTH line and 1685 feet from the WEST line </div>				
Ground Level Elev. 6638	Producing Formation Chacra (La Ventana)	Pool Undesignated	Dedicated Acreage: 160 Acres	

1. Outline the acreage dedicated to the subject well by colored pencil or hatchure marks on the plat below.
2. If more than one lease is dedicated to the well, outline each and identify the ownership thereof (both as to working interest and royalty).
3. If more than one lease of different ownership is dedicated to the well, have the interests of all owners been consolidated by communitization, unitization, force-pooling, etc?
☐ Yes ☐ No If answer is "yes," type of consolidation _____

If answer is "no," list the owners and tract descriptions which have actually consolidated. (Use reverse side of this form if necessary.) _____

No allowable will be assigned to the well until all interests have been consolidated (by communitization, unitization, forced-pooling, or otherwise) or until a non standard unit, eliminating such interests, has been approved by the Commission.

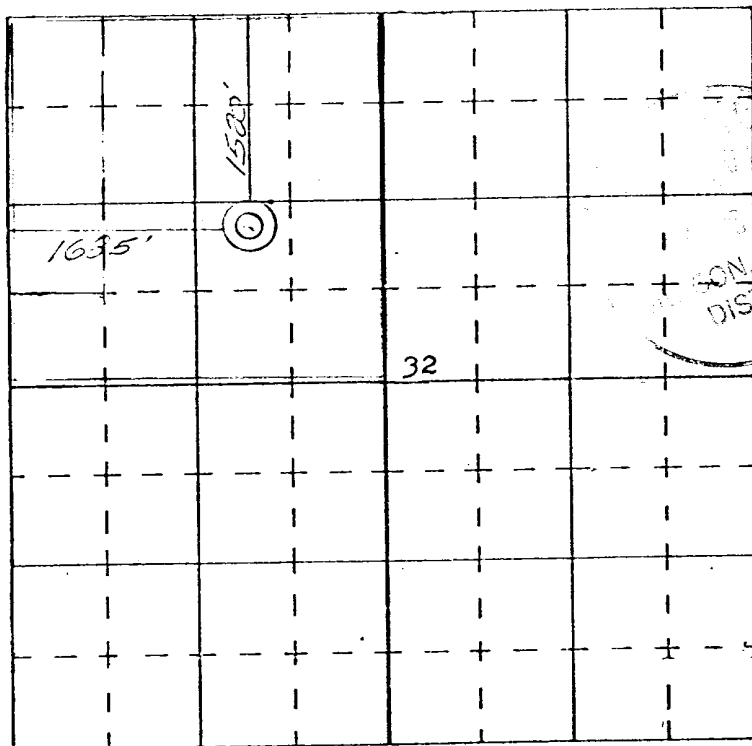

SCALE—4 INCHES EQUALS 1 MILE

SAN JUAN ENGINEERING COMPANY, FARMINGTON, N. M.

CERTIFICATION

I hereby certify that the information contained herein is true and complete to the best of my knowledge and belief.

Joel B. Burr, Jr.
Joel B. Burr, Jr.
 Name _____

President
 Position _____

Basin Fuels, Incorporated
 Company _____

4/29/77
 Date _____

I hereby certify that the well location shown on this plat was plotted from field notes of actual surveys made by me or under my supervision, and that the same is true and correct to the best of my knowledge and belief.

26 April 1977
 Date Surveyed _____

James P. Leese
 Registered Professional Engineer
 and/or Land Surveyor **James P. Leese**

1463

Certificate No.

UNITED STATES
DEPARTMENT OF THE INTERIOR
GEOLOGICAL SURVEY

