

UNITED STATES  
DEPARTMENT OF THE INTERIOR  
GEOLOGICAL SURVEY

30-043-20300

## APPLICATION FOR PERMIT TO DRILL, DEEPEN, OR PLUG BACK

1a. TYPE OF WORK DRILL <input checked="" type="checkbox"/> DEEPEN <input type="checkbox"/> PLUG BACK <input type="checkbox"/>		5. LEASE DESIGNATION AND SERIAL NO. Contract No. 183	
b. TYPE OF WELL OIL WELL <input checked="" type="checkbox"/> GAS WELL <input type="checkbox"/> OTHER <input type="checkbox"/> SINGLE ZONE <input checked="" type="checkbox"/> MULTIPLE ZONE <input type="checkbox"/>		6. IF INDIAN, ALLOTTEE OR TRIBE NAME Jicarilla Apache	
2. NAME OF OPERATOR ODESSA NATURAL CORPORATION ATTN: John Strojek		7. UNIT AGREEMENT NAME	
3. ADDRESS OF OPERATOR P.O.Box 3908 Odessa, Texas 79760		8. FARM OR LEASE NAME Chacon Jicarilla "D"	
4. LOCATION OF WELL (Report location clearly and in accordance with any State requirements.) At surface 1700'FSL, 790'FEL At proposed prod. zone Same		9. WELL NO. 10	
14. DISTANCE IN MILES AND DIRECTION FROM NEAREST TOWN OR POST OFFICE* Not applicable		10. FIELD AND POOL, OR WILDCAT ChaconDakotaOil Pool Associated	
15. DISTANCE FROM PROPOSED* LOCATION TO NEAREST PROPERTY OR LEASE LINE, FT. (Also to nearest drig. unit line, if any) 790'		11. SEC., T., R., M., OR BLK. AND SURVEY OR AREA Sec. 27-T23N-R3W N.M.P.M.	
18. DISTANCE FROM PROPOSED LOCATION* TO NEAREST WELL, DRILLING, COMPLETED, OR APPLIED FOR, ON THIS LEASE, FT. -		12. COUNTY OR PARISH 13. STATE Sandoval NewMexico	
16. NO. OF ACRES IN LEASE -		17. NO. OF ACRES ASSIGNED TO THIS WELL 160	
19. PROPOSED DEPTH 7520'		20. ROTARY OR CABLE TOOLS Rotary	
21. ELEVATIONS (Show whether DF, RT, GR, etc.) 7301'GL, 7314'DF, 7315'KB		22. APPROX. DATE WORK WILL START* 12-1-77	

## PROPOSED CASING AND CEMENTING PROGRAM

SIZE OF HOLE	SIZE OF CASING	WEIGHT PER FOOT	SETTING DEPTH	QUANTITY OF CEMENT
12-1/4"	8-5/8"	24.0	250'	250 sacks
7-7/8"	4-1/2"	10.50 & 11.60	7520'	To be determined

It is proposed to drill this well with rotary tools, using oil base mud as circulation medium, through the Dakota Formation. Possible productive zones in the Dakota Formation will be completed. Production casing will be cemented in such a manner as to protect the Pictured Cliffs formation.

## Estimated Formation Tops

Pictured Cliffs	2950'	Greenhorn	7040'
Cliff House	4520'	Graneros	7100'
Gallup	6060'	Dakota	7120'

The SE/4 Section 27 is dedicated to this well.

The natural gas produced from this well is committed.

IN ABOVE SPACE DESCRIBE PROPOSED PROGRAM: If proposal is to deepen or plug back, give data on present productive zone and proposed new productive zone. If proposal is to drill or deepen directionally, give pertinent data on subsurface locations and measured and true vertical depths. Give blowout preventer program, if any.

24. FOR: Odessa Natural Corp. President, Walsh Engineering  
Ewell N. Walsh, P.E. TITLE & Production Corp. DATE 10-17-77  
(This space for Federal or State office use)

PERMIT NO. \_\_\_\_\_ APPROVAL DATE \_\_\_\_\_

APPROVED BY \_\_\_\_\_ TITLE \_\_\_\_\_ DATE \_\_\_\_\_  
CONDITIONS OF APPROVAL, IF ANY:

NEW MEXICO OIL CONSERVATION COMMISSION  
WELL LOCATION AND ACREAGE DEDICATION PLAT

Form C-102  
Supersedes C-128  
Effective 1-1-65

All distances must be from the outer boundaries of the Section.

Operator <b>Odessa Natural Corporation</b>		Lease <b>Chacon-Jicarilla "D"</b>		Well No. <b>10</b>
Unit Letter <b>I</b>	Section <b>27</b>	Township <b>23N</b>	Range <b>3W</b>	County <b>Sandoval</b>
Actual Footage Location of Well: <b>1700</b> feet from the <b>South</b> line and <b>790</b> feet from the <b>East</b> line				
Ground Level Elev. <b>7301</b>	Producing Formation <b>Dakota</b>		Pool <b>Chacon Dakota Associated Oil Pool</b>	Dedicated Acreage: <b>160</b> Acres

1. Outline the acreage dedicated to the subject well by colored pencil or hachure marks on the plat below.
2. If more than one lease is dedicated to the well, outline each and identify the ownership thereof (both as to working interest and royalty).
3. If more than one lease of different ownership is dedicated to the well, have the interests of all owners been consolidated by communitization, unitization, force-pooling, etc?

☐ Yes ☐ No If answer is "yes," type of consolidation \_\_\_\_\_

If answer is "no," list the owners and tract descriptions which have actually been consolidated. (Use reverse side of this form if necessary.) \_\_\_\_\_

No allowable will be assigned to the well until all interests have been consolidated (by communitization, unitization, forced-pooling, or otherwise) or until a non-standard unit, eliminating such interests, has been approved by the Commission.

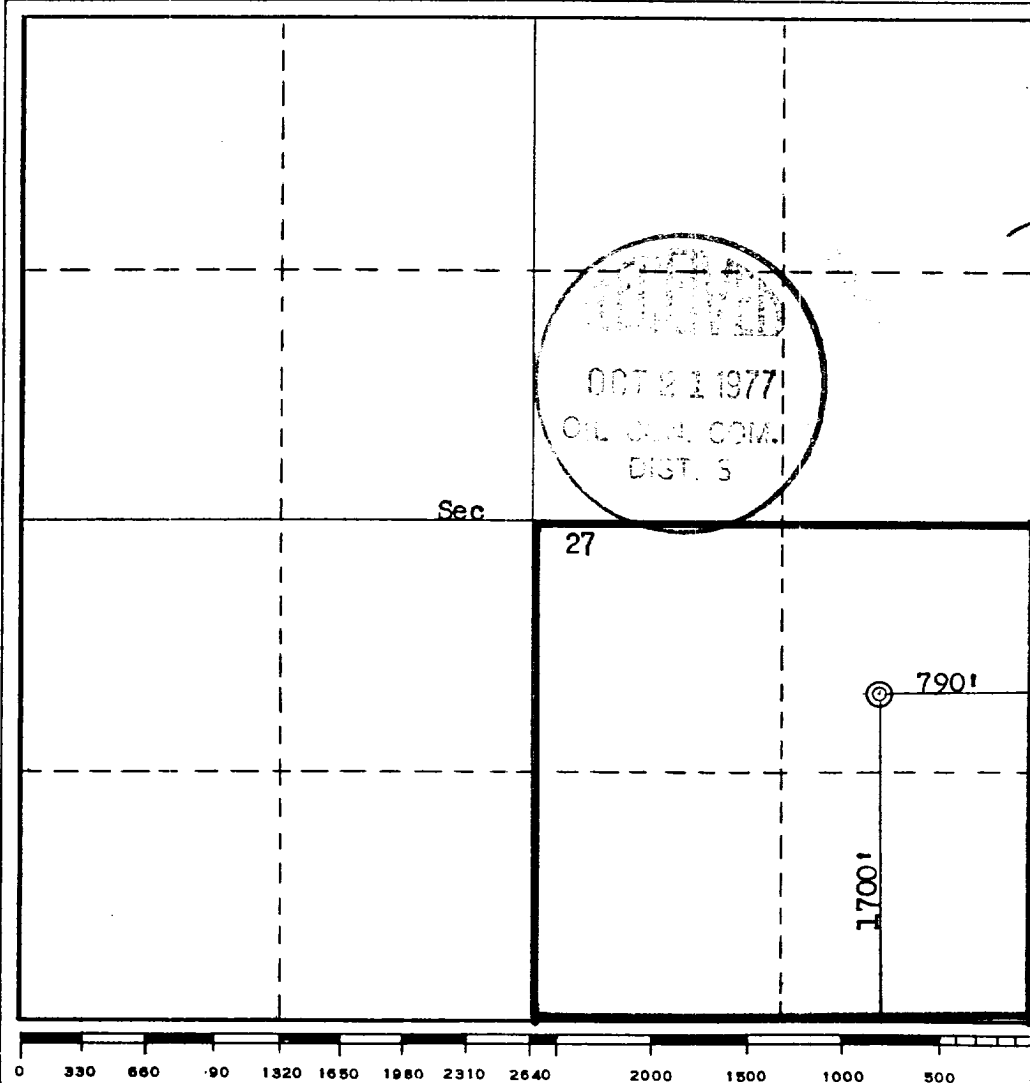

CERTIFICATION

I hereby certify that the information contained herein is true and complete to the best of my knowledge and belief.

*Ewell N. Walsh*

Name  
**Ewell N. Walsh, P.E.**

Position  
**President**

Company  
**Walsh Engr. & Prod. Corp.**

Date  
**10-17-77**

I hereby certify that the well location shown on this plat was plotted from field notes of actual surveys made by me or under my supervision, and that the same is true and correct to the best of my knowledge and belief.

Date Surveyed  
**September 21, 1977**

Registered Professional Engineer and/or Land Surveyor

*Fred B. Kern Jr.*  
**Fred B. Kern Jr.**

Certificate No.  
**3950**

