

UNITED STATES
DEPARTMENT OF THE INTERIOR
GEOLOGICAL SURVEY

APPLICATION FOR PERMIT TO DRILL, DEEPEN, OR PLUG BACK

1a. TYPE OF WORK

DRILL ☒DEEPEN ☐PLUG BACK ☐

b. TYPE OF WELL

OIL
WELL ☒GAS
WELL ☐OTHER ☐SINGLE
ZONE ☐MULTIPLE
ZONE ☐

2. NAME OF OPERATOR

Dave M. Thoams, Jr.

3. ADDRESS OF OPERATOR

P.O. Box 2026, Farmington, New Mexico 87401

4. LOCATION OF WELL (Report location clearly and in accordance with any State requirements.*)

At surface

790'FSL, 790'FWL

At proposed pred. zone

Same

14. DISTANCE IN MILES AND DIRECTION FROM NEAREST TOWN OR POST OFFICE*

Not Applicable

15. DISTANCE FROM PROPOSED*

LOCATION TO NEAREST

PROPERTY OR LEASE LINE, FT.

(Also to nearest drlg. unit line, if any)

790'

18. DISTANCE FROM PROPOSED LOCATION*

TO NEAREST WELL, DRILLING, COMPLETED,

OR APPLIED FOR, ON THIS LEASE, FT.

1 Mile

16. NO. OF ACRES IN LEASE

19. PROPOSED DEPTH

7580'

17. NO. OF ACRES ASSIGNED
TO THIS WELL

160

20. ROTARY OR CABLE TOOLS

Rotary

21. ELEVATIONS (Show whether DF, RT, GR, etc.)

7351'GL, 7364'DF, 7365'KB

22. APPROX. DATE WORK WILL START*

1-30-79

23. PROPOSED CASING AND CEMENTING PROGRAM

SIZE OF HOLE	SIZE OF CASING	WEIGHT PER FOOT	SETTING DEPTH	QUANTITY OF CEMENT
12-1/4"	8-5/8"	24.0	250	250 Sacks
7-7/8"	4-1/2"	10.50 & 11.60	7580	To be determined

It is proposed to drill this well with rotary tools, using oil base mud as circulation medium, through the Dakota Formation. Possible productive zones in the Dakota Formation will be completed. Production casing will be cemented in such a manner as to protect the Pictured Cliffs Formation.

ESTIMATED FORMATION TOPS

Pictured Cliffs
Cliff House
Gallup2978'
4541'
6129'Green Horn
Graneros
Dakota7109'
7165'
7197'

The SW/4 Section 25 is dedicated to this well.

The natural gas produced from this well is committed.

IN ABOVE SPACE DESCRIBE PROPOSED PROGRAM: If proposal is to deepen or plug back, give data on present productive zone and proposed new productive zone. If proposal is to drill or deepen directionally, give pertinent data on subsurface locations and measured and true vertical depths. Give blowout preventer program, if any.

24. FOR: Dave M. Thomas, Jr.

President, Walsh Engineering &

SIGNED

Ewell N. Walsh, P.E.

TITLE Production Corporation

DATE 12-28-78

(This space for Federal or State office use)

PERMIT NO.

APPROVAL DATE

APPROVED BY

TITLE

DATE

CONDITIONS OF APPROVAL, IF ANY:

ok Frank

*See Instructions On Reverse Side

**NEW MEXICO OIL CONSERVATION COMMISSION
WELL LOCATION AND ACREAGE DEDICATION PLAT**

Form C-102
Supersedes C-128
Effective 1-1-65

All distances must be from the outer boundaries of the Section.

Operator DAVE M. THOMAS JR.			Lease CHACON JICARILLA APACHE "D"		Well No. 104
Unit Letter M	Section 25	Township 23N	Range 3W	County SANDOVAL	
Actual Footage Location of Well: 790 feet from the South line and 790 feet from the West line					
Ground Level Elev. 7351	Producing Formation Dakota		Pool Chacon Dakota Associated		Dedicated Acreage: 160 Acres

1. Outline the acreage dedicated to the subject well by colored pencil or hachure marks on the plat below.
2. If more than one lease is dedicated to the well, outline each and identify the ownership thereof (both as to working interest and royalty).
3. If more than one lease of different ownership is dedicated to the well, have the interests of all owners been consolidated by communitization, unitization, force-pooling, etc?

☐ Yes ☐ No If answer is "yes," type of consolidation _____

If answer is "no," list the owners and tract descriptions which have actually been consolidated. (Use reverse side of this form if necessary.) _____

No allowable will be assigned to the well until all interests have been consolidated (by communitization, unitization, forced-pooling, or otherwise) or until a non-standard unit, eliminating such interests, has been approved by the Commission.

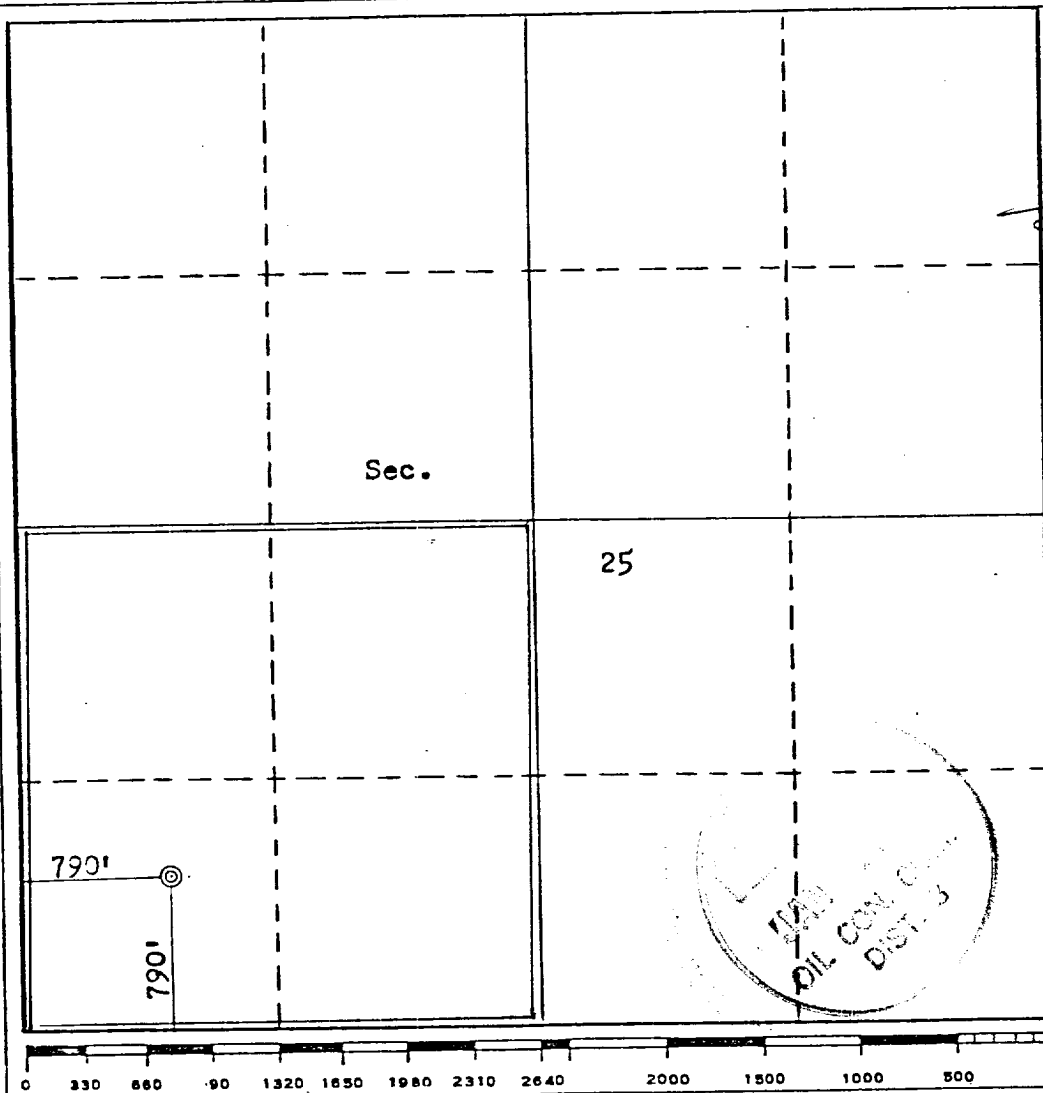

CERTIFICATION

I hereby certify that the information contained herein is true and complete to the best of my knowledge and belief.

FOR: **Dave M. Thomas, Jr.**

Name **Ewell N. Walsh, P.E.**

Position **President**

Walsh Engineering &

Company

Production Corporation

Date

December 28, 1978

I hereby certify that the well location shown on this plat was plotted from field notes of actual surveys made by me or under my supervision, and that the same is true and correct to the best of my knowledge and belief.

Date Surveyed

December 27, 1978

Registered Professional Engineer and/or Land Surveyor

Fred B. Kerr, Jr.

Certificate No. **3950**

B. KERR, JR.

100 ARIZONA CO
 BAPTIST CHURCH

RIO ARRIBA
SANDOVAN CI

RZW

23

24

25

乙亥

Ex 10 Litoy Road