

UNITED STATES
DEPARTMENT OF THE INTERIOR
GEOLOGICAL SURVEY

APPLICATION FOR PERMIT TO DRILL, DEEPEN, OR PLUG BACK

1a. TYPE OF WORK
DRILL ☒ DEEPEN ☐ PLUG BACK ☐b. TYPE OF WELL
OIL WELL ☒ GAS WELL ☒ OTHER ☐ SINGLE ZONE ☒ MULTIPLE ZONE ☐

2. NAME OF OPERATOR

The SUPERIOR OIL Co

3. ADDRESS OF OPERATOR

P. O. DRAWER 'G', CORTEZ, COLORADO 81321

4. LOCATION OF WELL (Report location clearly and in accordance with any State requirements.*)
At surfaceI 1850' FSL and 980' FEL of Sec. 35
At proposed prod. zone

Same as surface

14. DISTANCE IN MILES AND DIRECTION FROM NEAREST TOWN OR POST OFFICE*

8.2 miles west of La Jara, New Mexico

15. DISTANCE FROM PROPOSED*
LOCATION TO NEAREST
PROPERTY OR LEASE LINE, FT.
(Also to nearest drlg. unit line, if any)

790'

16. NO. OF ACRES IN LEASE
32017. NO. OF ACRES ASSIGNED
TO THIS WELL
160.1118. DISTANCE FROM PROPOSED LOCATION*
TO NEAREST WELL, DRILLING, COMPLETED,
OR APPLIED FOR, ON THIS LEASE, FT.

812'

19. PROPOSED DEPTH
7450'20. ROTARY OR CABLE TOOLS
Rotary

21. ELEVATIONS (Show whether DF, RT, GR, etc.)

7260' Ungraded Ground Level

22. APPROX. DATE WORK WILL START*
August 15, 1980

23. PROPOSED CASING AND CEMENTING PROGRAM

SIZE OF HOLE	SIZE OF CASING	WEIGHT PER FOOT	SETTING DEPTH	QUANTITY OF CEMENT
16"	New 13-3/8"	54.5# K-55	50'	25 sx
12-1/4"	New 9-5/8"	36# K-55	285'	150 sx
7-7/8"	New 5-1/2"	15.5# K-55	7450'	1000 sx

1. Drill 16" hole to 50'. Set 50' of new 13-3/8" 54.5# K-55 casing. Cement to surface with 25 sx.
2. Drill 12-1/4" hole to 285' with fresh water mud system. Set 285' of new 9-5/8" 36# K-55 casing to 285'. Cement to surface with 150 sx. NU BOP.
3. Drill 7-7/8" hole to 7450' with fresh water mud system.
4. Log well. Set 7450' of new 5-1/2" 15.5# K-55 casing and cement with 1000 sx.
5. Perforate Dakota formation and stimulate as necessary.

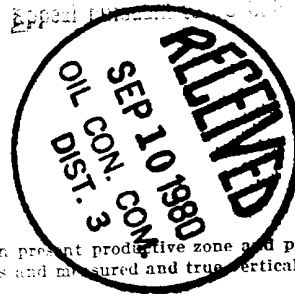

IN ABOVE SPACE DESCRIBE PROPOSED PROGRAM: If proposal is to deepen or plug back, give data on present productive zone and proposed new productive zone. If proposal is to drill or deepen directionally, give pertinent data on subsurface locations and measured and true vertical depths. Give blowout preventer program, if any.

24.

SIGNED

D. B. Bradford

TITLE

Production Engineer

DATE

August 5, 1980

(This space for Federal or State office use)

PERMIT NO.

APPROVAL DATE

APPROVED BY

TITLE

CONDITIONS OF APPROVAL, IF ANY:

ah 3.24

APPROVED
AS AMENDED
DATE

SEP 10 1980

G. P. SIMS
DISTRICT ENGINEER

NMOCC

NEW MEXICO OIL CONSERVATION COMMISSION
WELL LOCATION AND ACREAGE DEDICATION PLAT

Form C-162
Supersedes C-128
Effective 1-1-65

All distances must be from the outer boundaries of the Section.

Property SUPERIOR OIL			Lease Jicarilla 55		Well No. 2
Section I	Section 35	Township 23N	Range 3W	County Sandoval	
Acreage Dedication of Well:					
1850 feet from the south line and		980 feet from the east line			
Depth of well Elev. 7260'	Producing Formation Dakota	Pool Dakota	Dedicated Acreage: 160.11 Acres		

1. Outline the acreage dedicated to the subject well by colored pencil or hachure marks on the plat below.
2. If more than one lease is dedicated to the well, outline each and identify the ownership thereof (both as to working interest and royalty).
3. If more than one lease of different ownership is dedicated to the well, have the interests of all owners been consolidated by communitization, unitization, force-pooling, etc?

☐ Yes ☐ No If answer is "yes," type of consolidation _____

If answer is "no," list the owners and tract descriptions which have actually been consolidated. (Use reverse side of this form if necessary.) _____

No allowable will be assigned to the well until all interests have been consolidated (by communitization, unitization, forced-pooling, or otherwise) or until a non-standard unit, eliminating such interests, has been approved by the Commission.

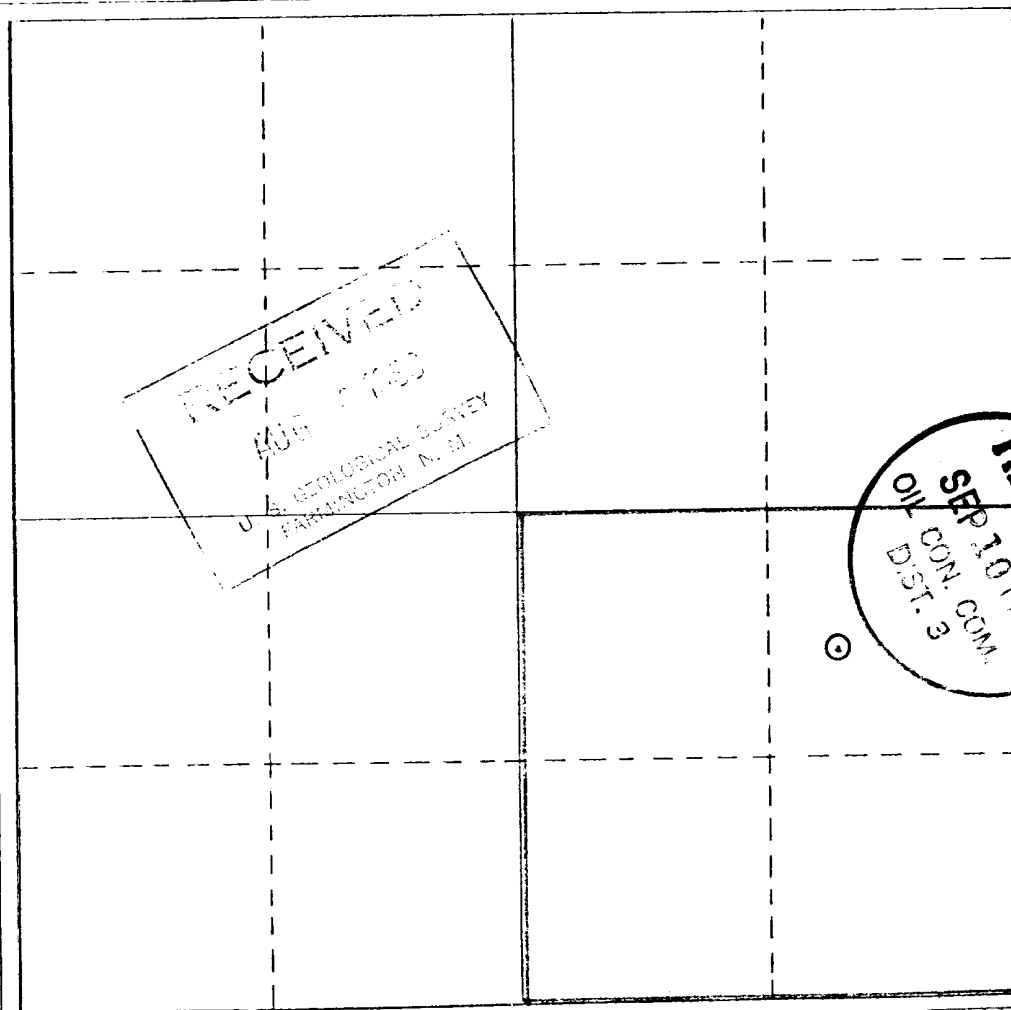

CERTIFICATION

I hereby certify that the information contained herein is true and complete to the best of my knowledge and belief.

Wm. H. Edwards

Name
Wm. H. Edwards

Position
Spec. Projects Superin.

Company
SUPERIOR OIL

Date

I hereby certify that the well location shown on this plat was plotted from field notes of actual surveys made by me or under my supervision, and that the same is true and correct to the best of my knowledge and belief.



7/23/80
Date Surveyed

Charles L. Hill
Registered Professional Engineer
and/or Land Surveyor **C. L. Hill**

Colorado 7582

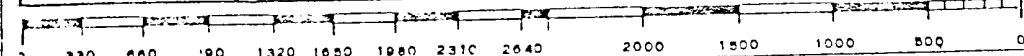
Certificate No.



-  Location
 Well
 Injector

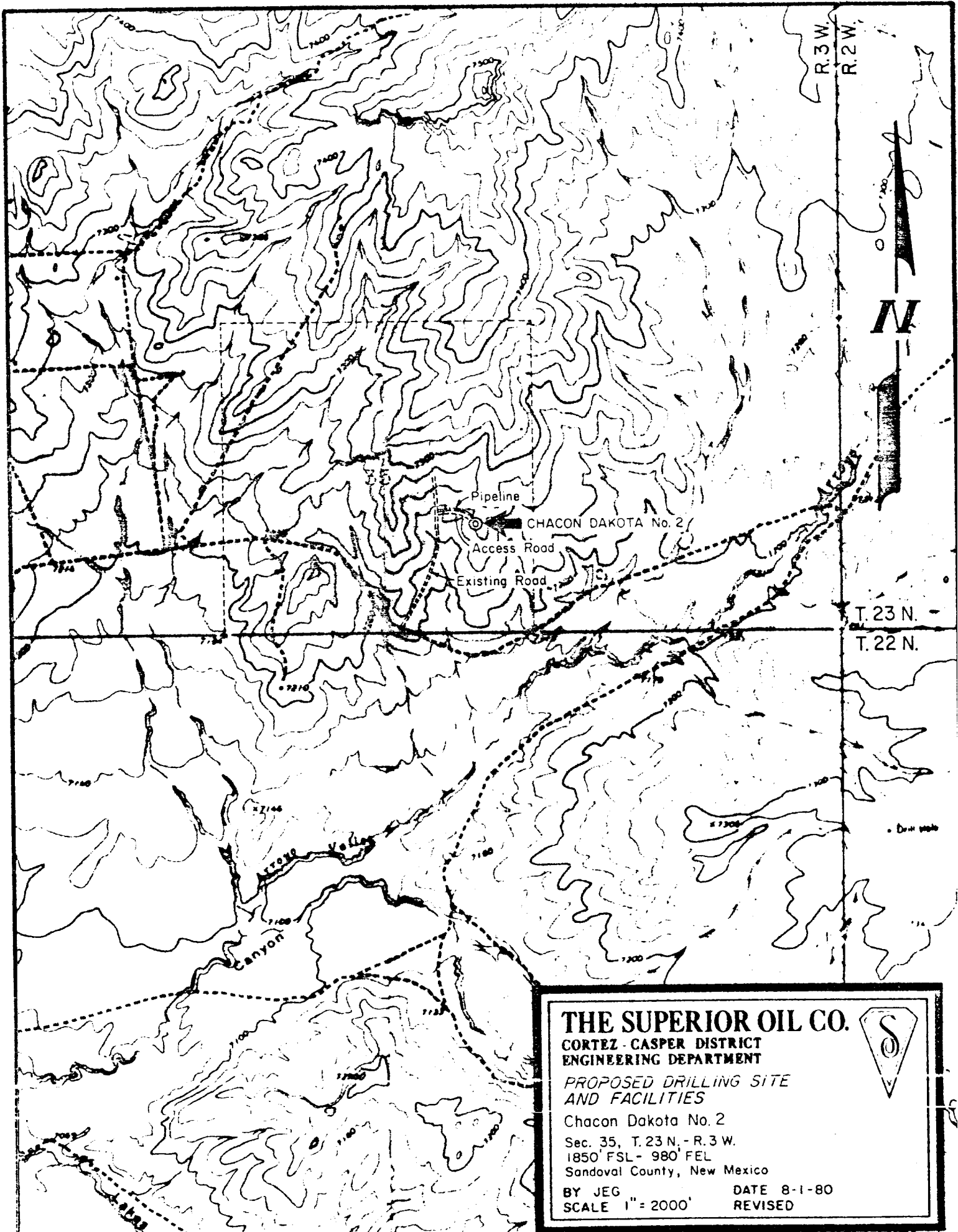

THE SUPERIOR OIL CO.

CORTEZ - CASPER DISTRICT
ENGINEERING DEPARTMENT

PROPOSED DRILLING SITE
AND FACILITIES

Chacon Dakota No. 2

Sec. 35, T. 23 N., - R. 3 W.

1850' FSL - 980' FEL

Sandoval County, New Mexico

BY JEG

DATE 8-1-80

SCALE 1" = 2000'

REVISED

