

UNITED STATES
DEPARTMENT OF THE INTERIOR
GEOLOGICAL SURVEY

APPLICATION FOR PERMIT TO DRILL, DEEPEN, OR PLUG BACK

1a. TYPE OF WORK

DRILL ☒

DEEPEN ☐

PLUG BACK ☐

b. TYPE OF WELL

OIL
WELL ☐

GAS
WELL ☒

OTHER

SINGLE
ZONE ☐

MULTIPLE
ZONE ☐

2. NAME OF OPERATOR

COLEMAN OIL & GAS, INC.

3. ADDRESS OF OPERATOR

Drawer 3337

Farmington, New Mexico 87401

4. LOCATION OF WELL (Report location clearly and in accordance with any State requirements.)

At surface

1600' FNL, 1840' ~~FNL~~ FNL SEP

At proposed prod. zone

Same

14. DISTANCE IN MILES AND DIRECTION FROM NEAREST TOWN OR POST OFFICE*

12 miles south Councilor's, New Mexico

15. DISTANCE FROM PROPOSED*

LOCATION TO NEAREST
PROPERTY OR LEASE LINE, FT.
(Also to nearest drlg. unit line, if any)

1600'

16. NO. OF ACRES IN LEASE

2040

17. NO. OF ACRES ASSIGNED
TO THIS WELL

160

18. DISTANCE FROM PROPOSED LOCATION*
TO NEAREST WELL, DRILLING, COMPLETED,
OR APPLIED FOR, ON THIS LEASE, FT.

7360'

19. PROPOSED DEPTH
1700' Chacra

20. ROTARY OR CABLE TOOLS
Rotary

21. ELEVATIONS (Show whether DF, RT, GR, etc.)

7026 GR.

22. APPROX. DATE WORK WILL START*

12-25-1980

23.

PROPOSED CASING AND CEMENTING PROGRAM

SIZE OF HOLE	SIZE OF CASING	WEIGHT PER FOOT	SETTING DEPTH	QUANTITY OF CEMENT
11	7	24#	100	100 Circ
6-3/4	4 1/2	9.5#	1700	200 Circ

SEE NTL-6 ATTACHMENTS

GAS NOT DEDICATED

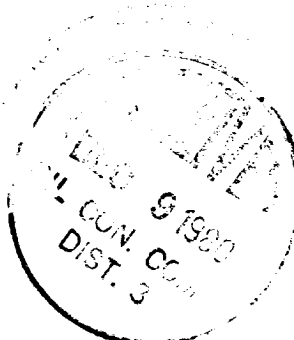

IN ABOVE SPACE DESCRIBE PROPOSED PROGRAM: If proposal is to deepen or plug back, give data on present productive zone and proposed new productive zone. If proposal is to drill or deepen directionally, give pertinent data on subsurface locations and measured and true vertical depths. Give blowout preventer program, if any.

24.

SIGNED

James C. Kennedy

TITLE

Agent

DATE

9-29-1980

(This space for Federal or State office use)

PERMIT NO.

APPROVAL DATE

APPROVED BY

TITLE

DATE

CONDITIONS OF APPROVAL, IF ANY:

*See Instructions On Reverse Side

OIL CONSERVATION DIVISION

P. O. BOX 2088

SANTA FE, NEW MEXICO 87501

Form C-107
Revised 10-1-78

STATE OF NEW MEXICO

ENERGY AND MINERALS DEPARTMENT

All distances must be from the outer boundaries of the Section.

Operator COLEMAN OIL & GAS, INCORPORATED			Lease LASSMAN		Well No. 5
Unit Letter F	Section 23	Township 21N	Range 6W	County Sandoval	
Actual Footage Location of Well: 1600 feet from the North line and 1840 feet from the West line					
Ground Level Elev. 7026	Producing Formation Chacra		Pool Wildcat		Dedicated Acreage: 160 Acres

1. Outline the acreage dedicated to the subject well by colored pencil or hachure marks on the plat below.
2. If more than one lease is dedicated to the well, outline each and identify the ownership thereof (both as to working interest and royalty).
3. If more than one lease of different ownership is dedicated to the well, have the interests of all owners been consolidated by communitization, unitization, force-pooling, etc?

☒ Yes ☐ No If answer is "yes," type of consolidation Communitization

If answer is "no," list the owners and tract descriptions which have actually been consolidated. (Use reverse side of this form if necessary.)

No allowable will be assigned to the well until all interests have been consolidated (by communitization, unitization, forced-pooling, or otherwise) or until a non-standard unit, eliminating such interests, has been approved by the Commission.

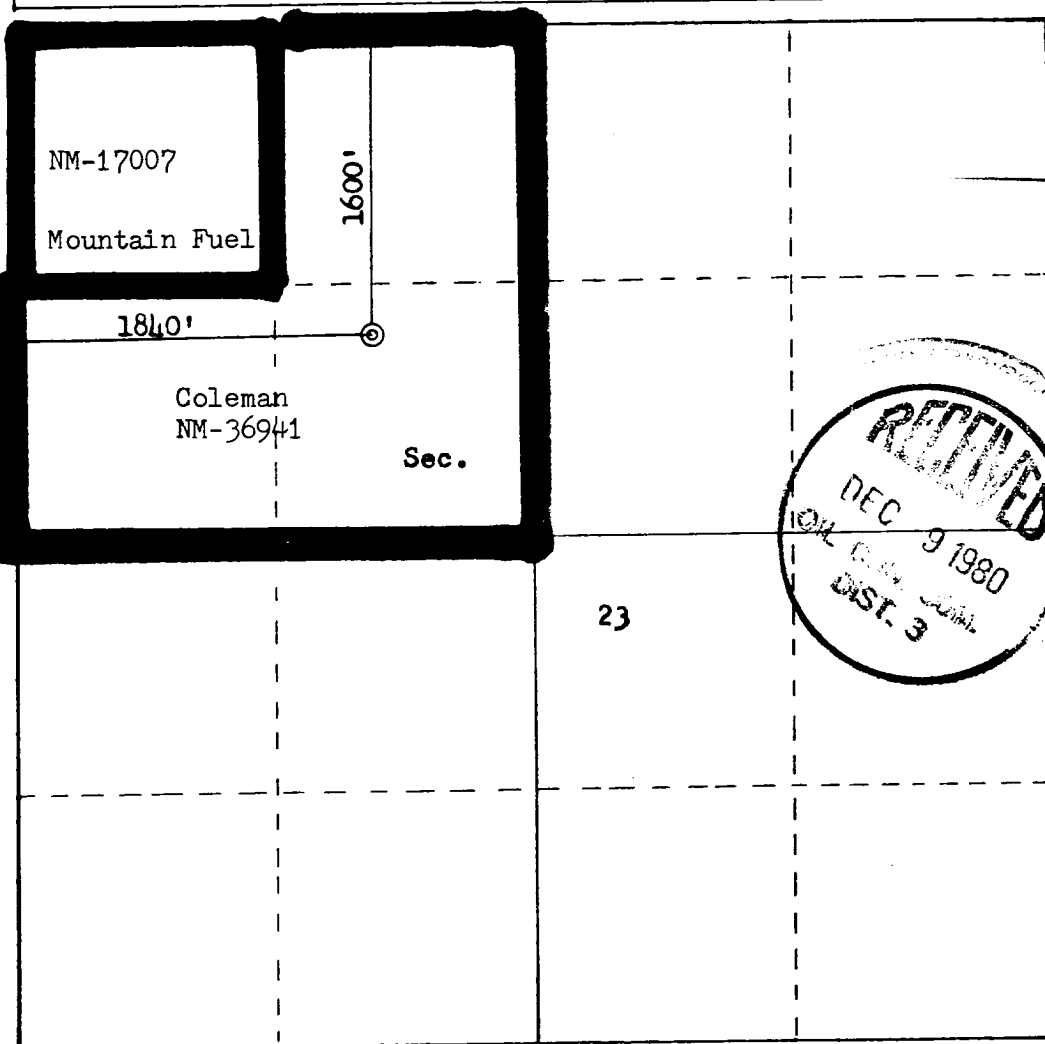

Scale: 1"=1000'

CERTIFICATION

I hereby certify that the information contained herein is true and complete to the best of my knowledge and belief.

Claude C. Kennedy
Name **Claude C. Kennedy**

Position **Agent**

Company
Coleman Oil & Gas, Inc.

Date **9-29-1980**

I hereby certify that the well location shown on this plat was plotted from field notes of actual surveys made by me or under my supervision, and that the same is true and correct to the best of my knowledge and belief.

Date Surveyed

September 21, 1980

Registered Professional Engineer
and Land Surveyor

Fred B. Kerr Jr.
Fred B. Kerr Jr.

Certificate No. **3950**

UNITED STATES
DEPARTMENT OF THE INTERIOR
GEOLOGICAL SURVEY

APPLICATION FOR PERMIT TO DRILL, DEEPEN, OR PLUG BACK

1a. TYPE OF WORK DRILL <input checked="" type="checkbox"/> DEEPEN <input type="checkbox"/> PLUG BACK <input type="checkbox"/>		5. LEASE DESIGNATION AND SERIAL NO. 36941
b. TYPE OF WELL OIL WELL <input type="checkbox"/> GAS WELL <input checked="" type="checkbox"/> OTHER <input type="checkbox"/> SINGLE ZONE <input type="checkbox"/> MULTIPLE ZONE <input type="checkbox"/>		6. IF INDIAN, ALLOTTEE OR TRIBE NAME
2. NAME OF OPERATOR Coleman Oil & Gas, Inc.		7. UNIT AGREEMENT NAME
3. ADDRESS OF OPERATOR Drawer 3337 Farmington, New Mexico 87401		8. FARM OR LEASE NAME Lassman
4. LOCATION OF WELL (Report location clearly and in accordance with any State requirements.)* At surface 1600' FNL, 1840' FNL At proposed prod. zone same		9. WELL NO. 5
14. DISTANCE IN MILES AND DIRECTION FROM NEAREST TOWN OR POST OFFICE* 12 miles south Councilor's, New Mexico		10. FIELD AND POOL, OR WILDCAT Wildcat
15. DISTANCE FROM PROPOSED* LOCATION TO NEAREST PROPERTY OR LEASE LINE, FT. (Also to nearest drlg. unit line, if any) 1600'	16. NO. OF ACRES IN LEASE 2040	11. SEC., T., R., M., OR BLK. AND SURVEY OR AREA Sec. 23, T21N, R6W
18. DISTANCE FROM PROPOSED LOCATION* TO NEAREST WELL, DRILLING, COMPLETED, OR APPLIED FOR, ON THIS LEASE, FT. 700'	19. PROPOSED DEPTH 1700' hacre	12. COUNTY OR PARISH Sandoval
21. ELEVATIONS (Show whether DF, RT, GR, etc.) 7026 or.		13. STATE N. M.
22. APPROX. DATE WORK WILL START* 12-25-1980		

23. PROPOSED CASING AND CEMENTING PROGRAM

SIZE OF HOLE	SIZE OF CASING	WEIGHT PER FOOT	SETTING DEPTH	QUANTITY OF CEMENT
11	7	24	100	100 ciro
6 3/4	4 1/2	9.5	1700	200 ciro

See NML-6 Attachments

CORRECTED LOGS:

the above footage location was incorrectly reported as 1600 FNL and 1840 FNL.

CORRECT LOG IS: 1600 FNL, 1840 FNL.

Survey plat as filed was correct.

Was Not Dedicated

IN ABOVE SPACE DESCRIBE PROPOSED PROGRAM: If proposal is to deepen or plug back, give data on present productive zone and proposed new productive zone. If proposal is to drill or deepen directionally, give pertinent data on subsurface locations and measured and true vertical depths. Give blowout preventer program, if any.

24. **James E. Kennedy** TITLE **Agent** DATE **10-10-1980**

SIGNED **James E. Kennedy**
APPROVED
(This space for Federal or State office use)
AS AMENDED

PERMIT NO. **DEC 09 1980** APPROVAL DATE

APPROVED BY **James E. Sims** TITLE **DISTRICT ENGINEER** DATE

*See Instructions On Reverse Side

11/10/80

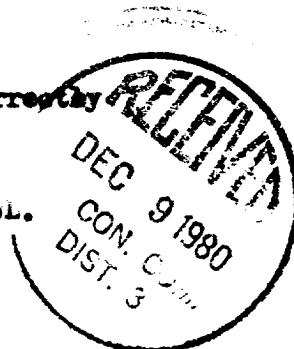

Instructions

General: This form is designed for submitting proposals to perform certain well operations, as indicated, on all types of lands and leases for appropriate action by either a Federal or a State agency, or both, pursuant to applicable Federal and/or State laws and regulations. Any necessary special instructions concerning the use of this form and the number of copies to be submitted, particularly with regard to local, area, or regional procedures and practices, either are shown below or will be issued by, or may be obtained from, the local Federal and/or State office.

Item 1: If the proposal is to redrill to the same reservoir at a different subsurface location or to a new reservoir, use this form with appropriate notations. Consult applicable State or Federal regulations concerning subsequent work proposals or reports on the well.

Item 4: If there are no applicable State requirements, locations on Federal or Indian land should be described in accordance with Federal requirements. Consult local State or Federal office for specific instructions.

Item 14: Needed only when location of well cannot readily be found by road from the land or lease description. A plat, or plats, separate or on this reverse side, showing the roads to, and the surveyed location of, the well, and any other required information, should be furnished when required by Federal or State agency offices.

Items 15 and 18: If well is to be, or has been directionally drilled, give distances for subsurface location of hole in any present or objective production zone.

Item 22: Consult applicable Federal or State regulations, or appropriate officials, concerning approval of the proposal before operations are started.

FORMATION INFORMATION & DRILLING PRACTICE

1. Geologic name of surface formation.

Tertiary

2. Estimated tops of important geologic markers.

Ojo	350 to 650
PC	930
Chacra	1250

3. Estimated depths at which anticipated water, oil, gas or other mineral-bearing formations are expected.

Gas	1300-50
-----	---------

4. Proposed casing program.

Surface:

7", 24#, Used casing to be set @ 100' Cement will be 50 sx Class B, 2% CaCl or adequate to circulate.

Production:

4½ csg, K-55, new casing to be set at 1700' cement will be 100 sx 50/50 Poz, plus 100 sx Class B, 2% CaCl or adequate to circulate.

5. Specifications for pressure control equipment.

The attached schematic shows the type of blow out preventer to be used while drilling. The unit will be tested to 200 psi as soon as possible after its installation on the surface pipe. Testing will be done with the rig pump. This is a manual type preventer, and its operation will be manually checked when practical.

6. Drilling fluids.

Depth	Type	Viscosity	Weight	Fluid Loss (cc)
0-100	Gel-lime	35-45	8.6-9.0	N/C
100-1700	Low-solids	29-33	8.4-8.8	15

7. Auxiliary equipment.

- bit float
- full opening stabbing valve to be used when kelly is not in the string

8. Logging - Coring - Testing.

Logging: Induction Electric Log, Formation Compensated Density, Gamma Ray Caliper

Coring: None

Drill Stem Testing: None

9. Abnormal temperatures, pressure, or hazardous conditions.

None expected

10. Starting Date.

Anticipated starting date is 12-25-1980 Approximately six days will be needed to build roads and location and drill the well to total depth. If commercial, completion will commence immediately and require ten days.



SHAFFER HYDRAULIC BLOWOUT PREVENTERS

(Patented)

TYPE LWS PREVENTERS—8", 3000 lb. & 5000 lb.—10", 5000 lb.
12", 3000 lb.—13 $\frac{1}{8}$ ", 5000 lb.—16", 3000 lb.

PARTS AND DIMENSIONAL ILLUSTRATIONS

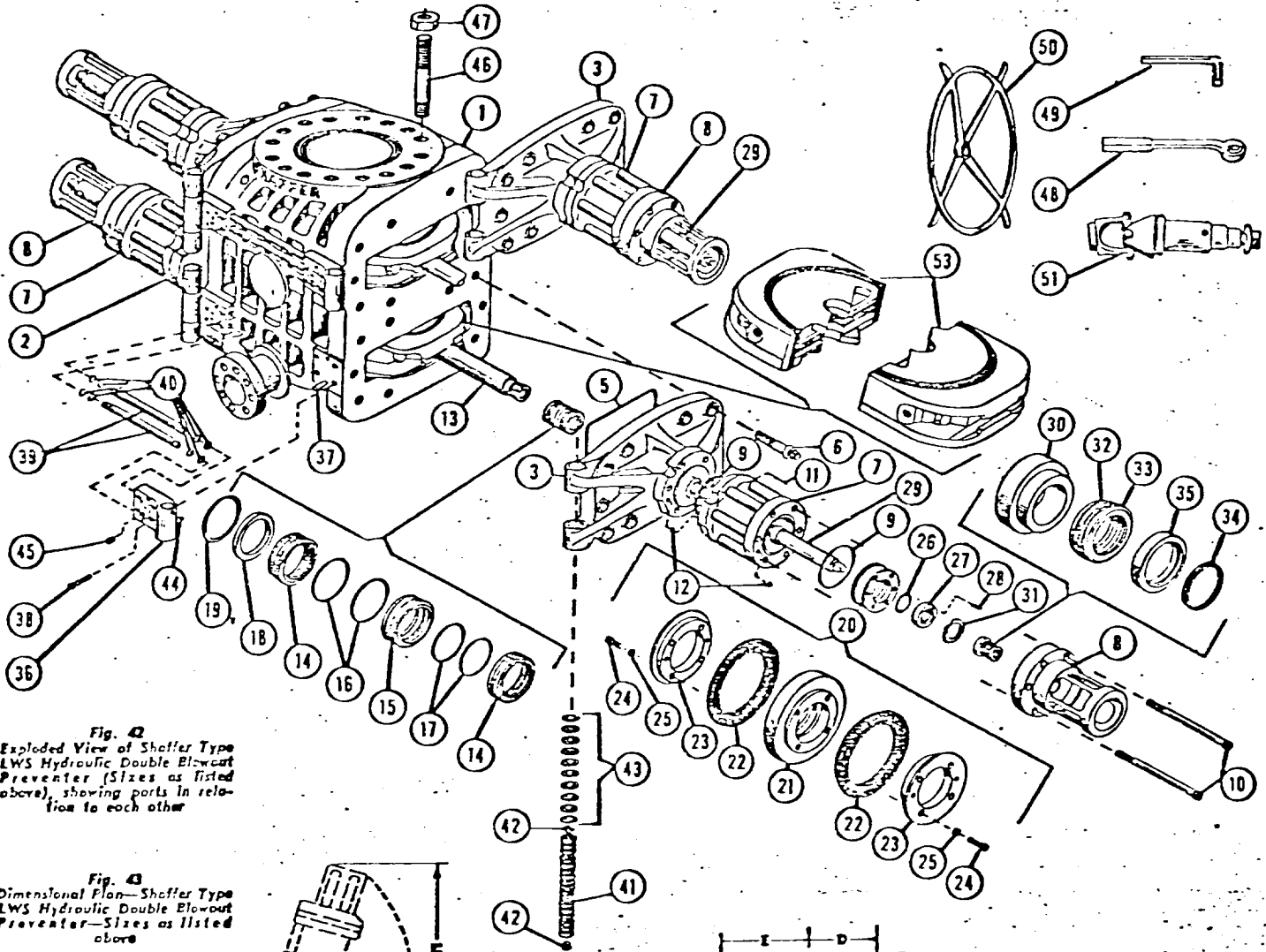

Fig. 42
Exploded View of Shaffer Type
LWS Hydraulic Double Blowout
Preventer (Sizes as listed
above), showing ports in rela-
tion to each other

Fig. 43
Dimensional Plan—Shaffer Type
LWS Hydraulic Double Blowout
Preventer—Sizes as listed
above

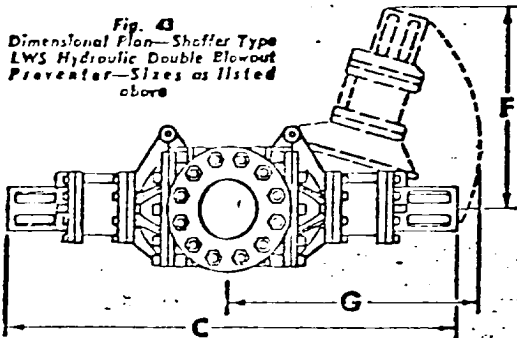
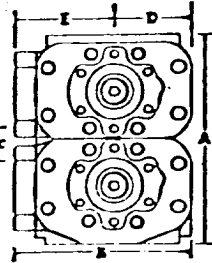

Fig. 44
Dimensional End Elevation—
Shaffer Type LWS Hydraulic
Double Blowout Preventer—
Sizes as listed above



STANDARD ACCESSORIES

- (50) 4 Hand Wheels
- (48) 1 Door Wrench
- (49) 1 Cylinder & Cylinder Head Wrench
- (51) 4 Universal Joints

DIMENSIONAL AND ENGINEERING DATA ON ABOVE SIZES OF TYPE LWS PREVENTERS
Refer to Figs. 43 and 44

Size	Max. Service Pressure, Working psi	Test Pressure, psi	Vertical Rise	Max. Yarn Size	Approx. Weight Lbs.		A				B	C	D	E	F	G	Closing Ratio	Opening Ratio	U.S. Gals. Fluid To Close Rams	U.S. Gals. Fluid To Open Rams
							Height													
					Studded Flange		Single		Double		Width									
					Single	Double	Studded Flange	Bellied Flange	Studded Flange	Bellied Flange										
8"	3,000	6,000	8"	7"	2,500	20½"	41½"	25½"	75½"	11½"	14½"	22"	48"	5.5 to 1	1.85 to 1	2.75	2.5
10"	3,000	6,000	10"	7"	3,500	25½"	45½"	25½"	75½"	11½"	14½"	22"	48"	5.5 to 1	1.85 to 1	2.75	2.5
12"	3,000	6,000	11"	8½"	5,000	7,000	24½"	24½"	23"	50½"	25½"	85½"	12½"	18"	22"	48"	5.5 to 1	1.5 to 1	2.55	2.7
13½"	3,000	6,000	12½"	10½"	6,300	24½"	47½"	25½"	92½"	13½"	18½"	22"	48"	5.5 to 1	1.85 to 1	2.55	2.9
16"	3,000	6,000	12½"	10½"	6,500	9,500	26½"	26½"	26"	49½"	25½"	92½"	14½"	18½"	22"	48"	5.5 to 1	1.5 to 1	2.55	2.9
16"	3,000	6,000	13½"	12½"	8,500	28"	51"	25½"	105½"	16½"	20½"	22"	48"	5.5 to 1	1.5 to 1	2.5	2.9

13 POINT SURFACE USE PLAN

1. EXISTING ROADS: (Shown in Green)

The attached topographic map shows all existing roads within (3) miles of the proposed location. All roads are in fair condition and will require a minimal amount of work to upgrade them to handle normal drilling activity traffic.

2. PLANNED ACCESS ROAD (Shown in Red)

Width: 20' flat bladed.

Maximum Grades: 2% or less, road is flat.

New road required: 300'
No cut, fill, turnouts, culverts or gates will be required.
Water bars will be consistant with existing drainage pattern.

3. LOCATION OF EXISTING WELLS:

Map attached.

4. LOCATION OF EXISTING OR PROPOSED PRODUCTION FACILITIES:

A. All production facilities are to be contained within the proposed location.

B. Production facilities are present on wells as per 3. above.

5. LOCATION AND TYPE OF WATER SUPPLY:

Private Source: Escrito

6. SOURCE OF CONSTRUCTION MATERIAL:

Any construction material required for road or location will be excess materials accumulated during building of such sites.

7. METHOD FOR HANDLING WASTE DISPOSAL:

1. The cuttings will be retained in the reserve pit.

2. Drilling fluids will be contained in a reserve pit or mud tanks until well is completed.

3. Oil will be collected in tanks. Little or no water is anticipated at this location. If volume of oil is sufficient, it will be trucked from location.

4. A portable toilet will be provided.

5. A fenced pit will be provided for trash. The trash pit will be enclosed with small mesh wire. The reserve pit will be fenced.

6. Location and mud pits will be leveled and seeded as soon as feasible after well is completed. The area will be cleaned of all trash and materials.

13 POINT SURFACE USE PLAN - continued

Page - 2

8. ANCILLARY FACILITIES:

No camps or airstrips will be constructed.

9. WELL SITE LAYOUT:

The attached layout shows the drilling rig with all supporting facilities. Cut and fill, required for pad construction, is also shown.

10. SURFACE RESTORATION PLANS:

Restoration of the well site and access road will begin within 90 days of well completion, weather permitting.

Should the well be abandoned, the drilling site will be reshaped to its approximate former contour. The access road will be plowed and leveled. Both road and location will have top soil replaced and will be reseeded when germination can occur.

Should the well be commercial, that portion of location not needed for operation will be repaired as above. The portion of the location needed for daily production operations, and the access road, will be kept in good repair and clean.

In either case, cleanup of the site will include burning any safely burnable material, filling of all pits, and proper disposal of any nonburnable material that can not be safely buried. Any oil that has accumulated on the pits will be trucked away.

11. OTHER INFORMATION:

A. General topography of the area may be seen on the attached map.

B. There were no archaeological or cultural sites visible on the location. The archaeologist's report is forthcoming.

C. Animal life: Small, wild Sheep

D. Dwellings: none, abandon Church, approx 600'

E. Drainage: South, southwest

F. Surface Owner: BLM

G. General location: Mule Dam Quad

12. OPERATOR REPRESENTATIVES:

CLAUDE C. KENNEDY
INDEPENDENT OIL AND GAS OPERATOR

6109 DEL CAMPO PLACE, N.E.
ALBUQUERQUE, N. M. 87109

PHONE (505) 883-9624

13 POINT SURFACE USE PLAN - continued

Page - 3

13. CERTIFICATION:

I hereby certify that I or persons under my direct supervision, have inspected the proposed drill site and access route; that I am familiar with the conditions which presently exist; that the statements made in the plan are to the best of my knowledge; true and correct; and, that the work associated with the operations proposed herein will be performed by operator, and his contractors and sub-contractors in conformity with this plan and the terms and conditions under which it is approved.

Claude C. Kennedy

Date: 9-29-1980

COLEMAN OIL & GAS, INC.
LASSMAN FEDERAL LEASE
NM 36941

R-7-W
RUSTY CLACCA
FIELD AREA

R-6-W

31

32

SANDWAL CO., NM

33

34

35

36

37

38

39

40

41

30

29

28

27

26

25

24

23

22

21

20

19

19

20

21

22

23

24

25

26

27

28

29

30

18

17

16

15

14

13

12

11

10

9

8

7

7

8

9

10

11

12

13

14

15

16

17

18

6

5

4

3

2

1

0

-1

-2

-3

-4

-5

5

4

3

2

1

0

-1

-2

-3

-4

-5

30

29

28

27

26

25

24

23

22

21

20

19

19

18

17

16

15

14

13

12

11

10

9

8

18

17

16

15

14

13

12

11

10

9

8

7



LOCATION LAYOUT

COLEMAN OIL & GAS, INC. #5 LASSMAN

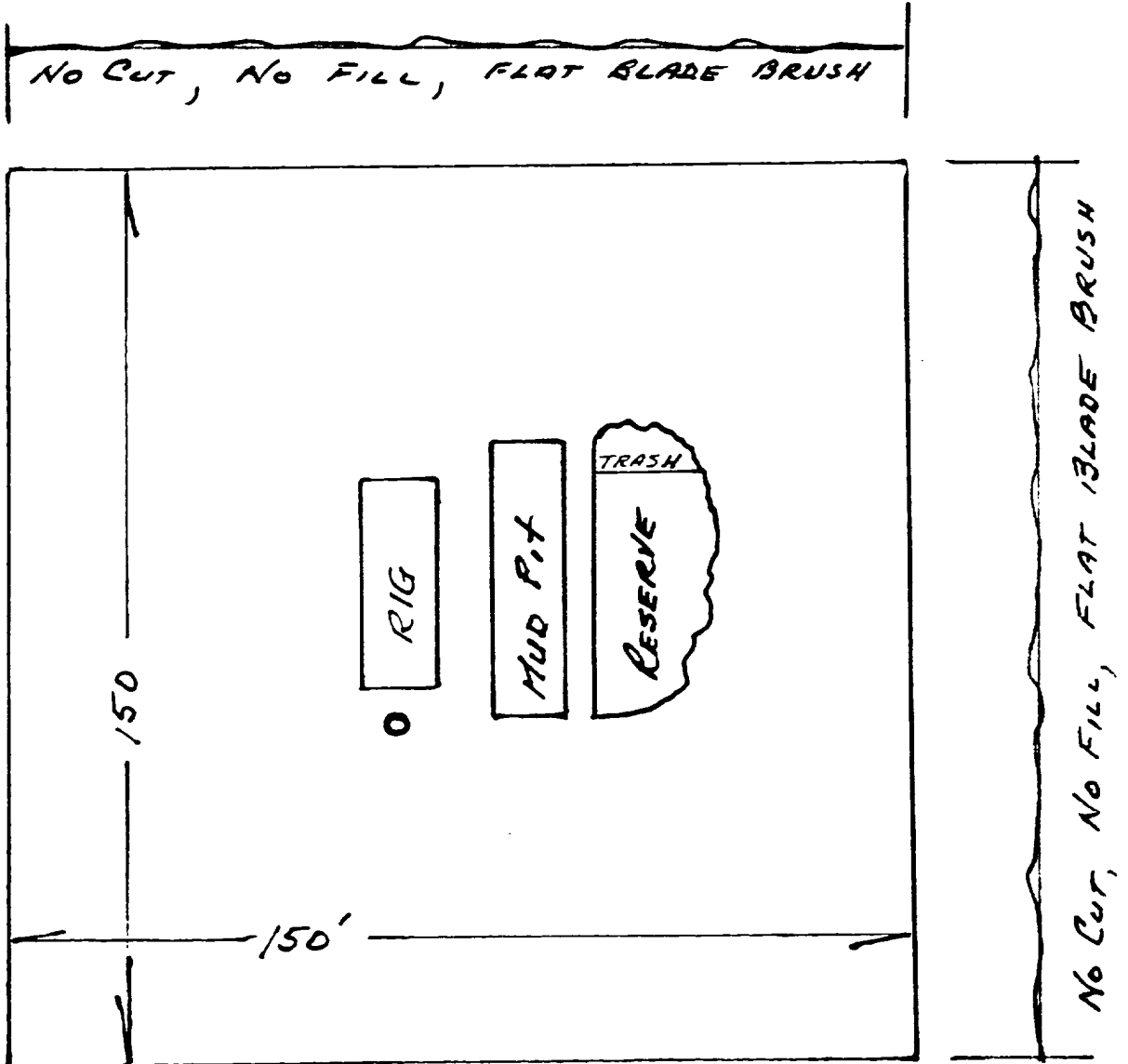

SCALE: 1 INCH = 30 FEET