

UNITED STATES
DEPARTMENT OF THE INTERIOR
GEOLOGICAL SURVEY30-043-305-39
5. LEASE DESIGNATION AND SERIAL NO.

Contract 45

6. IF INDIAN, ALLOTTEE OR TRIBE NAME

Jicarilla

7. UNIT AGREEMENT NAME

8. FARM OR LEASE NAME

Ponca

9. WELL NO.

3

10. FIELD AND POOL, OR WILDCAT

Ballard Pic. Cliffs

11. SEC., T., R., M., OR BLE.
AND SURVEY OR AREA

Sec. 19, T23N, R4W

12. COUNTY OR PARISH

Sandoval

13. STATE

N.M.

APPLICATION FOR PERMIT TO DRILL, DEEPEN, OR PLUG BACK

1a. TYPE OF WORK

DRILL ☒DEEPEN ☐PLUG BACK ☐

b. TYPE OF WELL

OIL
WELL ☐GAS
WELL ☒

OTHER

SINGLE
ZONE ☒MULTIPLE
ZONE ☐

2. NAME OF OPERATOR

J. Gregory Merrion & Robert L. Bayless

3. ADDRESS OF OPERATOR

P.O. Box 1541, Farmington, NM 87401

4. LOCATION OF WELL (Report location clearly and in accordance with any State requirements*)

At surface

1850' FSL & 790' FEL

At proposed prod. zone

same

14. DISTANCE IN MILES AND DIRECTION FROM NEAREST TOWN OR POST OFFICE*

15. DISTANCE FROM PROPOSED*

LOCATION TO NEAREST
PROPERTY OR LEASE LINE, FT.
(Also to nearest drlg. unit line, if any)

16. NO. OF ACRES IN LEASE

2401.58

18. DISTANCE FROM PROPOSED LOCATION*
TO NEAREST WELL, DRILLING, COMPLETED,
OR APPLIED FOR, ON THIS LEASE, FT.

19. PROPOSED DEPTH

2500 ft.

17. NO. OF ACRES ASSIGNED
TO THIS WELL

160

20. ROTARY OR CABLE TOOLS

Rotary

21. ELEVATIONS (Show whether DF, RT, GR, etc.)

6973' GL

22. APPROX. DATE WORK WILL START*

As soon as possible.

23.

PROPOSED CASING AND CEMENTING PROGRAM

SIZE OF HOLE	SIZE OF CASING	WEIGHT PER FOOT	SETTING DEPTH	QUANTITY OF CEMENT
9"	7"	23#	90'	30 sacks circulated to surface
5-1/8"	2-7/8"	6.5#	2525'	125 sacks

AUTHORIZED ARE

WITH ATTACHED

Will drill 9" hole to 90' and set 90' of 7", 23#, J-55 used casing with 30 sacks Class H Cement, circulated to surface. Will drill 5-1/8" hole to 2525' and run 2525' of 2-7/8", EUE, J-55, used casing and cement with 125 sacks Class H cement with 2% D-79 circulated to above Ojo Alamo. Circulating medium will be clear water, natural mud and water-loss control additives. No abnormal pressures or temperatures are anticipated. Will run Induction and Density logs. Blowout preventer schematic is attached. The gas from this formation is dedicated to a gas contract.

ESTIMATED TOPS

Surface Formation: Clays & sand

1750': Ojo Alamo

2175': Fruitland

2375': Pictured Cliffs - oil con. salt water

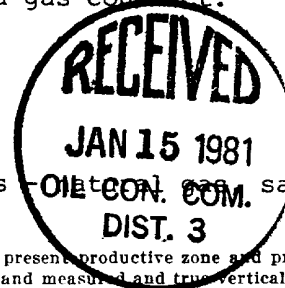

IN ABOVE SPACE DESCRIBE PROPOSED PROGRAM: If proposal is to deepen or plug back, give data on present productive zone and proposed new productive zone. If proposal is to drill or deepen directionally, give pertinent data on subsurface locations and measured and true vertical depths. Give blowout preventer program, if any.

24.

SIGNED

TITLE

Operator

DATE

Dec. 15, 1980

(This space for Federal or State office use)

PERMIT NO.

APPROVAL DATE

APPROVED BY

TITLE

DATE

CONDITIONS OF APPROVAL, IF ANY:

oh 3m

NMOCC

All distances must be from the outer boundaries of the Section.

Operator MERRION & BAYLESS			Lease PONCA		Well No. 3
Unit Letter I	Section 19	Township 23N	Range 4W	County Sandoval	
Actual Footage Location of Well: 1850 feet from the South line and 790 feet from the East line					
Ground Level Elev: 6973	Producing Formation Pictured Cliffs		Pool Ballard		Dedicated Acreage: 160 Acres

1. Outline the acreage dedicated to the subject well by colored pencil or hachure marks on the plat below.
2. If more than one lease is dedicated to the well, outline each and identify the ownership thereof (both as to working interest and royalty).
3. If more than one lease of different ownership is dedicated to the well, have the interests of all owners been consolidated by communitization, unitization, force-pooling, etc?

☐ Yes ☐ No If answer is "yes," type of consolidation _____

If answer is "no," list the owners and tract descriptions which have actually been consolidated. (Use reverse side of this form if necessary.) _____

No allowable will be assigned to the well until all interests have been consolidated (by communitization, unitization, forced-pooling, or otherwise) or until a non-standard unit, eliminating such interests, has been approved by the Commission.

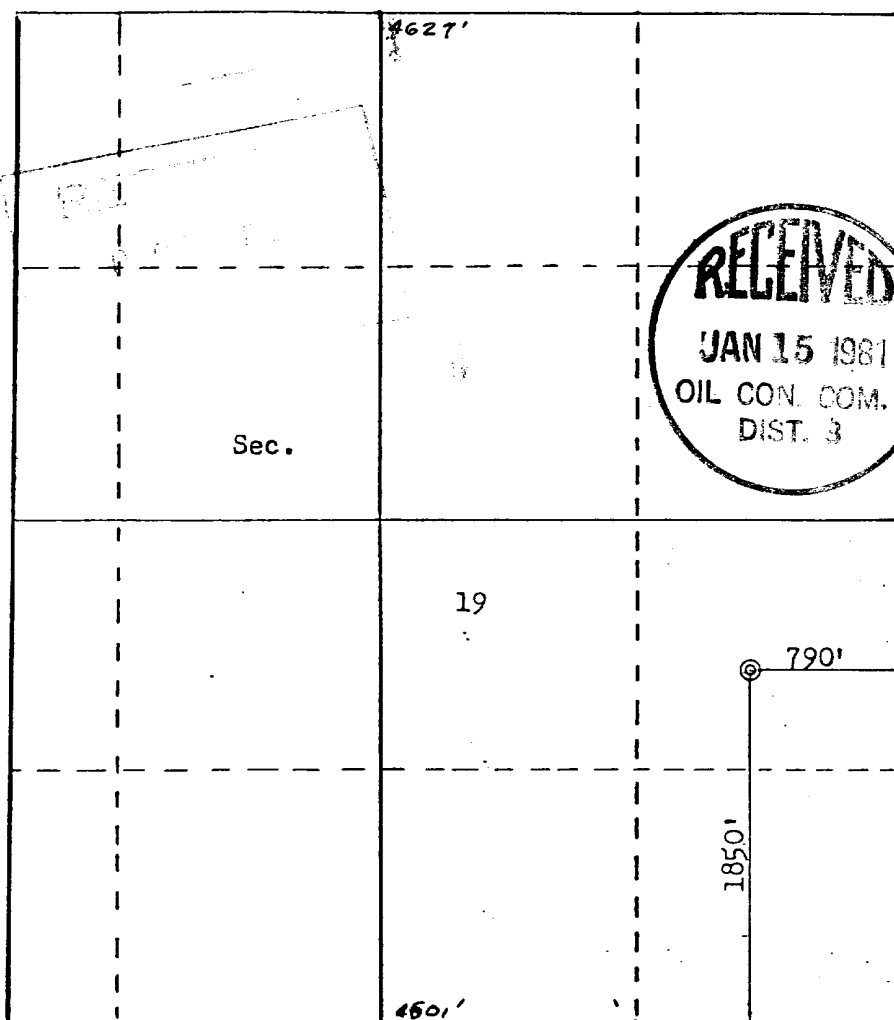

Scale: 1"=1000'

CERTIFICATION

I hereby certify that the information contained herein is true and complete to the best of my knowledge and belief.

Robert L. Bayless
Name

Robert L. Bayless

Position

Co-Venturer

Company

Merrion & Bayless

Date

December 15, 1980

I hereby certify that the well location shown on this plat was plotted from field notes of actual surveys made by me or under my supervision, and that the same is true and correct to the best of my knowledge and belief.

Date Surveyed

December 12, 1980

Registered Professional Engineer
and Land Surveyor

Fred B. Kerr Jr.
Fred B. Kerr Jr.

Certificate No.

3950

FRED B. KERR, JR.

