

~~to~~ 7-2-77

Update -

for Abby - they still  
have this well in  
their <sup>oper.</sup> name.

UNITED STATES  
DEPARTMENT OF THE INTERIOR  
GEOLOGICAL SURVEY

30-043-20671

5. LEASE DESIGNATION AND SERIAL NO.

NM-18455

6. IF INDIAN, ALLOTTEE OR TRIBE NAME

BLM Land / Fee Surface

7. UNIT AGREEMENT NAME

8. FARM OR LEASE NAME

Federal Lease

9. WELL NO.

Atencio #1

10. FIELD AND POOL, OR WILDCAT

Wildcat

11. SEC., T., R., M., OR BLK.  
AND SURVEY OR AREA

Sec. 32, Twp. 23N, Rge. 1W

12. COUNTY OR PARISH

Sandoval New Mexico

1a. TYPE OF WORK

DRILL ☒DEEPEN ☐PLUG BACK ☐

b. TYPE OF WELL

OIL  
WELL ☒GAS  
WELL ☒

OTHER

SINGLE  
ZONE ☐MULTIPLE  
ZONE ☒

2. NAME OF OPERATOR

Mesa Grande Resources, Inc.

3. ADDRESS OF OPERATOR

1200 Philtower Building, Tulsa, Oklahoma 74103

4. LOCATION OF WELL (Report location clearly and in accordance with any State requirements.)

At surface 1653.23 ft. from North line and 975.56 ft. from the West  
line of Sec. 32, Township 23 North, Range 1 West, NMPM.  
At proposed prod. zone

14. DISTANCE IN MILES AND DIRECTION FROM NEAREST TOWN OR POST OFFICE\*

Regina, New Mexico 3/4 of 1 mile East of location

15. DISTANCE FROM PROPOSED\* 975.56 ft. from Fed.

16. NO. OF ACRES IN LEASE

582.88 Acres

17. NO. OF ACRES ASSIGNED

TO THIS WELL  
16018. DISTANCE FROM PROPOSED LOCATION TO NEAREST WELL, DRILLING, COMPLETED,  
OR APPLIED FOR, ON THIS LEASE, FT.

19. PROPOSED DEPTH

8,000 ft.

20. ROTARY OR CABLE TOOLS

Rotary

21. ELEVATIONS (Show whether DF, RT, GR, etc.)

7438.00 feet Ground Level

22. APPROX. DATE WORK WILL START\*

November 1, 1982

## 23. PROPOSED CASING AND CEMENTING PROGRAM

SIZE OF HOLE	SIZE OF CASING	WEIGHT PER FOOT	SETTING DEPTH	QUANTITY OF CEMENT
12-1/4"	8-5/8"	26 lb. per ft.	300 feet	240 sacks
8 3/4"	4 1/2" 5 1/2" depends on depth	16.5 for 4 1/2" 5 1/2"	8,000'	470 sacks plus 750

- A) Proposed test well to be drilled through Dakota Sandstone to top of Morrison Formation and will test multiple zones to the Morrison  
Pictured Cliffs Sandstone - approximately 3,000'  
Mesa Verde Sandstone - approximately 4,725'  
Pt. Lookout Sandstone - approximately 5,200'  
Gallup Sandstone - approximately 6,400'  
Graneros Sandstone - approximately 7,400'  
Dakota Sandstone - approximately 7,750'  
Top Morrison - approximately 7,950'
- B) 6,000 pound test (rental) hydraulic operated
- C) Before the well is plugged and abandoned, it will be offered to the surface owner for potential water rights and will be completed at the surface owner's expense.
- D) Water zones and potential producing zones listed above will be bridged and cemented upon plugging the well.
- E) Drilling mud is low solid gel: 44-45 viscosity; 9 - 9.5 lbs. (see back page)

IN ABOVE SPACE DESCRIBE PROPOSED PROGRAM: If proposal is to deepen or plug back, give data on present productive zone and proposed new productive zone. If proposal is to drill or deepen directionally, give pertinent data on subsurface locations and measured and true vertical depths. Give blowout preventer program, if any.

24. SIGNED E. Alex Phillips TITLE President DATE 10-11-82

(This space for Federal or State office use)

PERMIT NO.

APPROVAL DATE

APPROVED BY

TITLE

CONDITIONS OF APPROVAL, IF ANY:

APPROVED  
AS AMENDED  
March 9  
1983  
JAMES F. SIMS  
DISTRICT ENGINEER

NMOCG

All distances must be from the outer boundary of the Section.

Operator <b>Mesa Grande Resources, Inc.</b>			Lease <b>NM-18455</b>		Well No. <b>ATENCIO # 1</b>
Unit Letter <b>n/a</b>	Section <b>32</b>	Township <b>23 North</b>	Range <b>1 West</b>	County <b>Sandoval</b>	
Actual Footage Location of Well: <b>975.56</b> feet from the <b>WEST</b> line and <b>1653.23</b> feet from the <b>NORTH</b> line					
Ground Level Elev. <b>7438.00 feet.</b>	Producing Formation <i>San Juan - Pt. Indiant</i>		Pool <b>Regina WC</b>	Dedicated Acreage: <b>160</b> Acres	

- Outline the acreage dedicated to the subject well by colored pencil or hachure marks on the plat below.
- If more than one lease is dedicated to the well, outline each and identify the ownership thereof (both as to working interest and royalty).
- If more than one lease of different ownership is dedicated to the well, have the interests of all owners been consolidated by communitization, unitization, force-pooling, etc?

☐ Yes ☐ No If answer is "yes," type of consolidation \_\_\_\_\_

If answer is "no," list the owners and tract descriptions which have actually been consolidated. (Use reverse side of this form if necessary.) \_\_\_\_\_

No allowable will be assigned to the well until all interests have been consolidated (by communitization, unitization, forced-pooling, or otherwise) or until a non-standard unit, eliminating such interests, has been approved by the Division.

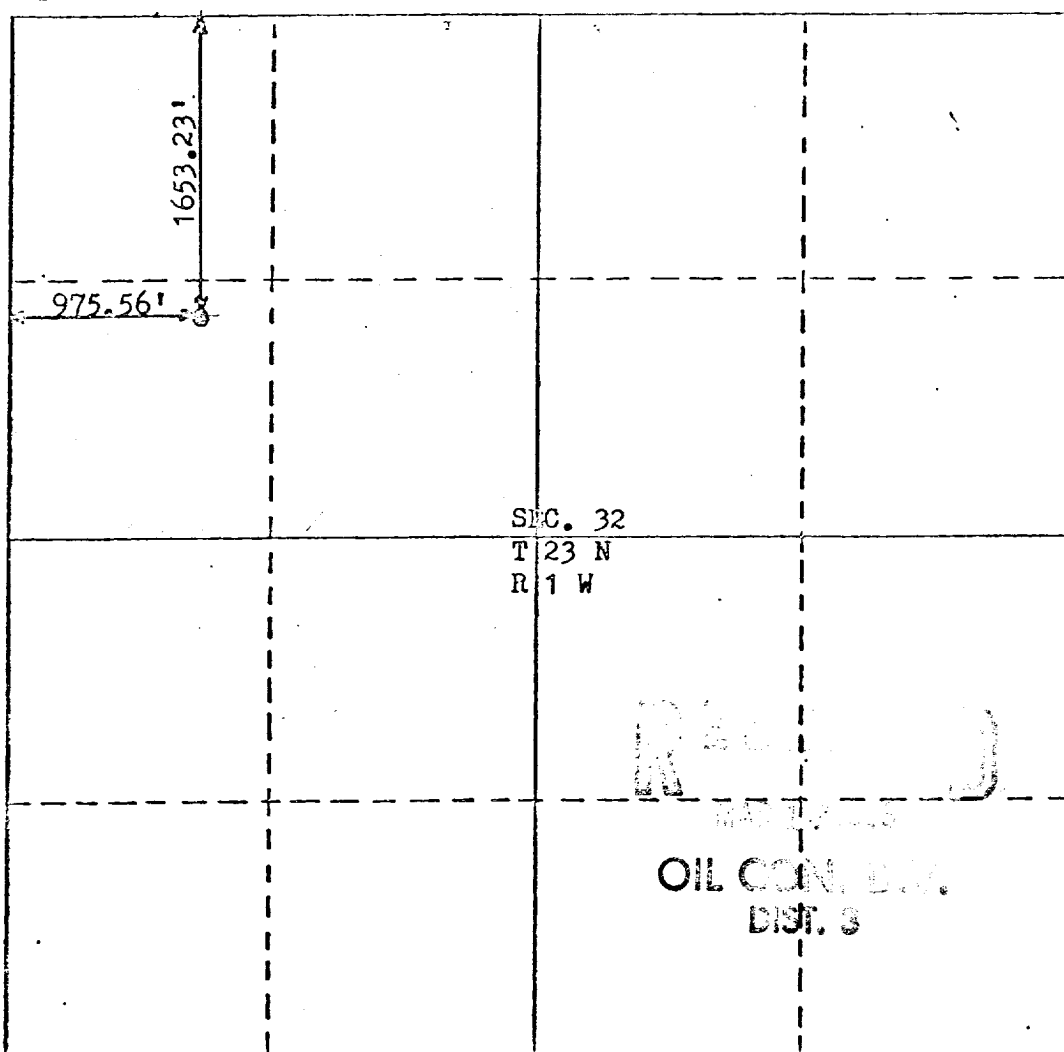

## CERTIFICATION

I hereby certify that the information contained herein is true and complete to the best of my knowledge and belief.

*E. Alex Phillips*

Name

**E. Alex Phillips**

Position

**President**

Company

**Mesa Grande Resources, Inc.**

Date

**March 14, 1983**

I hereby certify that the well location shown on this plat was verified from field notes of a professional survey made by me under my supervision and that the same is true and correct to the best of my knowledge and belief.

**12-3-81**

Date Surveyed

*Wayne E. Johnston*  
Registered Professional Engineer  
and/or Land Surveyor

**WAYNE E. JOHNSTON**  
**6540**

Certificate No.

0 330 660 990 1320 1650 1980 2310 2640 2970 3300 3630 3960 4290 4620 4950 5280 5610 5940 6270 6600