

UNITED STATES
DEPARTMENT OF THE INTERIOR
GEOLOGICAL SURVEY

APPLICATION FOR PERMIT TO DRILL, DEEPEN, OR PLUG BACK

1a. TYPE OF WORK

DRILL ☒DEEPEN ☐PLUG BACK ☐

b. TYPE OF WELL

OIL
WELL ☒GAS
WELL ☐OTHER ☐SINGLE
ZONE ☐MULTIPLE
ZONE ☐

2. NAME OF OPERATOR

Samuel Gary Oil Producers

3. ADDRESS OF OPERATOR

#4 Inverness Court East, Englewood, CO 80112-5599

4. LOCATION OF WELL (Report location clearly and in accordance with any State requirements.)

1900' FNL & 750' FEL Section 28, T20N., R3W.
At proposed prod. zone

14. DISTANCE IN MILES AND DIRECTION FROM NEAREST TOWN OR POST OFFICE*

12 miles S/W of Cuba, New Mexico

15. DISTANCE FROM PROPOSED*

LOCATION TO NEAREST
PROPERTY OR LEASE LINE, FT.
(Also to nearest drlg. unit line, if any)

750'

18. DISTANCE FROM PROPOSED LOCATION*

TO NEAREST WELL, DRILLING, COMPLETED,
OR APPLIED FOR, ON THIS LEASE, FT.

1-1/2 miles

16. NO. OF ACRES IN LEASE

2,531.76

19. PROPOSED DEPTH

4200'±

17. NO. OF ACRES ASSIGNED
TO THIS WELL

40

20. ROTARY OR CABLE TOOLS

Rotary

21. ELEVATIONS (Show whether DF, RT, GR, etc.)

6740' GR (Approx.)

DRILLING OPERATIONS AUTHORIZED ARE
SUBJECT TO COMPLIANCE WITH ATTACHED
"GENERAL REQUIREMENTS"

22. APPROX. DATE WORK WILL START*

9-29-83

23.

PROPOSED CASING AND CEMENTING PROGRAM

This action is subject to administrative
appeal pursuant to 30 CFR 290.

SIZE OF HOLE	SIZE OF CASING	WEIGHT PER FOOT	SETTING DEPTH
13-1/2	9 5/8		200'
8-3/4	7"	23 lb.	4200'±
	4-1/2	10.50	TD

QUANTITY OF CEMENT

Cement to Surface

To be determined by Caliper Log

Drill 13-1/2" Surface hole to 200'. Cement to surface. Drill 8-3/4" hole to 4200'. Cement thru Ojo Alamo. Run 7" 23 lb K-55 LTC to 3200' Cement with 1000' fill. Run 4-1/2" producing casing to 4200' + -.

Surface to be drilled with 9 lb. mud weight viscosity 45' to 200'. From 200' to TD will be drilled with air mist.

IN ABOVE SPACE DESCRIBE
zone. If proposal is to d
preventer program, if any.

24.

SIGNED

Harry Williams
will send
Operator Change
for this well

TITLE

Agent

(This space for Federal or State office use)

PERMIT NO.

APPROVAL DATE

APPROVED BY

TITLE

CONDITIONS OF APPROVAL, IF ANY:

NMOCC

RECEIVED
SEP 26 1983
OIL CON. DIV.
DIST. 2

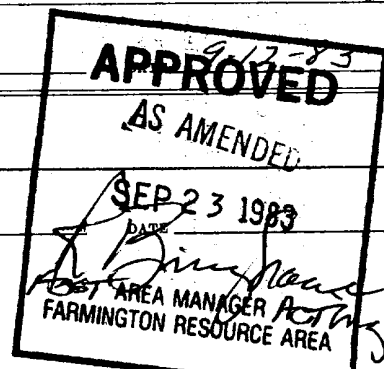

All distances must be from the outer boundaries of the Section.

Operator SAMUEL GARY OIL PRODUCER			Lease FEDERAL NM-19151		Well No. 28-8
Unit Letter H	Section 28	Township 20 NORTH	Range 3 WEST	County SANDOVAL	
Actual Footage Location of Well: 1848 feet from the NORTH line and 732 feet from the EAST line					
Ground Level Elev. 6740	Producing Formation Gallup	Pool Undesignated	Dedicated Acreage: 40 Acres		

1. Outline the acreage dedicated to the subject well by colored pencil or hatchure marks on the plat below.
2. If more than one lease is dedicated to the well, outline each and identify the ownership thereof (both as to working interest and royalty).
3. If more than one lease of different ownership is dedicated to the well, have the interests of all owners been consolidated by communitization, unitization, force-pooling, etc?

☐ Yes ☐ No If answer is "yes," type of consolidation _____

If answer is "no," list the owners and tract descriptions which have actually been consolidated (Use reverse side of this form if necessary.) _____

No allowable will be assigned to the well until all interests have been consolidated (by communitization, unitization, forced-pooling, or otherwise) or until a non-standard unit, eliminating such interests, has been approved by the Division

RECEIVED
SEP 26 1983
CON. DIV.
DIST. 13

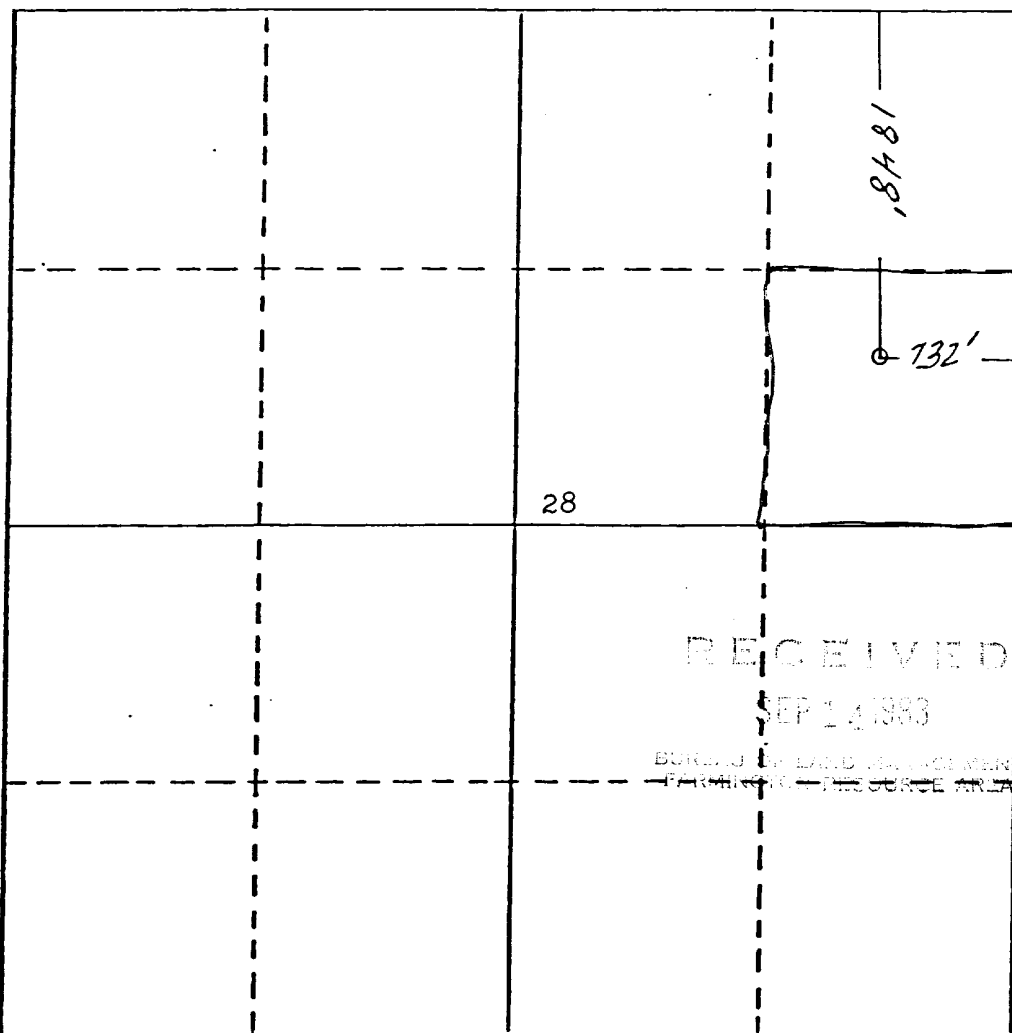

CERTIFICATION

I hereby certify that the information contained herein is true and complete to the best of my knowledge and belief.

Name Del Alvarado
Position Agent
Company Samuel Gary Oil Producer
Date 9-29-83

I hereby certify that the well location shown on this plat was plotted from field notes of survey made by me or under my supervision, and that the same are true and correct to the best of my knowledge and belief.

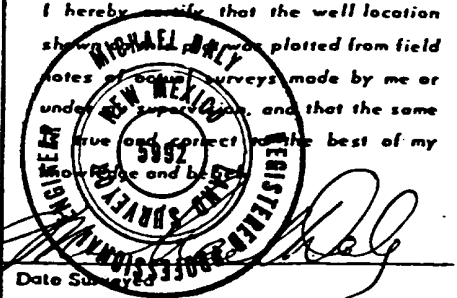

Date Surveyed September 13, 1983

Registered Professional Engineer and/or Land Surveyor

Michael Daly

Certificate No. 5992

0 330 660 990 1320 1650 1980 2310 2640 2970 3300 3630 3960 4290 4620 4950 5280 5610 5940 6270 6600

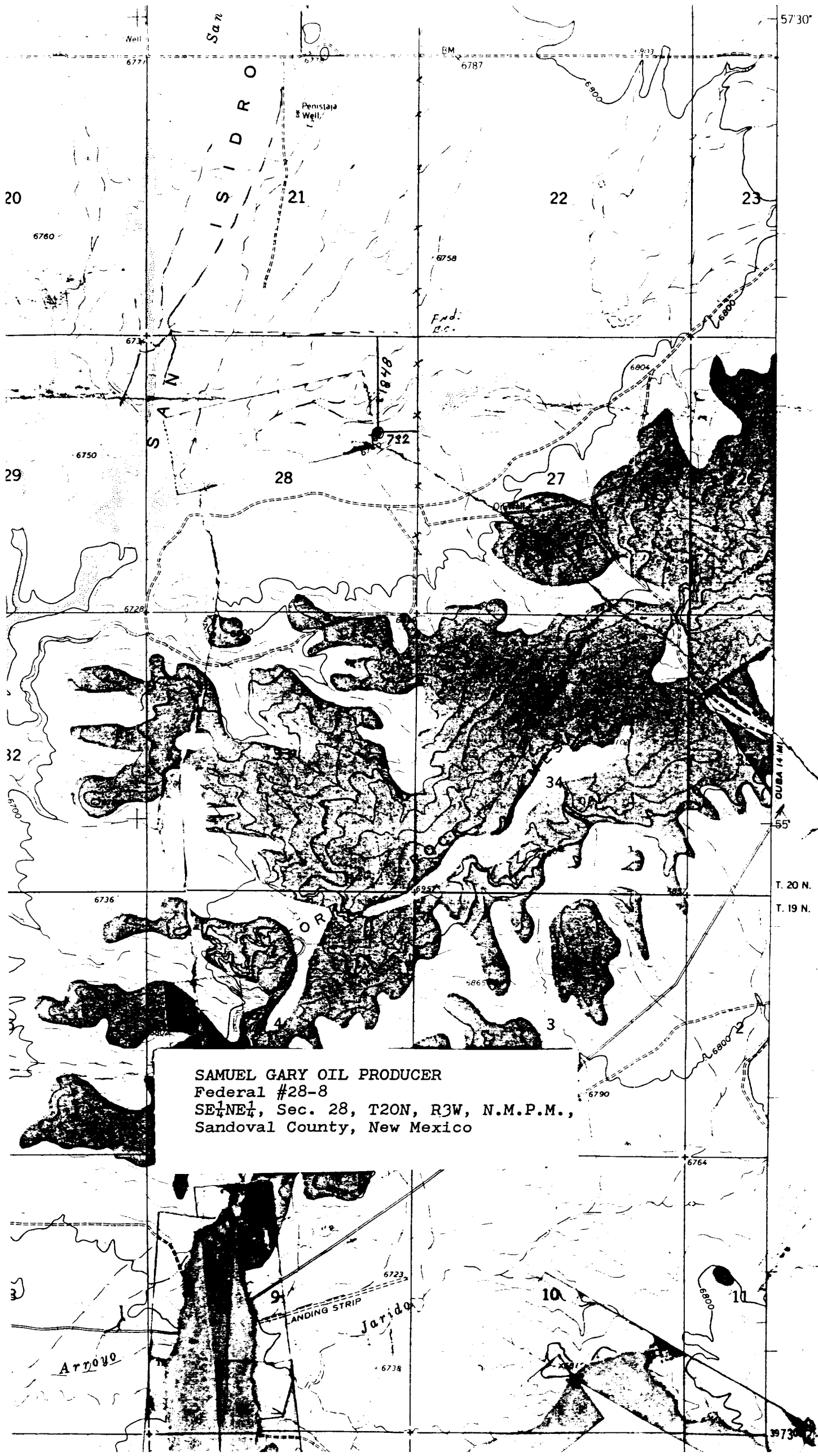

SAMUEL GARY OIL PRODUCER
Federal #28-8
SE $\frac{1}{4}$ NE $\frac{1}{4}$, Sec. 28, T20N, R3W, N.M.P.M.,
Sandoval County, New Mexico

57°30'

T. 20 N.
T. 19 N.

39°30' 2" N