



IN REPLY REFER TO:

UNITED STATES
DEPARTMENT OF THE INTERIOR
GEOLOGICAL SURVEY

P. O. Box 965
Farmington, New Mexico

COPY TO O. C. C.

August 2, 1955

Amesada Petroleum Corporation
Drawer D
Monument, New Mexico

RE: Jicarilla Tribal Contract 40
Tract 85

Gentlemen:

Receipt is acknowledged of your "Notice of Intention to Drill" dated July 29, 1955 covering your well No. 1 Jicarilla Apache "D" in NW $\frac{1}{4}$ SW $\frac{1}{4}$ sec. 35, T. 24 N, R. 5 W, N. M. P. M., Rio Arriba County, New Mexico, Wildcat pool.

Your proposed work is hereby approved subject to compliance with the provisions of the "Oil and Gas Operating Regulations" revised May 25, 1942, a copy of which will be sent to you on request, and subject to the following conditions:

1. Drilling operations so authorized are subject to the attached sheet for general conditions of approval.
2. Furnish copies of all logs.

Very truly yours,

(Orig. Sgd.) P. T. McGRATH

P. T. McGrath
District Engineer



PTMcGrath:al
cc: Jicarilla Agency

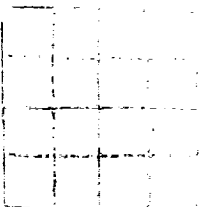

IN REPLY REFER TO

UNITED STATES
DEPARTMENT OF THE INTERIOR
GEOLOGICAL SURVEY



OFFICE OF THE CHIEF OF BUREAU



WILLIAM F. T. WILKINSON

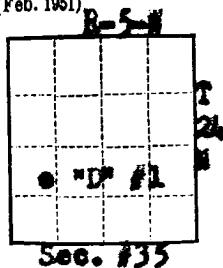

(SUBMIT IN TRIPLICATE)

UNITED STATES
DEPARTMENT OF THE INTERIOR
GEOLOGICAL SURVEY

Land Office Jicarilla Apache
Lease No. Jicarilla Apache
Tribal #40; Tract #85
Unit Jicarilla Apache "D"

RECEIVED

SUNDRY NOTICES AND REPORTS ON WELLS

NOTICE OF INTENTION TO DRILL.....	<input checked="" type="checkbox"/>	SUBSEQUENT REPORT OF WATER SHUT-OFF.....
NOTICE OF INTENTION TO CHANGE PLANS.....		SUBSEQUENT REPORT OF SHOOTING OR ACIDIZING.....
NOTICE OF INTENTION TO TEST WATER SHUT-OFF.....		SUBSEQUENT REPORT OF ALTERING CASING.....
NOTICE OF INTENTION TO RE-DRILL OR REPAIR WELL.....		SUBSEQUENT REPORT OF RE-DRILLING OR REPAIR.....
NOTICE OF INTENTION TO SHOOT OR ACIDIZE.....		SUBSEQUENT REPORT OF ABANDONMENT.....
NOTICE OF INTENTION TO PULL OR ALTER CASING.....		SUPPLEMENTARY WELL HISTORY.....
NOTICE OF INTENTION TO ABANDON WELL.....		

(INDICATE ABOVE BY CHECK MARK NATURE OF REPORT, NOTICE, OR OTHER DATA)

July 29, 1955

Well No. 1 is located 1680' ft. from S line and 990' ft. from W line of sec. #35

NW/4, SE/4 #35 (1/4 Sec. and Sec. No.) T-24-N (Twp.) R-5-W (Range) NMPM (Meridian)
Wilcox (Field) Rio Arriba (County or Subdivision) New Mexico (State or Territory)

The elevation of the derrick floor above sea level is _____ ft. **Not determined.**

DETAILS OF WORK

(State names of and expected depths to objective sands; show sizes, weights, and lengths of proposed casings; indicate mudding jobs, cementing points, and all other important proposed work)

We intend to drill well with Rotary tools to approximately 3000' to test Fruitland Pictured Cliff section.

HOLE	CASING	WEIGHT	NEW OR SH	DEPTH	HOW SET	SACKS CEMENT
12-1/4"	8-5/8"	32#	New	120'	Cemented	100
7-7/8"	5-1/2"	15.5#	New	3000'	Cemented	400

I understand that this plan of work must receive approval in writing by the Geological Survey before operations may be commenced.

Company Amerada Petroleum Corporation

Address Drawer D
Monument, New Mexico

By H. E. Campbell
Title District Superintendent

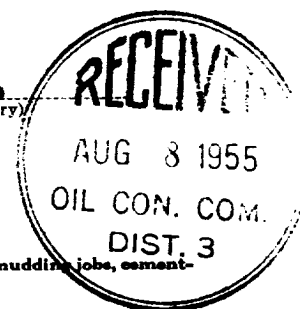

[illegible]

10

Company AMERADA PETROLEUM CORPORATION

Lease JICARILLA APACHE "D". CONTR. 40 Well No. 1

Sec. 35, T. 24 N, R. 5 W, N.M.P.M.

Location 1680' FROM THE SOUTH LINE AND 990' FROM
THE WEST LINE.

RIO ARriba COUNTY

NEW MEXICO

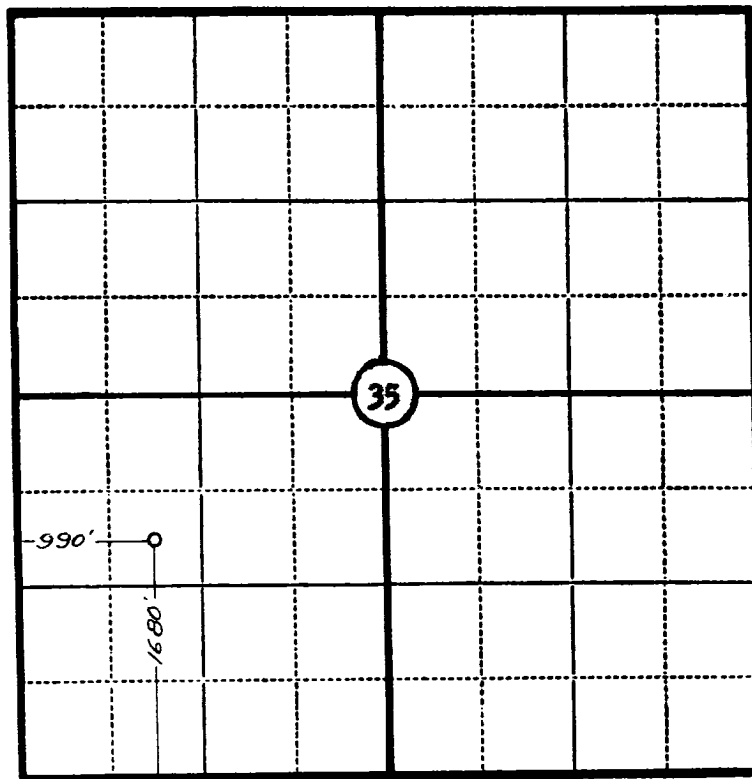

Scale—4 inches equal 1 mile.

This is to certify that the above plat was prepared from field notes of actual surveys made by me or under my supervision and that the same are true and correct to the best of my knowledge and belief.

Seal:

James P. Leese
Registered ~~Surveyor~~ Land Surveyor.

James P. Leese
N. Mex. Reg. No. 1463

Surveyed 30 July, 1955

