

(SUBMIT IN TRIPLICATE)

UNITED STATES  
DEPARTMENT OF THE INTERIOR  
GEOLOGICAL SURVEY

Land Office San Juan  
Lease No. 07090  
Unit Normal

SUNDRY NOTICES AND REPORTS ON WELLS

NOTICE OF INTENTION TO DRILL.....	<input checked="" type="checkbox"/>	SUBSEQUENT REPORT OF WATER SHUT-OFF.....	
NOTICE OF INTENTION TO CHANGE PLANS.....		SUBSEQUENT REPORT OF SHOOTING OR ACIDIZING.....	
NOTICE OF INTENTION TO TEST WATER SHUT-OFF.....		SUBSEQUENT REPORT OF ALTERING CASING.....	
NOTICE OF INTENTION TO RE-DRILL OR REPAIR WELL.....		SUBSEQUENT REPORT OF RE-DRILLING OR REPAIR.....	
NOTICE OF INTENTION TO SHOOT OR ACIDIZE.....		SUBSEQUENT REPORT OF ABANDONMENT.....	
NOTICE OF INTENTION TO PULL OR ALTER CASING.....		SUPPLEMENTARY WELL HISTORY.....	
NOTICE OF INTENTION TO ABANDON WELL.....			

(INDICATE ABOVE BY CHECK MARK NATURE OF REPORT, NOTICE, OR OTHER DATA)

Well No. 1 is located 1600 ft. from N line and 1600 ft. from W line of sec. 32  
32 Sec. 32 32N 32E 32W  
 (1/4 Sec. and Sec. No.) (Twp.) (Range) (Meridian)  
San Juan Co. New Mexico San Juan  
 (Field) (County or Subdivision) (State or Territory)

The elevation of the derrick floor above sea level is 6700 ft.

DETAILS OF WORK

(State names of and expected depths to objective sands; show sizes, weights, and lengths of proposed casings; indicate mudding jobs, cementing points, and all other important proposed work)

It is intended to drill a well thru the Pictured Cliffs formation using rotary tools and to permeate and water fracture possible producing zones. Estimated Total Depth 2500'.

Casing Program:

9-5/8" at 120' with 125 sacks regular cement circulated to surface.

5-1/2" at 2500' with 75 sacks regular cement, 75 sacks heavy.

The NW 1/4 of Section 32 is dedicated to this well.  
 SP 07090 (NW 1/4).

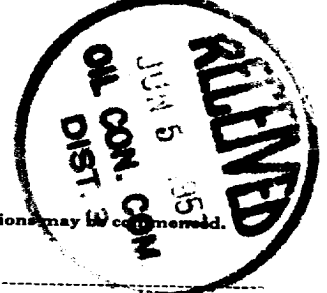

I understand that this plan of work must receive approval in writing by the Geological Survey before operations may be commenced.

Company El Paso Natural Gas Company

Address Box 907

Farmington, New Mexico

By [Signature]

Title Petroleum Engineer

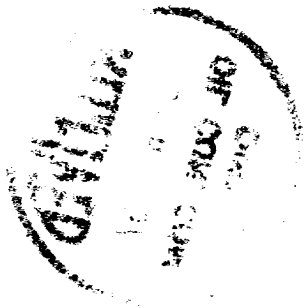

Well Location and Acreage Dedication Plat

Section A

Date MAY 31, 1957

Operator EL PASO NATURAL GAS COMPANY Lease DONNELL SF 078598  
 Well No. 1 Unit Letter \_\_\_\_\_ Section 22 Township 24-N Range 6-W NMPM  
 Located 1650 Feet From NORTH Line, 1010 Feet From WEST Line  
 County RIO ARriba G. L. Elevation 6759.21 Dedicated Acreage 160 Acres  
 Name of Producing Formation PICTURED CLIFF Pool WILDCAT

1. Is the Operator the only owner in the dedicated acreage outlined on the plat below?  
 Yes ☒ No \_\_\_\_\_
2. If the answer to question one is "no", have the interests of all the owners been consolidated by commun-  
 ication agreement or otherwise? Yes \_\_\_\_\_ No \_\_\_\_\_ If answer is "yes," Type of Consol-  
 idation \_\_\_\_\_
3. If the answer to question two is "no," list all the owners and their respective interests below

OwnerLand Description

Section B

This is to certify that the information  
 in Section A above is true and com-  
 plete to the best of my knowledge  
 and belief

**El Paso Natural Gas Co.**

(Operator)

*R. J. Johnston*

(Representative)

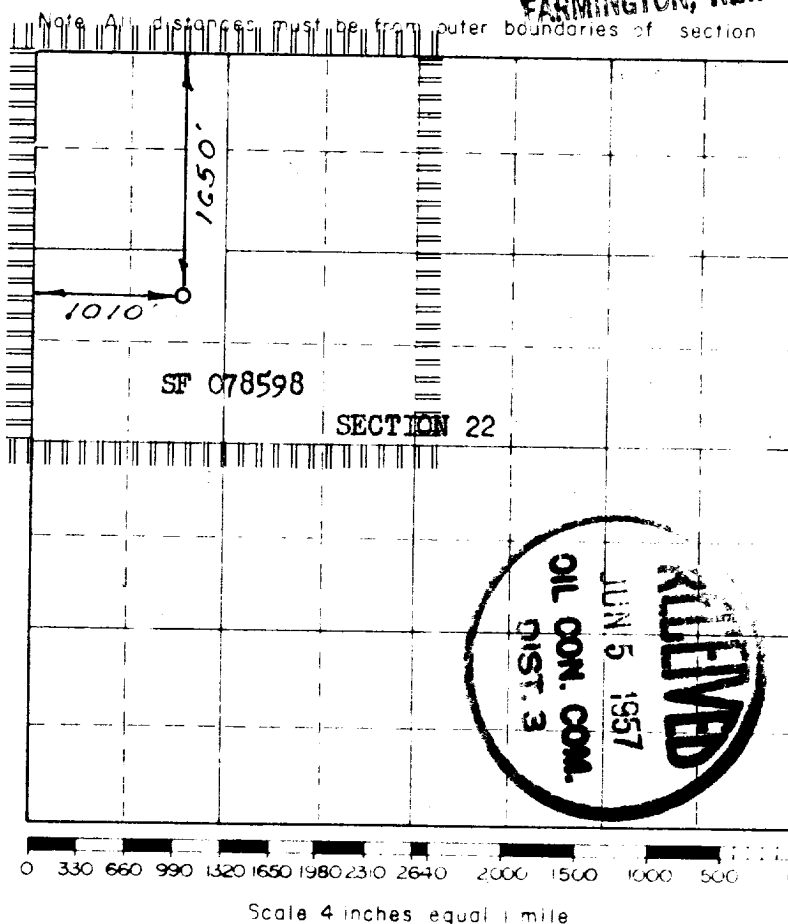
**Box 997** Address**Farmington, New Mexico**

This is to certify that the above plat was prepared from field notes of actual surveys  
 made by me or under my supervision and that the same are true and correct to the  
 best of my knowledge and belief.

(Seal)

Farmington, New Mexico

Date Surveyed APRIL 25, 1957*E. O. Walker*  
Registered Professional Engineer and/or Land Surveyor