

(SUBMIT IN TRIPLICATE)

Indian Agency Salas, New Mexico

UNITED STATES
DEPARTMENT OF THE INTERIOR
GEOLOGICAL SURVEY

Sanilla Apache

Allottee Cont. #188-Trust #225

Lease No. J. Apache "G"

3

Sec-16	
T2N-R4E	

SUNDRY NOTICES AND REPORTS ON WELLS

NOTICE OF INTENTION TO DRILL	<input checked="" type="checkbox"/>	SUBSEQUENT REPORT OF WATER SHUT-OFF	
NOTICE OF INTENTION TO CHANGE PLANS		SUBSEQUENT REPORT OF SHOOTING OR ACIDIZING	
NOTICE OF INTENTION TO TEST WATER SHUT-OFF		SUBSEQUENT REPORT OF ALTERING CASING	
NOTICE OF INTENTION TO REDRILL OR REPAIR WELL		SUBSEQUENT REPORT OF REDRILLING OR REPAIR	
NOTICE OF INTENTION TO SHOOT OR ACIDIZE		SUBSEQUENT REPORT OF ABANDONMENT	
NOTICE OF INTENTION TO PULL OR ALTER CASING		SUPPLEMENTARY WELL HISTORY	
NOTICE OF INTENTION TO ABANDON WELL			

(INDICATE ABOVE BY CHECK MARK NATURE OF REPORT, NOTICE, OR OTHER DATA)

September 28, 1962

Well No. 1 is located 744' ft. from S line and 744' ft. from E line of sec. 16

NE-SE-SE - Sec-16

(1/4 Sec. and Sec. No.)

R4E

(Twp.)

4N

(Range)

W2W

(Meridian)

Basin Dakota

(Field)

Rio Arriba

(County or Subdivision)

New Mexico

(State or Territory)

The elevation of the derrick floor above sea level is 6837' ft. Ungraded Ground



DETAILS OF WORK

(State names of and expected depths to objective sands; show sizes, weights, and lengths of proposed casings; indicate mudding jobs, cementing points, and all other important proposed work)

PROPOSED TOTAL DEPTH: To be drilled to 7500' or sufficient depth to test Dakota Formation.

SURFACE CASING: Will set 9-5/8" OD 25-lb Amoco SW 63 Casing at 160' and Circulate Cement.

PRODUCTION STRING: Will set production string to total depth if productive and cement with sufficient cement to protect Dakota & Gallup Zones, and second stage through staging tool approximately 100' below Pictured Cliffs and cement with sufficient cement to protect Pictured Cliffs Zone.

Lease consists of all of secs. 15, 16, 21 and 22, T2N, R4E, Rio Arriba County, New Mex. Survey Plat of secs. 15, 16, 21 and 22 filed under date of September 21, 1962, by Land Department.

I understand that this plan of work must receive approval in writing by the Geological Survey before operations may be commenced.

Company Amerada Petroleum Corporation

Address Box 1449

Durango, Colorado

PH-267-5553

*Oct 4th
NSC approved
notified 10-4-62
filed 10-4-62*

By D.F. Furee D.F. Furee
Title Foreman

NUMBER OF COPIES RECEIVED	
DISTRIBUTION	
SANTA FE	
FILE	
U.S.G.S.	
LAND OFFICE	
TRANSPORTER	OIL
	GAS
PRODUCTION OFFICE	
OPERATOR	

NEW MEXICO OIL CONSERVATION COMMISSION
WELL LOCATION AND ACREAGE DEDICATION PLAT
 SEE INSTRUCTIONS FOR COMPLETING THIS FORM ON THE REVERSE SIDE

FORM C-128
 Revised 5/1/57

SECTION A

Operator Amerada Petroleum Corporation		Lease Jicarilla Apache "G"		Well No. 1
Unit Letter P	Section 16	Township 24N	Range 4W	County Rio Arriba
Actual Footage Location of Well: 944' feet from the South line and 746' feet from the East line				
Ground Level Elev. 6637'	Producing Formation Basin Dakota Formation	Pool Basin Dakota	Dedicated Acreage: 330 Acres	

1. Is the Operator the only owner in the dedicated acreage outlined on the plat below? YES ☒ NO ____ . ("Owner" means the person who has the right to drill into and to produce from any pool and to appropriate the production either for himself or for himself and another. (65-3-29 (e) NMSA 1935 Comp.)
2. If the answer to question one is "no," have the interests of all the owners been consolidated by communitization agreement or otherwise? YES ____ NO ____ . If answer is "yes," Type of Consolidation ____
3. If the answer to question two is "no," list all the owners and their respective interests below:

Owner	Land Description

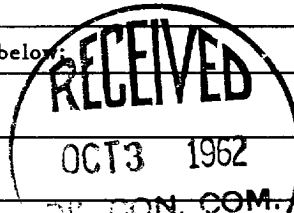

SECTION B

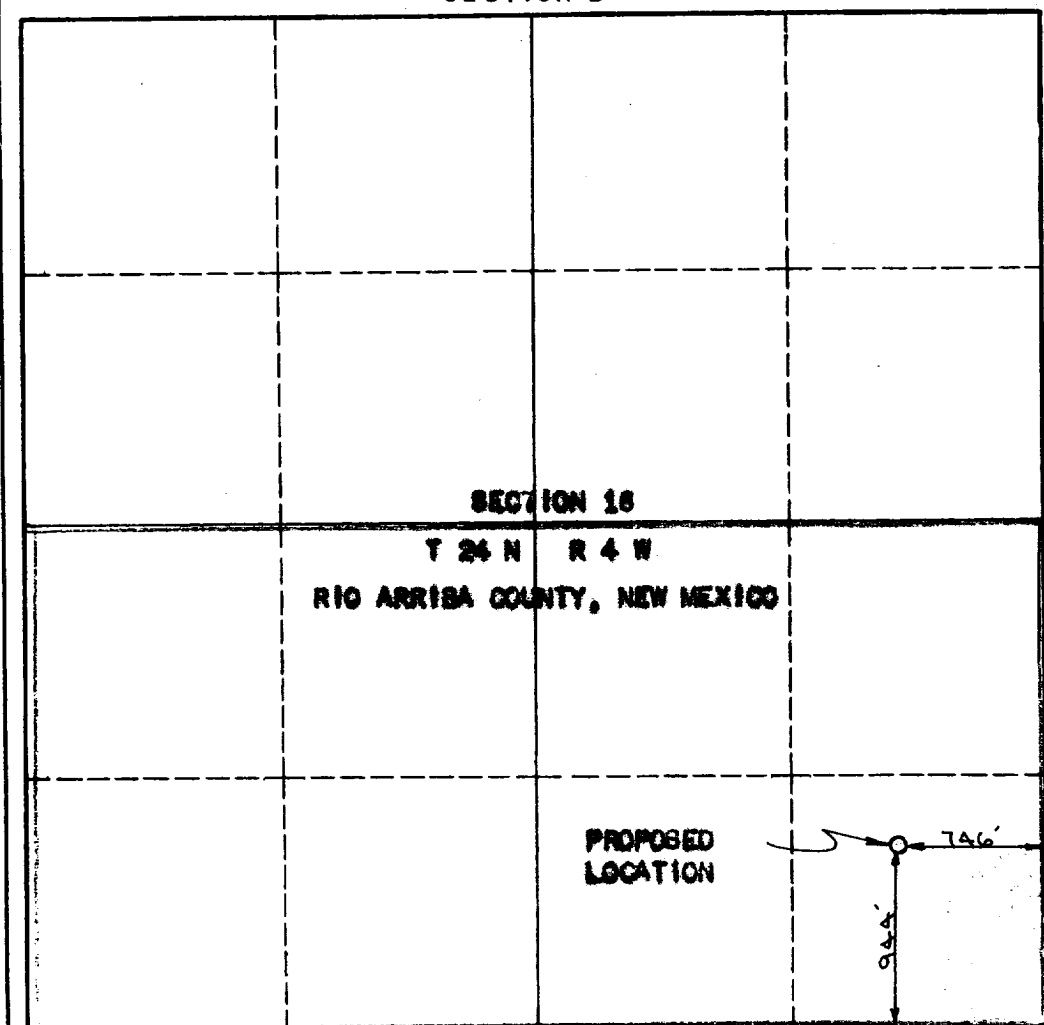

CERTIFICATION

I hereby certify that the information in SECTION A above is true and complete to the best of my knowledge and belief.

D.F. Furze **D.F. Furze**

Name Foreman
Position Amerada Petroleum Corp.
Company September 28, 1962
Date

I hereby certify that the well location shown on the plat in SECTION B was plotted from field notes of actual surveys made by me or under my supervision, and that the same is true and correct to the best of my knowledge and belief.

Date Surveyed 9-14-62
Registered Professional Engineer and/or Land Surveyor
<i>Edmund M. Clark</i>
Certificate No. 3189

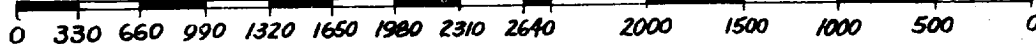

INSTRUCTIONS FOR COMPLETION OF FORM C-128

1. Operator shall furnish and certify to the information called for in Section A.
2. Operator shall outline the dedicated acreage for *both* oil and gas wells on the plat in Section B.
3. A registered professional engineer or land surveyor registered in the State of New Mexico or approved by the Commission shall show on the plat the location of the well and certify this information in the space provided.
4. All distances shown on the plat must be from the outer boundaries of the Section.
5. If additional space is needed for listing owners and their respective interests as required in question 3 of Section A, please use space below.