

(SUBMIT IN TRIPLICATE)

UNITED STATES
DEPARTMENT OF THE INTERIOR
GEOLOGICAL SURVEY

Indian Agency Alamo, New Mexico
Jicarilla Apache
Allottee Cont. #128-Tract #223
Lease No. A. S. Apache #0*

500-16	
T24N-R4W	

SUNDRY NOTICES AND REPORTS ON WELLS

NOTICE OF INTENTION TO DRILL <u>See Foot Note</u>	<input checked="" type="checkbox"/>	SUBSEQUENT REPORT OF WATER SHUT-OFF	
NOTICE OF INTENTION TO CHANGE PLANS		SUBSEQUENT REPORT OF SHOOTING OR ACIDIZING	
NOTICE OF INTENTION TO TEST WATER SHUT-OFF		SUBSEQUENT REPORT OF ALTERING CASING	
NOTICE OF INTENTION TO REDRILL OR REPAIR WELL		SUBSEQUENT REPORT OF REDRILLING OR REPAIR	
NOTICE OF INTENTION TO SHOOT OR ACIDIZE		SUBSEQUENT REPORT OF ABANDONMENT	
NOTICE OF INTENTION TO PULL OR ALTER CASING		SUPPLEMENTARY WELL HISTORY	
NOTICE OF INTENTION TO ABANDON WELL			

U.S. GEOLOGICAL SURVEY

(INDICATE ABOVE BY CHECK MARK NATURE OF REPORT, NOTICE, OR OTHER DATA)

October 8, 1962

Well No. 1 is located 744 ft. from S line and 790 ft. from E line of sec. 16

N4-51-52-600-16
(1/4 Sec. and Sec. No.)

24N
(Twp.)

4W
(Range)

MDPN
(Meridian)

Basin Dakota
(Field)

Rio Arriba
(County or Subdivision)

New Mexico
(State or Territory)

The elevation of the derrick floor above sea level is 6037 ft.

DETAILS OF WORK

(State names of and expected depths to objective sands; show sizes, weights, and lengths of proposed casings; indicate mudding jobs, cementing points, and all other important proposed work)

PROPOSED TOTAL DEPTH: To be drilled to 7500' or sufficient depth to test Dakota Formation.

SURFACE CASING: Will set 9-5/8" OD 25.4# Armo SW 5J Casing @ 140' and Circulate cement.

Production String: If productive, will set production string to total depth and cement with sufficient cement to protect Dakota & Gallup Zones, and second stage through staging tool approximately 100' below Pictured Cliffs and cement with sufficient cement to protect Pictured Cliffs Zone.

Lease consists of all of secs. 15, 16, 21 and 22, T24N, R4W, Rio Arriba County, New Mex.

NOTE: This location moved 44' West to read 790' from East line of Unit Boundary, to conform with rules and regulations governing the Basin Dakota Pool. This cancels original "Notice of Intention to Drill" filed 9/28/62.

I understand that this plan of work must receive approval in writing by the Geological Survey before operations may be commenced.

Company Amerada Petroleum Corporation

Address Box 1449

Durango, Colorado

247-5353

By D.F. Farce D.F. Farce

Title Foreman

NUMBER OF COPIES RECEIVED	
DISTRIBUTION	
SANTA FE	
FILE	
U.S.G.S.	
LAND OFFICE	
TRANSPORTER	OIL GAS
PRODUCTION OFFICE	
OPERATOR	

NEW MEXICO OIL CONSERVATION COMMISSION
WELL LOCATION AND ACREAGE DEDICATION PLAT
 SEE INSTRUCTIONS FOR COMPLETING THIS FORM ON THE REVERSE SIDE

FORM C-128
Revised 5/1/57

SECTION A

Operator Amerada Petroleum Corporation		Lease Jicarilla Apache "G"		Well No. 1
Unit Letter P	Section 16	Township 24 N	Range 4 W	County Rio Arriba
Actual Footage Location of Well: 944' feet from the South line and 790' feet from the Last line				
Ground Level Elev. 6637'	Producing Formation Basin Dakota Formation	Pool Basin Dakota	Dedicated Acreage: 380 Acres	

1. Is the Operator the only owner in the dedicated acreage outlined on the plat below? YES ☒ NO ____ . ("Owner" means the person who has the right to drill into and to produce from any pool and to appropriate the production either for himself or for himself and another. (65-3-29 (e) NMSA 1935 Comp.)
2. If the answer to question one is "no," have the interests of all the owners been consolidated by communitization agreement or otherwise? YES ____ NO ____ . If answer is "yes," Type of Consolidation ____
3. If the answer to question two is "no," list all the owners and their respective interests below:

Owner	Land Description

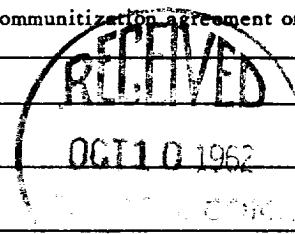

SECTION B

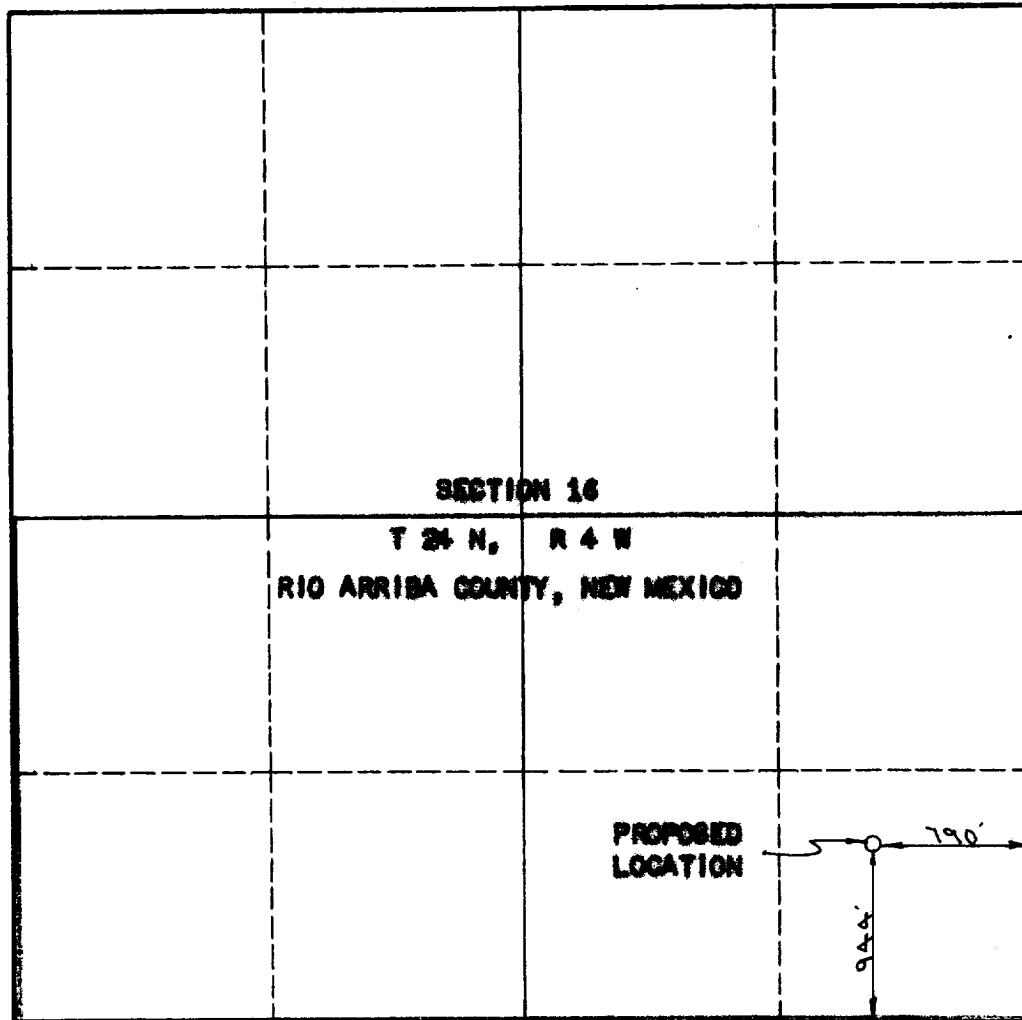

CERTIFICATION

I hereby certify that the information in SECTION A above is true and complete to the best of my knowledge and belief.

Name D. F. Furrer D. F. Furrer
Position Foreman
Company Amerada Petroleum Corp.
Date October 8, 1962

I hereby certify that the well location shown on the plat in SECTION B was plotted from field notes of actual surveys made by me or under my supervision, and that the same is true and correct to the best of my knowledge and belief.

Date Surveyed 10-8-62
Registered Professional Engineer and/or Land Surveyor Edmund M. Clark
Certificate No. 3189

0 330 660 990 1320 1650 1980 2310 2640 2000 1500 1000 500 0

INSTRUCTIONS FOR COMPLETION OF FORM C-128

1. Operator shall furnish and certify to the information called for in Section A.
2. Operator shall outline the dedicated acreage for *both* oil and gas wells on the plat in Section B.
3. A registered professional engineer or land surveyor registered in the State of New Mexico or approved by the Commission shall show on the plat the location of the well and certify this information in the space provided.
4. All distances shown on the plat must be from the outer boundaries of the Section.
5. If additional space is needed for listing owners and their respective interests as required in question 3 of Section A, please use space below.