

n 9-231b
-II 1962)

(SUBMIT IN TRIPLICATE)

Indian Agency

Jicarilla Apache

UNITED STATES

DEPARTMENT OF THE INTERIOR

GEOLOGICAL SURVEY

Allottee

Lease No. 36

16		
		X

SUNDRY NOTICES AND REPORTS ON WELLS RECEIVE

NOTICE OF INTENTION TO DRILL	<input checked="" type="checkbox"/>	SUBSEQUENT REPORT OF WATER SHUT-OFF	APR 9 1962
NOTICE OF INTENTION TO CHANGE PLANS		SUBSEQUENT REPORT OF SHOOTING OR ACIDIZING	
NOTICE OF INTENTION TO TEST WATER SHUT-OFF		SUBSEQUENT REPORT OF ALTERING CASING	
NOTICE OF INTENTION TO REDRILL OR REPAIR WELL		SUBSEQUENT REPORT OF REDRILLING OR REPAIR	U. S. GEOLOGICAL SURV
NOTICE OF INTENTION TO SHOOT OR ACIDIZE		SUBSEQUENT REPORT OF ABANDONMENT	FARMINGTON, NEW MEXI
NOTICE OF INTENTION TO PULL OR ALTER CASING		SUPPLEMENTARY WELL HISTORY	
NOTICE OF INTENTION TO ABANDON WELL			

(INDICATE ABOVE BY CHECK MARK NATURE OF REPORT, NOTICE, OR OTHER DATA)

April 6, 1962

N. E. Haynes
Well No. 3 is located 990 ft. from N line and 990 ft. from E line of sec. 16

SE/4 Sec. 16
(1/4 Sec. and Sec. No.)

T24N
(Twp.)

R5W
(Range)

NMPM
(Meridian)

Basin Dakota
(Field)

Rio Arriba County
(County or Subdivision)

New Mexico
(State or Territory)

The elevation of the derrick floor above sea level is 6684 ft. (Est. 11' RBM)



DETAILS OF WORK

(State names of and expected depths to objective sands; show sizes, weights, and lengths of proposed casings; indicate mudding jobs, cementing points, and all other important proposed work)

We propose to drill this well with rotary tools to an estimated depth of 6900' to test the Dakota formation. Approximately 300' of 8 5/8" surface pipe will be run and cemented to surface. If commercial production is encountered, a string of 5 1/2" casing will be run and cemented and the well completed.

The Dakota and Gallup formations will be cemented through the casing shoe and the Mesa Verde and Pictured Cliffs formations will be cemented through a stage collar at approximately 4700'.



I understand that this plan of work must receive approval in writing by the Geological Survey before operations may be commenced.

Company Continental Oil Company

Address Box 3312
Durango, Colorado

Original Signed By:
H. D. HALEY

Title District Superintendent

Page 1 of 1

66

60

3

45

100-111111-111111

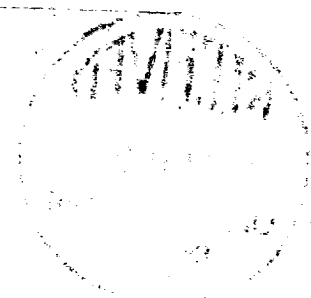

CONFIDENTIAL - NO FORN DISSEM

Box 3315

observed, compared

10-10-68 100000 100000

978-2-310-06112-1

NUMBER OF COPIES RECEIVED	
DISTRIBUTION	
SANITARY	
FILE	
U.S.G.S.	
LAND OFFICE	
TRANSPORTER	OIL GAS
PRODUCTION OFFICE	
OPERATOR	

NEW MEXICO OIL CONSERVATION COMMISSION
WELL LOCATION AND ACREAGE DEDICATION PLAT
 SEE INSTRUCTIONS FOR COMPLETING THIS FORM ON THE REVERSE SIDE

FORM C-128
 Revised 5/1/57

SECTION A			
Operator Continental Oil Company		Lease H. S. Haynes Apache	
Well No. 3			
Unit Letter P	Section 16	Township 24N	Range 3W
County Rio Arriba			
Actual Footage Location of Well: 990 feet from the South line and 990 feet from the East line			
Ground Level Elev. 6673	Producing Formation Dakota	Pool Basin Dakota	Dedicated Acreage: 320 Acres

1. Is the Operator the only owner in the dedicated acreage outlined on the plat below? YES ☒ NO ____ . ("Owner" means the person who has the right to drill into and to produce from any pool and to appropriate the production either for himself or for himself and another. (65-3-29 (e) NMSA 1935 Comp.)
2. If the answer to question one is "no," have the interests of all the owners been consolidated by communitization agreement or otherwise? YES ____ NO ____ . If answer is "yes," Type of Consolidation ____
3. If the answer to question two is "no," list all the owners and their respective interests below.

Owner	Land Description

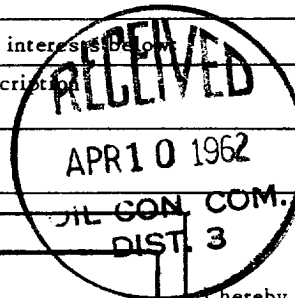

SECTION B

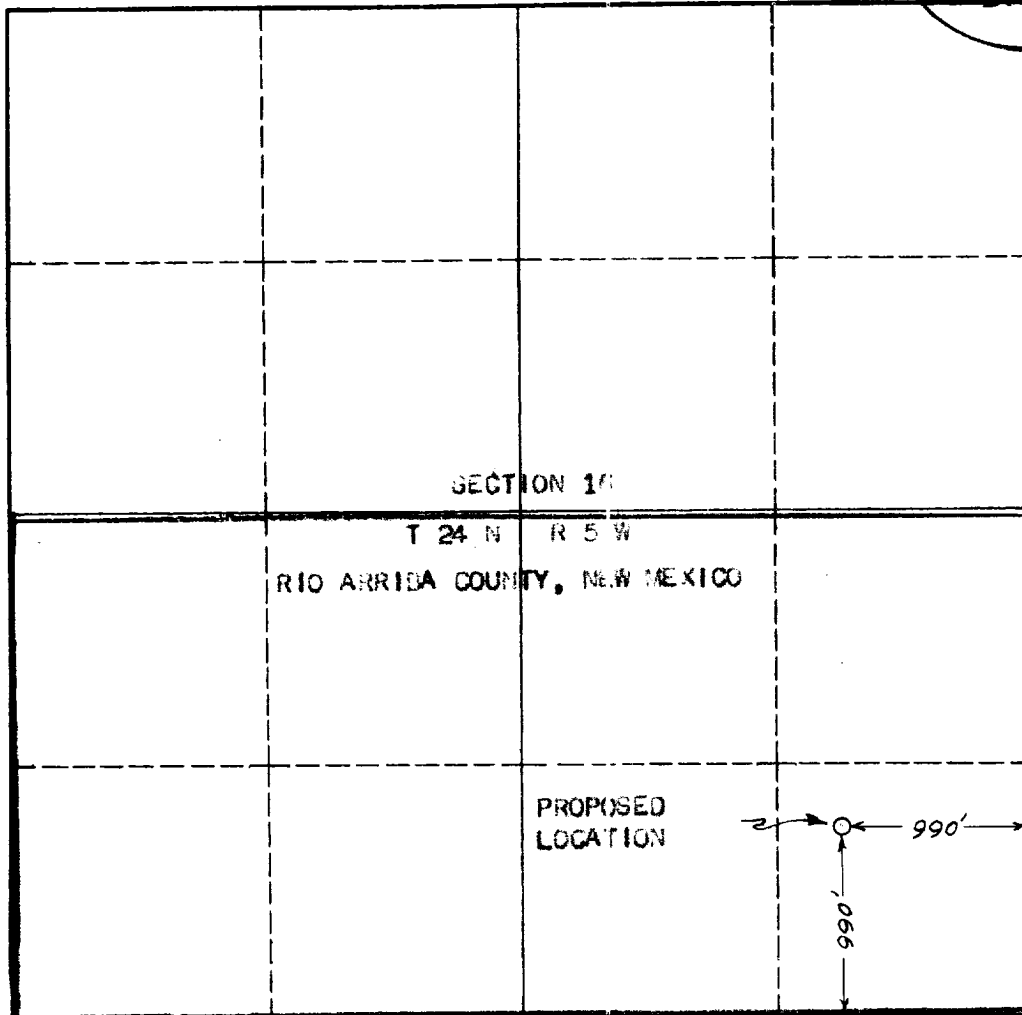

CERTIFICATION

I hereby certify that the information in SECTION A above is true and complete to the best of my knowledge and belief.

Name Original Signed By:
H. D. HALEY
 Position
District Superintendent
 Company
Continental Oil Company
 Date
April 6, 1962

I hereby certify that the well location shown on the plat in SECTION B was plotted from field notes of actual surveys made by me or under my supervision, and that the same is true and correct to the best of my knowledge and belief.

Date Surveyed
3-16-62
 Registered Professional Engineer and/or Land Surveyor
[Signature]
 Certificate No. **#3189**

INSTRUCTIONS FOR COMPLETION OF FORM C-128

1. Operator shall furnish and certify to the information called for in Section A.
2. Operator shall outline the dedicated acreage for *both* oil and gas wells on the plat in Section B.
3. A registered professional engineer or land surveyor registered in the State of New Mexico or approved by the Commission shall show on the plat the location of the well and certify this information in the space provided.
4. All distances shown on the plat must be from the outer boundaries of the Section.
5. If additional space is needed for listing owners and their respective interests as required in question 3 of Section A, please use space below.