

NEW MEXICO
OIL CONSERVATION COMMISSION

Form C-128

Well Location and/or Gas Proration Plat

Date 6-14-56

Operator GARDNER PETROLEUM COMPANY Lease Federal SF 081347

Well No. 1 Section 17 Township 24 NORTH Range 3 WEST NMPM

Located 1170 Feet From the NORTH Line, 1140 Feet From the EAST Line,

RIO ARriba County, New Mexico. G. L. Elevation 6878.7 UNGRADED GROUND

Name of Producing Formation P.C. Pool U.C. Dedicated Acreage 160

(Note: All distances must be from outer boundaries of Section)

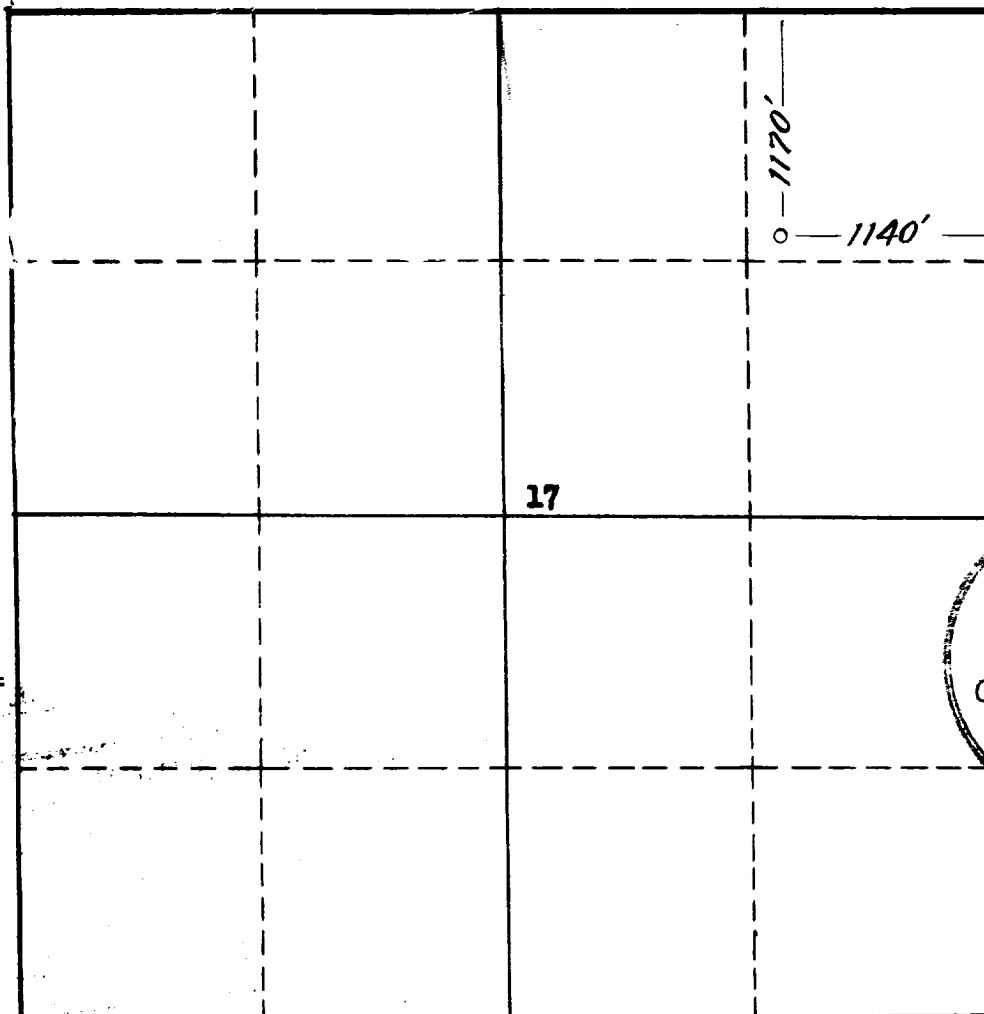

NOTE

This section of form is to be used for gas wells only.



SCALE: 1"=1000'

1. Is this Well a Dual Comp. ? Yes No X.
2. If the answer to Question 1 is yes, are there any other dually completed wells within the dedicated acreage ? Yes No.

Name James H. Gardner
Position President
Representing Gardner Pet. Co.
Address 411 Mayo Bldg Tulsa, Okla.

This is to certify that the above plat was prepared from field notes of actual surveys made by me or under my supervision and that the same are true and correct to the best of my knowledge and belief.

Date Surveyed 4 JUNE 1956
James P. Leese
Registered Professional Engineer and/or
Land Surveyor James P. Leese
N. Mex. Reg. No. 1463

RECREATION COMMISSION		
AZTEC DISTRICT OFFICE		
No. Copies Received		3
DISTRIBUTION		
	NO. FURNISHED	
Director	1	
Asst. Dir.	1	
District Office		
State Land Office		
U. S. G. S.		
Transporter		
File	1	✓