

(SUBMIT IN TRIPLICATE)

UNITED STATES  
DEPARTMENT OF THE INTERIOR  
GEOLOGICAL SURVEY

Indian Agency Sicorilla  
Tribal Sicorilla  
Allottee Sicorilla "C"  
Lease No. Contract #34

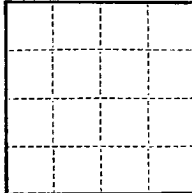

SUNDRY NOTICES AND REPORTS ON WELLS

NOTICE OF INTENTION TO DRILL	<input checked="" type="checkbox"/>	SUBSEQUENT REPORT OF WATER SHUT-OFF	
NOTICE OF INTENTION TO CHANGE PLANS		SUBSEQUENT REPORT OF SHOOTING OR REDRILLING	
NOTICE OF INTENTION TO TEST WATER SHUT-OFF		SUBSEQUENT REPORT OF ALTERING CASING	
NOTICE OF INTENTION TO REDRILL OR REPAIR WELL		SUBSEQUENT REPORT OF REDRILLING OR REPAIR	
NOTICE OF INTENTION TO SHOOT OR ACIDIZE		SUBSEQUENT REPORT OF ABANDONMENT	
NOTICE OF INTENTION TO PULL OR ALTER CASING		SUPPLEMENTARY WELL HISTORY	
NOTICE OF INTENTION TO ABANDON WELL			

RECEIVED  
NOV 24 1958  
GEOLOGICAL SURVEY  
WASHINGTON NEW MEXICO

(INDICATE ABOVE BY CHECK MARK NATURE OF REPORT, NOTICE, OR OTHER DATA)

November 21, 1958

Sicorilla "C"  
Well No. 21 is located 1900 ft. from S line and 1900 ft. from E line of sec. 22  
NW 1/4 - SE 1/4 Section 22 23N 34 N.M.P.M.  
(1/4 Sec. and Sec. No.) (Twp.) (Range) (Meridian)  
Otero (Callup) Rio Arriba New Mexico  
(Field) (County or Subdivision) (State or Territory)

The elevation of the derrick floor above sea level is \_\_\_\_\_ ft.

DETAILS OF WORK

(State names of and expected depths to objective sands; show sizes, weights, and lengths of proposed casings; indicate mudding jobs, cementing points, and all other important proposed work)

It is our intention to drill Well No. 21 to approximately 6900' to test the Gallup formation. Our casing program is as follows:

300' of 10-3/4" OD 32.75# N-40 casing with 250 sacks of regular cement, to be circulated.

6300' of 5 1/2" OD 15.5# J-55 casing with 450 sacks of regular cement.

The designated drilling unit is the NW 1/4 - SE 1/4 of Section 22-23N-34, Rio Arriba County, New Mexico.

If necessary, DV tool to be run to cover FC with cement.

I understand that this plan of work must receive approval in writing by the Geological Survey before operations may be commenced.

Company \_\_\_\_\_

Address \_\_\_\_\_

By (Signed) P. E. Cosper

Title District Superintendent

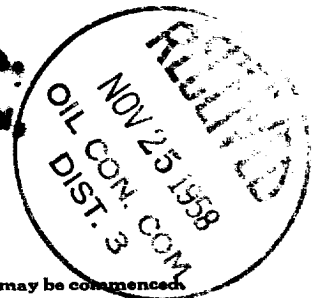

NEW MEXICO OIL CONSERVATION COMMISSION  
Well Location and Acreage Dedication Plat

Section A.

Date November 21, 1958

Operator SKELLY OIL COMPANY Lease JICARILLA  
Well No. C#21 Unit Letter J Section 28 Township 25 NORTH Range 5 WEST NMPM  
Located 1980 Feet From THE SOUTH Line, 1980 Feet From THE EAST Line  
County RIO ARriba G. L. Elevation - Dedicated Acreage 40 Acres  
Name of Producing Formation Gallup Pool Other

1. Is the Operator the only owner\* in the dedicated acreage outlined on the plat below?  
Yes X No       .
2. If the answer to question one is "no," have the interests of all the owners been consolidated by communitization agreement or otherwise? Yes        No       . If answer is "yes," Type of Consolidation
3. If the answer to question two is "no," list all the owners and their respective interests below:

Owner

Land Description

**RECEIVED**

NOV 24 1958

U. S. GEOLOGICAL SURVEY  
FARMINGTON NEW MEXICO

Section B

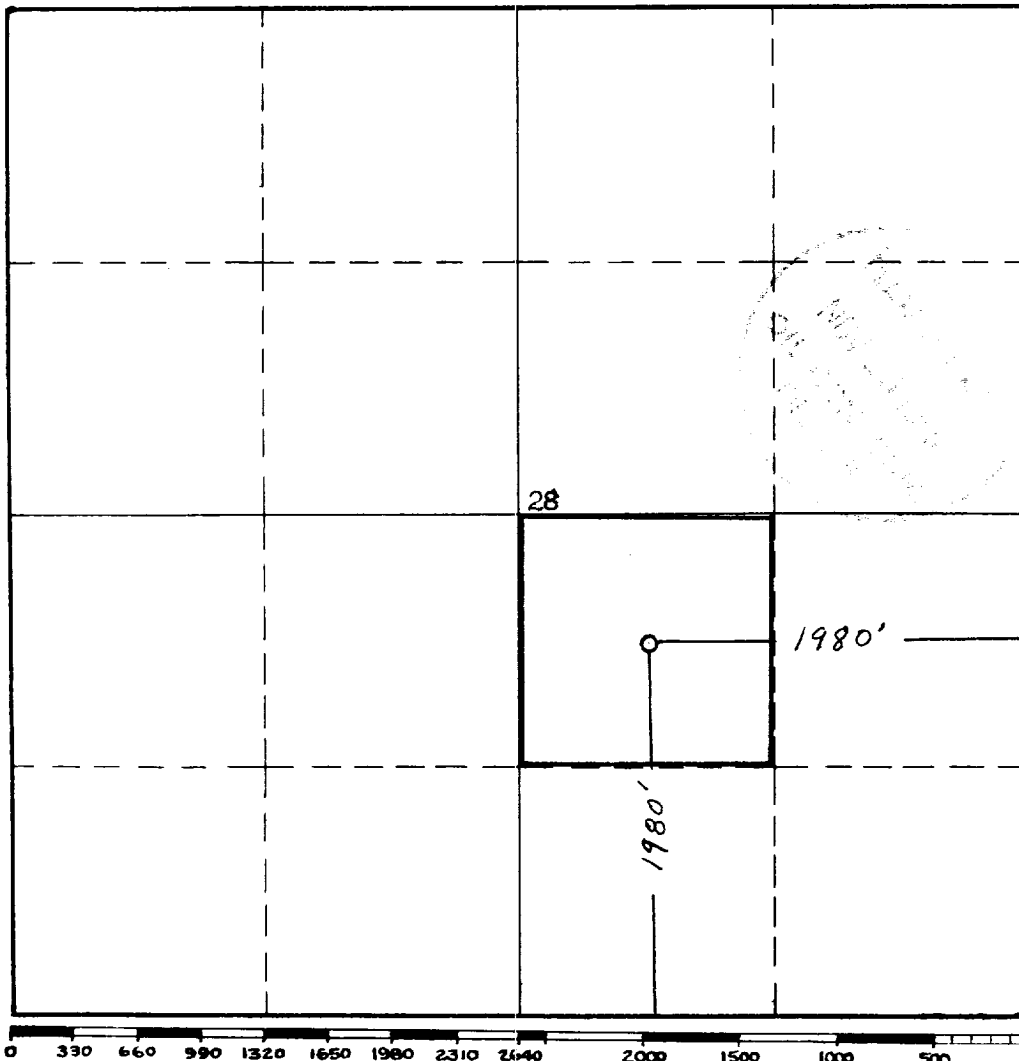

This is to certify that the information in Section A above is true and complete to the best of my knowledge and belief.

SKELLY OIL COMPANY

(Operator)

(Signed) P. E. Cosper

(Representative)

Box 426 - Farmington, New Mexico  
Address

This is to certify that the well location shown on the plat in Section B was plotted from field notes of actual surveys made by me or under my supervision and that the same is true and correct to the best of my knowledge and belief.

Date Surveyed 20th Nov, 1958

James P. Leese  
Registered Professional  
Engineer and/or Land Surveyor.  
James P. Leese

Certificate No. 1463

(See instructions for completing this form on the reverse side)

INSTRUCTIONS FOR COMPLETION:

1. Operator shall furnish and certify to the information called for in Section A.
2. Operator shall outline the dedicated acreage for both oil and gas wells on the plat in Section B.
3. A registered professional engineer or land surveyor registered in the State of New Mexico or approved by the Commission shall show on the plat the location of the well and certify this information in the space provided.
4. All distances shown on the plat must be from the outer boundaries of Section.
5. If additional space is needed for listing owners and their respective interests as required in question 3, Section A, please use space below

\* "Owner" means the person who has the right to drill into and to produce from any pool and to appropriate the production either for himself or for himself and another. (65-3-29 (e) NMSA 1953 Comp.)