

(SUBMIT IN TRIPLICATE)

Indian Agency Alamogordo

UNITED STATES
DEPARTMENT OF THE INTERIOR
GEOLOGICAL SURVEY

Allottee Alamogordo Tribal

Lease No. Lease No. 66

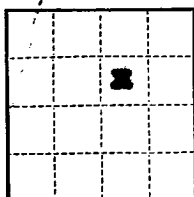

SUNDRY NOTICES AND REPORTS ON WELLS

NOTICE OF INTENTION TO DRILL	<input checked="" type="checkbox"/>	SUBSEQUENT REPORT OF WATER SHUT-OFF	
NOTICE OF INTENTION TO CHANGE PLANS		SUBSEQUENT REPORT OF SHOOTING OR ACIDIZING	
NOTICE OF INTENTION TO TEST WATER SHUT-OFF		SUBSEQUENT REPORT OF ALTERING CASING	
NOTICE OF INTENTION TO REDRILL OR REPAIR WELL		SUBSEQUENT REPORT OF REDRILLING OR REPAIR	
NOTICE OF INTENTION TO SHOOT OR ACIDIZE		SUBSEQUENT REPORT OF ABANDONMENT	
NOTICE OF INTENTION TO PULL OR ALTER CASING		SUPPLEMENTARY WELL HISTORY	
NOTICE OF INTENTION TO ABANDON WELL			

RECEIVED

APR 7 1959

U.S. GEOLOGICAL SURVEY
FARMINGTON, NEW MEXICO

(INDICATE ABOVE BY CHECK MARK NATURE OF REPORT, NOTICE, OR OTHER DATA)

April 6th, 1959

Well No. 11-B is located 1650 ft. from N line and 1670 ft. from E line of sec. 27

SW 1/4 NE 1/4 Sec. 27
(1/4 Sec. and Sec. No.)

R5N
(Twp.)

4W
(Range)

N.M.P.M.
(Meridian)

S. Blanco FC NE
(Field)

Rio Arriba
(County or Subdivision)

New Mexico
(State or Territory)

The elevation of the derrick floor above sea level is 6941 ft.

DETAILS OF WORK

(State names of and expected depths to objective sands; show sizes, weights, and lengths of proposed casings; indicate mudlogging, cementing points, and all other important proposed work)

Pictured Cliffs Sand test. Estimated total depth 3300'.

Surface Casing: 90' of 8-5/8" CD 24# J-55 cemented to surface.
Production : Approximately 3300' of 5-1/2" CD 15.5# J-55 cemented with 150 sacks.

If commercial production is indicated, the producing section will be sand-water fractured.

I understand that this plan of work must receive approval in writing by the Geological Survey before operations may be commenced.

Company EL PASO NATURAL GAS COMPANY

Address Box 997
Farmington, New Mexico

By E. S. Oberly

Title Division Petroleum Engineer

NEW MEXICO OIL CONSERVATION COMMISSION

Well Location and Acreage Dedication Plat

Section A.

Date **APRIL 6, 1959**

Operator **EL PASO NATURAL GAS COMPANY** Lease **JICARILLA** **JICARILLA APACHE NO. 66**
 Well No. **11-B** Unit Letter **G** Section **27** Township **25-N** Range **4-W** NMPM
 Located **1650** Feet From **NORTH** Line **1650** Feet From **EAST** Line
 County **RIO ARriba** G. L. Elevation **6933** Dedicate Acreage **160** Acres
 Name of Producing Formation **PICTURED CLIFF** Pool **SOUTH BLANCO PICTURED CLIFF**

1. Is the Operator the only owner in the dedicated acreage outlined on the plat below?
 Yes ☒ No ☐
2. If the answer to question one is "no", have the interests of all the owners been consolidated by communitization agreement or otherwise? Yes ☐ No ☐ If answer is "yes", Type of Consolidation:
3. If the answer to question two is "no", list all the owners and their respective interests below:

Owner

Land Description

RECEIVED**APR 7 1959**U. S. GEOLOGICAL SURVEY
FARMINGTON, NEW MEXICO

Section B.

Note: All distances must be from outer boundaries of section.

This is to certify that the information in Section A above is true and complete to the best of my knowledge and belief.

EL PASO NATURAL GAS COMPANY

S. S. Oberly
 (Operator)
 (Representative)
Box 997

(Address)

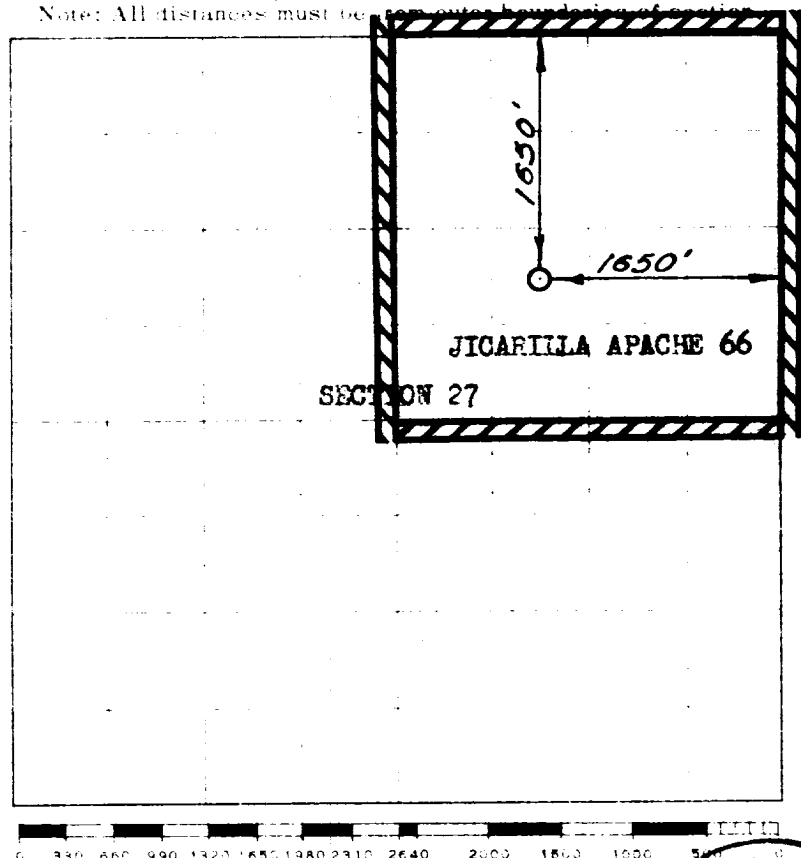
Farmington, New Mexico

Scale 4 inches equal 1 mile

This is to certify that the above plat was prepared from field notes of actual survey made by me or under my supervision and that the same are true and correct to the best of my knowledge and belief.

(Seal)

Date Surveyed **OCTOBER 22, 1958**

David O. Kilven
 Registered Professional Engineer and/or Land Surveyor

Farmington, New Mexico

RECEIVED
APR 8 1959
CON. COM.
DIST. 3